

Skagit County Public Safety Jail Facility

Law & Justice Council

Marc Estvold, AIA, LEED AP, Project Manager

September 11, 2013

Two Sites In Permitting Process

- ☐ Alf Christianson Seed Site 8.17 Acres
 - ☐ Purchase & Sale \$3.1 Million + Street
 - ☐ Free look thru Dec 1, + 9 – 2 Month Options
- ☐ Truck City / Suzanne Lane 10.38 Acres
 - ☐ Purchase & Sale \$3.1 Million + Street
 - ☐ Free look thru Dec 1, + 9 – 2 Month Options



Alf Christianson Seed Site



Truck City / Suzanne Lane Site

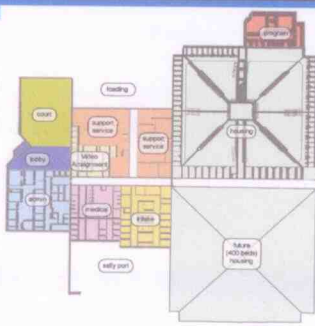

Jail Floor Plan, 400 Beds

- Phased Construction
- Phase I Built now, 400 Beds
- Phase II built 20 + years additional 400 beds
- Most of Phase II infrastructure built with Phase I
- Design to Today's Standards
- Operations Efficiency Important - 75% Building Life Budget
- Most Efficient Operations scenario

New Construction

- ☐ 400 Bed Core / 400 Beds at Opening \$60 Million
 - 400 Beds Operational at Opening W/ Expansion

Financing

- ☐ Washington State Sales Tax Increase
 - From 8.2% to 8.5% In Skagit County (autos exempt)
 - Bellevue 9.5% Bellingham 8.7% (headed to 8.9%?)
 - Everett 9.2% Seattle 9.5% Tacoma 9.5%