

TETROMINO
 DESCRIPTION OF STATE TRUST LAND SURVEYED

THE EAST HALF OF THE NORTHEAST QUARTER OF THE SOUTHWEST QUARTER OF THE NORTHEAST QUARTER OF SECTION 6, TOWNSHIP 33 NORTH, RANGE 5 EAST, W.M. AND THE SOUTHWEST QUARTER OF THE NORTHWEST QUARTER AND THE NORTH HALF OF THE NORTHWEST QUARTER OF THE SOUTHWEST QUARTER OF SECTION 5, TOWNSHIP 33 NORTH, RANGE 5 EAST, W.M. BARGAIN AND SALE DEED RECORDED UNDER AFN 20180210017 AND DATED 04-12-2018 AND THE SOUTH HALF OF THE NORTHWEST QUARTER OF THE SOUTHWEST QUARTER AND THE NORTH HALF OF THE NORTHWEST QUARTER OF THE SOUTHWEST QUARTER OF SECTION 4, TOWNSHIP 33 NORTH, RANGE 5 EAST, W.M. PER ESCHER RECORD DATED 12-27-1933

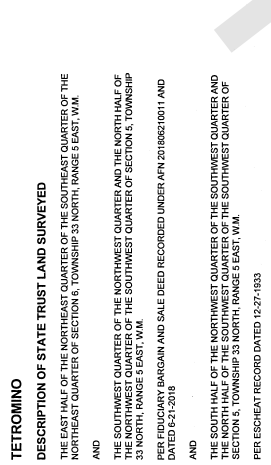

BASIS OF BEARINGS

WASHINGTON COORDINATE SYSTEM (NAD83) (EPOCH 2010.00, NORTH ZONE, DATUM AVERAGED SESSIONS USING WISH RTK OR POST PROCESSING SOLUTIONS).

CONVERGENCE

-1°01'17" AT CORNER E05
 PROJECT DISTANCE FACTOR
 THE AREAS AND DISTANCES SHOWN ARE GRID, IN U.S. SURVEY FEET. DIVIDE THE GRID DISTANCE BY 0.99997777 TO COMPUTE GROUND DISTANCE.
 LATITUDE FACTOR = 0.99998244
 LONGITUDE FACTOR = 0.99998777
 COMBINED GRID FACTOR = 0.9999777

METHOD OF HORIZONTAL CONTROL

WE USED CARLSON BR7 GNSS RECEIVERS AND THE USRN TO ESTABLISH PRIMARY CONTROL FOR THIS SURVEY. TRAVERSES WERE RUN WITH A LEICA TS18 TOTAL STATION. CLOSURES MEET RELATIVE ACCURACY STANDARDS AS SPECIFIED IN WAC 352-150.060.

NARRATIVE

THE PURPOSE OF THIS SURVEY IS TO POST PORTIONS OF STATE TRUST LAND BOUNDARY, AS SHOWN.
 THIS SURVEY DOES NOT PURPORT TO SHOW ALL EASEMENTS OF RECORD OR OTHERWISE.



AUDITOR'S INDEXING DATA

SECTION 5, TOWNSHIP 33 NORTH, RANGE 5 EAST
 SW 1/4 SW 1/4 NW 1/4 SW 1/4
 SW 1/4 NW 1/4 NW 1/4 NW 1/4
 SECTION 6, TOWNSHIP 33 NORTH, RANGE 5 EAST
 SE 1/4 NE 1/4

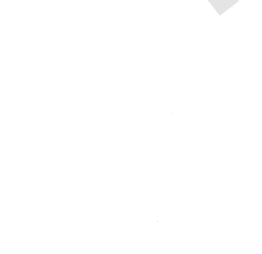

LEGEND



AUDITOR'S CERTIFICATE

FILED FOR RECORD THIS 19 DAY OF April, 2025 AT 11:10 AM IN BOOK OF SURVEYS AT PAGE AT THE REQUEST OF THE WASHINGTON STATE DEPARTMENT OF NATURAL RESOURCES.

SKAGIT COUNTY AUDITOR
 Deputy
 Brian James Williams, P.L.S. #47613

STATE OF WASHINGTON
 DEPARTMENT OF NATURAL RESOURCES
 LAND SURVEY SECTION - P.O. BOX 47030
 OLYMPIA, WASHINGTON 98504-7030 (360)902-1206

LIST OF PERTINENT SURVEY DOCUMENTS USED FOR REFERENCE

- (1) GENERAL LAND OFFICE SURVEY #1 TOWNSHIP 33 NORTH, RANGE 5 EAST BY U.S. DEPUTY SURVEYOR JAMES T. BERRY UNDER HIS CONTRACT NO. 296, DATED 2-24-1883 SURVEY OFFICE IN OLYMPIA, UNDATED
- (2) SECTION 5, TOWNSHIP 33 NORTH, RANGE 5 EAST, ON FILE WITH THE DNR PUBLIC LAND SURVEY OFFICE IN OLYMPIA, UNDATED
- (3) SECTION 6, TOWNSHIP 33 NORTH, RANGE 5 EAST, ON FILE WITH THE DNR PUBLIC LAND SURVEY OFFICE IN OLYMPIA, UNDATED
- (4) DNR SECTION CORNER MONUMENT SECTIONS 5 & 6, NE 1/4 AT THE INTERSECTION OFFICE IN SEBRACAWOLLEY, ALSO ON FILE WITH THE DNR PUBLIC LAND SURVEY OFFICE IN OLYMPIA, MULTIPLE DATES
- (5) UNRECORDED INVESTMENT CO. BY GOLDSMITH AND ASSOCIATES FOUND AT PILCHUCK TREE PANIS OFFICE, DATED 6-14-1972
- (6) AMENDED PLAT IN SECTION 6 BY HIERER, CROSSMAN & CHRISTENSEN (DAVID G. HIERER, CROSSMAN & CHRISTENSEN ASSOCIATES) SHOWING THE DISTANCE ALONG THE ORIGINAL PLAT AND THE AMENDED PLAT SHOWING DIFFERENT DISTANCES ALONG THE NORTHERLY QUARTER MILE OF THE EAST LINE OF SECTION 6. I BELIEVE THE DISTANCE SHOWN ON THE AMENDED PLAT IS A SURVEYOR'S ERROR.
- (7) RECORD OF SURVEY IN SECTION 6 BY SEMRAU & ASSOCIATES (DONALD R. SEMRAU, PLS 9623), RECORDED UNDER AFN 800777043 AND DATED 7-17-1980
- (8) RECORD OF SURVEY IN SECTION 6 BY SKAGIT SURVEYORS (JOHN ABERNETHY, PLS 17611), RECORDED UNDER AFN 860210029 AND DATED 1-21-1986
- (9) RECORD OF SURVEY IN SECTION 5 BY SKAGIT SURVEYORS (JOHN ABERNETHY, PLS 17611), RECORDED UNDER AFN 890440026 AND DATED 4-14-1989
- (10) RECORD OF SURVEY IN SECTION 6 BY LEONARD, BOUDINOT & SKODJE (JOHN E. LEONARD, JR., PLS 8692), RECORDED UNDER AFN 930605085 AND DATED 6-8-1993
- (11) RECORD OF SURVEY IN SECTION 6 BY MOWBRER & ASSOCIATES (MICHAEL T. MOWBRER, PLS 21520), RECORDED UNDER AFN 2003040139 AND DATED 4-3-2003
- (12) RECORD OF SURVEY IN SECTION 5 BY NORTHWEST DATUM & DESIGN (DOUGLAS E. SCHWIND, PLS 28223), RECORDED UNDER AFN 20071230137, AND DATED 12-3-2007
- (13) RECORD OF SURVEY IN MULTIPLE SECTIONS BY EASTSIDE CONSULTANTS (STEVEN W. KITZ, PLS 27426), RECORDED UNDER AFN 20080410001 AND DATED 4-16-2009
- (14) SHORT PLAT SURVEY IN SECTION 5 BY LISSER & ASSOCIATES (BRUCE G. LISSER, PLS 22950), RECORDED UNDER AFN 20120740030 AND DATED 1-24-2012
- (15) RECORD OF SURVEY IN SECTION 6 BY LISSER & ASSOCIATES (BRUCE G. LISSER, PLS 22950), RECORDED UNDER AFN 20160606042 AND DATED 6-6-2016
- (16) RECORD OF SURVEY IN SECTION 6 BY CASCADE SURVEYING & ENGINEERING (DERICK F. POWNER, PLS 12716), RECORDED UNDER AFN 20191010055 AND DATED 10-11-2019
- (17) RECORD OF SURVEY IN SECTION 6 BY NORTHELE SURVEYING (BRIAN ADAM GULLONG, PLS 2630768), RECORDED UNDER AFN 20200700777 AND DATED 7-7-2023
- (18) RECORD OF SURVEY IN SECTION 6 BY JEPSON & ASSOCIATES (CHRISTOPHER MICHAEL JEPSON, PLS 55823), RECORDED UNDER AFN 20230604069 AND DATED 6-9-2023

"TETROMINO" SURVEY

FIELD CREW: B. WILLIAMS, PLS
 R. THOMAS, LSIT
 E. MARCY, LSIT

FIELD BOOK: 7177
 2/10/2026

F.M.# 2427

SHEET 1 OF 3

A SURVEY IN THE WEST HALF OF THE WEST HALF OF SECTION 5 AND THE SOUTHEAST QUARTER OF THE NORTHEAST QUARTER OF SECTION 6, TOWNSHIP 33 NORTH, RANGE 5 EAST, W.M., SKAGIT COUNTY

STATE OF WASHINGTON
 DEPARTMENT OF NATURAL RESOURCES
 LAND SURVEY SECTION - P.O. BOX 47030
 OLYMPIA, WASHINGTON 98504-7030 (360)902-1206

