

After Recording Return To:  
1800 Continental Place  
Mount Vernon, WA 98273

202503280182  
03/28/2025 03:41 PM Pages: 1 of 3 Fees: \$305.50  
Skagit County Auditor



## Skagit County Public Health

Keith Higman, Director  
Howard Leibrand, M.D., Health Officer

### OPERATION-MAINTENANCE & MONITORING REQUIREMENT FOR PROPRIETARY ONSITE SEWAGE SYSTEMS

**This form must be recorded before permit approval**

#### NOTICE OF ON-SITE SEWAGE SYSTEM MAINTENANCE AGREEMENT REQUIREMENT (DESIGN)

GRANTOR: (Name of Property Owner) Allison Covey  
GRANTEE: Skagit County  
ADDRESS: 9369 PROSPECT STREET, SEDRO WOOLLEY, WA 98284  
PARCEL: P67653  
LEGAL DESCRIPTION:  
LOT 20, MOUNTAIN VISTA ADDITION V7/PAGE 65, SKAGIT COUNTY

THE FOLLOWING INFORMATION HAS BEEN DISCLOSED TO THE HOMEOWNER AS PER SKAGIT COUNTY CODE 12.05.120 AND WASHINGTON ADMINISTRATIVE CODE 246-272A-0015 and 0270:

1. Maintenance & Monitoring Required: The proposed septic system for this lot will require annual inspections or more frequently as deemed necessary by Skagit County Public Health Department.
2. Maintenance Specialist Required: The person performing this service must be certified by the Skagit County Public Health Department.

I have read and fully understand the conditions contained within this notification.

DATED this 28 day of MARCH, 2025.

Allison Covey  
Property Owner

State of Washington)  
ss.)  
County of Skagit )

Signed or attested before me on 3/28/2025 by Allison Covey (Grantor).

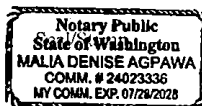

Malia Denise Agpawa  
Printed Name: Malia Denise Agpawa

Notary Public in and for the State of Washington

My commission expires: 07/28/2028

Michael Yeates  
Licensed Designer  
425.516.2627

Soil Log Profile for:  
Applicant: Andrew Bennett  
Address: 9369 Prospect St  
Sedro-Woolley  
Skagit

Parcel: P67653  
Date: 26-Mar-2025

phone: 360.970.2257

Conditions  
Property is .43 acres

Sunny



O Horizon	0-2"	(leaves, duff)
A Horizon	2-10"	surface
B Horizon	10-30"	subsoil
C Horizon	+30"	parent material

Location SL-1 is 15' W of SW corner of house (in front yard)

0-5" Loam

5-20" LFS

20-28" Motts

Water Table

26"

Location SL-2 is 20' E of back of Garage and 20' S of N Property Line (Back yard NE corner)

0-8" Loam

8-20" LFS

20-31" Motts

Water Table

26"

Findings:

Soil Type 4

Application Rate 0.6

Surface water closer than 100' No

- Sewer Main Closer than 200' - No - - -

Vegetation Open Grass and Garden area

Vertical Separation >18"

Recommended Design TL A Timed Dosing 360 GPD / .6 = 600 Sq Ft

System Recommendation - Oscar XO2 with (3) OS-100 Coils

PUD Water

Maintain min 10' to pressurized line.

Andrew Bennett Septic Design for 9369 Prospect St, Sedro-Woolley - 67653

Site Plan Detail

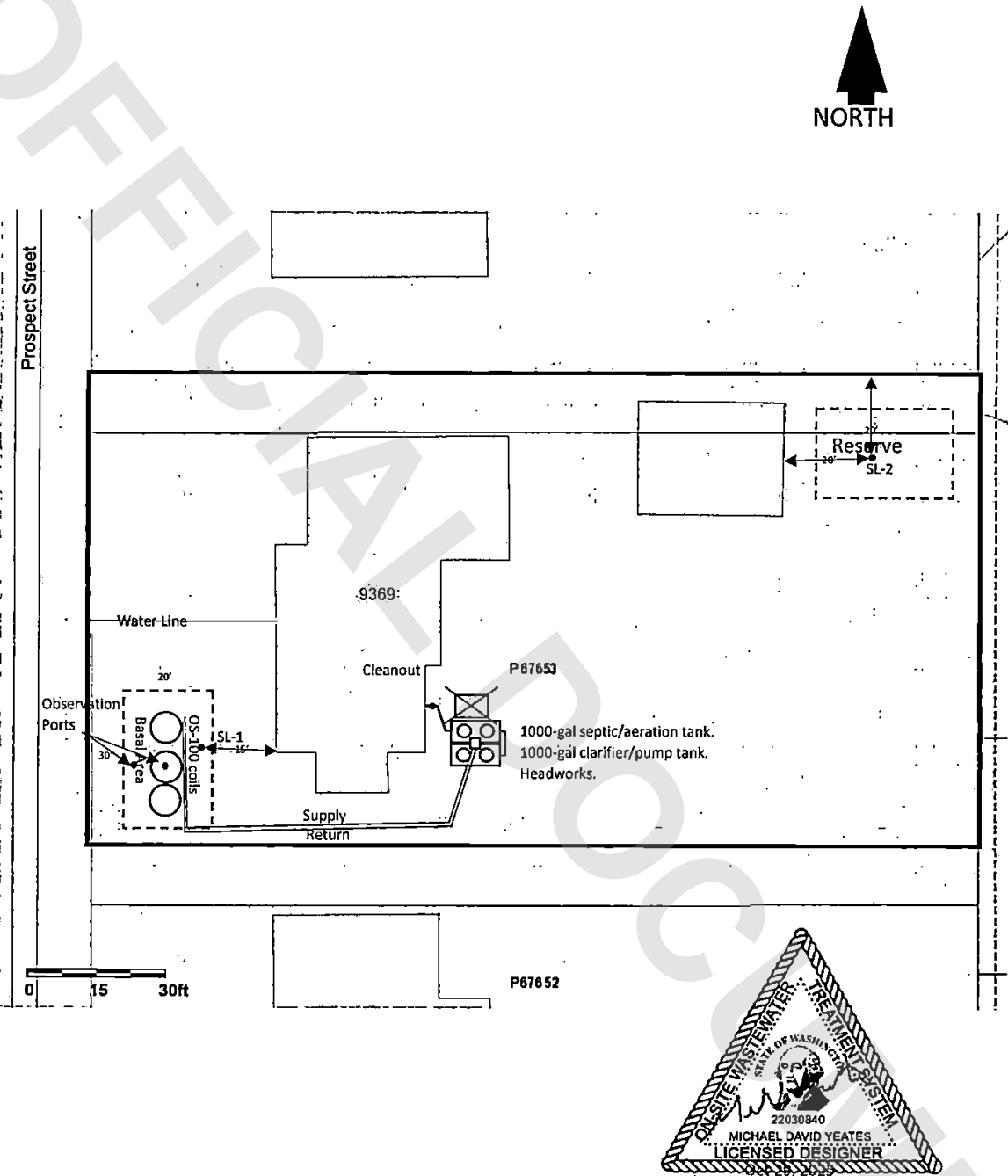

Michael Yeates – On-site Wastewater Treatment System Licensed Designer – 425.516.2627