

SURVEY NOTES:

1. THE BASIS OF BEARINGS FOR THIS SURVEY IS NORTH BY THE METHOD OF FOUND TRIPLES MONUMENT AND THE FOUND REBAR WITH CAP "KITZ" L.S. 27826 (R) SHOWN HEREON. WASHINGTON STATE PLANE COORDINATES NORTH ZONE, NAD 83/11 DERIVED FROM GNSS OBSERVATIONS VIA THE WASHINGTON SPATIAL REFERENCE NETWORK.
  2. THE VERTICAL DATUM FOR THIS SURVEY IS NAVD83 AND BASED ON "DEVILS MOUNTAIN BM" SHOWN HEREON.
  3. THIS SURVEY WAS PERFORMED USING A TRIMBLE 56 TOTAL STATION AND TRIMBLE R10 GNSS RECEIVER. ALL FIELD WORK WAS PERFORMED IN SEPTEMBER, 2024.
  4. ALL CORNERS ARE WITHIN 0.10' OF POSITION UNLESS OTHERWISE NOTED.
  5. THE PURPOSE OF THIS SURVEY IS TO UPDATE THE COMMUNICATION SITE LEASE BOUNDARY FOR QWEST CORPORATION, DBA CENTURY LINK ORIGINALLY FILED UNDER DNR APPLICATION NO. 52-082678.
- SURVEY REFERENCES/RECORDS OF SKEGITT COUNTY, WA:**
1. RECORD OF SURVEY RECORDED UNDER AFN#8904090016
  2. RECORD OF SURVEY RECORDED UNDER AFN#201070820024
  3. RECORD OF SURVEY RECORDED UNDER AFN#20109210027
  4. RECORD OF SURVEY RECORDED UNDER AFN#20202130057
  5. RECORD OF SURVEY RECORDED UNDER AFN#20103090011
  6. RECORD OF SURVEY RECORDED UNDER AFN#307160040

LEGEND

- ② FOUND MONUMENT AS NOTED
- FOUND REBAR & CAP AS NOTED
- FOUND IRON PIPE AS NOTED
- SET REBAR AND CAP L.S. 19612
- UTILITY POLE
- POWER METER
- (M) MEASURED DISTANCE
- (C) CALCULATED DISTANCE
- (D) DISTANCE PER SURVEY REFERENCE
- TPN TAX PARCEL NUMBER
- SUBJECT LEASE LINE
- TIE LINE
- SECTION LINE
- OHW — OHW
- OVERHEAD WIRE LINE

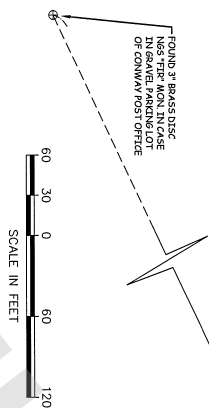

**AUDITOR'S CERTIFICATE**  
FILED FOR RECORD THIS 20 DAY OF DEC 2024 AT 2:59 AM (C)  
IN BOOK 1 OF SURVEYS AT PAGE 1, AT THE REQUEST OF QWEST CORPORATION, DBA CENTURY LINK.

202412200091  
Robert M. Anderson  
SKEGITT COUNTY AUDITOR

WASHINGTON DEPARTMENT OF NATURAL RESOURCES  
LEASE APPLICATION NO. 52-082678  
**QWEST CORPORATION, DBA CENTURY LINK**  
DEVILS MOUNTAIN COMMUNICATIONS LEASE SITE  
SECTION 11, T33N, R4E, W1A  
SKEGITT COUNTY, WA

LEASE AREA DESCRIPTION

THAT PORTION OF THE NORTHWEST QUARTER OF SECTION 11, TOWNSHIP 33 NORTH, RANGE 4 EAST, WASHINGTON, AS DESCRIBED IN VOLUME 172 OF DEEDS AT PAGE 99 AND VOLUME 214 OF DEEDS AT PAGE 399 MORE PARTICULARLY DESCRIBED AS FOLLOWS: COMMENCING AT THE WEST QUARTER CORNER OF SAID SECTION 11, BEING A 3' ALUMINUM CAP DNR MONUMENT AS SHOWN ON RECORD OF SURVEY RECORDED UNDER AFN#20103090011 RECORDS OF SKEGITT COUNTY, WA, THENCE NORTH 1°45'09" WEST 898.87 FEET ALONG THE WEST LINE OF SAID SECTION 11; THENCE NORTH 88°15'45" EAST 19.11 FEET; THENCE SOUTH 12°53'39" EAST 70.00 FEET TO A 3/4" IRON PIPE AS SHOWN ON RECORD OF SURVEY RECORDED UNDER AFN#8904090016 RECORDS OF SKEGITT COUNTY, WA, THENCE SOUTH 13°31'31" EAST 41.05 FEET TO A 5/8" REBAR WITH CAP INSCRIBED "STAR SURVEYING L.S. 19612"; THENCE NORTH 14°08'10" WEST 41.01 FEET TO A 5/8" REBAR WITH CAP INSCRIBED "STAR SURVEYING L.S. 19612"; THENCE SOUTH 77°56'53" WEST 66.56 FEET TO A 5/8" REBAR WITH CAP INSCRIBED "STAR SURVEYING L.S. 19612", SAID REBAR BEING THE TRUE POINT OF BEGINNING; CONTAINING 2738 SQUARE FEET MORE OR LESS, SITUATE IN SKEGITT COUNTY, WASHINGTON STATE.

**GRANTOR/PARENT PARCEL LEGAL DESCRIPTION**  
THE NORTHWEST QUARTER OF SECTION 11, TOWNSHIP 33 NORTH, RANGE 4 EAST, W1A, SKEGITT COUNTY, WASHINGTON, AS DESCRIBED IN VOLUME 172 OF DEEDS AT PAGE 99 AND VOLUME 214 OF DEEDS AT PAGE 399, (R)

SEGMENT	LENGTH	BEARING
L1	10.43'	N 45° 09' W
L2	91.35'	N 45° 11' E
L3	34.66'	N 87° 03' W
L4	40.00'	S 67° 10' E
L5	5.00'	N 0° 03' E
L6	66.56'	S 77° 56' W
L7	41.05'	S 87° 31' E
L8	66.57'	N 77° 54' E
L9	41.01'	N 45° 09' W

SEGMENT	LENGTH	BEARING
L10	19.11'	N 88° 15' E
L11	123.59'	N 25° 24' W
L12	25.47'	N 79° 58' E
L13	80.73'	N 88° 04' W
L14	40.00'	N 0° 03' E
L15	40.00'	N 0° 03' E
L16	40.00'	N 0° 03' E
L17	40.00'	N 0° 03' E
L18	40.00'	S 0° 03' W

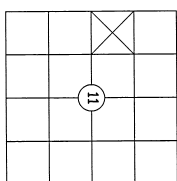

INDEX  
SECTION 11, TOWNSHIP 33 NORTH,  
RANGE 4 EAST, W1A.  
**RECORD OF SURVEY**

PREPARED AT THE REQUEST OF  
**QWEST CORPORATION, DBA CENTURY LINK**  
A PORTION OF SW1/4, NW1/4 SECTION 11,  
TOWNSHIP 33 NORTH, RANGE 4 EAST, W1A,  
MOUNT VERNON, SKEGITT COUNTY, WA

STAR SURVEYING, INC.  
PO BOX 1343  
MOUNT VERNON, WA 98201  
INSCRIBED  
WASHINGTON 39821  
LAND SURVEYING  
MAPPING  
PLANNING  
Phone: (360) 399-7693  
info@starsurveying.com  
www.starsurveying.com

CAD BY: RLP  
CHK BY: BMA  
FLD BY: DGA  
DATE: 12/19/2024  
PAGE 1 OF 2  
SCALE: 1"=60'  
JOB NO.: A2663  
PLD BK: 5024  
A2663 DWG  
CITY: 3D 2020  
SURVEYED BY FIELD TRAVERSE WITH A TRIMBLE S-6 ROBOTIC SYSTEM



TOWER DATA(NAVD88)  
CENTER OF TOWER: N:501240.85 E:1291381.15  
BASE ELEVATION: 160.43E'

FOUND 3.5" BRASS. DISC  
IN CONC. IN ROCK OUTCROPPING  
NGS MON "DEVILS MOUNTAIN RM 1941  
N-501182.3  
E:1291618.4  
ELEV.=1729.36(NAVD88)

PREPARED AT THE REQUEST OF  
QWEST CORPORATION, DBA CENTURY LINK  
A PORTION OF SW1/4, NW1/4 SECTION 11,  
TOWNSHIP 33 NORTH, RANGE 4 EAST, W.M.  
MOUNT VERNON, SKAGIT COUNTY, WA

PO BOX 1343  
ANACORTES  
WASHINGTON 98221

phone - (360)399-7693  
info.sas@rockisland.com  
www.starsurveyinginc.com

LAND SURVEYING

MAPPING

PLANNING

MAPPING

DATE: 12/19/2017

A2663.DW

**PROSE WITH A T**