



**202303160069**

03/16/2023 02:57 PM Pages: 1 of 9 Fees: \$211.50  
Skagit County Auditor

**AFTER RECORDING MAIL TO:**

SVH Partners, LLC  
232 7<sup>th</sup> Avenue N.  
Suite 100  
Seattle, WA 98109

SKAGIT COUNTY WASHINGTON  
REAL ESTATE EXCISE TAX

2023 5745  
MAR 10 2023

Amount Paid \$ 0  
Skagit Co. Treasurer  
By  Deputy

**QUIT CLAIM DEED FOR BOUNDARY LINE ADJUSTMENT**

Grantor (s): SVH PARTNERS LLC,  
a Washington limited liability company

Grantee (s): SVH PARTNERS LLC,  
a Washington limited liability company

Abbreviated Legal: Lots 9, 10, 11, 12, 13, 14, 15, & 16  
"Hartley & Rings Addition to Mount Vernon"  
Ptn NE, SW, S20, T34N, R4E

Additional Legal on page(s): Pages 1 & 2; Exhibits "A" & "B"

Assessor's Tax Parcel Nos.: 3727-002-010-0000 / P53021; 3727-002-011-0009 / P53022  
3727-002-013-0007 / P53023; 3727-002-014-0006 / P53024  
3727-002-015-0005 / P53025; 3727-002-016-0004 / P53026

**WHEREAS:** SVH PARTNERS LLC a Washington limited liability company, is the owner of the following real property (the "SVH Property Original Parcels – 13 West"):

See Exhibit "A"

**WHEREAS:** SVH PARTNERS LLC, a Washington limited liability company, wishes to adjust the above-described parcels through boundary line adjustments as described herein to combine and consolidate all of the above described real properties into a single parcel;

**SVH PARTNERS LLC CONVEYANCE OF "SVH Property Original Parcels – 13 West"**

NOW THEREFORE, SVH PARTNERS LLC, a Washington limited liability company, in consideration

QUIT CLAIM DEED FOR BOUNDARY LINE ADJUSTMENT - I  
13 - WEST

of the boundary line adjustments described herein, and for other good and valuable consideration, the receipt and sufficiency of which are hereby acknowledged, and in consideration of the mutual covenants and promises herein, does hereby convey and warrant to SVH PARTNERS LLC, a Washington limited liability company, together with all after-acquired title therein, those certain contiguous real properties identified on the attached Exhibit "A", as SVH Property Original Parcels – 13 West, which real properties are hereby combined and consolidated into a single parcel consisting of real estate situate in the County of Skagit, State of Washington, referred to as "SVH Property Final Parcel – 13 West" and as more particularly described on the attached Exhibit "B".

Maps of the parcels before and after this boundary line adjustment are attached hereto as Exhibit C and Exhibit D.

The above described property will be combined or aggregated with contiguous property owned by the grantee.

This boundary line adjustment is hereby approved.



Chris Phillips – Public Works Director, City of Mount Vernon

13 MAR 23

Dated

///

///

///

Quit Claim Deed for Boundary Line Adjustment - 3  
13 - WEST

SVH PARTNERS LLC, a Washington limited liability company  
 by: SVH MANAGER, LLC, a Washington limited liability company  
 Its: Manager

SVH MANAGER, LLC, a Washington limited liability company

*Joel Aslanian*  
 By: Joel Aslanian  
 Its: Manager  
 Date: 2/15/23

STATE OF WASHINGTON )  
 ) ss  
 COUNTY OF KING )

I certify that I know or have satisfactory evidence that JOEL ASLANIAN is the person who appeared before me, and said person acknowledged that s/he signed this instrument, on oath stated that s/he was authorized to execute the instrument and acknowledged it as the MANAGER of SVH MANAGER, LLC, a Washington limited liability company, in its capacity as MANAGER of SVH PARTNERS LLC, a Washington limited liability company, to be the free and voluntary act of such party for the uses and purposes mentioned in the instrument.

Dated: 2/15/23

*Matthew Brennan*  
 (Signature)

NOTARY PUBLIC

Matthew Brennan  
 Print Name of Notary

My appointment expires: 11/05/23

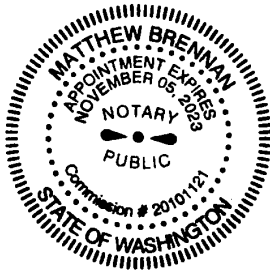

**EXHIBIT "A"**  
**"SVH PROPERTY ORIGINAL PARCELS – 13 WEST"**  
*(SVH parcels before boundary line adjustment)*

3727-002-010-0000 / P53021

Lot 9 and the South 35.00 feet of Lot 10, "HARTLEY AND RINGS ADDITION TO MOUNT VERNON", as per plat recorded in Volume 6 of Plats, records of Skagit County, Washington.

Situate in the City of Mount Vernon, County of Skagit, State of Washington.

3727-002-011-0009 / P53022

Lot 10, EXCEPT the South 35.00 feet thereof, and the South 60.00 feet of Lot 11, Block 2, "HARTLEY AND RINGS ADDITION TO MOUNT VERNON", as per plat recorded in Volume 6 of Plats, records of Skagit County, Washington.

Situate in the City of Mount Vernon, County of Skagit, State of Washington.

3727-002-013-0007 / P53023

Lot 11, EXCEPT the South 60.00 feet thereof, all of Lot 12, and the South 13 feet of Lot 13, Block 2, "HARTLEY & RINGS ADDITION TO MOUNT VERNON", as per plat recorded in Volume 6 of Plats, page 16, records of Skagit County, Washington.

Situate in the City of Mount Vernon, County of Skagit, State of Washington.

3727-002-014-0006 / P53024

The North 52.00 feet of Lot 13, and the South 3.53 feet of Lot 14, Block 2, "HARTLEY & RINGS ADDITION TO MOUNT VERNON", as per plat recorded in Volume 6 of Plats, page 16, records of Skagit County, Washington.

Situate in the City of Mount Vernon, County of Skagit, State of Washington.

3727-002-015-0005 / P53025

The North 71.47 feet of Lot 14 and the South 28.53 feet of Lot 15, Block 2, "HARTLEY & RINGS ADDITION TO MOUNT VERNON", as per plat recorded in Volume 6 of Plats, page 16, records of Skagit County, Washington.

**EXHIBIT "A"**

13 - WEST

Situate in the City of Mount Vernon, County of Skagit, State of Washington.

3727-002-015-0005 / P53026

The North 46.47 feet of Lot 15, and all of Lot 16, Block 2, "HARTLEY & RINGS ADDITION TO MOUNT VERNON", as per plat recorded in Volume 6 of Plats, page 16, records of Skagit County, Washington.

Situate in the City of Mount Vernon, County of Skagit, State of Washington.

**EXHIBIT "A"**

13 - WEST

**EXHIBIT "B"**  
**SVH PROPERTY FINAL PARCEL – 13 WEST**  
*(SVH parcel after boundary line adjustment)*

Lots 9, 10, 11, 12, 13, 14, 15, and 16, Block 2, "HARTLEY AND RINGS ADDITION TO MOUNT VERNON", as per plat recorded in Volume 6 of Plats, records of Skagit County, Washington.

Situate in the City of Mount Vernon, County of Skagit, State of Washington.

**EXHIBIT "B"**  
13 - WEST

## EXHIBIT "C"

## MAP BEFORE BOUNDARY LINE ADJUSTMENT

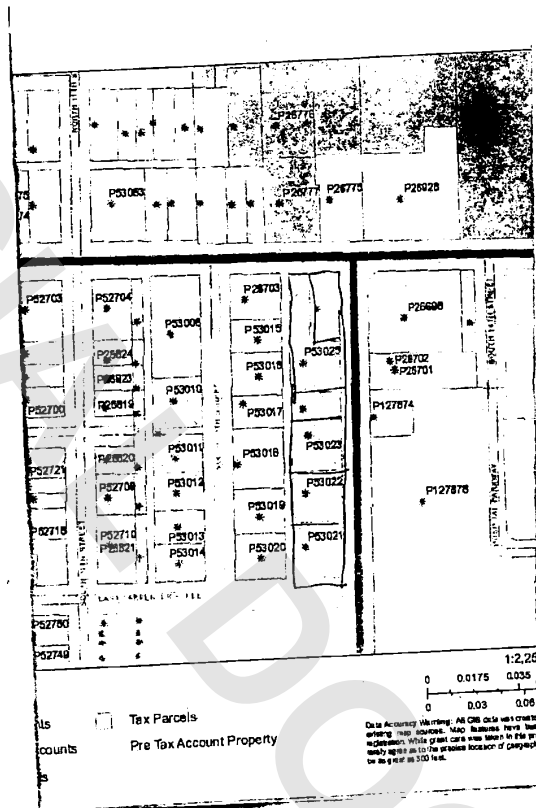

EXHIBIT "C"

13 - WEST



## EXHIBIT "D"

## MAP AFTER BOUNDARY LINE ADJUSTMENT



EXHIBIT "D"

13 - WEST