



202202180187

02/18/2022 03:40 PM Pages: 1 of 2 Fees: \$204.50  
Skagit County Auditor

Return to:

\_\_\_\_\_  
\_\_\_\_\_  
\_\_\_\_\_

**PROTECTED CRITICAL AREA SITE PLAN**

Page 1 of 2

Grantor/Owner: Timothy Boettcher

Grantee: PUBLIC

Site Address: 7448 Hayes Lane

Property ID #: 109053 Assessors Tax Account #: 350412-1-013-1400

Legal Description: SW ¼ NE ¼ Sec. 12 Twp. 35 Rng. 04

Permit/Activity #: PL21-0463

The PROTECTED CRITICAL AREA (PCA) is to be left undisturbed in its natural state. "With the exception of activities identified as Allowed without Standard review under SCC 14.24.070, any land-use activity that can impair the functions and values of critical areas or their buffers through a development activity or by disturbance of the soil or water, and/or by removal of, or damage to, existing vegetation shall require critical areas review and written authorization pursuant to SCC 14.24." SCC 14.24.060

No clearing, grading, filling, logging or removal of woody material, building, construction or road construction of any kind, planting of non-native vegetation or grazing of livestock is allowed within the PCA areas except as specifically permitted by Skagit County on a case-by-case basis consistent with SCC 14.24.

Representations on this site plan may be approximations only and should not be used for purposes other than for determining general locations of critical areas. Development activities beyond the scope of this plan may require additional studies and approvals.

The above references to "Grantor" and "Grantee" shall not be construed as a transfer of property ownership and are used solely for filing with the County Auditor.

Owner: *[Signature]* Date: 2/2/22

On this day personally appeared before me Timothy Boettcher, to me known to be the individual(s) described in and who executed the within and foregoing instrument, and acknowledged that he/she/they signed the same as his/her/their free and voluntary act and deed, for the uses and purposes therein mentioned.

Given under my hand and seal of office this 2 day of February, 2022



*[Signature]*  
Notary Public residing at Sedrow Valley  
My Commission Expires: 08/19/2023

### Critical Areas Site Plan

Parcel P109053  
7448 Hayes Lane

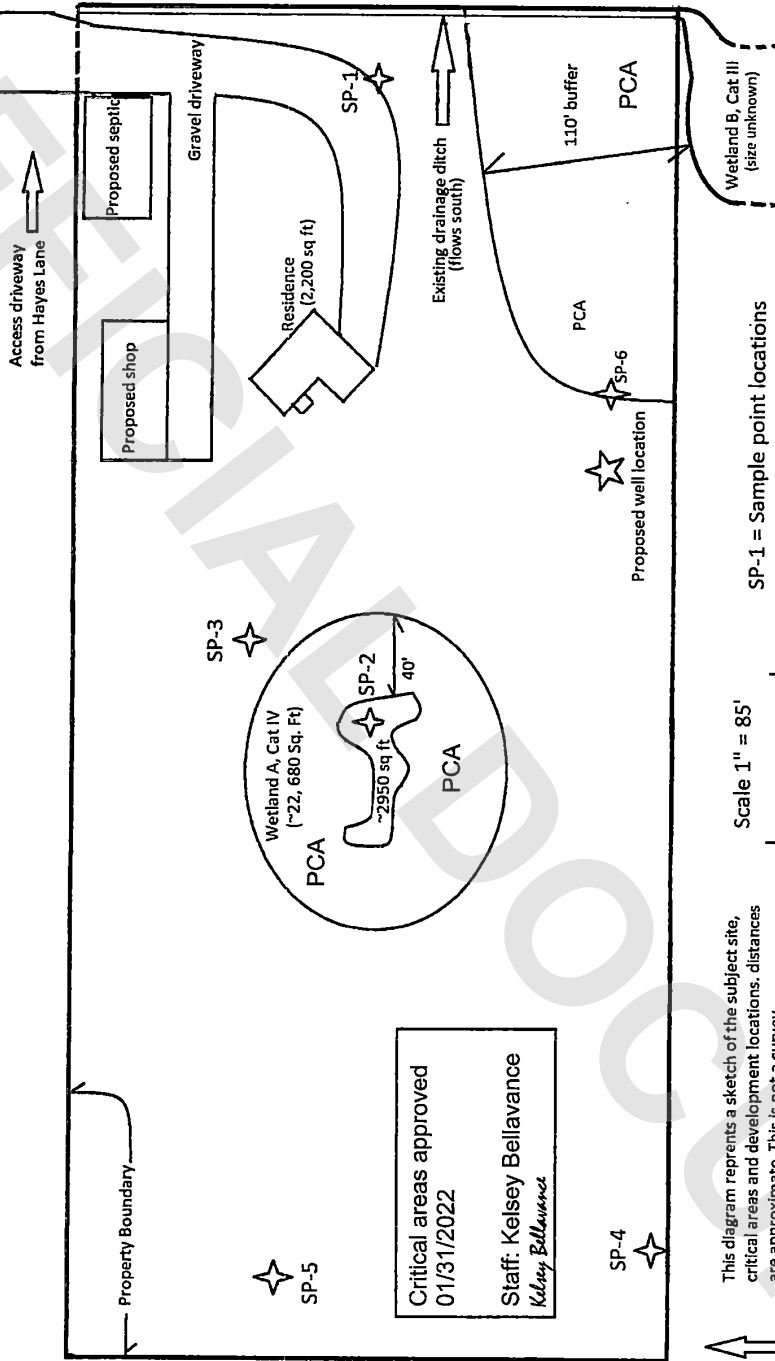

Critical areas approved  
01/31/2022  
Staff: Kelsey Bellavance  
*Kelsey Bellavance*

North ↑  
Scale 1" = 85'  
85'  
SP-1 = Sample point locations

This diagram represents a sketch of the subject site, critical areas and development locations. Distances are approximate. This is not a survey.

Prepared by Cooper GeoSciences  
December 2021.