

DESCRIPTION OF STATE TRUST LAND SURVEYED

SECTION 16, TOWNSHIP 36 NORTH, RANGE 9 EAST, WM, SKAGIT COUNTY
PER U.S. PATENT NUMBER 46,79,009; GRANTED 2-22-1884. SEE DEED RECORDED UNDER A/N 42789

BASIS OF BEARINGS

WASHINGTON COORDINATE SYSTEM, NAD(2011) EPOCH 2010, NORTH ZONE, DERIVED FROM AVERAGED STATIC GPS SESSIONS WITH OPUS POST PROCESSING
CONVERGENCE:

PROJECT DISTANCE FACTOR:
THE AREAS AND DISTANCES SHOWN HEREON WERE THE GRID DISTANCE BY 0.9999992 TO COMPARE TO GRID DISTANCE.
LATITUDE FACTOR = 0.9999992
LONGITUDE FACTOR = 0.9999992
CONVERSION GRID FACTOR = 0.999999555

METHOD OF HORIZONTAL CONTROL

WE ESTABLISHED PRIMARY CONTROL FOR THIS SURVEY WITH SIX TRIPLET STATION POINTS. WE USED A LEICA GS14 AND GS16 RECEIVERS, USING BASE STATIONS ESTABLISHED BY MULTIPLE STATIC GPS SESSIONS PROCESSED WITH OPERATING A LEICA TS16 TOTAL STATION. TRAVELERS WERE EITHER CLOSED LOOPS OR BEGAN AND ENDED ON GPS BENCHMARKS. CLOSURES WERE RELATIVE ACCURACY STATIONED AS SPECIFIED IN WA 05S 10045.

NARRATIVE

THE PURPOSE OF THIS SURVEY IS TO RETRACE AND POST THE WEST LINE OF SECTION 16.

THIS SURVEY DOES NOT PURPORT TO SHOW ALL EASEMENTS OF RECORD OR OTHERWISE.

LIST OF PERTINENT SURVEY DOCUMENTS USED FOR REFERENCE

- REGIONS INFORMATION REFERS TO THE RECORDS OF THE SKAGIT COUNTY AUDITOR.
- (1) GENERAL LAND OFFICE SURVEY BY U.S. DEPUTY SURVEYOR JOHN C. PERSONS, UNDER HIS CONTRACT NUMBER 453, DATED 4-18-1885
 - (2) GENERAL LAND OFFICE SURVEY BY U.S. GEOLOGICAL ENGINEER CHESTER W. REED, UNDER SPECIAL INSTRUCTIONS DATED 1885, COMPLETED 9-26-1885 AND COMPLETED 6-29-1885
 - (3) U.S. CORNER RECORD FOR THE SECTION CORNER COMMON TO SECTIONS 8 AND 17, ON FILE WITH THE DNR PUBLIC LAND SURVEY OFFICE IN OLWYPA AND DATED 4-13-1900
 - (4) U.S. CORNER RECORD FOR THE EAST QUARTER CORNER OF SECTION 17, ON FILE WITH THE DNR PUBLIC LAND SURVEY OFFICE IN OLWYPA AND DATED 4-13-1901
 - (5) U.S. CORNER RECORD FOR THE SECTION CORNER COMMON TO SECTIONS 8 AND 17, ON FILE WITH THE DNR PUBLIC LAND SURVEY OFFICE IN OLWYPA AND DATED 4-13-1901
 - (6) U.S. CORNER RECORD FOR THE EAST QUARTER CORNER OF SECTION 16, ON FILE WITH THE DNR PUBLIC LAND SURVEY OFFICE IN OLWYPA AND DATED 5-18-82
 - (7) U.S. CORNER RECORD FOR THE WEST QUARTER CORNER OF SECTION 16, ON FILE WITH THE DNR PUBLIC LAND SURVEY OFFICE IN OLWYPA AND DATED 5-18-82
 - (8) U.S. CORNER RECORD FOR THE EAST QUARTER CORNER OF SECTION 17, ON FILE WITH THE DNR PUBLIC LAND SURVEY OFFICE IN OLWYPA AND DATED 5-18-82
 - (9) U.S. CORNER RECORD FOR THE SECTION CORNER COMMON TO SECTIONS 8 AND 17, ON FILE WITH THE DNR PUBLIC LAND SURVEY OFFICE IN OLWYPA AND DATED 5-18-82
 - (10) U.S. CORNER RECORD FOR THE SECTION CORNER COMMON TO SECTIONS 8 AND 17, ON FILE WITH THE DNR PUBLIC LAND SURVEY OFFICE IN OLWYPA AND DATED 5-18-82
 - (11) LAND CORNER RECORD FOR CORNER 103 BY FRED PETERSEN, R.S. 26304, RECORDED UNDER A/N 880200143 AND DATED 5-30-1988
 - (12) RECORD OF SURVEY IN SECTIONS 8 AND 9 BY FRED PETERSEN, R.S. 26304, RECORDED UNDER A/N 880200143 AND DATED 5-14-1988

AUDITOR'S CERTIFICATE

FILED FOR RECORD THIS 18 DAY OF January, 2022
AT 9:35 AM UNDER AUDITORS FILE # 202201180079
AT THE REQUEST OF THE WASHINGTON STATE DEPARTMENT OF NATURAL RESOURCES

SKAGIT COUNTY AUDITOR
DEPUTY AUDITOR

[109] 17

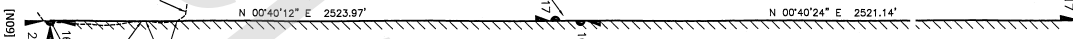

SURVEYOR'S CERTIFICATE

THIS MAP CORRECTLY REPRESENTS A SURVEY MADE BY ME OR UNDER MY DIRECTION IN CONFORMANCE WITH THE REQUIREMENTS OF THE SURVEY RECORDS ACT AND THE REQUIREMENTS OF THE WASHINGTON STATE DEPARTMENT OF NATURAL RESOURCES IN OCTOBER, 2021.

1 - 11 - 2022

47613

CERTIFICATE NUMBER

CORNER CODES REFER TO TOWNSHIP 36 NORTH, RANGE 9 EAST

(L09 OF S 8 & 17) SECTION CORNER COMMON TO SECTIONS 8 AND 17

ACCEPTED REBAR WITH ALUMINUM CAP
HISTORY:
1984 - SURVEY SETS AN IRON PIPE WITH BRASS CAP AND MARKS 2 B'S (2) 1980 - USFS FINDS ORIGINAL PIPE AND CAP LINED LOOSE ON THE GROUND AND NOTES ORIGINAL SCRIBING IN 4" STAMP FOR STUMP (9) 1982 - USFS FOUND ORIGINAL PIPE AND CAP IN MOUND OF STONE BUT BOTH ORIGINAL BEARINGS WERE WITH VISIBLE SCRIBING. SETS 7/8" REBAR WITH ALUMINUM CAP AT ORIGINAL POSITION BASED ON RECORD OF SURVEY SHOWS 2 ORIGINAL B'S AND SET REBAR. REFERENCES LAND CORNER RECORD (12)

(L09 OF S 16) WEST QUARTER CORNER OF SECTION 16
ACCEPTED ORIGINAL GLO PIPE AND CAP
HISTORY:
1924 - GLO SURVEY SETS AN IRON PIPE WITH BRASS CAP AND MARKS 2 B'S (2) 1924 - 1.5" CEDAR BEAMS 12" E, 46" W, (2) 50' 1924 - USFS FOUND ORIGINAL GLO PIPE AND CAP IN MOUND OF STONE. RECORD OF SURVEY SHOWS A FOUND GLO PIPE WITH BRASS CAP IN MOUND OF STONE AND 1 ORIGINAL GLO BR WITH SCRIBING (10) CORNER DISAPPEARANCE.
WE HELD THIS ORIGINAL QUARTER CORNER FOR THE WEST LINE OF SECTION 16 AS THE WEST LINE OF SECTION 17. SEE SECTION 7:22 OF THE 2009 MANUAL.

(L09 OF S 16 AND S 21) SECTION CORNER COMMON TO SECTIONS 16 & 21

FOUND AND RESTORED 1924 GLO PIPE AND CAP
HISTORY:
1924 - GLO SURVEY SETS AN IRON PIPE WITH BRASS CAP FOR CORNER 1971 - USFS ORIGINAL GLO PIPE AND CAP AND ORIGINAL SCRIBING (9) UNRESTORED BEARING (6) 1982 - USFS FOUND ORIGINAL GLO PIPE WITH SCRIBING (9) 1982 - RECORD OF SURVEY SHOWS A FOUND GLO PIPE WITH BRASS CAP IN MOUND OF STONE AND 1 ORIGINAL (6) SURVEY SHOWS 2 B'S WITH SCRIBING (10)

(L09 OF S 16 AND S 21) SECTION CORNER COMMON TO SECTIONS 16 & 21
FOUND AND RESTORED 1924 GLO PIPE AND CAP
HISTORY:
1924 - GLO SURVEY SETS AN IRON PIPE WITH BRASS CAP FOR CORNER 1971 - USFS ORIGINAL GLO PIPE AND CAP AND ORIGINAL SCRIBING (9) UNRESTORED BEARING (6) 1982 - USFS FOUND ORIGINAL GLO PIPE WITH SCRIBING (9) 1982 - RECORD OF SURVEY SHOWS A FOUND GLO PIPE WITH BRASS CAP IN MOUND OF STONE AND 1 ORIGINAL (6) SURVEY SHOWS 2 B'S WITH SCRIBING (10)

(L09 OF S 16 AND S 21) SECTION CORNER COMMON TO SECTIONS 16 & 21
FOUND AND RESTORED 1924 GLO PIPE AND CAP
HISTORY:
1924 - GLO SURVEY SETS AN IRON PIPE WITH BRASS CAP FOR CORNER 1971 - USFS ORIGINAL GLO PIPE AND CAP AND ORIGINAL SCRIBING (9) UNRESTORED BEARING (6) 1982 - USFS FOUND ORIGINAL GLO PIPE WITH SCRIBING (9) 1982 - RECORD OF SURVEY SHOWS A FOUND GLO PIPE WITH BRASS CAP IN MOUND OF STONE AND 1 ORIGINAL (6) SURVEY SHOWS 2 B'S WITH SCRIBING (10)

(L09 OF S 16 AND S 21) SECTION CORNER COMMON TO SECTIONS 16 & 21
FOUND AND RESTORED 1924 GLO PIPE AND CAP
HISTORY:
1924 - GLO SURVEY SETS AN IRON PIPE WITH BRASS CAP FOR CORNER 1971 - USFS ORIGINAL GLO PIPE AND CAP AND ORIGINAL SCRIBING (9) UNRESTORED BEARING (6) 1982 - USFS FOUND ORIGINAL GLO PIPE WITH SCRIBING (9) 1982 - RECORD OF SURVEY SHOWS A FOUND GLO PIPE WITH BRASS CAP IN MOUND OF STONE AND 1 ORIGINAL (6) SURVEY SHOWS 2 B'S WITH SCRIBING (10)

(L09 OF S 16 AND S 21) SECTION CORNER COMMON TO SECTIONS 16 & 21
FOUND AND RESTORED 1924 GLO PIPE AND CAP
HISTORY:
1924 - GLO SURVEY SETS AN IRON PIPE WITH BRASS CAP FOR CORNER 1971 - USFS ORIGINAL GLO PIPE AND CAP AND ORIGINAL SCRIBING (9) UNRESTORED BEARING (6) 1982 - USFS FOUND ORIGINAL GLO PIPE WITH SCRIBING (9) 1982 - RECORD OF SURVEY SHOWS A FOUND GLO PIPE WITH BRASS CAP IN MOUND OF STONE AND 1 ORIGINAL (6) SURVEY SHOWS 2 B'S WITH SCRIBING (10)

(L09 OF S 16 AND S 21) SECTION CORNER COMMON TO SECTIONS 16 & 21
FOUND AND RESTORED 1924 GLO PIPE AND CAP
HISTORY:
1924 - GLO SURVEY SETS AN IRON PIPE WITH BRASS CAP FOR CORNER 1971 - USFS ORIGINAL GLO PIPE AND CAP AND ORIGINAL SCRIBING (9) UNRESTORED BEARING (6) 1982 - USFS FOUND ORIGINAL GLO PIPE WITH SCRIBING (9) 1982 - RECORD OF SURVEY SHOWS A FOUND GLO PIPE WITH BRASS CAP IN MOUND OF STONE AND 1 ORIGINAL (6) SURVEY SHOWS 2 B'S WITH SCRIBING (10)

(L09 OF S 16 AND S 21) SECTION CORNER COMMON TO SECTIONS 16 & 21
FOUND AND RESTORED 1924 GLO PIPE AND CAP
HISTORY:
1924 - GLO SURVEY SETS AN IRON PIPE WITH BRASS CAP FOR CORNER 1971 - USFS ORIGINAL GLO PIPE AND CAP AND ORIGINAL SCRIBING (9) UNRESTORED BEARING (6) 1982 - USFS FOUND ORIGINAL GLO PIPE WITH SCRIBING (9) 1982 - RECORD OF SURVEY SHOWS A FOUND GLO PIPE WITH BRASS CAP IN MOUND OF STONE AND 1 ORIGINAL (6) SURVEY SHOWS 2 B'S WITH SCRIBING (10)

(L09 OF S 16 AND S 21) SECTION CORNER COMMON TO SECTIONS 16 & 21
FOUND AND RESTORED 1924 GLO PIPE AND CAP
HISTORY:
1924 - GLO SURVEY SETS AN IRON PIPE WITH BRASS CAP FOR CORNER 1971 - USFS ORIGINAL GLO PIPE AND CAP AND ORIGINAL SCRIBING (9) UNRESTORED BEARING (6) 1982 - USFS FOUND ORIGINAL GLO PIPE WITH SCRIBING (9) 1982 - RECORD OF SURVEY SHOWS A FOUND GLO PIPE WITH BRASS CAP IN MOUND OF STONE AND 1 ORIGINAL (6) SURVEY SHOWS 2 B'S WITH SCRIBING (10)

(L09 OF S 16 AND S 21) SECTION CORNER COMMON TO SECTIONS 16 & 21
FOUND AND RESTORED 1924 GLO PIPE AND CAP
HISTORY:
1924 - GLO SURVEY SETS AN IRON PIPE WITH BRASS CAP FOR CORNER 1971 - USFS ORIGINAL GLO PIPE AND CAP AND ORIGINAL SCRIBING (9) UNRESTORED BEARING (6) 1982 - USFS FOUND ORIGINAL GLO PIPE WITH SCRIBING (9) 1982 - RECORD OF SURVEY SHOWS A FOUND GLO PIPE WITH BRASS CAP IN MOUND OF STONE AND 1 ORIGINAL (6) SURVEY SHOWS 2 B'S WITH SCRIBING (10)

(L09 OF S 16 AND S 21) SECTION CORNER COMMON TO SECTIONS 16 & 21
FOUND AND RESTORED 1924 GLO PIPE AND CAP
HISTORY:
1924 - GLO SURVEY SETS AN IRON PIPE WITH BRASS CAP FOR CORNER 1971 - USFS ORIGINAL GLO PIPE AND CAP AND ORIGINAL SCRIBING (9) UNRESTORED BEARING (6) 1982 - USFS FOUND ORIGINAL GLO PIPE WITH SCRIBING (9) 1982 - RECORD OF SURVEY SHOWS A FOUND GLO PIPE WITH BRASS CAP IN MOUND OF STONE AND 1 ORIGINAL (6) SURVEY SHOWS 2 B'S WITH SCRIBING (10)

(L09 OF S 16 AND S 21) SECTION CORNER COMMON TO SECTIONS 16 & 21
FOUND AND RESTORED 1924 GLO PIPE AND CAP
HISTORY:
1924 - GLO SURVEY SETS AN IRON PIPE WITH BRASS CAP FOR CORNER 1971 - USFS ORIGINAL GLO PIPE AND CAP AND ORIGINAL SCRIBING (9) UNRESTORED BEARING (6) 1982 - USFS FOUND ORIGINAL GLO PIPE WITH SCRIBING (9) 1982 - RECORD OF SURVEY SHOWS A FOUND GLO PIPE WITH BRASS CAP IN MOUND OF STONE AND 1 ORIGINAL (6) SURVEY SHOWS 2 B'S WITH SCRIBING (10)

(L09 OF S 16 AND S 21) SECTION CORNER COMMON TO SECTIONS 16 & 21
FOUND AND RESTORED 1924 GLO PIPE AND CAP
HISTORY:
1924 - GLO SURVEY SETS AN IRON PIPE WITH BRASS CAP FOR CORNER 1971 - USFS ORIGINAL GLO PIPE AND CAP AND ORIGINAL SCRIBING (9) UNRESTORED BEARING (6) 1982 - USFS FOUND ORIGINAL GLO PIPE WITH SCRIBING (9) 1982 - RECORD OF SURVEY SHOWS A FOUND GLO PIPE WITH BRASS CAP IN MOUND OF STONE AND 1 ORIGINAL (6) SURVEY SHOWS 2 B'S WITH SCRIBING (10)



LINE POSTING



FOUND MONUMENT

INDICATES THAT A WHITE CARBONITE TOWNSHIP CORNER BEARS THE BEARING AND DISTANCE FROM THE MONUMENT OVER ITS BASE AND RESULT THE ROCK MOUND.

SECTION 16, TOWNSHIP 36 NORTH, RANGE 9 EAST
NW 1/4 SW 1/4, SW 1/4 NW 1/4
NW 1/4 SW 1/4, SW 1/4 NW 1/4

AUDITOR'S INDEXING DATA

A SURVEY IN SECTION 16,
TOWNSHIP 36 NORTH, RANGE 9 EAST, WM,
SKAGIT COUNTY
STATE OF WASHINGTON
DEPARTMENT OF NATURAL RESOURCES
LAND SURVEY SECTION - P.O. BOX 47030
OLYMPIA, WASHINGTON 98504-7030 (360) 902-1206

"DWALIN" SURVEY
FIELD CREW: B WILLIAMS, P.L.S.
R THOMAS, L.S.T.
FIELD BOOK: 746 109/26/2021
FINAL MAP NUMBER: 2204
SHEET 1 OF 1

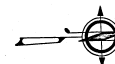

1" = 400 FEET
SECTION 16, TOWNSHIP 36 NORTH, RANGE 9 EAST
WASHINGTON COORDINATE SYSTEM
NORTH ZONE, MAD83 (CON2011) EPOCH 2010