



202110180116

10/18/2021 03:47 PM Pages: 1 of 18 Fees: \$220.50
Skagit County Auditor

When recorded return to:

Craig Sjoström
1204 Cleveland Ave.
Mount Vernon, Washington 98273

Consent to Adjustment to Legal Descriptions

Grantor: William R. Kelly

Grantees: Michael Dahl & Sonia Dahl

Legal Description: Lots 4-7, Block 1, Everett's Garden Tracts

Assessor's Property Tax Parcel or Account Nos.: P70858; P70861; P70864; P70866

Reference Nos of Documents Assigned or Released: 201705170052

THIS CONSENT TO ADJUSTMENT OF LEGAL DESCRIPTIONS is made this 30
day of AUGUST, 2021, between William R. Kelly, as Beneficiary, and Michael Dahl & Sonia Dahl,
h/w, as Owners.

Recitals

- a. Owners are the owners of the property bearing Skagit County Assessor's parcel nos. P70858; P70861; P70864; and P70866, described in the attached Exhibit A.
- b. Beneficiary is the beneficiary of a Deed of Trust, encumbering the said parcels, dated May 12th, 2017 and recorded under Skagit County Auditor's File No. 201705170052.
- c. Owners wish to adjust the boundaries between the various parcels, per the descriptions set forth in the attached Exhibits B through G.
- d. Beneficiary is consenting to the adjustment of the boundaries and the consequent alteration of the legal descriptions for the parcels encumbered by the said Deed of Trust.

Consent

THEREFORE, for and in consideration of the said Deed of Trust, and the Note secured by the same, Beneficiary does hereby consent to the alteration of the legal descriptions for the subject parcels, per the descriptions attached hereto as Exhibits L through O.

DATED: August 30 2021.

William R. Kelly
WILLIAM R. KELLY

STATE OF WA)

COUNTY OF KING)
:ss

On this day personally appeared before me William R. Kelly, to me known to be the individual described in and who executed the within and foregoing instrument, and acknowledged that he signed the same as his free and voluntary act and deed for the uses and purposes therein mentioned.

GIVEN under my hand and official seal this 30th day of August, 2021.



InSeok Cheong
NOTARY PUBLIC in and for the State of WA
residing at Kirkland
My commission expires: 03/19/2022
Name: InSeok Cheong

Exhibit A
Legal Description before

That portion of the following described tract of land lying Southerly of the Southerly line of that certain tract conveyed to the State of Washington for highway purposes by Deeds recorded August 23, 1960, and September 20, 1971, under Auditor's file No. 597903 and 758257, records of Skagit County, Washington, as follows:

Lots 4, 5, 6, and 7, Block 1, EVERETT'S GARDEN TRACTS, SUPPLEMENTAL ADDITION TO CEMENT CITY, according to the plat thereof recorded in Volume 3 of Plats, page 77, records of Skagit County, Washington;

TOGETHER WITH the vacated East 30 feet of Everett Avenue, adjoining said Lot 7 on the West;

EXCEPT that portion of vacated Everett Avenue conveyed to the State of Washington by Deed dated July 25, 1960, and recorded August 23, 1960, under Auditor's file No. 597903, records of Skagit County, Washington.

Situated in Skagit County, Washington.

Exhibit B
Conveyance of Lot 4 to Lot 5

That portion of Lot 4, Block 1, EVERETT'S GARDEN TRACTS, SUPPLEMENTAL ADDITION TO CEMENT CITY, according to the plat thereof recorded in Volume 3 of Plats, page 77, records of Skagit County, Washington, lying Southerly of the Southerly line of that certain tract conveyed to the State of Washington for highway purposes by Deeds recorded August 23, 1960, and September 20, 1971, under Auditor's File Numbers 597903 and 758257, records of Skagit County, Washington, described as follows:

Beginning at the monument, marking the southwest corner of said Lot 4, said monument being described by the Record of Survey filed under Auditor's File Number 202011030187, records of Skagit County, Washington;
thence North 7° 05' 00" East along the west line of said Lot 4 a distance of 150.06 feet to the monument marking the southeast corner of Lot 5 of said plat per said survey;
thence continue North 7° 05' 00" East along said west line of Lot 4 a distance of 86.76 feet to the **True Point of Beginning** of this portion;
thence continue North 7° 05' 00" East 93.18 feet to the southerly right-of-way margin of State Route 20 per said survey;
thence South 75° 32' 03" East along said margin 35.49 feet to an angle point of said margin;
thence South 62° 51' 16" East 95.61 feet along said margin to the monument marking the northeast corner of said Lot 4 per said survey;
thence South 7° 05' 00" West 72.92 feet along the east line of said Lot 4 per said survey;
thence North 75° 07' 43" West 126.16 feet to the **True Point of Beginning** of this portion.

Situate in the County of Skagit, State of Washington.

Exhibit C
Conveyance of Lot 5 to Lot 4

That portion of Lot 5, Block 1, EVERETT'S GARDEN TRACTS, SUPPLEMENTAL ADDITION TO THE TOWN OF CEMENT CITY, according to the plat thereof recorded in Volume 3 of Plats, page 77, records of Skagit County, Washington, lying southerly of the southerly line of that certain tract conveyed to the State of Washington for highway purposes by Deeds recorded August 23, 1960, and September 20, 1971, under Auditor's File Numbers 597903 and 758257, records of Skagit County, Washington, described as follows:

Beginning at the monument, marking the southwest corner of Lot 4, Block 1 of said Plat, said monument being described by the Record of Survey filed under Auditor's File Number 202011030187, records of Skagit County, Washington;
thence North 7° 05' 00" East 150.06 feet to the monument marking the southeast corner of Lot 5 of said plat per said survey, this being the **True Point of Beginning** of this portion;
thence continue North 7° 05' 00" East along the east line of said Lot 5 a distance of 86.76 feet;
thence North 75° 07' 43" West 120.77 feet;
thence South 14° 52' 59" West 22.33 feet;
thence North 74° 38' 57" West 2.34 feet to the west line of said Lot 5 per said survey;
thence South 7° 05' 00" West 81.34 feet along the west line of said Lot 5 to the southwest corner of said Lot 5 per said survey;
thence South 82° 55' 00" East along the south line of said lot 5 a distance of 125.00 feet to the **True Point of Beginning** of this portion.

Situate in the County of Skagit, State of Washington.

Exhibit D
Conveyance of Lot 5 to Lot 6

That portion of Lot 5, Block 1, EVERETT'S GARDEN TRACTS, SUPPLEMENTAL ADDITION TO THE TOWN OF CEMENT CITY, according to the plat thereof recorded in Volume 3 of Plats, page 77, records of Skagit County, Washington, lying southerly of the southerly line of that certain tract conveyed to the State of Washington for highway purposes by Deeds recorded August 23, 1960, and September 20, 1971, under Auditor's File Numbers 597903 and 758257, records of Skagit County, Washington, described as follows:

Beginning at the monument, marking the southwest corner of Lot 4, Block 1 of said Plat, said monument being described by the Record of Survey filed under Auditor's File Number 202011030187, records of Skagit County, Washington;
thence North 7° 05' 00" East 150.06 feet to the monument marking the southeast corner of Lot 5 of said plat per said survey;
thence continue North 7° 05' 00" East 86.76 feet along the east line of said Lot 5;
thence North 75° 07' 43" West 73.53 feet to the **True Point of Beginning** of this portion;
thence continue North 75° 07' 43" West 47.24 feet;
thence South 14° 52' 59" West 22.33 feet;
thence North 74° 38' 57" West 2.34 feet to the west line of said Lot 5 per said survey;
thence North 7° 05' 00" East 114.80 feet along the west line of said Lot 5 to the southerly right-of-way margin of State Route 20 per said survey;
thence South 75° 32' 03" East along said margin 52.58 feet;
thence South 7° 05' 00" West 92.66 feet to the **True Point of Beginning** of this portion.

Situate in the County of Skagit, State of Washington.

Exhibit E
Conveyance of Lot 6 to Lot 4

That portion of Lot 6, Block 1, EVERETT'S GARDEN TRACTS, SUPPLEMENTAL ADDITION TO THE TOWN OF CEMENT CITY, according to the plat thereof recorded in Volume 3 of Plats, page 77, records of Skagit County, Washington, lying southerly of the southerly line of that certain tract conveyed to the State of Washington for highway purposes by Deeds recorded August 23, 1960, and September 20, 1971, under Auditor's File Numbers 597903 and 758257, records of Skagit County, Washington, described as follows:

Beginning at the monument, marking the southwest corner of Lot 4, Block 1 of said Plat, said monument being described by the Record of Survey filed under Auditor's File Number 202011030187, records of Skagit County, Washington;
thence North 7° 05' 00" East 150.06 feet to the monument marking the southeast corner of Lot 5 of said plat per said survey;
thence North 82° 55' 00" West 125 feet to the southeast corner of Lot 6 per said survey and the **True Point of Beginning** of this portion;
thence continue North 82° 55' 00" West along the south line of said Lot 6 a distance of 125.00 feet to the southwest corner of said Lot 6 per said survey;
thence North 7° 05' 00" East 99.50 feet along the west line of said Lot 6 per said survey;
thence South 74° 38' 57" East 126.31 feet to the east line of said Lot 6 per said survey;
thence South 7° 05' 00" West along said east line 81.34 feet to the **True Point of Beginning** of this portion.

Situate in the County of Skagit, State of Washington.

Exhibit F
Conveyance of Lot 7 to Lot 4

That portion of Lot 7, Block 1, EVERETT'S GARDEN TRACTS, SUPPLEMENTAL ADDITION TO THE TOWN OF CEMENT CITY, according to the plat thereof recorded in Volume 3 of Plats, page 77, records of Skagit County, Washington, lying southerly of the southerly line of that certain tract conveyed to the State of Washington for highway purposes by Deeds recorded August 23, 1960, and September 20, 1971, under Auditor's File Numbers 597903 and 758257, records of Skagit County, Washington, and also that portion of the vacated East 30 feet of Everett Avenue adjoining said Lot 7, described as a whole as follows:

Beginning at the monument, marking the southwest corner of Lot 4, Block 1 of said Plat, said monument being described by the Record of Survey filed under Auditor's File Number 202011030187, records of Skagit County, Washington;
thence North 7° 05' 00" East 150.06 feet to the monument marking the southeast corner of Lot 5, Block 1 of said plat per said survey;
thence North 82° 55' 00" West 250.00 feet to the southeast corner of Lot 7, Block 1 of said plat per said survey and the **True Point of Beginning** of this portion;
thence North 7° 05' 00" East 99.50 feet along the east line of said Lot 7 per said survey;
thence North 74° 38' 57" West 25.09 feet;
thence South 10° 36' 43" West 29.16 feet;
thence North 78° 15' 14" West 118.77 feet to the easterly right-of-way margin of Everett Ave per said survey;
thence South 7° 05' 00" West 83.66 feet to the monument making the southwest corner of said Lot 7 per said survey;
thence South 82° 55' 00" East 145.00 feet to the **True Point of Beginning** of this portion;

Situated in Skagit County, Washington.

Exhibit G
Conveyance of Lot 7 to Lot 6

That portion of Lot 7, Block 1, EVERETT'S GARDEN TRACTS, SUPPLEMENTAL ADDITION TO THE TOWN OF CEMENT CITY, according to the plat thereof recorded in Volume 3 of Plats, page 77, records of Skagit County, Washington, lying southerly of the southerly line of that certain tract conveyed to the State of Washington for highway purposes by Deeds recorded August 23, 1960, and September 20, 1971, under Auditor's File Numbers 597903 and 758257, records of Skagit County, Washington, described as follows:

Beginning at the monument, marking the southwest corner of Lot 4, Block 1 of said Plat, said monument being described by the Record of Survey filed under Auditor's File Number 202011030187, records of Skagit County, Washington;
thence North 7° 05' 00" East 150.06 feet to the monument marking the southeast corner of Lot 5, Block 1 of said plat per said survey;
thence North 82° 55' 00" West 250 feet to the southeast corner of Lot 7, Block 1 of said Plat per said survey;
thence North 7° 05' 00" East 99.50 feet along the east line of said Lot 7 per said survey to the **True Point of Beginning** of this portion;
thence continue North 7° 05' 00" East along said east line 112.83 feet to the southerly right-of-way margin of State Route 20 per said survey;
thence North 75° 32' 03" West along said margin 18.10 feet;
thence South 10° 36' 43" West 111.76 feet;
thence South 74° 38' 57" East 25.09 feet to the **True Point of Beginning** of this portion.

Situate in the County of Skagit, State of Washington.

Exhibit L
Lot 4 After Boundary Line Adjustment

That portion of Lot 4, Block 1, EVERETT'S GARDEN TRACTS, SUPPLEMENTAL ADDITION TO CEMENT CITY, according to the plat thereof recorded in Volume 3 of Plats, page 77, records of Skagit County, Washington, lying southerly of the southerly line of that certain tract conveyed to the State of Washington for highway purposes by Deeds recorded August 23, 1960, and September 20, 1971, under Auditor's File Numbers 597903 and 758257, records of Skagit County, Washington;

TOGETHER WITH that portion of Lot 5, Block 1, EVERETT'S GARDEN TRACTS, SUPPLEMENTAL ADDITION TO THE TOWN OF CEMENT CITY, according to the plat thereof recorded in Volume 3 of Plats, page 77, records of Skagit County, Washington, lying southerly of the southerly line of that certain tract conveyed to the State of Washington for highway purposes by Deeds recorded August 23, 1960, and September 20, 1971, under Auditor's File Numbers 597903 and 758257, records of Skagit County, Washington, described as follows:

Beginning at the monument, marking the southwest corner of Lot 4, Block 1 of said Plat, said monument being described by the Record of Survey filed under Auditor's File Number 202011030187, records of Skagit County, Washington;
thence North 7° 05' 00" East 150.06 feet to the monument marking the southeast corner of Lot 5 of said plat per said survey, this being the **True Point of Beginning** of this portion;
thence continue North 7° 05' 00" East along the east line of said Lot 5 a distance of 86.76 feet;
thence North 75° 07' 43" West 120.77 feet;
thence South 14° 52' 59" West 22.33 feet;
thence North 74° 38' 57" West 2.34 feet to the west line of said Lot 5 per said survey;
thence South 7° 05' 00" West 81.34 feet along the west line of said Lot 5 to the southwest corner of said Lot 5 per said survey;
thence South 82° 55' 00" East along the south line of said lot 5 a distance of 125.00 feet to the **True Point of Beginning** of this portion.

ALSO TOGETHER WITH that portion of Lot 6, Block 1, EVERETT'S GARDEN TRACTS, SUPPLEMENTAL ADDITION TO THE TOWN OF CEMENT CITY, according to the plat thereof recorded in Volume 3 of Plats, page 77, records of Skagit County, Washington, lying southerly of the southerly line of that certain tract conveyed to the State of Washington for highway purposes by Deeds recorded August 23, 1960, and September 20, 1971, under Auditor's File Numbers 597903 and 758257, records of Skagit County, Washington, described as follows:

Beginning at the monument, marking the southwest corner of Lot 4, Block 1 of said Plat, said monument being described by the Record of Survey filed under Auditor's File Number 202011030187, records of Skagit County, Washington;

thence North 7° 05' 00" East 150.06 feet to the monument marking the southeast corner of Lot 5 of said plat per said survey;
thence North 82° 55' 00" West 125 feet to the southeast corner of Lot 6 per said survey and the **True Point of Beginning** of this portion;
thence continue North 82° 55' 00" West along the south line of said Lot 6 a distance of 125.00 feet to the southwest corner of said Lot 6 per said survey;
thence North 7° 05' 00" East 99.50 feet along the west line of said Lot 6 per said survey;
thence South 74° 38' 57" East 126.31 feet to the east line of said Lot 6 per said survey;
thence South 7° 05' 00" West along said east line 81.34 feet to the **True Point of Beginning** of this portion.

ALSO TOGETHER WITH that portion of Lot 7, Block 1, EVERETT'S GARDEN TRACTS, SUPPLEMENTAL ADDITION TO THE TOWN OF CEMENT CITY, according to the plat thereof recorded in Volume 3 of Plats, page 77, records of Skagit County, Washington, lying southerly of the southerly line of that certain tract conveyed to the State of Washington for highway purposes by Deeds recorded August 23, 1960, and September 20, 1971, under Auditor's File Numbers 597903 and 758257, records of Skagit County, Washington, and also with that portion of the vacated East 30 feet of Everett Avenue adjoining said Lot 7, described as a whole as follows:

Beginning at the monument, marking the southwest corner of Lot 4, Block 1 of said Plat, said monument being described by the Record of Survey filed under Auditor's File Number 202011030187, records of Skagit County, Washington;
thence North 7° 05' 00" East 150.06 feet to the monument marking the southeast corner of Lot 5, Block 1 of said plat per said survey;
thence North 82° 55' 00" West 250.00 feet to the southeast corner of Lot 7, Block 1 of said plat per said survey and the **True Point of Beginning** of this portion;
thence North 7° 05' 00" East 99.50 feet along the east line of said Lot 7 per said survey;
thence North 74° 38' 57" West 25.09 feet;
thence South 10° 36' 43" West 29.16 feet;
thence North 78° 15' 14" West 118.77 feet to the easterly right-of-way margin of Everett Ave per said survey;
thence South 7° 05' 00" West 83.66 feet to the monument making the southwest corner of said Lot 7 per said survey;
thence South 82° 55' 00" East 145.00 feet to the **True Point of Beginning** of this portion.

EXCEPT that portion of Lot 4, Block 1, EVERETT'S GARDEN TRACTS, SUPPLEMENTAL ADDITION TO CEMENT CITY, according to the plat thereof recorded in Volume 3 of Plats, page 77, records of Skagit County, Washington, lying Southerly of the Southerly line of that certain tract conveyed to the State of Washington for highway purposes by Deeds recorded August 23, 1960, and September 20, 1971, under Auditor's File Numbers 597903 and 758257, records of Skagit County, Washington, described as follows:

Beginning at the monument, marking the southwest corner of said Lot 4, said monument being described by the Record of Survey filed under Auditor's File Number 202011030187, records of Skagit County, Washington;
thence North 7° 05' 00" East along the west line of said Lot 4 a distance of 150.06 feet to the monument marking the southeast corner of Lot 5 of said plat per said survey;
thence continue North 7° 05' 00" East along said west line of Lot 4 a distance of 86.76 feet to the **True Point of Beginning** of this portion;
thence continue North 7° 05' 00" East 93.18 feet to the southerly right-of-way margin of State Route 20 per said survey;
thence South 75° 32' 03" East along said margin 35.49 feet to an angle point of said margin;
thence South 62° 51' 16" East 95.61 feet along said margin to the monument marking the Northeast corner of said Lot 4 per said survey;
thence South 7° 05' 00" West 72.92 feet along the east line of said Lot 4 per said survey;
thence North 75° 07' 43" West 126.16 feet to the **True Point of Beginning** of this portion.

Situated in Skagit County, Washington.



Exhibit M
Lot 5 After Boundary Line Adjustment

That portion of Lot 5, Block 1, EVERETT'S GARDEN TRACTS, SUPPLEMENTAL ADDITION TO CEMENT CITY, according to the plat thereof recorded in Volume 3 of Plats, page 77, records of Skagit County, Washington, lying southerly of the southerly line of that certain tract conveyed to the State of Washington for highway purposes by Deeds recorded August 23, 1960, and September 20, 1971, under Auditor's File Numbers 597903 and 758257, records of Skagit County, Washington.

TOGETHER WITH that portion of Lot 4, Block 1, EVERETT'S GARDEN TRACTS, SUPPLEMENTAL ADDITION TO CEMENT CITY, according to the plat thereof recorded in Volume 3 of Plats, page 77, records of Skagit County, Washington, lying Southerly of the Southerly line of that certain tract conveyed to the State of Washington for highway purposes by Deeds recorded August 23, 1960, and September 20, 1971, under Auditor's File Numbers 597903 and 758257, records of Skagit County, Washington, described as follows:

Beginning at the monument, marking the southwest corner of said Lot 4, said monument being described by the Record of Survey filed under Auditor's File Number 202011030187, records of Skagit County, Washington;
thence North 7° 05' 00" East along the west line of said Lot 4 a distance of 150.06 feet to the monument marking the southeast corner of Lot 5 of said plat per said survey;
thence continue North 7° 05' 00" East along said west line of Lot 4 a distance of 86.76 feet to the **True Point of Beginning** of this portion;
thence continue North 7° 05' 00" East 93.18 feet to the southerly right-of-way margin of State Route 20 per said survey;
thence South 75° 32' 03" East along said margin 35.49 feet to an angle point of said margin;
thence South 62° 51' 16" East 95.61 feet along said margin to the monument marking the northeast corner of said Lot 4 per said survey;
thence South 7° 05' 00" West 72.92 feet along the east line of said Lot 4 per said survey;
thence North 75° 07' 43" West 126.16 feet to the **True Point of Beginning** of this portion.

EXCEPT that portion of Lot 5, Block 1, EVERETT'S GARDEN TRACTS, SUPPLEMENTAL ADDITION TO THE TOWN OF CEMENT CITY, according to the plat thereof recorded in Volume 3 of Plats, page 77, records of Skagit County, Washington, lying southerly of the southerly line of that certain tract conveyed to the State of Washington for highway purposes by Deeds recorded August 23, 1960, and September 20, 1971, under Auditor's File Numbers 597903 and 758257, records of Skagit County, Washington, described as follows:

Beginning at the monument, marking the southwest corner of Lot 4, Block 1 of said Plat, said monument being described by the Record of Survey filed under Auditor's File Number 202011030187, records of Skagit County, Washington;

thence North 7° 05' 00" East 150.06 feet to the monument marking the southeast corner of Lot 5 of said plat per said survey, this being the **True Point of Beginning** of this portion;
 thence continue North 7° 05' 00" East along the east line of said Lot 5 a distance of 86.76 feet;
 thence North 75° 07' 43" West 120.77 feet;
 thence South 14° 52' 59" West 22.33 feet;
 thence North 74° 38' 57" West 2.34 feet to the west line of said Lot 5 per said survey;
 thence South 7° 05' 00" West 81.34 feet along the west line of said Lot 5 to the southwest corner of said Lot 5 per said survey;
 thence South 82° 55' 00" East along the south line of said lot 5 a distance of 125.00 feet to the **True Point of Beginning** of this portion.

ALSO EXCEPT that portion of Lot 5, Block 1, EVERETT'S GARDEN TRACTS, SUPPLEMENTAL ADDITION TO THE TOWN OF CEMENT CITY, according to the plat thereof recorded in Volume 3 of Plats, page 77, records of Skagit County, Washington, lying southerly of the southerly line of that certain tract conveyed to the State of Washington for highway purposes by Deeds recorded August 23, 1960, and September 20, 1971, under Auditor's File Numbers 597903 and 758257, records of Skagit County, Washington, described as follows:

Beginning at the monument, marking the southwest corner of Lot 4, Block 1 of said Plat, said monument being described by the Record of Survey filed under Auditor's File Number 202011030187, records of Skagit County, Washington;
 thence North 7° 05' 00" East 150.06 feet to the monument marking the southeast corner of Lot 5 of said plat per said survey;
 thence continue North 7° 05' 00" East 86.76 feet along the east line of said Lot 5;
 thence North 75° 07' 43" West 73.53 feet to the **True Point of Beginning** of this portion;
 thence continue North 75° 07' 43" West 47.24 feet;
 thence South 14° 52' 59" West 22.33 feet;
 thence North 74° 38' 57" West 2.34 feet to the west line of said Lot 5 per said survey;
 thence North 7° 05' 00" East 114.80 feet along the west line of said Lot 5 to the southerly right-of-way margin of State Route 20 per said survey;
 thence South 75° 32' 03" East along said margin 52.58 feet;
 thence South 7° 05' 00" West 92.66 feet to the **True Point of Beginning** of this portion.

Situated in Skagit County, Washington.

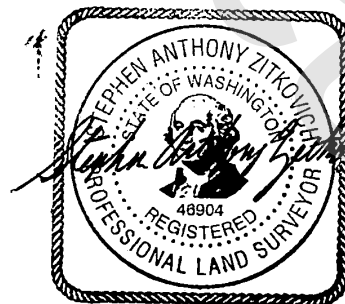

9/9/2021

Exhibit N
Lot 6 After Boundary Line Adjustment

That portion of Lot 6, Block 1, EVERETT'S GARDEN TRACTS, SUPPLEMENTAL ADDITION TO CEMENT CITY, according to the plat thereof recorded in Volume 3 of Plats, page 77, records of Skagit County, Washington, lying southerly of the southerly line of that certain tract conveyed to the State of Washington for highway purposes by Deeds recorded August 23, 1960, and September 20, 1971, under Auditor's File Numbers 597903 and 758257, records of Skagit County, Washington.

TOGETHER WITH that portion of Lot 5, Block 1, EVERETT'S GARDEN TRACTS, SUPPLEMENTAL ADDITION TO THE TOWN OF CEMENT CITY, according to the plat thereof recorded in Volume 3 of Plats, page 77, records of Skagit County, Washington, lying southerly of the southerly line of that certain tract conveyed to the State of Washington for highway purposes by Deeds recorded August 23, 1960, and September 20, 1971, under Auditor's File Numbers 597903 and 758257, records of Skagit County, Washington, described as follows:

Beginning at the monument, marking the southwest corner of Lot 4, Block 1 of said Plat, said monument being described by the Record of Survey filed under Auditor's File Number 202011030187, records of Skagit County, Washington;
thence North 7° 05' 00" East 150.06 feet to the monument marking the southeast corner of Lot 5 of said plat per said survey;
thence continue North 7° 05' 00" East 86.76 feet along the east line of said Lot 5;
thence North 75° 07' 43" West 73.53 feet to the **True Point of Beginning** of this portion;
thence continue North 75° 07' 43" West 47.24 feet;
thence South 14° 52' 59" West 22.33 feet;
thence North 74° 38' 57" West 2.34 feet to the west line of said Lot 5 per said survey;
thence North 7° 05' 00" East 114.80 feet along the west line of said Lot 5 to the southerly right-of-way margin of State Route 20 per said survey;
thence South 75° 32' 03" East along said margin 52.58 feet;
thence South 7° 05' 00" West 92.66 feet to the **True Point of Beginning** of this portion.

ALSO TOGETHER WITH that portion of Lot 7, Block 1, EVERETT'S GARDEN TRACTS, SUPPLEMENTAL ADDITION TO THE TOWN OF CEMENT CITY, according to the plat thereof recorded in Volume 3 of Plats, page 77, records of Skagit County, Washington, lying southerly of the southerly line of that certain tract conveyed to the State of Washington for highway purposes by Deeds recorded August 23, 1960, and September 20, 1971, under Auditor's File Numbers 597903 and 758257, records of Skagit County, Washington, described as follows:

Beginning at the monument, marking the southwest corner of Lot 4, Block 1 of said Plat, said monument being described by the Record of Survey filed under Auditor's File Number 202011030187, records of Skagit County, Washington;

thence North 7° 05' 00" East 150.06 feet to the monument marking the southeast corner of Lot 5, Block 1 of said plat per said survey;
 thence North 82° 55' 00" West 250 feet to the southeast corner of Lot 7, Block 1 of said Plat per said survey;
 thence North 7° 05' 00" East 99.50 feet along the east line of said Lot 7 per said survey to the **True Point of Beginning** of this portion;
 thence continue North 7° 05' 00" East along said east line 112.83 feet to the southerly right-of-way margin of State Route 20 per said survey;
 thence North 75° 32' 03" West along said margin 18.10 feet;
 thence South 10° 36' 43" West 111.76 feet;
 thence South 74° 38' 57" East 25.09 feet to the **True Point of Beginning** of this portion;

EXCEPT that portion of Lot 6, Block 1, EVERETT'S GARDEN TRACTS, SUPPLEMENTAL ADDITION TO THE TOWN OF CEMENT CITY, according to the plat thereof recorded in Volume 3 of Plats, page 77, records of Skagit County, Washington, lying southerly of the southerly line of that certain tract conveyed to the State of Washington for highway purposes by Deeds recorded August 23, 1960, and September 20, 1971, under Auditor's File Numbers 597903 and 758257, records of Skagit County, Washington, described as follows:

Beginning at the monument, marking the southwest corner of Lot 4, Block 1 of said Plat, said monument being described by the Record of Survey filed under Auditor's File Number 202011030187, records of Skagit County, Washington;
 thence North 7° 05' 00" East 150.06 feet to the monument marking the southeast corner of Lot 5 of said plat per said survey;
 thence North 82° 55' 00" West 125 feet to the southeast corner of Lot 6 per said survey and the **True Point of Beginning** of this portion;
 thence continue North 82° 55' 00" West along the south line of said Lot 6 a distance of 125.00 feet to the southwest corner of said Lot 6 per said survey;
 thence North 7° 05' 00" East 99.50 feet along the west line of said Lot 6 per said survey;
 thence South 74° 38' 57" East 126.31 feet to the east line of said Lot 6 per said survey;
 thence South 7° 05' 00" West along said east line 81.34 feet to the **True Point of Beginning** of this portion.

Situated in Skagit County, Washington.

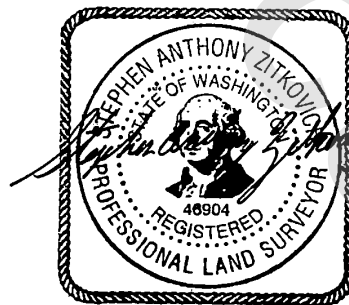

9/9/2021

Exhibit O
Lot 7 After Boundary Line Adjustment

That portion of Lot 7, Block 1, EVERETT'S GARDEN TRACTS, SUPPLEMENTAL ADDITION TO CEMENT CITY, according to the plat thereof recorded in Volume 3 of Plats, page 77, records of Skagit County, Washington, lying southerly of the southerly line of that certain tract conveyed to the State of Washington for highway purposes by Deeds recorded August 23, 1960, and September 20, 1971, under Auditor's File Numbers 597903 and 758257, records of Skagit County, Washington.

TOGETHER WITH the vacated East 30 feet of Everett Avenue, adjoining said Lot 7 on the West;

EXCEPT that portion of vacated Everett Avenue conveyed to the State of Washington by Deed dated July 25, 1960, (recorded August 23, 1960) under Auditor's File Number 597903, records of Skagit County, Washington.

ALSO EXCEPT that portion of Lot 7, Block 1, EVERETT'S GARDEN TRACTS, SUPPLEMENTAL ADDITION TO THE TOWN OF CEMENT CITY, according to the plat thereof recorded in Volume 3 of Plats, page 77, records of Skagit County, Washington, lying southerly of the southerly line of that certain tract conveyed to the State of Washington for highway purposes by Deeds recorded August 23, 1960, and September 20, 1971, under Auditor's File Numbers 597903 and 758257, records of Skagit County, Washington, described as follows:

Beginning at the monument, marking the southwest corner of Lot 4, Block 1 of said Plat, said monument being described by the Record of Survey filed under Auditor's File Number 202011030187, records of Skagit County, Washington;
thence North 7° 05' 00" East 150.06 feet to the monument marking the southeast corner of Lot 5, Block 1 of said plat per said survey;
thence North 82° 55' 00" West 250 feet to the southeast corner of Lot 7, Block 1 of said Plat per said survey;
thence North 7° 05' 00" East 99.50 feet along the east line of said Lot 7 per said survey to the **True Point of Beginning** of this portion;
thence continue North 7° 05' 00" East along said east line 112.83 feet to the southerly right-of-way margin of State Route 20 per said survey;
thence North 75° 32' 03" West along said margin 18.10 feet;
thence South 10° 36' 43" West 111.76 feet;
thence South 74° 38' 57" East 25.09 feet to the **True Point of Beginning** of this portion.

ALSO EXCEPT that portion of Lot 7, Block 1, EVERETT'S GARDEN TRACTS, SUPPLEMENTAL ADDITION TO THE TOWN OF CEMENT CITY, according to the plat thereof recorded in Volume 3 of Plats, page 77, records of Skagit County, Washington, lying southerly of the southerly line of that certain tract conveyed to the State of Washington for highway purposes by Deeds recorded August 23, 1960, and September 20, 1971, under Auditor's

File Numbers 597903 and 758257, records of Skagit County, Washington, and also that portion of the vacated East 30 feet of Everett Avenue adjoining said Lot 7, described as a whole as follows:

Beginning at the monument, marking the southwest corner of Lot 4, Block 1 of said Plat, said monument being described by the Record of Survey filed under Auditor's File Number 202011030187, records of Skagit County, Washington;
thence North 7° 05' 00" East 150.06 feet to the monument marking the southeast corner of Lot 5, Block 1 of said plat per said survey;
thence North 82° 55' 00" West 250.00 feet to the southeast corner of Lot 7, Block 1 of said plat per said survey and the **True Point of Beginning** of this portion;
thence North 7° 05' 00" East 99.50 feet along the east line of said Lot 7 per said survey;
thence North 74° 38' 57" West 25.09 feet;
thence South 10° 36' 43" West 29.16 feet;
thence North 78° 15' 14" West 118.77 feet to the easterly right-of-way margin of Everett Ave per said survey;
thence South 7° 05' 00" West 83.66 feet to the monument making the southwest corner of said Lot 7 per said survey;
thence South 82° 55' 00" East 145.00 feet to the **True Point of Beginning** of this portion.

Situated in Skagit County, Washington.

