



202103220191

03/22/2021 03:50 PM Pages: 1 of 5 Fees: \$107.50
Skagit County Auditor

Upon recording return to:
WILLIAM D REDDING
14137 GILMORE AVE
BOW, WA 98232

SKAGIT COUNTY WASHINGTON
REAL ESTATE EXCISE TAX

7501-1221
MAR 22 2021

QUIT CLAIM DEED

Amount Paid \$
By MM Skagit Co. Treasurer
Deputy

The GRANTOR, SCOTT D BUCKLES and ELLIS JENNIFER J BUCKLES, as their separate estate, for and in consideration of Establishing a Boundary Line Adjustment, Conveys and quit claims to WILLIAM D REDDING and CYNTHIA C REDDING, as there separate estate, the following described real estate, situated in the County of ~~Columbia~~ Skagit, State of Washington, together with all after acquired title of the grantor(s) therein:

EXHIBIT B

Tax Account No.: Tax ID 340217-2-015-0107 P 20450

Dated: 1/12/21

Scott Buckles 1-12-21 Jennifer Buckles 1-12-21
Name Date Name Date

Portion of Tract B of SP 15-84 517 N34N R2E
State of Washington
County of Skagit

This is to certify that on this 12th day of Jun., 2021, before me, the undersigned, a Notary Public personally appeared Scott Buckles and Jennifer Buckles, to me known to be the individual who executed the within and foregoing instruments, and acknowledged to me that he/she signed and sealed the same as his/hers free and voluntary act and deed for the uses and purposes therein mentioned. Witness my hand and official seal the day and year above written.

Jessica Kristen Bauer
Notary Public in and for the State of Washington
Residing at Burlington
My appointment expires: 08/13/2024

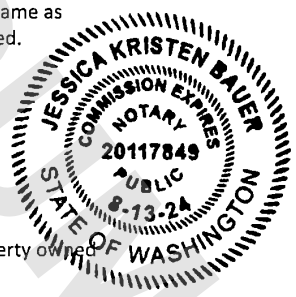

The above described property will be combined or aggregated with contiguous property owned by the grantee. This boundary line adjustment is hereby approved.

David Roeder DATE 2/1/2021
Skagit County

EXHIBIT B

PARCEL 1 - P20450 to Parcel 2 P20444

A PORTION OF TRACT B OF SKAGIT COUNTY SHORT PLAT NO. 15-84, AS APPROVED NOVEMBER 14, 1984, AND RECORDED NOVEMBER 19, 1984, IN VOLUME 6 OF SHORT PLATS, PAGE 189, UNDER AUDITOR'S FILE NO. 8411190019, RECORDS OF SKAGIT COUNTY, WASHINGTON; BEING A PORTION OF THE SOUTH ½ OF THE NORTHWEST ¼ OF SECTION 17, TOWNSHIP 34 NORTH, RANGE 2 EAST, W.M. BEING MORE PARTICULARLY DESCRIBED AS FOLLOWS: THE WEST 120.00 FT OF TRACT B OF SAID SHORT PLAT. AREA 26,403 SF (0.606 AC).

SITUATE IN THE COUNTY OF SKAGIT, STATE OF WASHINGTON.

12/04

BEFORE BOUNDARY LINE ADJUSTMENT

PARCEL A - P20444

TRACT A OF SKAGIT COUNTY SHORT PLAT NO. 15-84, AS APPROVED NOVEMBER 14, 1984, AND RECORDED NOVEMBER 19, 1984, IN VOLUME 6 OF SHORT PLATS, PAGE 189, UNDER AUDITOR'S FILE NO. 8411190019, RECORDS OF SKAGIT COUNTY, WASHINGTON; BEING A PORTION OF THE SOUTH 1/2 OF THE NORTHWEST 1/4 OF SECTION 17, TOWNSHIP 34 NORTH, RANGE 2 EAST, W.M. EXCEPT THAT PORTION OF TRACT A OF SAID SHORT PLAT NO. 15-84 LYING ADJACENT TO AND ABUTTING UPON THE SOUTH LINE OF TRACT C OF SAID SHORT PLAT NO. 15-84, AND LYING BETWEEN SOUTHERLY EXTENSION OF THE WESTERLY AND EASTERLY LINES OF SAID TRACT C. SITUATE IN THE COUNTY OF SKAGIT, STATE OF WASHINGTON.

PARCEL B - P20450

TRACT B OF SKAGIT COUNTY SHORT PLAT NO. 15-84, AS APPROVED NOVEMBER 14, 1984, AND RECORDED NOVEMBER 19, 1984, IN VOLUME 6 OF SHORT PLATS, PAGES 189, UNDER AUDITOR'S FILE NO. 8411190019, RECORDS OF SKAGIT COUNTY, WASHINGTON; BEING A PORTION OF THE SOUTH 1/2 OF THE NORTHWEST 1/4 OF SECTION 17, TOWNSHIP 34 NORTH, RANGE 2 EAST, W.M. SITUATE IN THE COUNTY OF SKAGIT, STATE OF WASHINGTON.

AFTER BOUNDARY LINE ADJUSTMENT

PARCEL 1 - P20444

TRACT A OF SKAGIT COUNTY SHORT PLAT NO. 15-84, AS APPROVED NOVEMBER 14, 1984, AND RECORDED NOVEMBER 19, 1984, IN VOLUME 6 OF SHORT PLATS, PAGE 189, UNDER AUDITOR'S FILE NO. 8411190019, RECORDS OF SKAGIT COUNTY, WASHINGTON; BEING A PORTION OF THE SOUTH 1/2 OF THE NORTHWEST 1/4 OF SECTION 17, TOWNSHIP 34 NORTH, RANGE 2 EAST, W.M. EXCEPT THAT PORTION OF TRACT A LYING ADJACENT TO AND ABUTTING UPON THE SOUTH LINE OF TRACT C OF SAID SHORT PLAT NO. 15-84, AND LYING BETWEEN SOUTHERLY EXTENSION OF THE WESTERLY AND EASTERLY LINES OF SAID TRACT C. TOGETHER WITH THE WEST 120.00 FT OF TRACT B OF SAID SHORT PLAT; EXCEPT THE SOUTH 30 FT OF SAID TRACT A WEST OF THE SOUTHERLY EXTENSION OF THE WEST LINE OF TRACT C OF SAID SHORT PLAT AND EXCEPT THE WEST 120 FT. EAST OF THE WEST OF TRACT B OF SAID SHORT PLAT EXTENDED SOUTHERLY. SITUATE IN THE COUNTY OF SKAGIT, STATE OF WASHINGTON.

PARCEL 2 - P20450

TRACT B OF SKAGIT COUNTY SHORT PLAT NO. 15-84, AS APPROVED NOVEMBER 14, 1984, AND RECORDED NOVEMBER 19, 1984, IN VOLUME 6 OF SHORT PLATS, PAGES 189, UNDER AUDITOR'S FILE NO. 8411190019, RECORDS OF SKAGIT COUNTY, WASHINGTON; EXCEPT THE WEST 120.00 FT OF SAID TRACT B; TOGETHER WITH THE SOUTH 30 FT OF SAID TRACT A EAST OF THE SOUTHERLY EXTENSION OF THE WEST LINE OF TRACT C AND EXCEPT THE WEST 120 FT. EAST OF THE WEST LINE OF TRACT B OF SAID SHORT PLAT EXTENDED SOUTHERLY; AND BEING A PORTION OF THE SOUTH 1/2 OF THE NORTHWEST 1/4 OF SECTION 17, TOWNSHIP 34 NORTH, RANGE 2 EAST, W.M. SITUATE IN THE COUNTY OF SKAGIT, STATE OF WASHINGTON.

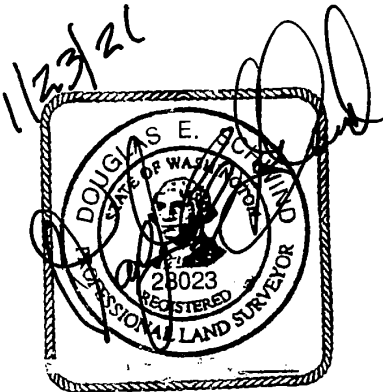

CUMMEND

