



201912100054

12/10/2019 11:59 AM Pages: 1 of 2 Fee: \$192.50
Skagit County Auditor

SURVEY DESCRIPTION

LOT 1, SAMISH SHORES PLAT, SKAGIT COUNTY, WASHINGTON, AS PER PLAT RECORDED IN VOLUME 8 OF PLATS, PAGES 7 AND 1A, RECORDS OF SKAGIT COUNTY, WASHINGTON.
SUBJECT TO AND TOGETHER WITH EASEMENTS, RESERVATIONS, RESTRICTIONS, COVENANTS, LIENS, LEASES, COURT CAUSES AND OTHER INSTRUMENTS OF RECORD.
SITUATED IN THE COUNTY OF SKAGIT, STATE OF WASHINGTON.

NOTES

1. INDICATES REBAR SET AND CAPPED WITH YELLOW CAP INSURBED LUSSEK 22960.
0 INDICATES EXISTING PIPE OR REBAR FOUND AS NOTED
2. DESCRIPTION FOR THIS SURVEY IS BASED UPON STATUTORY WARRANTY DEED RECORDED UNDER SKAGIT COUNTY AUDITOR'S FILE NUMBER 2011010010.
3. FOR ADDITIONAL SURVEY AND SUBDIVISION INFORMATION SEE SAMISH SHORES PLAT, SKAGIT COUNTY, WASHINGTON RECORDED IN VOLUME 8 OF PLATS, PAGES 7 AND 1A, RECORDS OF SKAGIT COUNTY AUDITOR'S FILE NO. 2010628079, ALL IN RECORDS OF SKAGIT COUNTY AUDITOR.
4. INSTRUMENTATION, LEICA 1103 TORA PLUS THEODOLITE DISTANCE METER
5. SURVEY PROCEDURE, STANDARD FIELD TRAVERSE
6. MERIDIAN, ASSIGNED
7. BASIS OF BEARING, MONUMENTED SOUTH LINE OF GOVERNMENT LOTS 1 AND 2, SECTION 26, TOWNSHIP 36 NORTH, RANGE 2 EAST, 1N1.
BEARING = SOUTH 84°44'30" EAST
8. THIS SURVEY WAS PERFORMED AT THE REQUEST OF D E PARKIN BUILDING DESIGN FOR THE DELINEATION AND STAKING OF THE DESCRIBED PROPERTY, AS SHOWN.
9. EXCEPT AS SPECIFICALLY STATED OR SHOWN ON THIS SURVEY MAP, THIS SURVEY WAS CONDUCTED IN ACCORDANCE WITH ALL OF THE FOLLOWING, WHICH MAY BE APPLICABLE TO THE SUBJECT REAL ESTATE, EASEMENTS, BUILDING SETBACK LINES, RESTRICTIVE COVENANTS, SUBDIVISION RESTRICTIONS, ZONING OR OTHER LAND-USE REGULATIONS.
10. ALL DISTANCES SHOWN HEREON ARE IN FEET.
11. THIS SURVEY FOUND OCCUPATIONAL INDICATORS (CONCRETE BLOCK WALLS, FENCE) AS PER MAC CHAPTER 392-130. LINES OF OCCUPATION MAY INDICATE AREAS FOR POTENTIAL CLAIMS OF UNWRITTEN OWNERSHIP. THIS BOUNDARY SURVEY HAS ONLY SHOWN THE RELATIONSHIP OF LINES OF OCCUPATION TO THE DEEDED LINES OF RECORD. NO RESOLUTION OF OWNERSHIP BASED ON UNWRITTEN RIGHTS HAS BEEN MADE OR IMPLIED BY THIS SURVEY.

AUDITOR'S CERTIFICATE

FILED FOR RECORD AT THE REQUEST OF LUSSEK & ASSOCIATES, PLLC.
FILED FOR RECORD THIS 10 DAY OF DECEMBER 2019 AT 50
MINUTES PAST 12 O'CLOCK PM IN VOLUME 8 OF PLATS, PAGES 7 AND 1A, RECORDS OF SKAGIT COUNTY, WASHINGTON.
RECORDS OF SKAGIT COUNTY, WASHINGTON.

Shirley Reilly
SKAGIT COUNTY AUDITOR

Dan Zwick
DEPUTY AUDITOR

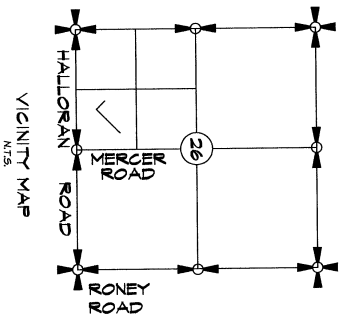

SURVEYOR'S CERTIFICATE

THIS MAP CORRECTLY REPRESENTS A SURVEY MADE BY ME OR UNDER MY DIRECTION IN CONFORMANCE WITH THE REQUIREMENTS OF THE SURVEY RECORDING ACT AT THE REQUEST OF D E PARKIN BUILDING DESIGN, IN DECEMBER 2019.

Bruce Lusser
BRUCE LUSSEK, PLLC
1400 MILLANEE STREET, BOX 1104
MOUNT VERNON, WA 98273
PHONE (360) 414-1442
FAX (360) 414-0561
E-MAIL BRUCE@LUSSEK.COM

DATE 12/10/2019



SHEET 1 OF 2

DATE 12/09/19

SURVEY IN A PORTION OF	
GOVERNMENT LOT 3	
SECTION 26, T. 36 N., R. 2 E., 1N1.	
PLAT OF SAMISH SHORES	
SKAGIT COUNTY, WASHINGTON	
FOR: DAN PARKIN	
BY: PG	LUSSEK & ASSOCIATES, PLLC SCALE
MERIDIAN, ASSIGNED	SURVEYING & LAND-USE CONSULTATION MOUNT VERNON, WA 98273 SECTION 1412 DWG. 14-124 R02

