



201805250072

05/25/2018 11:44 AM Pages: 1 of 2 Fees: \$163.00
Skagit County Auditor

Z:\Projects\2018\18005-Latham BLA\dwg\18005.dwg Mar 22, 2018 - 12:00pm

RECORD OF SURVEY FOR BOUNDARY LINE ADJUSTMENT

CONSENT

THE UNDERSIGNED AGREE THAT THE BOUNDARY LINE ADJUSTMENT SET FORTH HEREIN IS MADE THE FREE CONSENT AND IN ACCORDANCE WITH THE DESIRES OF THE OWNERS.

OWNER SKAGIT THIS 24 DAY OF APRIL, 2018.

OWNER SKAGIT THIS 24 DAY OF APRIL, 2018.

ACKNOWLEDGEMENT

STATE OF WASHINGTON)
COUNTY OF SKAGIT)

I HEREBY CERTIFY THAT ON THIS 21 DAY OF MAY, 2018, THAT THE ABOVE INDIVIDUAL(S) SIGNED CERTIFY THAT THIS BOUNDARY LINE ADJUSTMENT IS MADE AS THEIR FREE AND VOLUNTARY ACT AND DEED FOR THE USES AND PURPOSES MENTIONED.

DATE: 5-21-18 NAME: THOMAS SETH HADLEY

NOTARY PUBLIC IN AND FOR THE STATE OF WA
MY APPOINTMENT EXPIRES: 4-16-19



APPROVED FOR THE CITY OF SEDRO WOOLLEY

THE WITHIN AND FOREGOING BOUNDARY LINE ADJUSTMENT HAS BEEN EXAMINED FOR CONFORMANCE WITH THE PROVISIONS OF TITLE 59, CHAPTER 59.02, RCW, AND IS HEREBY APPROVED.

PLANNING DIRECTOR [Signature] CITY ENGINEER [Signature]

CITY TREASURER'S CERTIFICATE

I HEREBY CERTIFY THAT THERE ARE NO OUTSTANDING SPECIAL ASSESSMENTS AND THAT ALL SPECIAL ASSESSMENTS ON ANY PROPERTY CONTAINED HEREIN DEDICATED AS STREETS, ALLEYS OR OTHER PUBLIC USES ARE PAID IN FULL.

CITY TREASURER [Signature] DATE 4-24-18

AUDITOR'S CERTIFICATE

FILED FOR RECORD THIS 25 DAY OF MAY, 2018, AT 11:44 AM PM

UNDER # 201805250072

COUNTY AUDITOR [Signature] SKAGIT COUNTY DEPUTY AUDITOR [Signature]

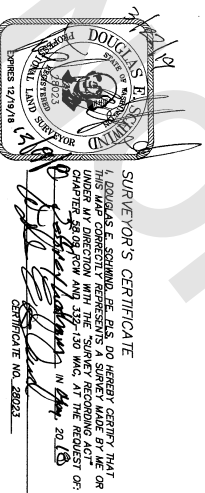

SURVEYOR'S CERTIFICATE

I, DOUGLAS E. SCHMITT, BE, PLS, DO HEREBY CERTIFY THAT THIS MAP CORRECTLY REPRESENTS A SURVEY MADE BY ME OR UNDER MY DIRECTION WITH THE STAKE RECORDING ACT OF 1994, CHAPTER 65A, RCW, IN ACCORDANCE WITH THE 2018



NORTHWEST DATUM & DESIGN CIVIL ENGINEERING AND SURVEYING SOLUTIONS

2200 UNION DRIVE
MOUNT VERNON, WASHINGTON 98273
PH: (360) 424-4865 FAX: (360) 424-4866

BOUNDARY LINE ADJUSTMENT

Lots 14 & 15, Block 74, 1st Addl. to Town of Sedro
SURVEY in a portion of the NW 1/4 of the NW 1/4 of
Section 30, T. 35 N., R. 5 E., WM

for
Jeffrey Latham
in Sedro Woolley, Washington

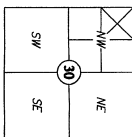

Section 30, T. 35 N., R. 5 E.
Skagit County, Washington

PROJECT 18005-LATHAM BLA

DRAWING 18005.dwg

DRAWN BY mid

CHECKED BY des

DATE

SHEET 1 OF 2

