

AUDITOR'S CERTIFICATE

201502210105
\$158.00
Skagit County Auditor
2/21/2019 Page 1 of 1 2:55PM

AT THE REQUEST OF SEMRAU ENGINEERING & SURVEYING P.L.L.C.

SKAGIT COUNTY Auditor

DEPUTY

DESCRIPTION

LOT 13, THE NORTHERLY 1/2 OF LOT 14, "PLAT OF CHEASTYS BIG LAKE TRACTS, SKAGIT COUNTY, WASHINGTON", AS PER PLAT RECORDED IN VOLUME 4 OF PLATS, ON PAGE 49, RECORDS OF SKAGIT COUNTY, WASHINGTON.

NOTES

- INDICATES IRON REBAR SET WITH YELLOW CAP - SEMRAU 28626
- INDICATES EXISTING REBAR AS DESCRIBED
- MONUMENT FOUND.
- THE DESCRIPTION FOR THIS SURVEY IS FROM STATUTORY WARRANTY DEED, AUDITOR'S FILE NO. 201404040066, RECORDS OF SKAGIT COUNTY, WASHINGTON.
- BASIS OF BEARING: MONUMENTS LOCATED AS SHOWN ON THE CENTERLINE OF LAKE VIEW BOULEVARD PER AFN 201312120049.
- BEARING = NORTH 44°17'15" WEST.
- ALL DISTANCES ARE SHOWN IN FEET.
- INSTRUMENTATION: LEICA MSSO THEODOLITE DISTANCE METER.
- SURVEY PROCEDURE: STANDARD FIELD TRAVERSE.
- THIS SURVEY WAS REQUESTED BY BRIDGETTE MCGARY.
- THIS SURVEY MAY SHOW OCCUPATIONAL INDICATORS AS PER W.A.C. CHAPTER 332.130. LINES OF OCCUPATION MAY INDICATE AREAS FOR POTENTIAL CLAIMS OF UNWRITTEN OWNERSHIP. THIS BOUNDARY SURVEY HAS ONLY SHOWN THE RELATIONSHIP OF LINES OF OCCUPATION TO THE DEEDED LINES OF RECORD. NO RESOLUTION OF OWNERSHIP BASED ON UNWRITTEN RIGHTS HAS BEEN MADE OR IMPLIED BY THIS SURVEY.
- EXCEPT AS SPECIFICALLY STATED OR SHOWN ON THIS SURVEY MAP, THIS SURVEY DOES NOT PURPORT TO REFLECT ALL OF THE FOLLOWING WHICH MAY BE APPLICABLE TO THE SUBJECT REAL ESTATE: EASEMENTS, BUILDING SETBACKS LINES, RESTRICTIVE COVENANTS, SUBDIVISION RESTRICTIONS, ZONING OR OTHER LAND-USE REGULATIONS AND ANY OTHER FACTS THAT AN ACCURATE AND CURRENT TITLE SEARCH MAY DISCLOSE.

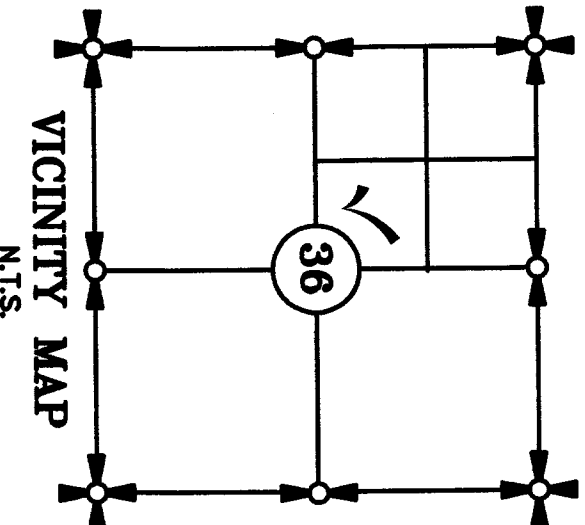

SHEET 1 OF 1

SURVEY OF

LOT 13 & THE NORTH 1/2 OF LOT 14
PLAT OF CHEASTYS BIG LAKE TRACTS,
SECTION 36, T. 34 N., R. 4 E., W.M.
SKAGIT COUNTY, WASHINGTON
FOR: BRIDGETTE MCGARY

FR. 308 PG. 65-69
MERIDIAN: ASSUMED
SEMRAU ENGINEERING & SURVEYING SCALE: 1" = 40'
SURVEYING - ENGINEERING - PLANNING
MOUNT VERNON, WA 98273 360-424-9566
JOB NO. 5756

SURVEYOR'S CERTIFICATE

THIS MAP CORRECTLY REPRESENTS A SURVEY MADE BY ME OR UNDER MY DIRECTION IN CONFORMANCE WITH THE REQUIREMENTS OF THE SURVEY RECORDING ACT AT THE REQUEST OF BRIDGETTE MCGARY IN FEBRUARY, 2018.

JOHN B. SEMRAU, P.E., P.L.S., CERTIFICATE NO. 28626
SEMRAU ENGINEERING & SURVEYING, P.L.L.C.
2118 FIVEFIVE DRIVE SUITE 208
MOUNT VERNON, WA 98273
PHONE 360-424-9566

DATE: 2-21-18

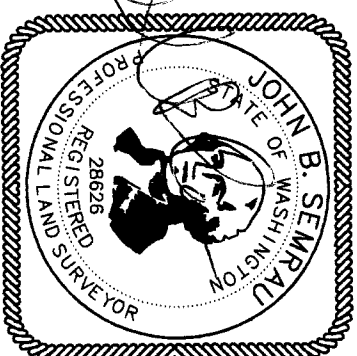

MON IN CASE
BRASS DISK W/ PUNCH
5.1", N 75°07'16" W OF
CENTERLINE PT
(AFN 201312120049)

MON IN CASE
BRASS DISK W/ PUNCH
4.49", N 65°28'33" W
OF CENTERLINE PC
(AFN 201312120049)

MONUMENT TO MONUMENT
N 44°17'15" W 573.19'
N 45°51'00" W 12.93'

A=3325.45'
R=220.39'
L=128.59'

A=1317.00'
R=1910.0'
L=442.81'

BIG LAKE

CHEASTYS BIG LAKE TRACTS

AFN 9506290046

P64397

P64396

5/8" REBAR & CAP
"SCHWIND LS 28028"
0.31' N 47°06'53" E
FROM CORNER

1/2" REBAR & CAP
"SKA SURV 17651"
0.48' N 12°46'19" E
FROM CORNER

AFN 200303050133

6

5/8" REBAR & CAP
"SCHWIND LS 28028"
0.35' N 37°46'21" E
FROM CORNER

5/8" REBAR & CAP
"SCHWIND LS 28028"
0.16' S 19°57'34" E
FROM CORNER

1/2" REBAR & CAP
"SKA SURV 17651"
0.16' N 74°12'42" W
FROM CORNER

1/2" REBAR & CAP
"SKA SURV 17651"
0.07' S 67°22'58" E
FROM CORNER

1/2" REBAR & CAP
"SKA SURV 17651"
0.07' S 67°22'58" E
FROM CORNER

1/2" REBAR & CAP
"SKA SURV 17651"
0.07' S 67°22'58" E
FROM CORNER

1/2" REBAR & CAP
"SKA SURV 17651"
0.07' S 67°22'58" E
FROM CORNER

1/2" REBAR & CAP
"SKA SURV 17651"
0.07' S 67°22'58" E
FROM CORNER

1/2" REBAR & CAP
"SKA SURV 17651"
0.07' S 67°22'58" E
FROM CORNER

1/2" REBAR & CAP
"SKA SURV 17651"
0.07' S 67°22'58" E
FROM CORNER

1/2" REBAR & CAP
"SKA SURV 17651"
0.07' S 67°22'58" E
FROM CORNER

1/2" REBAR & CAP
"SKA SURV 17651"
0.07' S 67°22'58" E
FROM CORNER

1/2" REBAR & CAP
"SKA SURV 17651"
0.07' S 67°22'58" E
FROM CORNER

1/2" REBAR & CAP
"SKA SURV 17651"
0.07' S 67°22'58" E
FROM CORNER

1/2" REBAR & CAP
"SKA SURV 17651"
0.07' S 67°22'58" E
FROM CORNER

1/2" REBAR & CAP
"SKA SURV 17651"
0.07' S 67°22'58" E
FROM CORNER

1/2" REBAR & CAP
"SKA SURV 17651"
0.07' S 67°22'58" E
FROM CORNER

1/2" REBAR & CAP
"SKA SURV 17651"
0.07' S 67°22'58" E
FROM CORNER

1/2" REBAR & CAP
"SKA SURV 17651"
0.07' S 67°22'58" E
FROM CORNER

1/2" REBAR & CAP
"SKA SURV 17651"
0.07' S 67°22'58" E
FROM CORNER

1/2" REBAR & CAP
"SKA SURV 17651"
0.07' S 67°22'58" E
FROM CORNER

1/2" REBAR & CAP
"SKA SURV 17651"
0.07' S 67°22'58" E
FROM CORNER

1/2" REBAR & CAP
"SKA SURV 17651"
0.07' S 67°22'58" E
FROM CORNER

1/2" REBAR & CAP
"SKA SURV 17651"
0.07' S 67°22'58" E
FROM CORNER

1/2" REBAR & CAP
"SKA SURV 17651"
0.07' S 67°22'58" E
FROM CORNER

1/2" REBAR & CAP
"SKA SURV 17651"
0.07' S 67°22'58" E
FROM CORNER

1/2" REBAR & CAP
"SKA SURV 17651"
0.07' S 67°22'58" E
FROM CORNER

1/2" REBAR & CAP
"SKA SURV 17651"
0.07' S 67°22'58" E
FROM CORNER

1/2" REBAR & CAP
"SKA SURV 17651"
0.07' S 67°22'58" E
FROM CORNER