

NORTH 1/4 CORNER SECTION 6
 CONCRETE MON AS PER
 SKAGIT SURVEYORS R.O.S.
 RECORDED UNDER A.F. #9206020023

APPROXIMATE LOCATION OF 100'
 AND 215' PUGET SOUND POWER
 & LIGHT EASEMENTS, RECORDED
 UNDER AUDITOR FILE NUMBERS
 177540, 558161 & 690367.

APPROXIMATE LOCATION OF 20'
 AND 55' NORTHWEST PACIFIC PIPELINE
 EASEMENTS RECORDED UNDER AUDITORS
 FILE NUMBERS 541478, 541746,
 543997 AND 560458.

NE CORNER SECTION 6
 FOUND 1" IRON SHAFT
 AS PER R.O.S. RECORDED
 UNDER A.F. #800320. 10/12/17

LEGAL DESCRIPTION:
 U.S. GOVERNMENT LOT 1, EXCEPT THE SOUTHEAST QUARTER THEREOF,
 IN SECTION 6, TOWNSHIP 34 NORTH, RANGE 5 EAST, W.M., SITUATE
 IN SKAGIT COUNTY, WASHINGTON.

SURVEYORS NOTES:
 SURVEY PROCEDURE: THIS SURVEY WAS PERFORMED IN 2017 USING A NIKON
 NPL-522.3 SECOND TOTAL STATION IN CONJUNCTION WITH A TDS RECON
 DATA COLLECTOR WITH RESULTING CLOSURES EXCEEDING PRECISION CLASS
 RURAL STANDARDS OF WAC 332-130-090.

BASIS OF BEARINGS: 500-35-40E BETWEEN THE SKAGIT SURVEYOR REBARCAP
 FOUND AT THE NE CORNER OF THE SW 1/4 OF THE NE 1/4 OF SECTION 6 AND THE
 SKAGIT SURVEYOR REBARCAP FOUND AT THE INTERSECTION OF THE EAST LINE
 OF SAID SW 1/4 NE 1/4 AND THE NORTH RW LINE OF THE OLD DAY CREEK ROAD
 AS PER R.O.S. RECORDED UNDER A.F. # 9206020023.

THIS SURVEY RELIED ON AND ACCEPTED THE SUBDIVISION OF SECTION 6 AS PER
 SKAGIT SURVEYORS 1992 RECORD OF SURVEY RECORDED UNDER AUDITORS
 FILE NUMBER 9206020023.

THIS SURVEY WAS COMPLETED WITHOUT THE BENEFIT OF A CURRENT TITLE
 REPORT AND DOES NOT PURPORT TO SHOW ANY OR ALL EASEMENTS,
 RESERVATIONS, ENCUMBRANCES, OR EXCEPTIONS WHICH MAY AFFECT THE
 PARCELS SHOWN HEREON.

THE PURPOSE OF THIS SURVEY WAS TO SURVEY AND MARK THE BOUNDARIES
 OF GOODYEAR NELSON'S OWNERSHIP AS SHOWN ON THE FACE OF THIS PLAT
 IN GOVERNMENT LOT 1 OF SECTION 6, T34N., R5E., W.M.

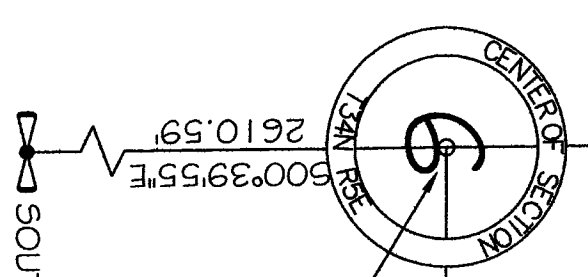
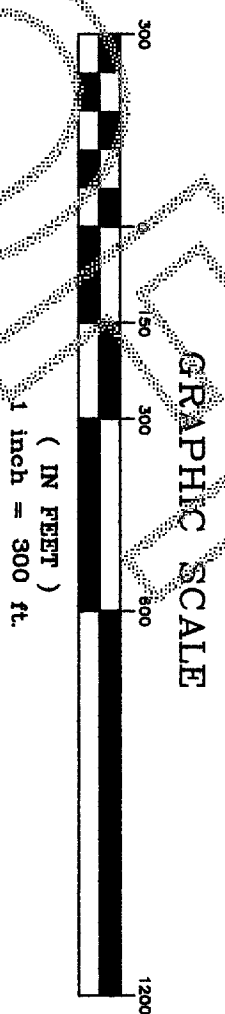

CENTER OF SECTION 6
 SKAGIT SURVEYOR REBARCAP
 AS PER R.O.S. RECORDED UNDER
 A.F. # 8601210019. SEE R.O.S.
 FOR HOW THIS WAS DETERMINED.

SOUTH 1/4 CORNER SECTION 6
 1.5" IRON PIPE AS PER
 SKAGIT SURVEYORS R.O.S.
 RECORDED UNDER A.F. #91101240032

FOUND SKAGIT SURVEYORS
 REBARCAP SET ON THE NORTH
 RW OF OLD DAY CREEK ROAD. SEE
 R.O.S. UNDER A.F.# 9206020023. 9/7/17

FOUND BARE REBAR WHICH
 BEARS EAST, 1.47' FROM
 CALCULATED POSITION. SEE
 SHORT PLAT RECORDED UNDER
 A.F. # 821900. 10/11/17

EAST 1/4 CORNER SECTION 6
 CONCRETE MON AS PER
 SKAGIT SURVEYORS R.O.S.
 RECORDED UNDER A.F. #9206020023

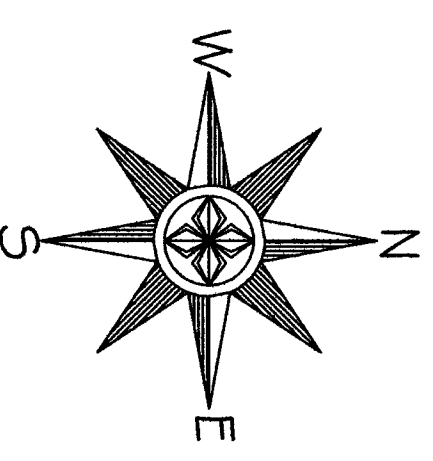

SURVEYORS CERTIFICATE

THIS MAP CORRECTLY REPRESENTS A SURVEY MADE
 UNDER MY DIRECTION IN CONFORMANCE WITH THE
 REQUIREMENTS OF THE SURVEY RECORDING ACT AT
 THE REQUEST OF GOODYEAR NELSON.

FREDERIC P. PETERSEN CERT. # 26303
 12/29/17



AUDITORS CERTIFICATE

FILED FOR THE RECORD THIS 29 DAY OF
 DEC. 2017 AT 12:29 PM IN BOOK
 OF SURVEYS ON PAGE 117
 REQUEST OF FREDERIC PETERSEN, S.S.
 COUNTY AUDITOR

AUDITORS FILE NO.: 201712290043

SURVEY IN U.S. GOVERNMENT LOT 1
 AND THE SE 1/4 OF THE NE 1/4
 OF SECTION 6, T34N., R5E., W.M.

- LEGEND:**
- ✚ DENOTES ACCEPTED GLO CONTROLLING CORNER POSITION.
 - DENOTES 5/8" REBARCAP, L526303 SET BY THIS SURVEY.
 - DENOTES PROPERTY LINE MARKED AND BLAZED.

PETERSEN LAND SURVEYING

14724 CHANDEL DRIVE
 LA CONNER, WA, 98257
 PHONE: 360-333-9493

SCALE 1" = 300'
 DRAWN BY: F.P.
 SURVEY BY: F.P., C.K.
 DATE: 11/24/2017
 SHEET 1 OF 1