



201711170078

Skagit County Auditor
11/17/2017 Page

1 of

\$75.00
2 12:27PM

Return to:

Skagit County
Planning & Development Services
1600 Continental Place
Mount Vernon, WA 98273-5625

PROTECTED CRITICAL AREA SITE PLAN

Page 1 of 2

Grantor/Owner: Cynthia Camlin/Douglas Loewen

Grantee: PUBLIC

Site Address: 22556 Franklin RoadProperty ID #: P17467 & P17433Legal Description: Sec. 29 Twp. 33 Rng. 04 Plat Name: --Permit/Activity #: PL17-0450

The PROTECTED CRITICAL AREA (PCA) is to be left undisturbed in its natural state. "With the exception of activities identified as Allowed without Standard review under SCC 14.24.070, any land-use activity that can impair the functions and values of critical areas or their buffers through a development activity or by disturbance of the soil or water, and/or by removal of, or damage to, existing vegetation shall require critical areas review and written authorization pursuant to SCC 14.24." SCC 14.24.060

No clearing, grading, filling, logging or removal of woody material, building, construction or road construction of any kind, planting of non-native vegetation or grazing of livestock is allowed within the PCA areas except as specifically permitted by Skagit County on a case-by-case basis consistent with SCC 14.24.

Representations on this site plan may be approximations only and should not be used for purposes other than for determining general locations of critical areas. Development activities beyond the scope of this plan may require additional studies and approvals.

The above references to "Grantor" and "Grantee" shall not be construed as a transfer of property ownership and are used solely for filing with the County Auditor.

Owner: [Signature] Date: 11/17/17

On this day personally appeared before me Cynthia Camlin, to me known to be the individual(s) described in and who executed the within and foregoing instrument, and acknowledged that he/she/they signed the same as his/her/their free and voluntary act and deed, for the uses and purposes therein mentioned.

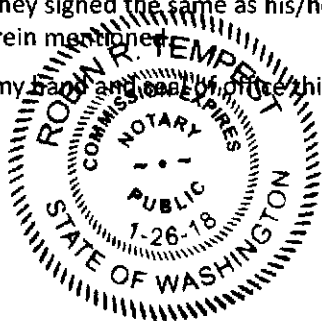
Given under my hand and seal of office this 17th day of November, 2017

[Signature]
Notary Public residing at Mount Vernon
My Commission Expires: 1-26-18

LOWEN-CAMLIN CRITICAL AREAS MAP
22556 FRANKLIN ROAD, MOUNT VERNON
PERMIT NO. PL17-0450

- See SCC 14.24.070(2)
- Ongoing commercial agricultural uses may continue in compliance with SCC 14.24.120

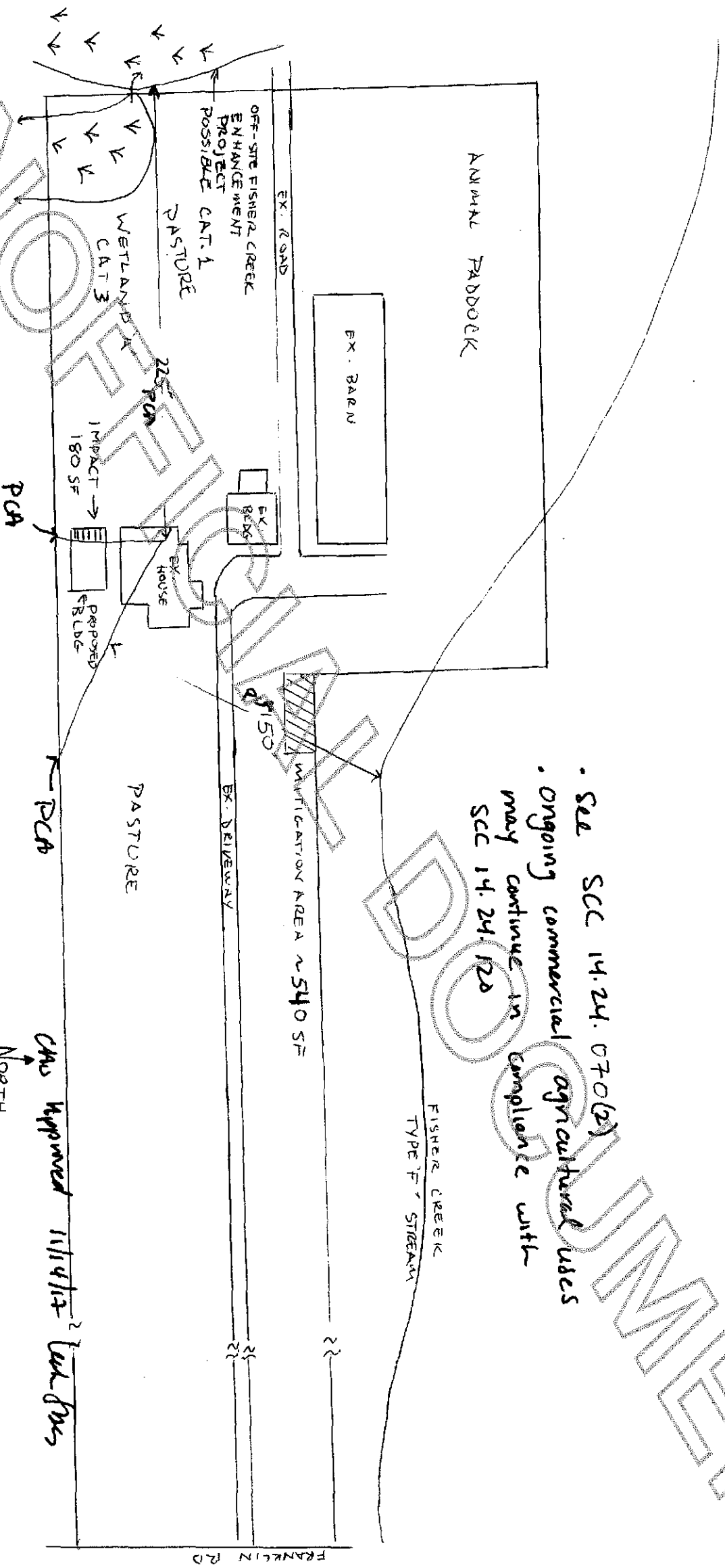

CHS approved 11/14/12
NORTH

SCALE:
0 50 100'