

AUDITOR'S CERTIFICATE

20170728 152
Skagit County Auditor
7/28/2017, Page 1 of 1 3:41PM \$158.00

AT THE REQUEST OF SEMRAU ENGINEERING & SURVEYING P.L.L.C.,

SKAGIT COUNTY AUDITOR

REPUTY

NOTES

- INDICATES SET 1/2"x18" REBAR WITH CAP - "SEMRAU 28626"
- INDICATES SET LEAD TACK & SHINER - "SEMRAU 28626"
- INDICATES EXISTING REBAR OR IRON PIPE FOUND AS DESCRIBED.
- INDICATES FOUND MONUMENT IN CASE AS DESCRIBED.
- THE DESCRIPTION FOR THIS SURVEY IS FROM STATUTORY WARRANTY DEED RECORDED UNDER AUDITOR'S FILE NO. 201412010114 DATED DECEMBER 1 2014.
- BASIS OF BEARING: EXISTING MONUMENTS FOUND IN THE CENTERLINE OF 6TH STREET BETWEEN AVENUE M AND AVENUE N, BEARING = SOUTH 89°56'33" EAST.
- ALL DISTANCES ARE SHOWN IN FEET.
- INSTRUMENTATION: LEICA M50 THEODOLITE DISTANCE METER.
- SURVEY PROCEDURE: STANDARD FIELD TRAVERSE.
- THIS SURVEY WAS REQUESTED BY MICHAEL HUBER.

8. THIS SURVEY MAY SHOW OCCUPATIONAL INDICATORS AS PER W.A.C. CHAPTER 332.130. LINES OF OCCUPATION MAY INDICATE AREAS FOR POTENTIAL CLAIMS OF UNWRITTEN OWNERSHIP. THIS BOUNDARY SURVEY HAS ONLY SHOWN THE RELATIONSHIP OF LINES OF OCCUPATION TO THE DEEDED LINES OF RECORD. NO RESOLUTION OF OWNERSHIP BASED ON UNWRITTEN RIGHTS HAS BEEN MADE OR IMPLIED BY THIS SURVEY.

9. EXCEPT AS SPECIFICALLY STATED OR SHOWN ON THIS SURVEY MAP, THIS SURVEY DOES NOT PURPORT TO REFLECT ALL OF THE FOLLOWING WHICH MAY BE APPLICABLE TO THE SUBJECT REAL ESTATE: EASEMENTS, BUILDING SETBACKS LINES, RESTRICTIVE COVENANTS, SUBDIVISION RESTRICTIONS, ZONING OR OTHER LAND-USE REGULATIONS AND ANY OTHER FACTS THAT AN ACCURATE AND CURRENT TITLE SEARCH MAY DISCLOSE.

DESCRIPTION

LOTS 4, 5, 6, AND THE EAST HALF OF LOT 7, BLOCK 74, MAP OF THE CITY OF ANACORTES, ACCORDING TO THE PLAT THEREOF, RECORDED IN VOLUME 2 OF PLATS, PAGE 4, RECORDS OF SKAGIT COUNTY, WASHINGTON.

SITUATED IN SKAGIT COUNTY, WASHINGTON

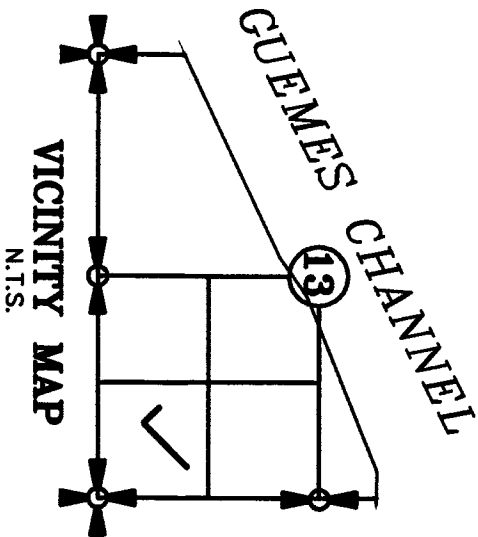

SHEET 1 OF 1

SURVEY OF LOTS 4, 5, 6, & E 1/2 LOT 7, BLOCK 74,
MAP OF CITY OF ANACORTES, SKAGIT COUNTY, WA
SE 1/4, SE 1/4, SECTION 13 T. 35 N., R. 1 E., W.M.
ANACORTES, WASHINGTON
FOR: MICHAEL HUBER

FB. 275 Pg. 57-X
MERIDIAN: ASSUMED
SEMRAU ENGINEERING & SURVEYING
SURVEYING • ENGINEERING • PLANNING
MOUNT VERNON, WA 98273 360-424-9566
SCALE: 1" = 40'
JOB NO. 5625

SURVEYOR'S CERTIFICATE

THIS MAP CORRECTLY REPRESENTS A SURVEY MADE BY ME OR UNDER MY DIRECTION IN CONFORMANCE WITH THE REQUIREMENTS OF THE SURVEY RECORDING ACT AT THE REQUEST OF MICHAEL HUBER.

JOHN B. SEMRAU, P.E., P.L.S., CERTIFICATE NO. 28626
SEMRAU ENGINEERING & SURVEYING, P.L.L.C.
2118 RIVERSIDE DRIVE SUITE 208
MOUNT VERNON, WA 98273
PHONE 360-424-9566

DATE: 7-28-17

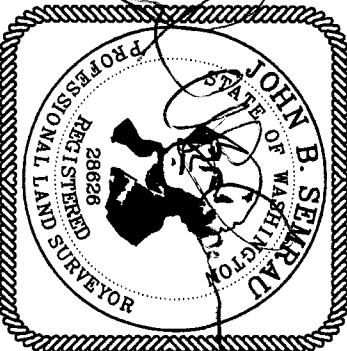

7-28-17