



201702100104

Skagit County Auditor

\$82.00

2/10/2017 Page

1 of 10 2:48PM

Return to:

David D. Lowell
P.O. Box 1346
Burlington, WA 98233

DOCUMENT TITLE: Quit Claim Deed for Boundary Line Adjustment

GRANTORS: Danno L. and Rebecca A. White

GRANTEES: Danno L. and Rebecca A. White

ABBREVIATED LEGAL DESCRIPTION: Ptn SE¼ of Section 17, Twp. 35N, Rng. 05E, W.M.

ASSESSOR'S PARCELS/TAX ID NUMBERS: P39271, P39275, and P39279

SKAGIT COUNTY WASHINGTON
REAL ESTATE EXCISE TAX

2017557

FEB 10 2017

Amount Paid \$ ~~0~~
Skagit Co. Treasurer
By *VF* Deputy

When Recorded Return to:
David D. Lowell
P.O. Box 1346
Burlington, WA 98233

QUIT CLAIM DEED *for*
(BOUNDARY LINE ADJUSTMENT)

GRANTORS: Danno L. and Rebecca A. White

GRANTEES: Danno L. and Rebecca A. White

ABBREVIATED LEGAL DESCRIPTION: Ptn SE¼ of Section 17, Twp. 35N, Rng. 05E, W.M.

ASSESSOR'S PARCELS/TAX ID NUMBERS: P39271, P39275, and P39279

THIS INDENTURE, is made this 3rd day of February, 2017, by Danno L. and Rebecca A. White (husband and Wife) who are both the Grantors and the Grantees between two lots of record for this Boundary Line Adjustment.

RECITALS:

- A. The Grantors Danno L. and Rebecca A. White are the owners of property bearing Skagit County Assessor's Parcel numbers: P39271 and P39275 that is more particularly described in the attached **Exhibit A**.
- B. The Grantees Danno L. and Rebecca A. White are also the owners of property bearing Skagit County Assessor's Parcel number: P39279; with a street address of 25875 Minkler Road, that is more particularly described in the attached **Exhibit B**.
- C. The parties wish to adjust the boundaries between the above described properties, with a portion of the Grantor's property being incorporated into the Grantees' property, as described in the attached **Exhibit C**.
- D. The descriptions of the new boundaries of the properties, as the result of this boundary line adjustment, are set forth in the attached **Exhibits D and E**.

E. An exhibit map showing the adjusted boundaries of all of the properties is attached as **Exhibit F.**

CONVEYANCE:

THEREFORE, for and in consideration of said boundary line adjustment, and for no monetary consideration, the Grantors do hereby **QUIT CLAIM** to the Grantees all of their interest in the real property lying and being in the County of Skagit and State of Washington, and described in the attached **Exhibit C**; with said property being combined or aggregated with the contiguous property owned by the Grantees.

This Boundary Line Adjustment is not for the purposes of creating an additional building lot.

This Boundary Line Adjustment is approved by Grace Roeder of the Skagit County Planning and Development Services Department, on this 8 day of Feb. 2017.

Grace Roeder (Skagit County Signature)

Dated this 8th day of Feb. 2017

Danno L. White
Danno L. White

Rebecca A. White
Rebecca A. White

STATE OF WASHINGTON }

ss.

COUNTY OF SKAGIT }

I certify that I know or have satisfactory evidence that Danno L White & Rebecca A White are the persons who signed this instrument, and said persons acknowledged that they signed this instrument and acknowledged it to be their free and voluntary act for the uses and purposes mentioned in the instrument.

NOTARY PUBLIC IN AND FOR THE STATE OF WASHINGTON

My appointment expires 11/1/19

Given under my hand and official seal this 3 day of February, 2017.

(SEAL)

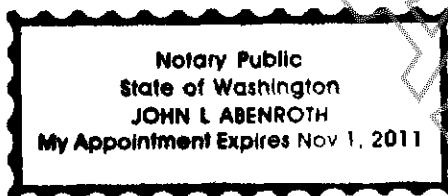

[Signature]
Notary Public

Residing at

Burlington

My appointment expires

11/1/19

Skagit Surveyors and Engineers

806 Metcalf St. Sedro-Woolley, WA 98284

360.855.2121 360.855.1658(f)

www.sseconsultants.com

LEGAL DESCRIPTION
FOR
DANNO AND BECKY WHITE
OF
P39271 and P39275
BEFORE BOUNDARY LINE ADJUSTMENT

January 10, 2017

The east half of the northeast quarter of the southeast quarter of Section 17, Township 35 North, Range 5 East, W.M.

TOGETHER WITH that portion of the east half of the southeast quarter of the southeast quarter of Section 17, Township 35 North, Range 5 East, W.M. lying north of Minkler Road.

Containing approximately 25 acres.

Situate in Skagit County, Washington.



1/10/17

Skagit Surveyors and Engineers

806 Metcalf St. Sedro-Woolley, WA 98284
360.855.2121 360.855.1658(f)
www.sseconsultants.com

LEGAL DESCRIPTION
FOR
DANNO AND BECKY WHITE
OF
P39279

BEFORE BOUNDARY LINE ADJUSTMENT

January 10, 2017

The west half of the southeast quarter of the southeast quarter of Section 17, Township 35 North, Range 5 East, W.M. lying north of Minkler Road.

EXCEPT the west 277.3 feet thereof.

Containing approximately 5.5 acres.

Situate in Skagit County, Washington.

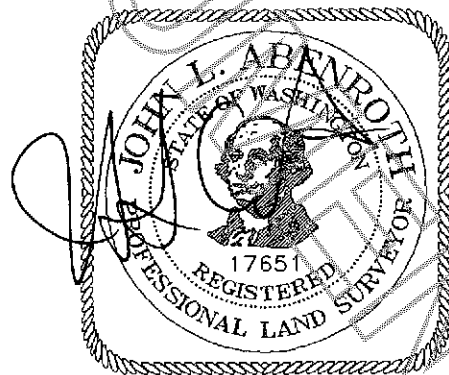

1/10/17

Skagit Surveyors and Engineers

806 Metcalf St. Sedro-Woolley, WA 98284
360.855.2121 360.855.1658(f)
www.sseconsultants.com

LEGAL DESCRIPTION
FOR
DANNO AND BECKY WHITE
OF PARCEL TO BE CONVEYED TO P39279

January 10, 2017

That portion of the east half of the southeast quarter of the southeast quarter of Section 17, Township 35 North, Range 5 East, W.M., described as follows:

Beginning at a point on the west line of said subdivision which lies S 1°41'02"E, a distance of 268.57 feet from the northwest corner thereof; thence S 62°06'19"E, a distance of 195.60 feet to the northerly line of Minkler Road; thence S 52°14'33"W along said northerly line, a distance of 210.46 feet to the west line of said subdivision; thence N 1°41'02"W, a distance of 220.48 feet to the point of beginning.

Containing approximately .4 acres.

Situate in Skagit County, Washington.

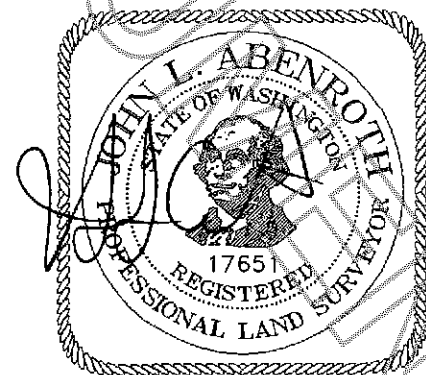

1/10/17

Skagit Surveyors and Engineers

806 Metcalf St. Sedro-Woolley, WA 98284

360.855.2121 360.855.1658(f)

www.sseconsultants.com

LEGAL DESCRIPTION
FOR
DANNO AND BECKY WHITE
OF
P39271 and P39275
AFTER BOUNDARY LINE ADJUSTMENT

January 10, 2017

The east half of the northeast quarter of the southeast quarter of Section 17, Township 35 North, Range 5 East, W.M.

TOGETHER WITH that portion of the east half of the southeast quarter of the southeast quarter of Section 17, Township 35 North, Range 5 East, W.M. lying north of Minkler Road.

EXCEPT that portion of the east half of the southeast quarter of the southeast quarter of Section 17, Township 35 North, Range 5 East, W.M., described as follows:

Beginning at a point on the west line of said subdivision which lies S 1°41'02"E, a distance of 268.57 feet from the northwest corner thereof; thence S 62°06'19"E, a distance of 195.60 feet to the northerly line of Minkler Road; thence S 52°14'33"W along said northerly line, a distance of 210.46 feet to the west line of said subdivision; thence N 1°41'02"W, a distance of 220.48 feet to the point of beginning.

Containing approximately 24.5 acres.

Situate in Skagit County, Washington.

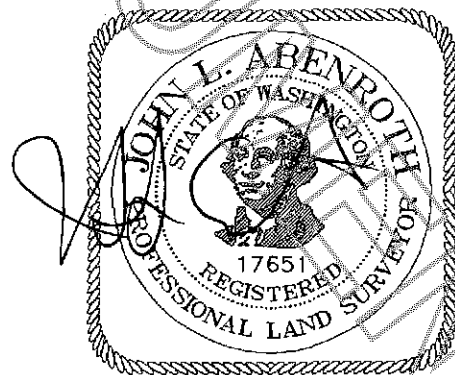

1/10/17

Skagit Surveyors and Engineers

806 Metcalf St. Sedro-Woolley, WA 98284
360.855.2121 360.855.1658(f)
www.sseconsultants.com

LEGAL DESCRIPTION
FOR
DANNO AND BECKY WHITE
OF
P39279

AFTER BOUNDARY LINE ADJUSTMENT

January 10, 2017

The west half of the southeast quarter of the southeast quarter of Section 17, Township 35 North, Range 5 East, W.M. lying north of Minkler Road.

TOGETHER WITH that portion of the east half of the southeast quarter of the southeast quarter of Section 17, Township 35 North, Range 5 East, W.M., described as follows:

Beginning at a point on the west line of said subdivision which lies S 1°41'02"E, a distance of 268.57 feet from the northwest corner thereof; thence S 62°06'19"E, a distance of 195.60 feet to the northerly line of Minkler Road; thence S 52°14'33"W along said northerly line, a distance of 210.46 feet to the west line of said subdivision; thence N 1°41'02"W, a distance of 220.48 feet to the point of beginning.

EXCEPT the west 277.3 feet of the west half of the southeast quarter of the southeast quarter of Section 17, Township 35 North, Range 5 East, W.M. lying north of Minkler Road. thereof.

Containing approximately 6 acres.

Situate in Skagit County, Washington.

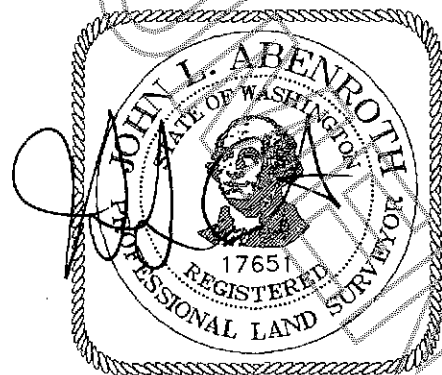

1/10/17

E1/2, SE1/4, Sec.17, Twp. 35 N., Rng. 5 E, W.M.

1701.6

P39271

Scale 1" = 250'

P39275

P39279

268.57'
S 01°41'02" E
220.48'

S 62°06'19" E
195.60'
210.46'
S 52°14'33" W

1701.6
201.27

SKAGIT SURVEYORS & ENGINEERS
806 METCALF ST.
SEDRO-WOOLLEY, WA 98284
(360) 855-2121

AFTER BOUNDARY LINE ADJUSTMENT
Exhibit Map
for
DANNO and BECKY WHITE

Exhibit F