

SURVEY IN THE SW 1/4 OF THE NE 1/4 OF SECTION 26, TOWNSHIP 36 NORTH, RANGE 1 EAST, W.M.

201611280163
\$157.00
11/28/2016 Page 1 of 1 11:21:19PM
Skagit County Auditor

QUARTER CORNER
FOUND 4"x4" CONCRETE
MONUMENT WITH "9622"
PLASTIC CAP WITH TACK
11/7/2016
ROS AFN 8209100028

FOUND POINT DESCRIPTIONS

- 1 FOUND 1/2" REBAR WITH "LEONARD 8992" CAP, HELD AS CENTER OF SECTION 26
- 2 FOUND 1/2" REBAR WITH SMASHED TILEGLOBE CAP LEAVING SOUTHWESTERLY S 0.94° W 2.43° OF SET CORNER, LIKELY DISPLACED
- 3 FOUND 1/2" REBAR WITH "EAB 18896" CAP S 0.06° W 1.73° OF SET CORNER
- 4 FOUND 5/8" REBAR WITH "LEGRO 375332" CAP N 0.02° E 0.28° OF CALCULATED POSITION, ACCEPTED AS CORNER AND HELD FOR LINE STAKING
- 5 FOUND 1/2" REBAR WITH "SKA SURV 17651" CAP S 0.17° E 0.14° OF CALCULATED POSITION, ACCEPTED
- 6 FOUND 5/8" REBAR WITH "LEGRO 375332" CAP S 0.08° W 0.33° OF CALCULATED POSITION, ACCEPTED AS CORNER AND HELD FOR LINE STAKING
- 7 FOUND 1/2" REBAR WITH "SKA SURV 17651" CAP E 0.11° OF CALCULATED LINE, ACCEPTED
- 8 FOUND 1/2" REBAR WITH "SKA SURV 17651" CAP E 0.17° OF CALCULATED LINE, ACCEPTED
- 9 FOUND 1/2" REBAR WITH "SKA SURV 17651" CAP E 0.09° OF CALCULATED LINE, ACCEPTED
- 10 FOUND 1/2" REBAR WITH "SKA SURV 17651" CAP E 0.16° OF CALCULATED LINE, ACCEPTED
- 11 FOUND 1/2" REBAR WITH "SKA SURV 17651" CAP N 0.11° E 0.07° OF CALCULATED POSITION, ACCEPTED
- 12 FOUND 1/2" REBAR WITH "EAB LS 18896" CAP WITH TACK S 1.04° W 0.63° OF CALCULATED POSITION
- 13 FOUND 3/4" INSIDE DIAMETER IRON PIPE WITH WOOD PLUD AND TACK S 1.37° W 0.88° OF CALCULATED POSITION
- 14 FOUND 1/2" REBAR WITH "SKA SURV 17651" CAP S 0.26° E 0.17° OF CALCULATED POSITION, ACCEPTED

LEGEND

- DENOTES 1/2" REBAR & "HAI 53688" CAP SEE THIS SURVEY
- DENOTES FOUND REBAR AND CAP AS DESCRIBED
- ⊙ DENOTES FOUND IRON PIPE AS DESCRIBED
- ⊙ DENOTES MEASURED BEARINGS AND DISTANCE
- (M) DENOTES CALCULATED BEARING AND DISTANCE
- (C) DENOTES CALCULATED BEARING AND DISTANCE
- (R1) DENOTES DISTANCE OF RECORD AS SHOWN ON THAT SURVEY RECORDED UNDER SKAGIT COUNTY AUDITOR'S FILE NO. 8209100028
- (SP1) DENOTES DISTANCE OF RECORD AS SHOWN ON THAT SHORT PLAT NO. 206707030062
- (SP2) DENOTES DISTANCE OF RECORD AS SHOWN ON SHORT PLAT NO. 42-85 RECORDED UNDER SKAGIT COUNTY AUDITOR'S FILE NO. 8512050001
- (SP3) DENOTES DISTANCE OF RECORD AS SHOWN ON SHORT PLAT NO. SP1-92-040 RECORDED UNDER SKAGIT COUNTY AUDITOR'S FILE NO. 9212210075
- AFN REFERENCE TO SKAGIT COUNTY AUDITOR'S FILE NUMBER
- ROS REFERENCE TO SKAGIT COUNTY RECORD OF SURVEY

LEGAL DESCRIPTION

THE NORTH 1/2 OF THE EAST 1/2 OF THE SOUTHWEST 1/4 OF THE NORTHEAST 1/4 OF SECTION 26, TOWNSHIP 36 NORTH, RANGE 1 EAST, W.M., TOGETHER WITH THE THREE NON-EXCLUSIVE EASEMENTS FOR INGRESS, EGRESS AND UTILITIES OVER AND ACROSS THE FOLLOWING DESCRIBED TRACTS OF LAND:

PARCEL "A"

THE EAST 40 FEET THE WEST 1/2 OF THE NORTH 1/2 OF THE NORTHEAST 1/4 QUARTER OF THE SOUTHEAST 1/4 OF SECTION 26, TOWNSHIP 36 NORTH, RANGE 1 EAST, W.M., EXCEPT THAT PORTION THEREOF CONVEYED TO SKAGIT COUNTY FOR ROAD PURPOSES BY DEED RECORDED NOVEMBER 24, 1937 UNDER AUDITOR'S FILE NO. 296846, RECORDS OF SKAGIT COUNTY, WASHINGTON.

PARCEL "B"

THE EAST 20 FEET THE WEST 1/2 OF THE SOUTHWEST 1/4 OF THE NORTHEAST 1/4 OF SAID SECTION 26 AS ESTABLISHED BY EASEMENT AND AGREEMENT DATED JUNE 19, 1985 AND RECORDED UNDER AUDITOR'S FILE NO. 9207280106, RECORDS OF SKAGIT COUNTY, WASHINGTON.

PARCEL "C"

THE WEST 20 FEET THE SOUTH 1/2 OF THE EAST 1/2 OF THE SOUTHWEST 1/4 OF THE NORTHEAST 1/4 OF SAID SECTION 26 AS ESTABLISHED BY EASEMENT AND AGREEMENT DATED JUNE 19, 1985 AND RECORDED UNDER AUDITOR'S FILE NO. 9207280106, RECORDS OF SKAGIT COUNTY, WASHINGTON.

SITUATE IN THE COUNTY OF SKAGIT, STATE OF WASHINGTON.

SURVEYOR'S CERTIFICATE

THIS MAP CORRECTLY REPRESENTS A SURVEY MADE BY ME OR UNDER MY DIRECTION IN CONFORMANCE WITH THE REQUIREMENTS OF THE WASHINGTON STATE SURVEY RECORDING ACT AT THE REQUEST OF MARK D. LINNEMANN IN NOVEMBER, 2016.

JAMES A. HILDEBRAND, PLS. CREDS
CERTIFICATE NO. 53688



AUDITOR'S CERTIFICATE

FILED FOR RECORD AT THE REQUEST OF HARMSEN & ASSOCIATES, INC.
SKAGIT COUNTY AUDITOR
BY DEPUTY
201611280163

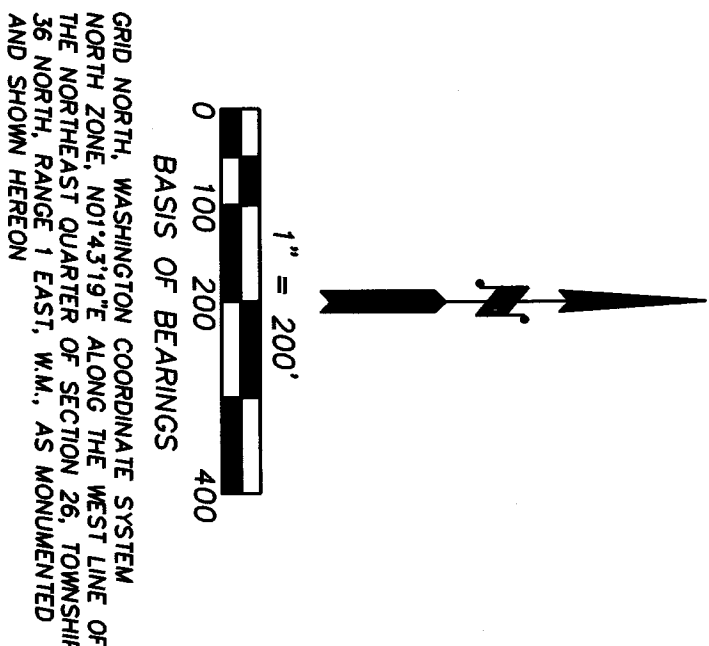

SURVEY NOTES

1. SURVEY PROCEDURES & EQUIPMENT:
EQUIPMENT: LEICA SYSTEM 1200 GPS SMARTROVER
LEICA 1203+ 3-SECOND ELECTRONIC DIGITAL TOTAL STATION
PROCEDURE: DUAL FREQUENCY GLOBAL POSITIONING SYSTEM (GPS) DATA CORRECTED WITH THE WASHINGTON STATE REFERENCE NETWORK (WSRN) AND FIELD TRAVERSE USING EXISTING MONUMENTATION; ALL CONTROL TRAVERSE ANGLES AND DISTANCES DOUBLE MEASURED; MEETS OR EXCEEDS THE STANDARDS CONTAINED IN WAC 322-130-090.
2. DISTANCES ARE IN US SURVEY FEET AND DECIMALS THEREOF.
3. ALL CONTROLLING MONUMENTS SHOWN ARE OF RECORD, ARE LOCALLY ACCEPTED AS REPRESENTATIVE OF THEIR PURPORTED POSITIONS, AND WERE VISITED DURING THE COURSE OF THIS SURVEY UNLESS OTHERWISE NOTED.
4. THE LEGAL DESCRIPTION RECITED HEREON WAS PROVIDED BY THAT STATUTORY WARRANTY DEED RECORDED UNDER SKAGIT COUNTY AUDITOR'S FILE NO. 201310310105.
5. THIS SURVEY DOES NOT PURPORT TO SHOW ALL EASEMENTS OR ENCUMBRANCES OF RECORD.
6. IN THE INTEREST OF CONSISTENCY WITH LOCAL SURVEYS OF RECORD, THIS SURVEY ACCEPTS AND UTILIZES THE SECTION SUBDIVISION AS SHOWN ON THAT SURVEY RECORDED UNDER SKAGIT COUNTY AUDITOR'S FILE NO. 8209100028.

MARK D. LINNEMANN

RECORD OF SURVEY

SCALE: 1" = 200'	SHEET: 1 OF 1
DRAWN BY: JAH	S.T.R. INDEX: 26-36N-1E
DATE: 11/18/16	SW 1/4 NE 1/4
REVISED N/A	
F/B: 110	
JOB#: 16-259	
HARMSEN & ASSOCIATES, INC. 603 SOUTH FIRST STREET MOUNT VERNON, WA 98273 TEL: (360) 336-9189	

