

AUDITOR'S CERTIFICATE



201603230101
Skagit County Auditor
4/21/2016 Page 1 of 1 \$157.00
4:14PM

AT THE REQUEST OF SEMRAU ENGINEERING & SURVEYING P.L.L.C.

SKAGIT COUNTY AUDITOR

DEPUTY

LEGAL DESCRIPTION

LOT 80, BLOCK 1, LAKE CAVANAUGH SUBDIVISION, DIVISION NO. 3, ACCORDING TO THE PLAT THEREOF, RECORDED IN VOLUME 6 OF PLATS, PAGES 25 TO 31, INCLUSIVE, RECORDS OF SKAGIT COUNTY, WASHINGTON.

TOGETHER WITH S.08RELANDS OF THE SECOND CLASS SITUATED IN FRONT OF, ADJACENT TO, OR ABUTTING UPON LOT 80, BLOCK 1, LAKE CAVANAUGH SUBDIVISION, DIVISION NO. 3, ACCORDING TO THE PLAT THEREOF, RECORDED IN VOLUME 6 OF PLATS, PAGES 25 TO 31, INCLUSIVE, RECORDS OF SKAGIT COUNTY, WASHINGTON.

SITUATE IN SKAGIT COUNTY, WASHINGTON.

NOTES

1. \bigcirc - INDICATES FOUND CORNER AS DESCRIBED
2. \oplus - INDICATES EXISTING CONCRETE MONUMENT FOUND.
3. THE DESCRIPTION FOR THIS SURVEY IS FROM DEED OF TRUST, RECORDED UNDER AUDITOR'S FILE NUMBER 200401290061, RECORDS OF SKAGIT COUNTY WASHINGTON.
4. BASIS OF BEARING: MERIDIAN IS AS SHOWN ON LAKE CAVANAUGH SUBDIVISION, DIVISION NO. 3, RECORDED IN VOLUME 6 OF PLATS, PAGES 25 TO 31, INCLUSIVE AND AUDITOR'S FILE NO. 420716.
5. ALL DISTANCES ARE SHOWN IN FEET.
6. INSTRUMENTATION: LEICA MS50 THEODOLITE DISTANCE METER.
7. SURVEY PROCEDURE: STANDARD FIELD TRAVERSE.
8. THIS SURVEY WAS REQUESTED BY MARIT AARYIK.
9. THIS SURVEY MAY SHOW OCCUPATIONAL INDICATORS AS PER W.A.C. CHAPTER 332.130. LINES OF OCCUPATION MAY INDICATE AREAS FOR POTENTIAL CLAIMS OF UNWRITTEN OWNERSHIP. THIS BOUNDARY SURVEY HAS ONLY SHOWN THE RELATIONSHIP OF LINES OF OCCUPATION TO THE DEEDED LINES OF RECORD. NO RESOLUTION OF OWNERSHIP BASED ON UNWRITTEN RIGHTS HAS BEEN MADE OR IMPLIED BY THIS SURVEY.
10. EXCEPT AS SPECIFICALLY STATED OR SHOWN ON THIS SURVEY MAP, THIS SURVEY DOES NOT PURPORT TO REFLECT ALL OF THE FOLLOWING WHICH MAY BE APPLICABLE TO THE SUBJECT REAL ESTATE: EASEMENTS, BUILDING SETBACKS, LINES, RESTRICTIVE COVENANTS, SUBDIVISION RESTRICTIONS, ZONING OR OTHER LAND-USE REGULATIONS AND ANY OTHER FACTS THAT AN ACCURATE AND CURRENT TITLE SEARCH MAY DISCLOSE.

SHEET 1 OF 1

SURVEYOR'S CERTIFICATE

THIS MAP CORRECTLY REPRESENTS A SURVEY MADE BY ME OR UNDER MY DIRECTION IN CONFORMANCE WITH THE REQUIREMENTS OF THE SURVEY RECORDING ACT AT THE REQUEST OF MARIT AARYIK.

JOHN B. SEMRAU, P.E., P.L.S. CERTIFICATE NO. 28626

DATE 4-21-16

SEMRAU ENGINEERING & SURVEYING, P.L.L.C.
2318 RIVERSIDE DRIVE SUITE 208
MOUNT VERNON, WA 98273 PHONE 360-424-9566

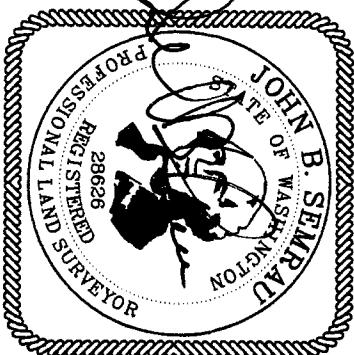

LAKE CAVANAUGH

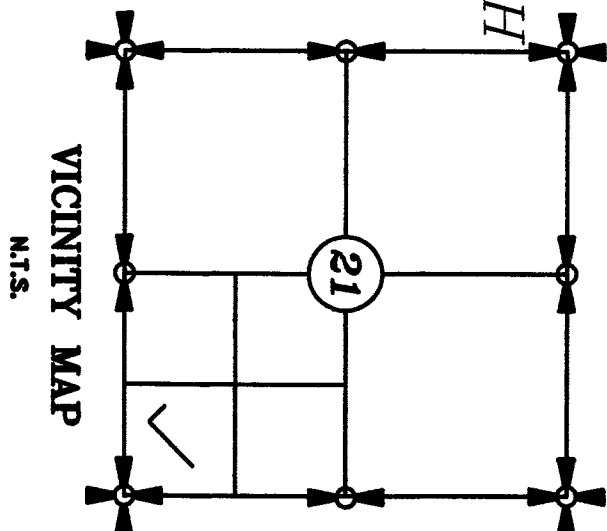

FB. 285 PG. 64		SEMRAU ENGINEERING & SURVEYING		SCALE: 1" = 40'	
MERIDIAN: NOTE 3		SURVEYING • ENGINEERING • PLANNING		JOB NO. 5419	
		MOUNT VERNON, WA 98273 360-424-9566			