

Return to:

Sandra L. Starbuck
PO Box 1107
Anacortes WA 98221



201508180056

Skagit County Auditor

\$73.00

8/18/2015 Page

1 of

2 3:46PM

PROTECTED CRITICAL AREA SITE PLAN

Page 1 of 2

Grantor/Owner: Marsha Kaye Mellana Estate.

Grantee: PUBLIC

Site Address: 11140 Happy Valley Road, Anacortes

Property ID #: P33253 & P33249 Assessors Tax Account #: 350231-0-003-0007 & 350231-0-001-0306

Legal Description: Sec. 31 Twp. 35 North Rng. 2 east, WM.

Permit/Activity #: PL15-0268

The PROTECTED CRITICAL AREA (PCA) is to be left undisturbed in its natural state. "With the exception of activities identified as Allowed without Standard review under SCC 14.24.070, any land-use activity that can impair the functions and values of critical areas or their buffers through a development activity or by disturbance of the soil or water, and/or by removal of, or damage to, existing vegetation shall require critical areas review and written authorization pursuant to SCC 14.24." SCC 14.24.060

No clearing, grading, filling, logging or removal of woody material, building, construction or road construction of any kind, planting of non-native vegetation or grazing of livestock is allowed within the PCA areas except as specifically permitted by Skagit County on a case-by-case basis consistent with SCC 14.24.

Representations on this site plan may be approximations only and should not be used for purposes other than for determining general locations of critical areas. Development activities beyond the scope of this plan may require additional studies and approvals.

The above references to "Grantor" and "Grantee" shall not be construed as a transfer of property ownership and are used solely for filing with the County Auditor.

Owner: Sandra L. Starbuck

Date: 8-10-15

On this day personally appeared before me Sandra L. Starbuck, to me known to be the individual(s) described in and who executed the within and foregoing instrument, and acknowledged that he/she/they signed the same as his/her/their free and voluntary act and deed, for the uses and purposes therein mentioned.

Given under my hand and seal of office this 10 day of August, 2015

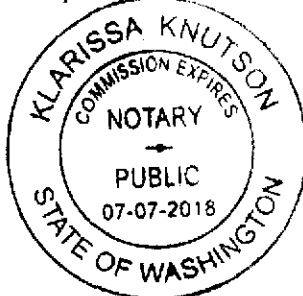

Klarissa Knutson
Notary Public residing at Mount Vernon

My Commission Expires: 7-7-18

Note: this is not a legal survey. We utilized a reduced copy of a recorded survey (AF201410300063), aerial photography and a fiberglass tape for on-site measurements to prepare this map.

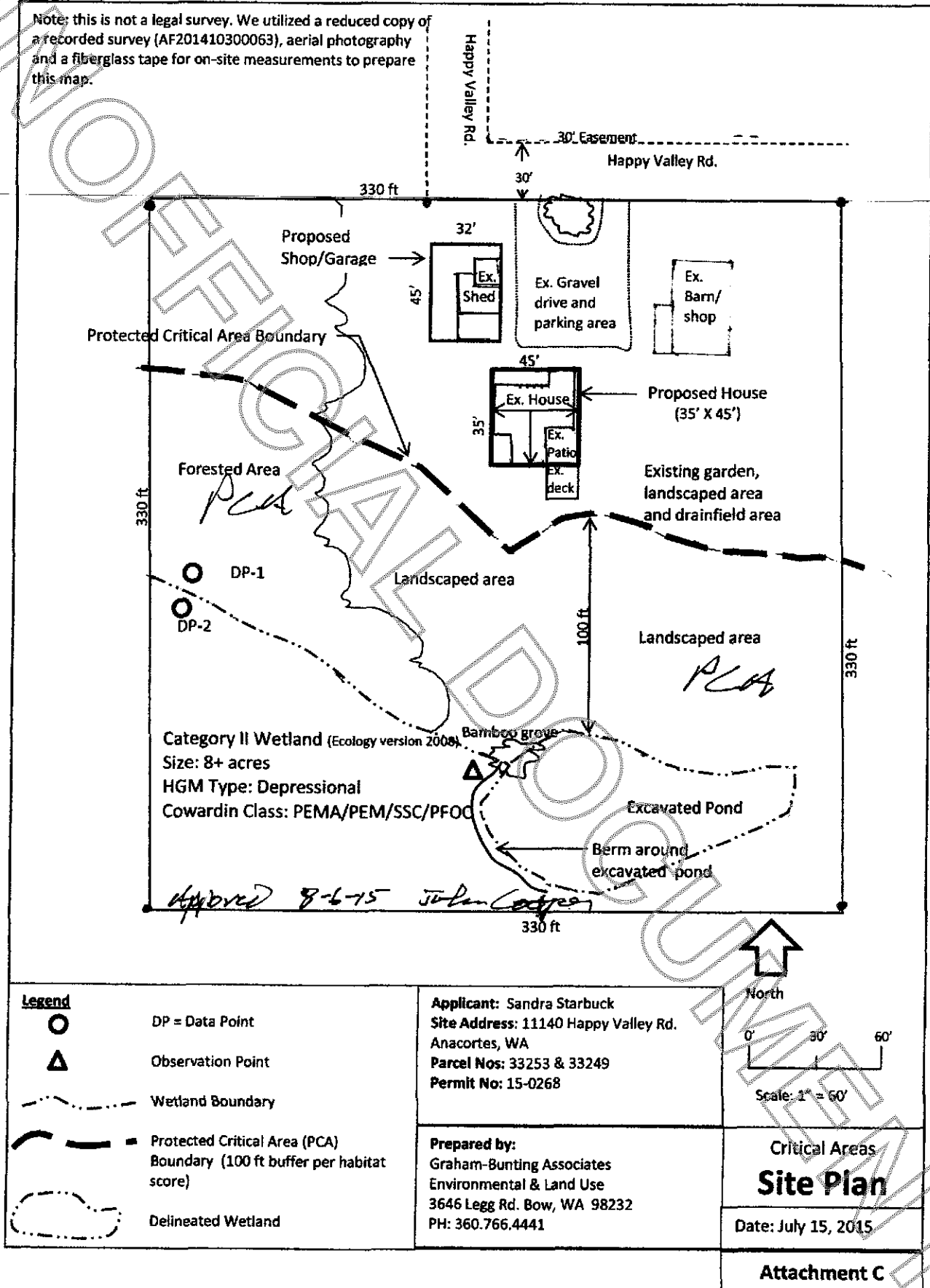

Legend



DP = Data Point



Observation Point



Wetland Boundary



Protected Critical Area (PCA) Boundary (100 ft buffer per habitat score)



Delineated Wetland

Applicant: Sandra Starbuck
Site Address: 11140 Happy Valley Rd.
 Anacortes, WA
Parcel Nos: 33253 & 33249
Permit No: 15-0268

Prepared by:
 Graham-Bunting Associates
 Environmental & Land Use
 3646 Legg Rd. Bow, WA 98232
 PH: 360.766.4441

North



Scale: 1" = 60'

**Critical Areas
 Site Plan**

Date: July 15, 2015

Attachment C