

SURVEY IN GOVERNMENT LOT 1 OF SECTION 35, TOWNSHIP 36 NORTH, RANGE 1 EAST, W.M.



Skagit County Auditor
4/30/2015 Page 1 of 1 1:12:45PM

AUDITOR'S CERTIFICATE

FILED FOR RECORD AT THE REQUEST OF HARMSEN & ASSOCIATES, INC.

Skagit County Auditor
BY DEPUTY

SECTION CORNER
FOUND 4"x4" CONCRETE
MONUMENT WITH 2" BRASS DISK
WITH PUNCH MARK STAMPED:
"R-1, 8992 SECTION CORNER-
1/29/2015 ROS AFN 867414

QUARTER CORNER
FOUND 4"x4" CONCRETE MONUMENT WITH
2" BRASS DISK WITH PUNCH MARK
STAMPED: "1/4 CORNER, 25/28"
ACCEPTED AS CORNER. CALCULATED
POSITION BASED ON TIES TO PLAT OF
POTLACH BEACH DIVISION NO. 2
MONUMENTATION IS N 1.33° E 0.18° OF
MONUMENT POSITION (SEE NOTE 6)

FOUND 3"x3"
CONCRETE MONUMENT
WITH 1/2" DIAMETER
IRON PIPE IN CASING
N 0.88° OF HEID LINE
PLAT AFN 758305

FOUND 3/4" INSIDE
DIAMETER IRON PIPE
WITH CEDAR PLUG
AND TACK N 0.32°
OF HEID LINE
PLAT AFN 406855

MEANDER CORNER
FOUND 3/4" INSIDE
DIAMETER OPEN IRON
PIPE, HEID 2/03/2015
PLAT AFN 406855
ROS AFN 200106260092

S 89° 54' 45" E ALONG THE SOUTH LINE OF
GOVERNMENT LOT 1 OF SECTION 35, AS MONUMENTED
AND SHOWN HEREON, AND BY THAT SURVEY RECORDED
201005260088.

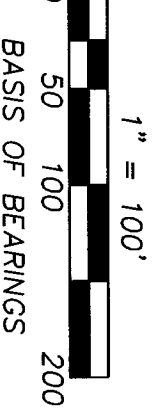

LEGEND

- DENOTES 1/2" REBAR & "H&A 27327" CAP SET THIS SURVEY
- DENOTES FOUND 1/2" REBAR & "MCLAUGHLIN 24223" CAP
- ⊙ DENOTES FOUND IRON PIPE AS DESCRIBED
- ⊗ DENOTES FOUND PLAT MONUMENT AS DESCRIBED
- (M) DENOTES MEASURED BEARING AND DISTANCE
- (C) DENOTES CALCULATED BEARING AND DISTANCE
- (P) DENOTES DISTANCE OR BEARING OF RECORD AS SHOWN ON THE PLAT OF POTLACH BEACH DIVISION NO. 2, RECORDED UNDER SKAGIT COUNTY AUDITOR'S FILE NO. 758305
- (R1) DENOTES DISTANCE OR BEARING OF RECORD AS SHOWN ON THAT SURVEY RECORDED UNDER SKAGIT COUNTY AUDITOR'S FILE NO. 201005260088
- (R2) DENOTES DISTANCE OF RECORD AS SHOWN ON THAT SURVEY RECORDED UNDER SKAGIT COUNTY AUDITOR'S FILE NO. 200106260092
- (R3) DENOTES DISTANCE OF RECORD AS SHOWN ON THAT SURVEY RECORDED UNDER SKAGIT COUNTY AUDITOR'S FILE NO. 8512050001
- AFN REFERENCE TO SKAGIT COUNTY AUDITOR'S FILE NUMBER
- ROS REFERENCE TO SKAGIT COUNTY RECORD OF SURVEY



SURVEY NOTES

- SURVEY PROCEDURES & EQUIPMENT:
EQUIPMENT: LEICA SYSTEM 1200 SMARTROVER
LEICA 1203+ 3-SECOND ELECTRONIC DIGITAL TOTAL STATION.
PROCEDURE: RAPID-STATIC DUAL FREQUENCY GLOBAL POSITIONING SYSTEM (GPS) DATA CORRECTED WITH THE NATIONAL GEODETIC SURVEY (NGS) ONLINE POSITIONING USER SERVICE (OPUS) AND FIELD TRAVERSE USING EXISTING MONUMENTATION. ALL CONTROL TRAVERSE ANGLES AND DISTANCES DOUBLE MEASURED. WEETS OR EXCEEDS THE STANDARDS CONTAINED IN WAC 322-150-090.
- DISTANCES ARE IN FEET AND DECIMALS THEREOF.
- ALL CONTROLLING MONUMENTS SHOWN ARE OF RECORD, ARE LOCALLY ACCEPTED AS REPRESENTATIVE OF THEIR PURPORTED POSITIONS, AND WERE VISITED DURING THE COURSE OF THIS SURVEY UNLESS OTHERWISE NOTED.
- THE LEGAL DESCRIPTION RECITED HEREON WAS PROVIDED BY THAT STATUTORY WARRANTY DEED RECORDED UNDER SKAGIT COUNTY AUDITOR'S FILE NO. 9712080089.
- THIS IS A SURVEY OF THE EAST LINE ONLY OF THE PARCEL DESCRIBED AND DEPICTED HEREON AND DOES NOT PURPORT TO SHOW ALL EASEMENTS OR ENCUMBRANCES OF RECORD.
- IN THE INTEREST OF CONSISTENCY WITH LOCAL SURVEYS OF RECORD, THIS SURVEY ACCEPTS THE MONUMENTED POSITION OF THE NORTH QUARTER CORNER OF SECTION 35 AND THE SOUTHEAST CORNER OF GOVERNMENT LOT 1, AS SHOWN HEREON, BY THE PLAT OF POTLACH BEACH DIVISION NO. 2, AND SURVEY'S RECORDED UNDER SKAGIT COUNTY AUDITOR'S FILE NOS. 8512050001, 921210075, 200106260092, AND 201005260088.

LEGAL DESCRIPTION

THAT PORTION OF GOVERNMENT LOT 1, SECTION 35, TOWNSHIP 36 NORTH, RANGE 1 EAST, W.M., LYING EASTERLY OF THE COUNTY ROAD.
EXCEPT THAT PORTION LYING WITHIN THE "PLAT OF POTLACH BEACH, DIVISION NO. 2", AS PER PLAT RECORDED IN VOLUME 10 OF PLATS, PAGES 8 AND 9, RECORDS OF SKAGIT COUNTY, WASHINGTON.
ALSO, EXCEPT THAT PORTION LYING NORTHERLY OF THE FOLLOWING DESCRIBED LINE:

BEGINNING AT THE SOUTHEAST CORNER OF LOT 17, "PLAT OF POTLACH BEACH, DIVISION NO. 2", AS PER PLAT RECORDED IN VOLUME 10 OF PLATS, PAGE 8, RECORDS OF SKAGIT COUNTY, WASHINGTON;
THENCE EAST TO A POINT ON THE EAST LINE OF SAID GOVERNMENT LOT 1 WHICH IS 85 FEET SOUTH OF A POINT ON SAID EAST LINE THAT IS EAST, PARALLEL WITH THE NORTH LINE OF SAID GOVERNMENT LOT 1, OF THE NORTHEAST CORNER OF SAID LOT 17 AND THE TERMINUS OF THIS LINE DESCRIPTION.

SITUATE IN THE COUNTY OF SKAGIT, STATE OF WASHINGTON.

SURVEYOR'S CERTIFICATE

THIS MAP CORRECTLY REPRESENTS A SURVEY MADE BY ME OR UNDER MY DIRECTION IN CONFORMANCE WITH THE REQUIREMENTS OF THE WASHINGTON STATE SURVEY RECORDING ACT AT THE REQUEST OF FRED R. AND SUSAN J. SIEVERS, IN FEBRUARY, 2015.

JAMES B. SMITH, PLUS Creds
CERIFICATE NO. 27327

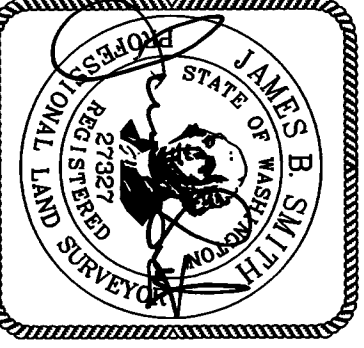

SOUTHEAST CORNER
GOVERNMENT LOT 1
ROS AFN 201005260088
(SEE NOTE 6)

217.79'

333.64'

187.10'

236.24'

179.70'

85.00'

80.26'

35

26

35

36

N00°00'28"W 1319.73'(M) 1320.76'(R1)(P)

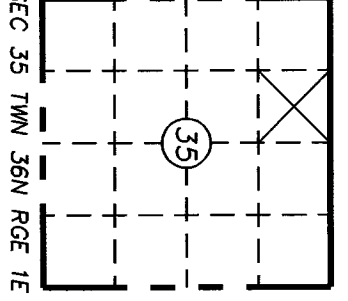

FRED R. & SUSAN J. SIEVERS

RECORD OF SURVEY

SCALE: 1" = 100'	SHEET: 1 OF 1
DRAWN BY: JAH	S.T.R. INDEX: 35-36N-1E
DATE: 2/10/15	CL 1
REVISED N/A	
F/B: 96 & 99	
JOBA: 14-068	
HARMSEN	
603 SOUTH FIRST STREET	
MOUNT VERNON, WA 98273	
TEL: (360) 336-9199	