



201504280026

Skagit County Auditor

\$80.00

4/28/2015 Page

1 of

9

9:23AM

AFTER RECORDING, RETURN TO:

Town of Concrete
45672 Main Street
PO Box 39
Concrete, WA 98237

DOCUMENT: Quit Claim Deed

GRANTOR: Marjorie Bell

GRANTEE: Marjorie Bell

ABBREVIATED LEGAL DESCRIPTION:

Portion of the SE ¼ of the NW ¼ Section 10, Township 35 N, Range 8 E, WM

ASSESSOR'S PARCEL / TAX ID NUMBERS:

P43707/350810-2-018-0005

P43708/350810-2-019-0004

P106620/4628-000-005-0100

SKAGIT COUNTY WASHINGTON
REAL ESTATE EXCISE TAX

2015/396

APR 28 2015

Amount Paid \$0

Skagit Co. Treasurer

By *mm* Deputy

**QUIT CLAIM DEED
(BOUNDARY LINE ADJUSTMENT)**

The grantor Marjorie Bell, is the owner of the following described property:

That portion of the Southeast $\frac{1}{4}$ of the Northwest $\frac{1}{4}$ of Section 10, Township 35, Range 8 East, W.M. described as follows:

Beginning at an iron pipe set as the Northeast corner of said Southeast $\frac{1}{4}$ of the Northwest $\frac{1}{4}$; thence South $1^{\circ}11'30''$ West along the East line of said Southeast $\frac{1}{4}$ of the Northwest $\frac{1}{4}$, a distance of 285.75 feet;

Thence North $89^{\circ}28'$ West 25 feet;

Thence South $1^{\circ}11'30''$ West 98.73 feet;

Thence South $78^{\circ}11'30''$ West 42.10 feet to the true point of beginning this description;

Thence from said point of beginning run South $1^{\circ}11'30''$ West 100 feet;

Thence South $78^{\circ}11'30''$ West 40.92 feet;

Thence North $1^{\circ}11'30''$ East 100 feet;

Thence North $78^{\circ}11'30''$ East to the point of beginning

(Said tract being sometimes known as Lot 19, Block 1 of the Unrecorded plat of Superior Addition, Division No. 1 to Concrete.)

Situated in the County of Skagit, State of Washington.

AND

PARCEL "A":

That portion of the Southeast $\frac{1}{4}$ of the Northwest $\frac{1}{4}$ of Section 10, Township 35, Range 8 East, W.M. described as follows:

Beginning at an iron pipe set as the Northeast corner of said Southeast $\frac{1}{4}$ of the Northwest $\frac{1}{4}$;

Thence South $1^{\circ}11'30''$ West along the East line of said Southeast $\frac{1}{4}$ of the Northwest $\frac{1}{4}$, 255.75 feet;

Thence North $89^{\circ}28'$ West, 25 feet;

Thence South $1^{\circ}11'30''$ West, 98.73 feet to the true point of beginning;

Thence from said point of beginning run South $78^{\circ}11'30''$ West, 42.10 feet;

Thence South $1^{\circ}11'30''$ West, 100 feet;

Thence North $78^{\circ}20'30''$ East, 40.92 feet

Thence North $1^{\circ}11'30''$ East, 100.23 feet to the point of beginning.

(Also known as Lot 20, Block 9 of the unrecorded Plat of Melville's Superior Addition, Division No. 1 to Concrete.)

Situated in the Town of Concrete, County of Skagit, State of Washington.

AND

PARCEL "B":

That portion of Tract 5 of "PLAT OF LONESTAR'S ADDITION TO THE CITY OF CONCRETE", as per plat recorded in volume 15 of Plats, pages 163 through 166, inclusive, records of Skagit County, Washington, described as follows:

Beginning at the Southeast corner of said Tract 5;

Thence North along the East line thereof 24.04 feet;

Thence West to the centerline of the existing creek;

Thence South along said centerline to the North line of Tract 6 of said plat;

Thence East along the South line of said Tract 5 to the Northeast corner of the aforementioned Tract 6;

Thence North 0°56'45" East 8.8 feet to a point lying South 77°56'45" West 67.63 feet from the point of beginning;
Thence North 77°56'45" East 67.63 feet to the true point of beginning.
Situated in the Town of Concrete, County of Skagit, State of Washington.

WHEREAS the grantor, Marjorie Bell, wishes to reconfigure the above described properties through a Boundary Line Adjustment:

NOW THEREFORE, the grantors, Marjorie Bell, for the purpose of aggregating contiguous property owned by the grantors, do hereby convey and QUIT CLAIM to Marjorie Bell the following described property together with all after-acquired title of the grantor therein:

That portion of the Southeast ¼ of the Northwest ¼ of Section 10, Township 35, Range 8 East, W.M. described as follows:

Beginning at an iron pipe set as the Northeast corner of said Southeast ¼ of the Northwest ¼; thence South 1°11'30" West along the East line of said Southeast ¼ of the Northwest ¼, a distance of 285.75 feet;

Thence North 89°28' West 25 feet;

Thence South 1°11'30" West 98.73 feet;

Thence South 78°11'30" West 42.10 feet to the true point of beginning this description;

Thence from said point of beginning run South 1°11'30" West 100 feet;

Thence South 78°11'30" West 40.92 feet;

Thence North 1°11'30" East 100 feet;

Thence North 78°11'30" East to the point of beginning

(Said tract being sometimes known as Lot 19, Block 1 of the Unrecorded plat of Superior Addition, Division No. 1 to Concrete.)

Situated in the County of Skagit, State of Washington.

TOGETHERWITH

PARCEL "A":

That portion of the Southeast ¼ of the Northwest ¼ of Section 10, Township 35, Range 8 East, W.M. described as follows:

Beginning at an iron pipe set as the Northeast corner of said Southeast ¼ of the Northwest ¼;

Thence South 1°11'30" West along the East line of said Southeast ¼ of the Northwest ¼, 255.75 feet;

Thence North 89°28' West, 25 feet;

Thence South 1°11'30" West, 98.73 feet to the true point of beginning;

Thence from said point of beginning run South 78°11'30" West, 42.10 feet;

Thence South 1°11'30" West, 100 feet;

Thence North 78°20'30" East, 40.92 feet

Thence North 1°11'30" East, 100.23 feet to the point of beginning.

(Also known as Lot 20, Block 9 of the unrecorded Plat of Melville's Superior Addition, Division No. 1 to Concrete.)

Situated in the Town of Concrete, County of Skagit, State of Washington.

PARCEL "B":

That portion of Tract 5 of "PLAT OF LONESTAR'S ADDITION TO THE CITY OF CONCRETE", as per plat recorded in volume 15 of Plats, pages 163 through 166, inclusive, records of Skagit County, Washington, described as follows:

Beginning at the Southeast corner of said Tract 5;

Thence North along the East line thereof 24.04 feet;
Thence West to the centerline of the existing creek;
Thence South along said centerline to the North line of Tract 6 of said plat;
Thence East along the South line of said Tract 5 to the Northeast corner of the
aforementioned Tract 6;
Thence North $0^{\circ}56'45''$ East 8.8 feet to a point lying South $77^{\circ}56'45''$ West 67.63 feet from
the point of beginning;
Thence North $77^{\circ}56'45''$ East 67.63 feet to the true point of beginning.
Situated in the Town of Concrete, County of Skagit, State of Washington.

This boundary adjustment is not for the purpose of creating an additional building lot.

This Boundary Line Adjustment is approved by the Town Planner of the Town of Concrete, on this
23 day of April, 2015.

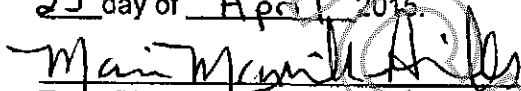

Town Planner.

LEGAL DESCRIPTIONS BEFORE BOUNDARY LINE ADJUSTMENT

Tax Parcel P43707

That portion of the Southeast $\frac{1}{4}$ of the Northwest $\frac{1}{4}$ of Section 10, Township 35, Range 8 East, W.M. described as follows:

Beginning at an iron pipe set as the Northeast corner of said Southeast $\frac{1}{4}$ of the Northwest $\frac{1}{4}$; thence South $1^{\circ}11'30''$ West along the East line of said Southeast $\frac{1}{4}$ of the Northwest $\frac{1}{4}$, a distance of 285.75 feet;

Thence North $89^{\circ}28'$ West 25 feet;

Thence South $1^{\circ}11'30''$ West 98.73 feet;

Thence South $78^{\circ}11'30''$ West 42.10 feet to the true point of beginning this description;

Thence from said point of beginning run South $1^{\circ}11'30''$ West 100 feet;

Thence South $78^{\circ}11'30''$ West 40.92 feet;

Thence North $1^{\circ}11'30''$ East 100 feet;

Thence North $78^{\circ}11'30''$ East to the point of beginning

(Said tract being sometimes known as Lot 19, Block 1 of the Unrecorded plat of Superior Addition, Division No. 1 to Concrete.)

Situated in the County of Skagit, State of Washington.

Tax Parcel P43708

PARCEL "A":

That portion of the Southeast $\frac{1}{4}$ of the Northwest $\frac{1}{4}$ of Section 10, Township 35, Range 8 East, W.M. described as follows:

Beginning at an iron pipe set as the Northeast corner of said Southeast $\frac{1}{4}$ of the Northwest $\frac{1}{4}$;

Thence South $1^{\circ}11'30''$ West along the East line of said Southeast $\frac{1}{4}$ of the Northwest $\frac{1}{4}$, 255.75 feet;

Thence North $89^{\circ}28'$ West, 25 feet;

Thence South $1^{\circ}11'30''$ West, 98.73 feet to the true point of beginning;

Thence from said point of beginning run South $78^{\circ}11'30''$ West, 42.10 feet;

Thence South $1^{\circ}11'30''$ West, 100 feet;

Thence North $78^{\circ}20'30''$ East, 40.92 feet

Thence North $1^{\circ}11'30''$ East, 100.23 feet to the point of beginning.

(Also known as Lot 20, Block 9 of the unrecorded Plat of Melville's Superior Addition, Division No. 1 to Concrete.)

Situated in the Town of Concrete, County of Skagit, State of Washington.

Tax Parcel P106620

PARCEL "B":

That portion of Tract 5 of "PLAT OF LONESTAR'S ADDITION TO THE CITY OF CONCRETE", as per plat recorded in volume 15 of Plats, pages 163 through 166, inclusive, records of Skagit County, Washington, described as follows:

Beginning at the Southeast corner of said Tract 5;

Thence North along the East line thereof 24.04 feet;

Thence West to the centerline of the existing creek;

Thence South along said centerline to the North line of Tract 6 of said plat;

Thence East along the South line of said Tract 5 to the Northeast corner of the aforementioned Tract 6;

Thence North $0^{\circ}56'45''$ East 8.8 feet to a point lying South $77^{\circ}56'45''$ West 67.63 feet from the point of beginning;

Thence North $77^{\circ}56'45''$ East 67.63 feet to the true point of beginning.

Situated in the Town of Concrete, County of Skagit, State of Washington.

LEGAL DESCRIPTION AFTER BOUNDARY LINE ADJUSTMENT

That portion of the Southeast $\frac{1}{4}$ of the Northwest $\frac{1}{4}$ of Section 10, Township 35, Range 8 East, W.M. described as follows:

Beginning at an iron pipe set as the Northeast corner of said Southeast $\frac{1}{4}$ of the Northwest $\frac{1}{4}$; thence South $1^{\circ}11'30''$ West along the East line of said Southeast $\frac{1}{4}$ of the Northwest $\frac{1}{4}$, a distance of 285.75 feet;

Thence North $89^{\circ}28'$ West 25 feet;

Thence South $1^{\circ}11'30''$ West 98.73 feet;

Thence South $78^{\circ}11'30''$ West 42.10 feet to the true point of beginning this description;

Thence from said point of beginning run South $1^{\circ}11'30''$ West 100 feet;

Thence South $78^{\circ}11'30''$ West 40.92 feet;

Thence North $1^{\circ}11'30''$ East 100 feet;

Thence North $78^{\circ}11'30''$ East to the point of beginning

(Said tract being sometimes known as Lot 19, Block 1 of the Unrecorded plat of Superior Addition, Division No. 1 to Concrete.)

Situated in the County of Skagit, State of Washington.

TOGETHERWITH

PARCEL "A":

That portion of the Southeast $\frac{1}{4}$ of the Northwest $\frac{1}{4}$ of Section 10, Township 35, Range 8 East, W.M. described as follows:

Beginning at an iron pipe set as the Northeast corner of said Southeast $\frac{1}{4}$ of the Northwest $\frac{1}{4}$;

Thence South $1^{\circ}11'30''$ West along the East line of said Southeast $\frac{1}{4}$ of the Northwest $\frac{1}{4}$, 255.75 feet;

Thence North $89^{\circ}28'$ West, 25 feet;

Thence South $1^{\circ}11'30''$ West, 98.73 feet to the true point of beginning;

Thence from said point of beginning run South $78^{\circ}11'30''$ West, 42.10 feet;

Thence South $1^{\circ}11'30''$ West, 100 feet;

Thence North $78^{\circ}20'30''$ East, 40.92 feet

Thence North $1^{\circ}11'30''$ East, 100.23 feet to the point of beginning.

(Also known as Lot 20, Block 9 of the unrecorded Plat of Melville's Superior Addition, Division No. 1 to Concrete.)

Situated in the Town of Concrete, County of Skagit, State of Washington.

PARCEL "B":

That portion of Tract 5 of "PLAT OF LONESTAR'S ADDITION TO THE CITY OF CONCRETE", as per plat recorded in volume 15 of Plats, pages 163 through 166, inclusive, records of Skagit County, Washington, described as follows:

Beginning at the Southeast corner of said Tract 5;

Thence North along the East line thereof 24.04 feet;

Thence West to the centerline of the existing creek;

Thence South along said centerline to the North line of Tract 6 of said plat;

Thence East along the South line of said Tract 5 to the Northeast corner of the aforementioned Tract 6;

Thence North $0^{\circ}56'45''$ East 8.8 feet to a point lying South $77^{\circ}56'45''$ West 67.63 feet from the point of beginning;

Thence North $77^{\circ}56'45''$ East 67.63 feet to the true point of beginning.

Situated in the Town of Concrete, County of Skagit, State of Washington.

Boundary Line Adjustment Maps

1" = 20'

Lot Configuration Before Boundary Line Adjustment:

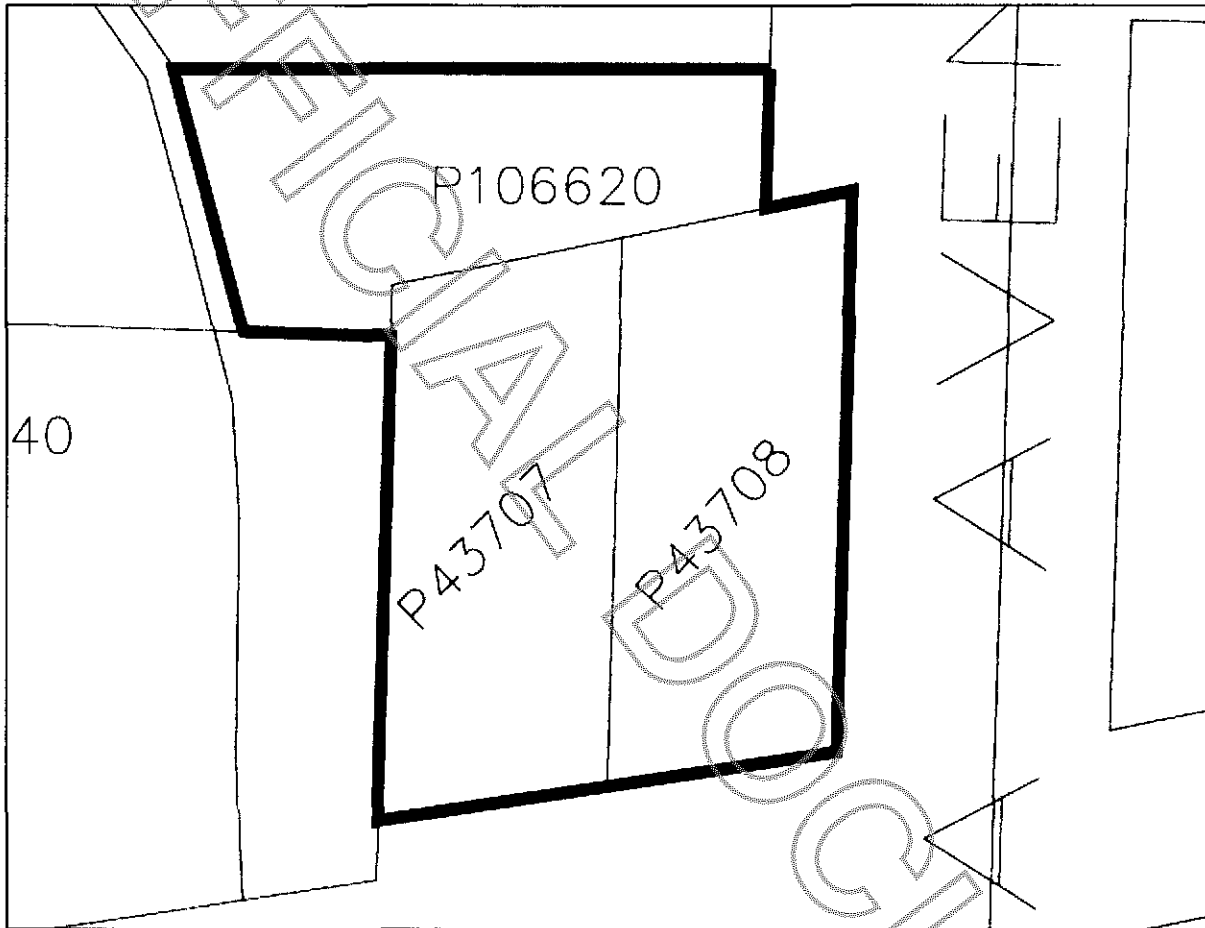

Lot Configuration After Boundary Line Adjustment:

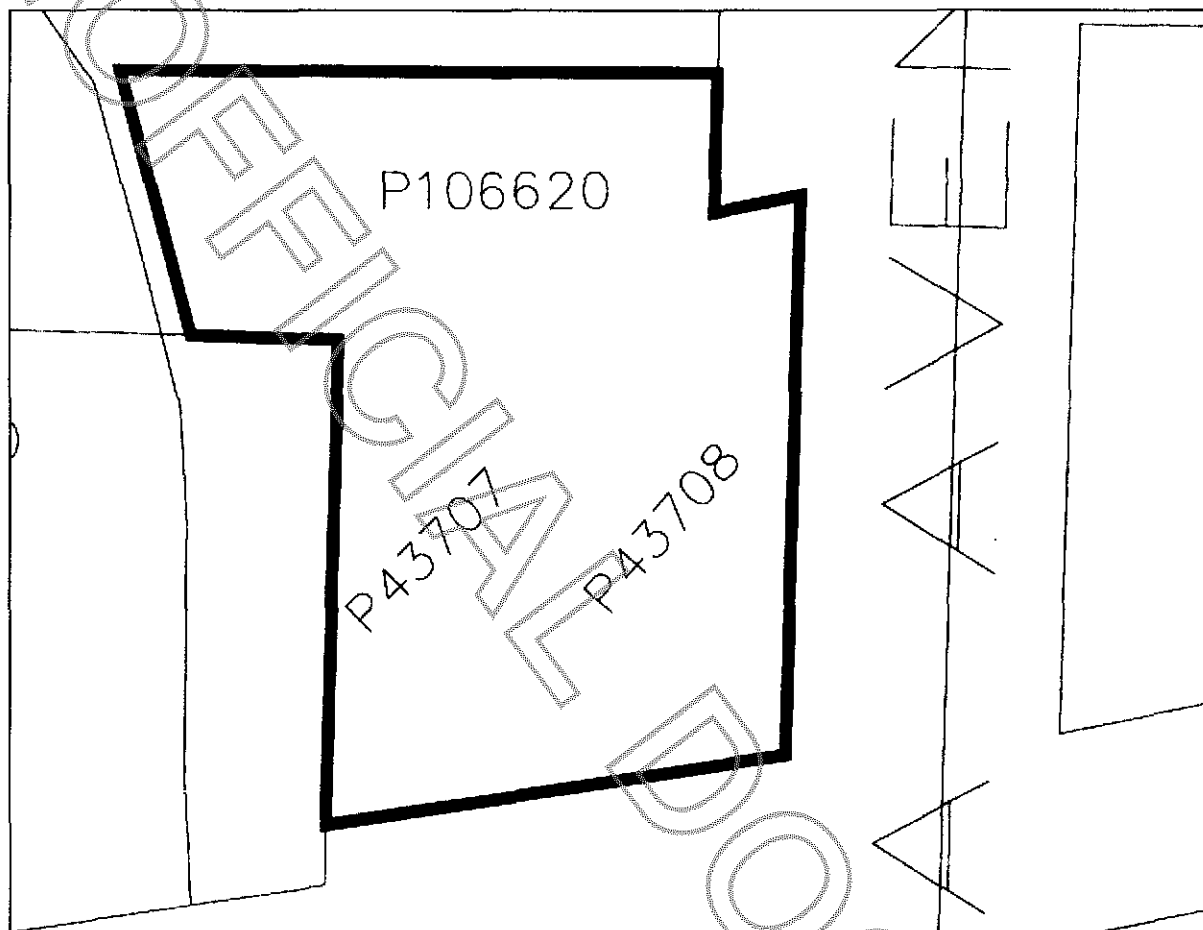

Marjorie Bell
Marjorie Bell

April 23, 2015
Dated

STATE OF WASHINGTON)
) ss
COUNTY OF SKAGIT)

I certify that I know or have satisfactory evidence that Marjorie Bell is the person who signed this instrument, and said person acknowledged that she signed this instrument, on oath stated that she was/were authorized to execute the instrument and acknowledged it as the Grantor to be the free and voluntary act of such party for the uses and purposes mentioned in the instrument.

Dated: 4/23/15

Signature: [Signature]

(print name) John L. Abenroth

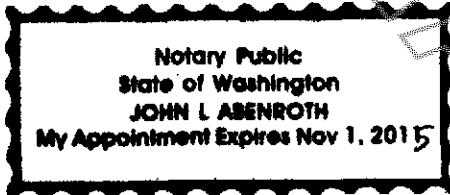

NOTARY PUBLIC IN AND FOR THE STATE OF Washington

My appointment expires 11/1/2015