

# THE RESERVE AT CHANNEL LANDING PH II

## LOT 7 & LOT 8

IN THE S.E. 1/4, SEC. 22, TWP 35 N., RNG 1 E., W.M.  
CITY OF ANACORTES, WASHINGTON

AUDITORS CERTIFICATE



Skagit County Auditor  
11/24/2014 Page 1 of 1 11:20:47 AM

AUDITOR  
DALE K. HERRIGSTAD  
DEPUTY AUDITOR

### NOTES

THE PURPOSE OF THIS RECORD OF SURVEY IS TO REVISE AN EASEMENT ACROSS LOT 7 FOR ACCESS AND UTILITIES TO LOT 8. THIS EASEMENT SUPERSEDES THE EASEMENT SHOWN ON "THE RESERVE AT CHANNEL LANDING PHASE II" RECORDED UNDER AUDITORS FILE NUMBER 201402200035.

1. EXISTING RE-BAR AND CAP PLS. #27817.
2. EXISTING BRASS CAP IN SIDEWALK MARKED PLS #9569.
3. EXISTING MONUMENT STAMPED LS #9569 W/ CASE & COVER.
4. EXISTING PK NAIL IN LARGE ROCK.
5. EQUIPMENT USED: CR 2 2" TOTAL STATION.
6. ALL EXISTING REBAR & CAPS AND CONCRETE MONUMENTS WERE VISITED ON 11-25-2014.
7. ERROR OF CLOSURE MEETS WASHINGTON STATE SURVEY STANDARDS.
8. SURVEY METHOD: STANDARD FIELD TRAVERSE.
9. BASIS OF BEARINGS: Record of Survey / Plat of San Juan Passage Phase I, Af 200811260099.

### LEGAL DESCRIPTIONS

LOT 7, "RESERVE AT CHANNEL LANDING PHASE II", RECORDED UNDER AF#201402200035 BEING A PORTION OF LOTS 8 AND 9, ANACORTES S/P SP-05-006 UNDER AF#201009210052, LOCATED IN THE SE 1/4 OF SECTION 22, TOWNSHIP 35 NORTH, RANGE 1 EAST, W.M.

LOT 8, "RESERVE AT CHANNEL LANDING PHASE II", RECORDED UNDER AF#201402200035 BEING A PORTION OF LOTS 8 AND 9, ANACORTES S/P SP-05-006 UNDER AF#201009210052, LOCATED IN THE SE 1/4 OF SECTION 22, TOWNSHIP 35 NORTH, RANGE 1 EAST, W.M.

### OWNERS CONSENT

CHANNEL LANDING LLC

State of Washington  
County of Skagit

I certify that I know of have satisfactory evidence that Nels Strandberg signed this instrument, on oath stated that (s/he/they) (was/are) authorized to execute the instrument and acknowledged it as the Member of CHANNEL LANDING LLC, to be the free and voluntary act of such party for the uses and purposes mentioned in the instrument.

Given under my hand and official seal this 20th day of November, 2014.

Notary Public in and for the State of Washington

Name printed Elvin Weliver

Residing at P.O. Box 931 Anacortes WA

My commissions expires 11/2018



### SURVEYOR'S CERTIFICATE

THIS MAP CORRECTLY REPRESENTS A SURVEY MADE BY ME OR UNDER MY DIRECTION IN CONFORMANCE WITH THE REQUIREMENTS OF THE SURVEY RECORDING ACT AT THE REQUEST OF DEBBIE HEADRICK IN NOVEMBER, 2014.

DALE K. HERRIGSTAD, P.L.S.

Certificate No. 27807

Date NOVEMBER 20, 2014

SHEET 1 OF 1

### RECORD OF SURVEY

Channel Landing LLC

PO Box 319

Anacortes, WA 98221

Owner:

A PORTION OF THE SE 1/4 OF SECTION 22, TOWNSHIP 35 N., RNG. 1 EAST, W.M. CITY OF ANACORTES, SKAGIT COUNTY, WASHINGTON

### HERRIGSTAD ENGINEERING & SURVEYING

4329 Whistle Lake Road, Anacortes, WA 98221 (360) 299-8804

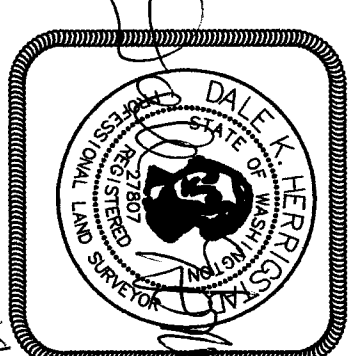

GRAPHIC SCALE

11-20-14



1 inch = 40 ft.

PROPERTY BOUNDARY LINE TABLE			
BEARING	DISTANCE		
L1 S30°20'4"W	35.05'		
L2 S30°20'4"W	41.77'		
L3 S30°20'4"W	16.55'		
L4 S30°20'4"W	22.20'		

ROAD CURVE & LINE TABLE			
LENGTH	RADIUS	DELTA	
⑤ 40.89'	51.00'	45°56'16"	
⑥ 30.26'	51.00'	33°59'44"	
⑦ 30.26'	51.00'	33°59'44"	
⑧ 30.26'	51.00'	33°59'44"	

EXIST. 20' PUBLIC UTILITY EASEMENT FOR STORM AND WATER MAIN DEDICATED IN SP-05-006, AF #201009210052.

20' ACCESS AND UTILITY EASEMENT TO LOTS 6 AND 7 IN THE SAME LOCATION AS EXISTING 20' PUBLIC UTILITY ESMT.

10' ACCESS & UTILITY ESMT. EXISTING 20' PUBLIC UTILITY EASEMENT

10' ACCESS & UTILITY ESMT. EXISTING 20' PUBLIC UTILITY EASEMENT

10' ACCESS AND UTILITY ESMT FOR LOT 8

10' ACCESS AND UTILITY ESMT FOR LOT 8

10' ACCESS AND UTILITY ESMT FOR LOT 8

10' ACCESS AND UTILITY ESMT FOR LOT 8

10' ACCESS AND UTILITY ESMT FOR LOT 8

10' ACCESS AND UTILITY ESMT FOR LOT 8

10' ACCESS AND UTILITY ESMT FOR LOT 8

10' ACCESS AND UTILITY ESMT FOR LOT 8

10' ACCESS AND UTILITY ESMT FOR LOT 8

10' ACCESS AND UTILITY ESMT FOR LOT 8

10' ACCESS AND UTILITY ESMT FOR LOT 8