

SURVEY IN GOVERNMENT LOT 2 OF SECTION 1, TOWNSHIP 33 NORTH, RANGE 4 EAST, W.M.
AND GOVERNMENT LOT 7 OF SECTION 6, TOWNSHIP 33 NORTH, RANGE 5 EAST, W.M.

AUDITOR'S CERTIFICATE

2014.11.14.00 PM 2 \$398.00
Skagit County Auditor 1 of 1 1:21:29 PM
11/14/2014 Page 1

FILED FOR RECORD AT THE REQUEST OF HARMSEN & ASSOCIATES, INC.

[Signature]
SKAGIT COUNTY AUDITOR
BY DEPUTY *[Signature]*

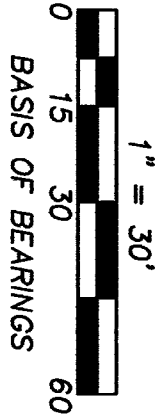

S 49° 21' 30" E ALONG THE CENTERLINE OF WEST
LAKE BOULEVARD AS MONUMENTED AND SHOWN
HEREON AND BY THAT SURVEY RECORDED UNDER
SKAGIT COUNTY AUDITOR'S FILE NO. 9801060055

LEGEND

- DENOTES 1/2" REBAR WITH "H&A 27327" CAP SET THIS SURVEY
- DENOTES FOUND IRON PIPE UNLESS OTHERWISE NOTED
- DENOTES FOUND 5/8" REBAR WITH "MOMER LS 21520" CAP, ACCEPTED AND HELD
- AFN REFERENCE TO SKAGIT COUNTY AUDITOR'S FILE NUMBER
- ROS REFERENCE TO SKAGIT COUNTY RECORD OF SURVEY
- (C) DENOTES CALCULATED BEARING AND DISTANCE
- (M) DENOTES MEASURED BEARING AND DISTANCE
- (P) DENOTES DISTANCE OR ANGLE OF RECORD, AS DEPICTED ON LELLA BUCK'S REPLAY OF LOT 74 FIRST ADDITION TO BIG LAKE WATERFRONT TRACTS, RECORDED UNDER SKAGIT COUNTY AUDITOR'S FILE NO. 8606250005
- (R1) DENOTES DISTANCE OF RECORD AS DEPICTED ON THAT SURVEY RECORDED UNDER SKAGIT COUNTY AUDITOR'S FILE NO. 9801060055
- (R2) DENOTES DISTANCE OF RECORD AS DEPICTED ON THAT SURVEY RECORDED UNDER SKAGIT COUNTY AUDITOR'S FILE NO. 7910250040

SURVEY NOTES

- SURVEY PROCEDURES & EQUIPMENT:
EQUIPMENT: LEICA 1103+ 3-SECOND ELECTRONIC DIGITAL TOTAL STATION, PROCEDURE: FIELD TRAVERSE USING EXISTING MONUMENTATION; ALL CONTROL ANGLES AND DISTANCES DOUBLE MEASURED; MEETS OR EXCEEDS THE STANDARDS CONTAINED IN WAC 322-130-080.
- DISTANCES ARE IN FEET AND DECIMALS THEREOF.
- ALL CONTROLLING MONUMENTS SHOWN ARE OF RECORD, ARE LOCALLY ACCEPTED AS REPRESENTATIVE OF THEIR PURPORTED POSITIONS, AND WERE VISITED DURING THE COURSE OF THIS SURVEY UNLESS OTHERWISE NOTED.
- THE LEGAL DESCRIPTION RECITED HEREON WAS PROVIDED BY STATUTORY WARRANTY DEED RECORDED UNDER SKAGIT COUNTY AUDITOR'S FILE NO. 201207150089.
- THIS SURVEY DOES NOT PURPORT TO SHOW ALL EASEMENTS OR ENCUMBRANCES OF RECORD.
- ENCUMBRANCES ARE DEPICTED HEREON IN ACCORDANCE WITH THE REQUIREMENTS OF WAC 332-130-050. THIS SURVEY DOES NOT RESOLVE ISSUES OF ENCROACHMENT OR OCCUPATION.

GLORIA R. SCHNELL

RECORD OF SURVEY

SCALE: 1" = 30'	SHEET: 1 OF 1
DRAWN BY: JAH	S.T.R. INDEX: 4F
DATE: 10/30/14	GL 2 1-33N-4E
REVISED: N/A	GL 7 6-33N-5E
F.B. M.V.-98	
JOB#: 14-204	
HARMSEN & ASSOCIATES, INC.	
603 SOUTH FIRST STREET	
MOUNT VERNON, WA 98273	
TEL: (360) 336-9189	

SURVEYOR'S CERTIFICATE

THIS MAP CORRECTLY REPRESENTS A SURVEY MADE BY ME OR UNDER MY DIRECTION IN CONFORMANCE WITH THE REQUIREMENTS OF THE WASHINGTON STATE SURVEY RECORDING ACT AT THE REQUEST OF GLORIA R. SCHNELL, IN OCTOBER, 2014.

JAMES B. SMITH, PLS OF ADS
CERTIFICATE NO. 27327

[Signature] 11/14/14

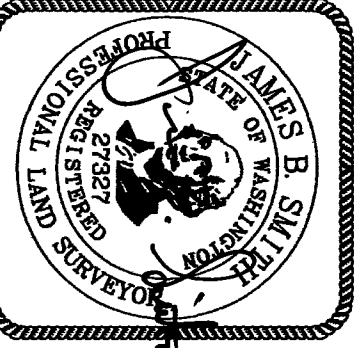

SEC 1, T 33N, R 4E W.M. SEC 6, T 33N, R 5E W.M.
X: \MOUNT VERNON\PROJECTS\14-204 SCHNELL\15\DWG\14-204_ROS_C3D13.DWG