

AUDITORS CERTIFICATE

RECORD OF SURVEY AT THE REQUEST OF DALE K. HERRIGSTAD

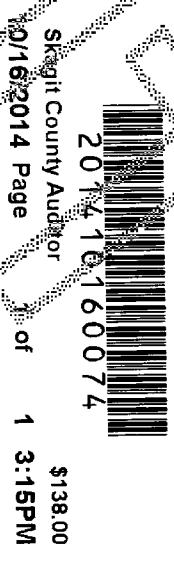

LEGAL DESCRIPTION

PARCEL "A":

That portion of the West 1/2 of the Southeast 1/4 of the Southwest 1/4 and of the East 1/2 of the Southwest 1/4 of the Southwest 1/4 of Section 25, Township 35 North, Range 1 East, W.M., described as follows:
Beginning at the Northeast corner of the Southeast 1/4 of the Southwest 1/4 of said Section 25;
thence West 77 4/7 rods;
thence due South a distance of 865.00 feet, to the true point of beginning;
thence West a distance of 180.32 feet;
thence South a distance of 290 feet;
thence East 180.32 feet;
thence North a distance of 290 feet to the true point of beginning.

Situate in the County of Skagit County, State of Washington.

PARCEL "B":

A non-exclusive right and privilege to use, travel upon and over and across the following described private roadway:

The East 50 feet of the West 205 feet of the following described tract: Beginning at the Northeast corner of the Southeast 1/4 of the Southwest 1/4 of said Section; thence West 77 4/7 rods to the true point of beginning; thence West 21 6/7 rods; thence South 70 rods; thence East 21 6/7 rods; thence North 70 rods to the true point of beginning.

Situate in the County of Skagit County, State of Washington.

PARCEL "C":

A tract of land 33 feet in width, the Westerly line of which is described as follows: A line running South through the Southeast 1/4 of the Southwest 1/4 of Section 25, Township 35 North, Range 1 East, W.M., Skagit County, Washington, more particularly described as follows: Beginning at the Northeast corner of the Southeast 1/4 of the Southwest 1/4 of said Section; thence South 89°09'22" West along the North line of the Southeast 1/4 of the Southwest 1/4 of a distance of 77 4/7 rods to the initial point of this line; thence South 00°48'27" East, a distance of 70 rods, more or less, along the Easterly line of those certain tracts conveyed by Deeds recorded September 16, 1961, under Auditor's File No. 612369, August 17, 1959, under Auditor's File No. 584420, June 13, 1977, under Auditor's File No. 780791, to Jack B. Tobien, et ux, Michael E. Kronholm, et ux, Albert A. Hodgson, et ux, and Donald F. Escher, et ux; respectively, to an existing iron pipe as shown on the plat prepared by Harold Rader for Frank Foster dated November 1, 1958.

EXCEPT the North 835 feet thereof.

Situate in the County of Skagit County, State of Washington

NOTES:-

1. THE LEGAL DESCRIPTION FOR THIS SURVEY IS A STATUTORY WARRANTY DEED RECORDED UNDER AUDITOR'S FILE #20121140040, RECORDS OF SKAGIT COUNTY, WASHINGTON.
2. FOUND RAILROAD SPIKE AND HELD PER ROS AF#200704110124.
3. FOUND REBAR & CAP AS NOTED.
4. SET REBAR & YELLOW CAP 27807.
5. EQUIPMENT USED: CARLSON CR2 Robotic Total Station.
6. MONUMENTS TIED ON May 5, 2014.
7. ERROR OF CLOSURE MEETS WASHINGTON STATE SURVEY STANDARDS.
8. SURVEY METHOD: STANDARD FIELD TRAVERSE.
9. BASIS OF BEARINGS AND SECTION BREAK DOWN: Recorded survey AF #200704110124.
10. THIS SURVEY WAS PERFORMED WITHOUT THE BENEFIT OF A CURRENT TITLE REPORT. THIS SURVEY DOES NOT PURPORT TO SHOW ALL EASEMENTS RESTRICTIONS, RESERVATIONS, PROVISIONS, COVENANTS OR CONDITIONS WHICH MAY AFFECT THE PARCELS SHOWN HEREON.
11. THIS IS A BOUNDARY SURVEY ONLY. UTILITIES WERE NOT INVESTIGATED.

SHEET 1 OF 1

RECORD OF SURVEY FOR:

4405 "E" Avenue
Anacortes, WA 98221

SURVEY IN THE SW 1/4 OF SECTION 25,
TOWNSHIP 35 N., RNG. 1 EAST, W.M.,
SKAGIT COUNTY, WASHINGTON

HERRIGSTAD ENGINEERING & SURVEYING

4320 Whistle Lake Road, Anacortes, WA 98221 (360) 299-8804

GRAPHIC SCALE

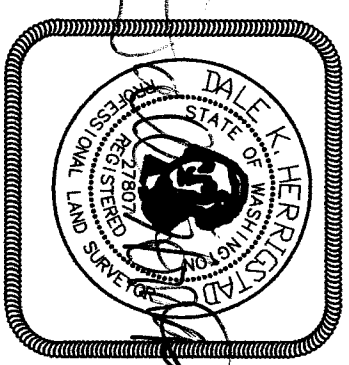
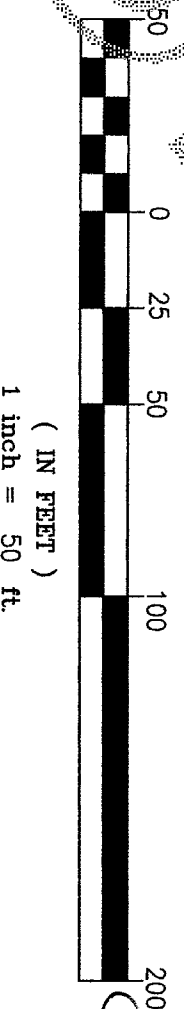

SURVEYOR'S CERTIFICATE

THIS MAP CORRECTLY REPRESENTS A SURVEY MADE BY ME OR UNDER MY DIRECTION IN CONFORMANCE WITH THE REQUIREMENTS OF THE SURVEY RECORDING ACT AT THE REQUEST OF ROY GRAVES IN MAY, 2014.

DALE K. HERRIGSTAD, P.L.S.

Date Oct 16, 2014

Certificate No. 27807