

201409300097

9/30/2014 Page 1 of 1 2:33PM \$138.00

AT THE REQUEST OF SEMPAU ENGINEERING & SURVEYING P.L.C..

 SKAOT COUNTY AUDITOR

 DEPUTY

DEPUTY

BOUNDARY SURVEY DESCRIPTION

THE WEST 1/2 OF THE NORTHEAST 1/4 OF THE NORTHWEST 1/4, LESS THE EAST 100 FEET OF THE NORTH 218 FEET THEREOF, OF SECTION 15, TOWNSHIP 34 NORTH, RANGE 3 EAST, T4M, S34C1 COUNTY, WASHINGTON.

EXCEPT THE NORTH 30 FEET THEREOF AS CONVEYED TO SKAGIT COUNTY FOR ROAD PURPOSES BY GULF CLAM DEED DATED OCTOBER 15, 1884 AND RECORDED NOVEMBER 1, 1895, UNDER AUDITOR'S FILE NO. 20609 IN VOLUME 30 OF DEEDS, PAGE 199, RECORDS OF SKAGIT COUNTY.

ALSO EXCEPT FOR RIGHT-OF-WAY CONDEMNED BY DRAINAGE DISTRICT #19 ON
DECEMBER 4, 1922.

NOTES

1. SURVEY PROCEDURE: FIELD TRAVERSE WITH LEICA TCRP 1201+ R1000 THEODOLITE DISTANCE MEETER.
2. LEGAL DESCRIPTION IS FROM STATUTORY WARRANTY DEED DATED SEPTEMBER 8, 2005 AND RECORDED SEPTEMBER 12, 2005 UNDER AUDITOR'S FILE NO. 200509120139 IN THE RECORDS OF SKAGIT COUNTY, WASHINGTON..
3. MERIDIAN: NORTH LINE OF THE NORTHWEST 1/4, SECTION 15, TOWNSHIP 34 NORTH RANGE 3 EAST, W.M. AS SHOWN ON RECORD OF SURVEY RECORDED UNDER AUDITOR'S FILE NO. 200408040065 = N89°27'09"E.
4. THIS SURVEY MAY SHOW OCCUPATIONAL INDICATORS AS PER W.A.C. CHAPTER 332.130. LINES OF OCCUPATION MAY INDICATE AREAS FOR POTENTIAL CLAIMS OF UNWRITTEN OWNERSHIP. THIS BOUNDARY SURVEY HAS ONLY SHOWN THE RELATIONSHIP OF LINES OF OCCUPATION TO THE DEEDED LINES OF RECORD. NO RESOLUTION OF OWNERSHIP BASED ON UNWRITTEN RIGHTS HAS BEEN MADE OR IMPLIED BY THIS SURVEY.
5. EXCEPT AS SPECIFICALLY STATED OR SHOWN ON THIS SURVEY MAP, THIS SURVEY DOES NOT PURPORT TO REFLECT ALL OF THE FOLLOWING WHICH MAY BE APPLICABLE TO THE SUBJECT REAL ESTATE: EASEMENTS, BUILDING SETBACK LINES, RESTRICTIVE COVENANTS, SUBDIVISION RESTRICTIONS, ZONING OR OTHER LAND-USE REGULATIONS AND ANY OTHER FACTS.
6. SUBDIVISION CALCULATED FROM RECORDS OF SURVEY UNDER AUDITOR'S FILE NUMBERS 9510030013 AND 200408040065.

LEGEND

- EXISTING REBAR OR IRON PIPE FOUND
- SET 1/2" REBAR & CAP "SEMRU 28626"

CALCULATED
SEE NOTE 6

SHEET 1 OF 1

SURVEY OF A
PORTION OF THE NORTHWEST 1/4 OF THE
NORTHWEST 1/4 OF SECTION 15, T. 34 N., R. 3 E., W.M.
SKAGIT COUNTY, WASHINGTON
FOR: KAREN PETERSEN

SUPERVISOR'S CERTIFICATE

THIS MAP CORRECTLY REPRESENTS A SURVEY MADE BY ME OR UNDER MY DIRECTION IN CONFORMANCE WITH THE REQUIREMENTS OF THE SURVEY RECORDING ACT AT THE REQUEST OF KAREN PETERSEN.

JOHN B. SEMRAU, P.E., P.L.S., CERTIFICATE NO. 28626

DATE: _____

2148 RIVERSIDE DRIVE SUITE 208
MOUNT VERNON, WA 98273
PHONE 360-424-9566

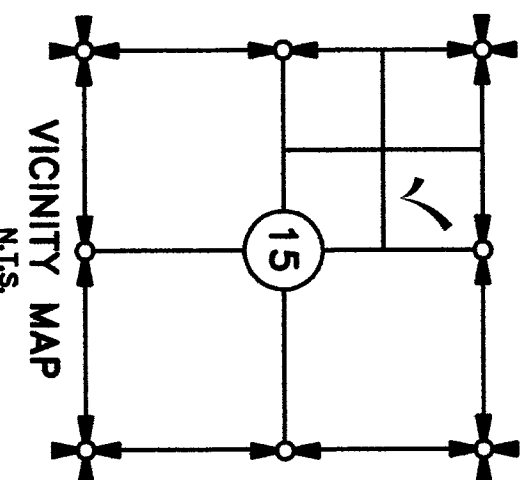
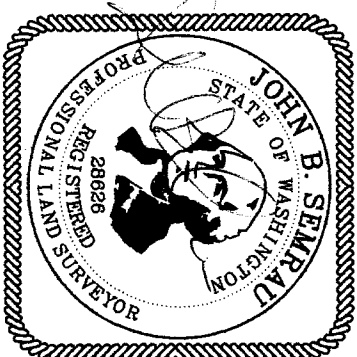

N.T.S.

MERIDIAN: ASSUMED

SURVEYING • ENGINEERING • PLANNING
MOUNT VERNON, WA 98273 360-424-9566

JOB NO. 5323

DRAWING FILE: 5323.DWG 9/30/14