



201408210068

Skagit County Auditor

\$77.00

8/21/2014 Page

1 of

6 1:33PM

When recorded return to:  
Department of Natural Resources  
Northwest Region  
Attn: Jamie Hitt  
919 North Township St.  
Sedro-Woolley, WA 98284

With a copy to:  
Weyerhaeuser Columbia Timberlands LLC  
Attn: Michelle Metcalf  
PO Box 667  
Longview WA 98632

SKAGIT COUNTY WASHINGTON  
REAL ESTATE EXCISE TAX

AUG 21 2014

Amount Paid \$  
Skagit Co. Treasurer  
By *1/1/14* Deputy

STATE OF WASHINGTON  
DEPARTMENT OF NATURAL RESOURCES  
PETER GOLDMARK, Commissioner of Public Lands  
Olympia, Washington 98504

**Grantor:** Weyerhaeuser Columbia Timberlands LLC and  
State of Washington, Department of Natural Resources  
**Grantee:** State of Washington, Department of Natural Resources and  
Weyerhaeuser Columbia Timberlands LLC

**Weyerhaeuser Columbia Timberlands LLC Legal Description:** E1/2SE1/4, S17, T36N, R5E  
Assessor's Property Tax Parcel or Account Number: P50949

**Department of Natural Resources, Legal Description:** SW1/4SW1/4, S16, T36N, R5E  
Assessor's Property Tax Parcel or Account Number: P114747

**Cross Reference:** AFN 200603010016, 200401300177

**DNR Easement No.:** 55-074132, 50-074105

SECOND EASEMENT AMENDMENT

THIS AGREEMENT, made and entered into this 3<sup>rd</sup> day of <sup>JULY</sup>~~JUNE~~, 2014, by and between WEYERHAEUSER COLUMBIA TIMBERLANDS LLC, a Delaware limited liability company, successor by merger to Longview Fibre Company, a Washington corporation, herein called "Grantor," and STATE OF WASHINGTON, acting by and through the Department of Natural Resources, herein called "State," WITNESSETH:

## RECITALS

- A. Whereas, on the 16<sup>th</sup> day of January, 2004, Grantor and State entered into an easement exchange, hereinafter "Original Easement Exchange", which was recorded in the records of Skagit County, Washington on the 30<sup>th</sup> day of January, 2004, under Auditor's File No. 200401300177, and;
- B. Whereas on February 17, 2006, Grantor and State entered into an easement exchange supplement to the Original Easement Exchange, herein called "Original Supplement #1", which was recorded in the records of Skagit County, Washington on March 1<sup>st</sup>, 2006, under Auditors File No. 200603010016, and;
- C. Whereas the State and Grantor wish to amend the Original Supplement #1 as follows:
- D. Weyerhaeuser Columbia Timberlands LLC is successor to Longview Fibre Company.

## AGREEMENT

1. Weyerhaeuser Columbia Timberlands LLC, hereby grants and conveys, to State, its successors and assigns, subject to all matters of public record, a non-exclusive, permanent easement (the "New Easement") sixty (60) feet wide, running thirty (30) feet on each side of the centerline of a road over and across a portion of the E $\frac{1}{2}$ SE $\frac{1}{4}$  of Section 17, Township 36 North, Range 5 East, W.M., in Skagit County, Washington, and located approximately as shown on the attached "Exhibit A."
2. For and in consideration for conveyance of the New Easement, the State relinquishes and quitclaims to Weyerhaeuser Columbia Timberlands LLC all interest, rights and liabilities that the State may have in and to those portions of Supplement #1 over and across NE $\frac{1}{4}$  SE $\frac{1}{4}$  of Section 17, Township 36 North, Range 5 East, in Skagit County, Washington, and located approximately as shown on the attached "Exhibit A"
3. State hereby grants and conveys, to Weyerhaeuser Columbia Timberlands LLC, its successors and assigns, subject to all matters of public record, a non-exclusive, permanent easement sixty (60) feet wide, running thirty (30) feet on each side of the centerline of a road over and across a portion of the SW $\frac{1}{4}$  SW $\frac{1}{4}$  of Section 16, Township 36 North, Range 5 East, W.M., in Skagit County, Washington, and located approximately as shown on the attached "Exhibit A".
4. Exhibit A, State's Burdened Parcels, shall be amended to include: SW $\frac{1}{4}$  SW $\frac{1}{4}$  of Section 16, Township 36 North, Range 5 East.
5. Exhibit F, Exchanger's Benefited Parcels, shall be amended to include: Gov. Lots 4 and 5, Section 21, Township 36 North, Range 5 East.



201408210068

Except as herein amended, all of the terms, conditions and reservations of the Supplement and Original Easement Exchange shall remain in full force and effect.

IN WITNESS WHEREOF, the parties hereto have executed this instrument, in duplicate, to become effective as of the day and year first above written.

WEYERHAEUSER COLUMBIA  
TIMBERLANDS LLC

Dated: June 9<sup>th</sup>, 2014.

Affix Seal of Corporation





By: Devin W. Stockfish  
Title: Corporate Secretary  
P. O. Box 667  
Longview, WA 98632

STATE OF WASHINGTON  
DEPARTMENT OF NATURAL RESOURCES

Dated: 7/31, 2014.



Peter Goldmark  
Commissioner of Public Lands  
P.O. Box 7000  
1111 Washington Street SE  
Olympia WA 98504-7000

Affix Seal of Commissioner  
of Public Lands



201408210068

UNRECORDED

REPRESENTATIVE ACKNOWLEDGEMENT

State of Washington

County of King

I certify that I know or have satisfactory evidence that Devin W. Stockfish is the person who appeared before me, and said person acknowledged that he signed this instrument, on oath stated that he was authorized to execute the instrument and acknowledged it as the Corporate Secretary of Weyerhaeuser Columbia Timberlands LLC to be the free and voluntary act of such party for the uses and purposes mentioned in the instrument.

Dated: 6/9/2014

(Seal or stamp)

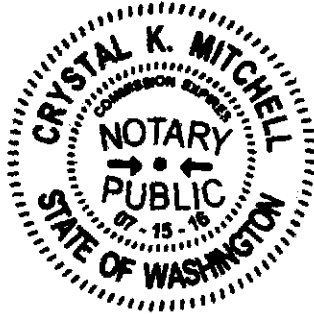

[Signature]  
(Signature)

Crystal K. Mitchell  
(Print Name)

Notary Public in and for the State of Washington,  
residing at Pierce County

My appointment expires 7/15/2016



201408210068

Skagit County Auditor

8/21/2014 Page

4 of

6

1:33PM

\$77.00

## STATE ACKNOWLEDGEMENT

State of Washington

County of Thurston

I certify that I know or have satisfactory evidence that PETER GOLDMARK is the person who appeared before me, and said person acknowledged that he signed this instrument, on oath stated that he was authorized to execute the instrument and acknowledged it as the Commissioner of Public Lands, and administrator of the Department of Natural Resources of the State of Washington to be the free and voluntary act of such party for the uses and purposes mentioned in the instrument.

Dated: 7.31.14

(Seal or stamp)

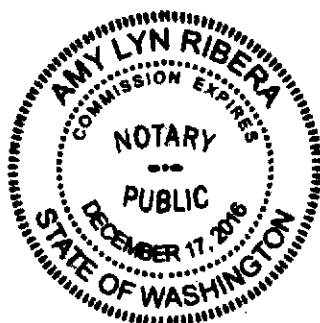

(Signature)

(Print Name)

Notary Public in and for the State of Washington,  
residing at Olympic

My appointment expires 12.17.16





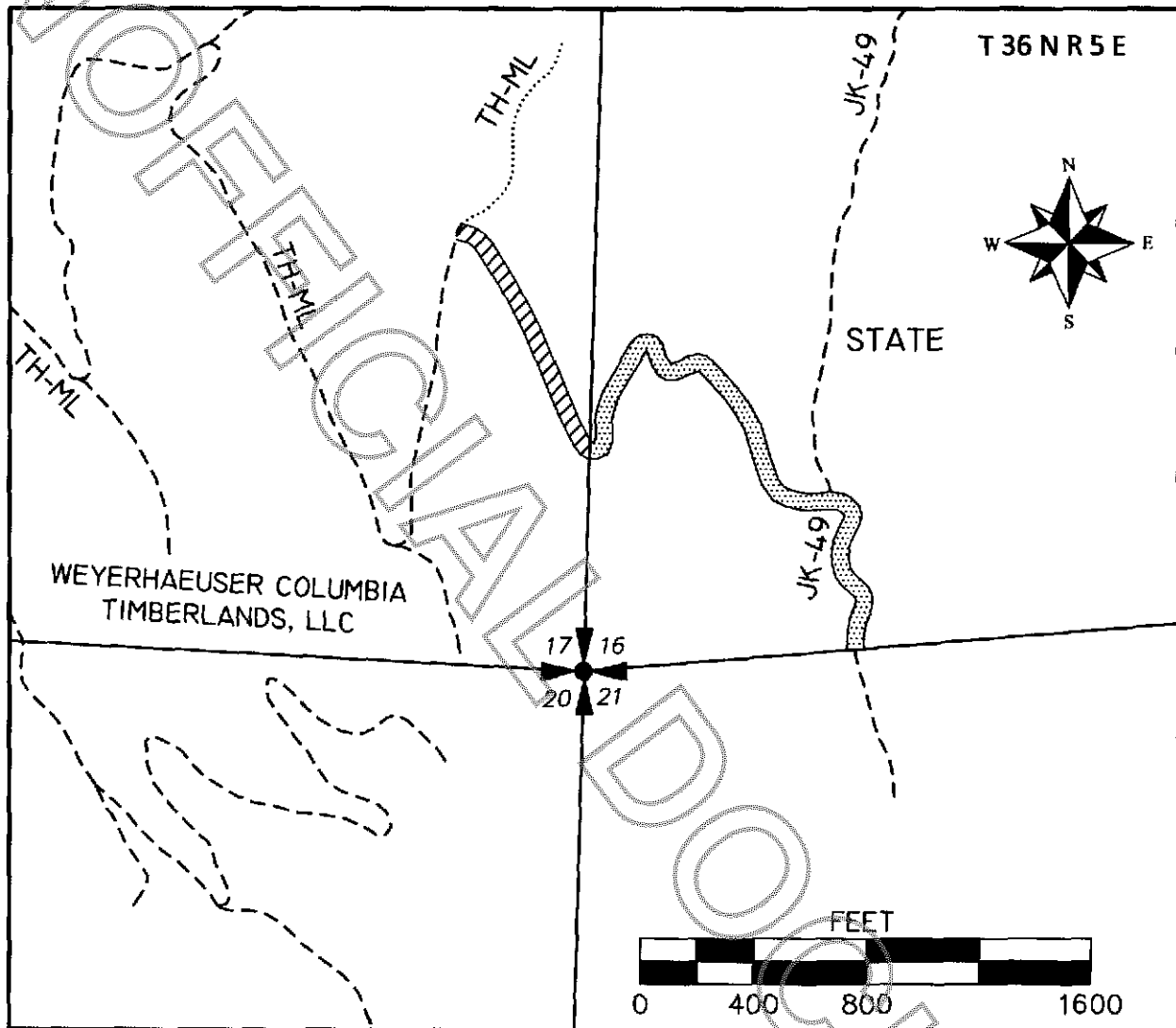

201408210068

Exhibit A



LEGEND

-  SECTION CORNER
-  RELINQUISHED
-  ROAD EASEMENT AREA - STATE TO WEYERHAEUSER  
WIDTH: 60 FT. LENGTH: 2,157 FT. AREA: 3.0 ACRES  
(50-074105)
-  ROAD EASEMENT AREA - WEYERHAEUSER TO STATE  
WIDTH: 60 FT. LENGTH: 950 FT. AREA: 1.3 ACRES  
(55-074132)
-  EXISTING ROADS

