

NARRATIVE

THE PURPOSE OF THIS SURVEY WAS TO POST THE WESTERLY PORTION OF THE NORTH LINE OF THE SW 1/4 OF THE NE 1/4 OF SECTION 27 TO SERVE THE 'RYE BREAD' TIMBER SALE.

STATE BOUNDARIES WERE POSTED WITH ORANGE, 4-FOOT-LONG WOOD LATH SET AT IRREGULAR INTERVALS OF ABOUT 110 FEET.

DESCRIPTION OF STATE BOUNDARY SURVEYED

THE WESTERLY 688 FEET OF THE NORTH LINE OF THE SW 1/4 OF THE NE 1/4 OF SECTION 27, TOWNSHIP 36 NORTH, RANGE 6 EAST, WILLAMETTE MERIDIAN, SKAGIT COUNTY, WASHINGTON

CONTROL SPECIFICATIONS, METHOD OF SURVEY, EQUIPMENT USED AND ACCURACY

CORNER TIES WERE MADE BY FIELD TRAVERSE USING A LEICA TCRA 1203+ TOTAL STATION. CORNER MONUMENTS TIED WERE CHECKED BY DOUBLE MEASURES OF BOTH DIRECTION AND DISTANCE. THE TRAVERSE DATA WAS PROCESSED USING STARSNET VERSION 7.0.0.42. TRAVERSE CLOSURES MEET FIELD TRAVERSE STANDARDS FOR FOREST LAND TRAVERSES AS SPECIFIED IN WAC 332-130-090.

BASIS OF BEARINGS AND DISTANCES

BASIS OF BEARINGS IS S88°41'31"E, FOR THE EAST-WEST CENTER LINE OF THE NE 1/4 OF SECTION 27, AS DEPICTED OF THAT RECORD OF SURVEY RECORDED UNDER APN 9709090088 AND DATED SEPTEMBER 9, 1997 AT THE SKAGIT COUNTY, WASHINGTON AUDITOR'S OFFICE. DISTANCES ARE HORIZONTAL GROUND DISTANCES.

LIST OF SURVEY DOCUMENTS USED FOR REFERENCE

RECORDING INFORMATION REFERS TO THE RECORDS OF THE SKAGIT COUNTY AUDITOR, UNLESS OTHERWISE NOTED. THE PARENTHETICAL NUMBERS ARE REFERENCED WITHIN THE HISTORY SECTION OF THE VARIOUS CORNERS.

(1) RECORD OF SURVEY IN SECTIONS 25, 26, 27 AND 33, BY CROWN PACIFIC LTD. (FREDERIC P. PETERSEN, PLS 26303), RECORDED UNDER APN 9709090088 AND DATED 9-9-1997

[S15]

688'

STATE

PRIVATE

S 88°41'31" E 2722.24' (2721.97 RECORD)

[S17]

LINE POSTING:

////////// - INDICATES THAT WOODEN LATH "BOUNDARY" POSTS WERE SET AT IRREGULAR INTERVALS ALONG THE INDICATED SUBDIVISION LINE AND ARE WITHIN ONE FOOT OF THE ACTUAL SUBDIVISION LINE.

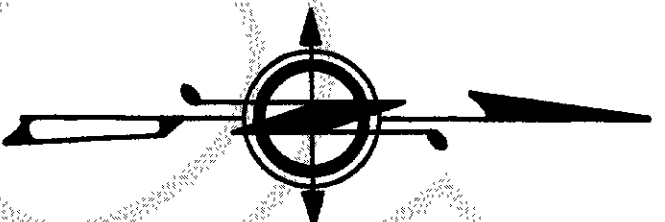

1" = 200 FEET
0 100 200 400
RECORD OF SURVEY A.F.N. 9709090088

SURVEYOR'S CERTIFICATE

THIS MAP CORRECTLY REPRESENTS A SURVEY MADE BY ME OR UNDER MY DIRECTION IN CONFORMANCE WITH THE REQUIREMENTS OF THE SURVEY RECORDING ACT AT THE REQUEST OF THE WASHINGTON STATE DEPARTMENT OF NATURAL RESOURCES IN DECEMBER, 2013.

GARY S. HERRICK, PLS

CERTIFICATE NUMBER 31444

3-31-14

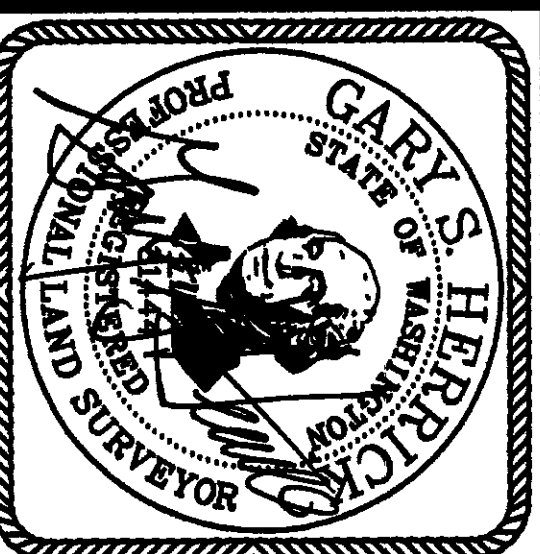

A SURVEY IN SECTION 27
TOWNSHIP 36 NORTH, RANGE 6 EAST, W.M.

STATE OF WASHINGTON
DEPARTMENT OF NATURAL RESOURCES

LAND SURVEY SECTION--P.O. BOX 47030
OLYMPIA, WASHINGTON 98504-7030 (360)902-1206

RYE BREAD

FIELD CREW: HERRICK, WILLIAMS

FIELD BOOK: 7082 FM1796.DWG 12/19/13

F.M.# 1796

SHEET 1 OF 1

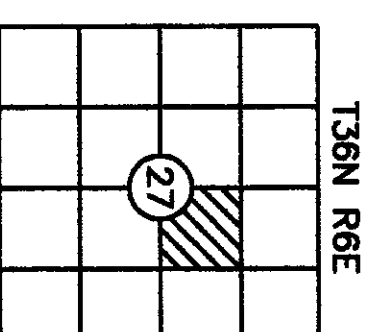

AUDITOR'S CERTIFICATE

FILED FOR RECORD AT THE REQUEST
OF THE WASHINGTON STATE D.N.R.



Skagit County Auditor
201404010041 \$138.00
4/1/2014 Page 1 of 1 1:12:40PM

SKAGIT COUNTY AUDITOR

DEPUTY

CORNER HISTORY AND DESCRIPTIONS

(S15) CENTER N 1/16 SEC. COR. OF SEC. 27

FOUND & ACCEPTED 1/2" REBAR & PLASTIC CAP

HISTORY:
1997 - A SURVEY BY CROWN PACIFIC SET A 1/2" REBAR WITH PLASTIC CAP LS26303 (1).

FIELD SEARCH:
ON 10-10-13, THIS SURVEY FOUND AND ACCEPTED A 1/2" REBAR WITH YELLOW PLASTIC CAP MARKED "CPL 26303." THE REBAR WAS FOUND DRIVEN INTO A ROTTED, DOWNED LOG BUT APPEARED STRAIGHT AND UNDISTURBED. THIS SURVEY STRADDLED THE REBAR & CAP, TEMPORARILY REMOVED IT, CUT AWAY THE ROTTED LOG AND RESET THE REBAR & CAP IN MINERAL SOIL. TWO CROWN PACIFIC RP TAGS WERE FOUND FACING THE REBAR & CAP.

CORNER PERPETUATION:

THIS SURVEY ESTABLISHED REFERENCES AS FOLLOWS:
A DNR VINYL RP TAG ON AN 18" HEMLOCK BEARS N83E AT 19.69 FEET TO AN ALUMINUM NAIL THAT IS 2 FEET UP ON THE NORTHWEST SIDE.
A DNR VINYL RP TAG ON A 21" HEMLOCK BEARS S12E AT 19.74 FEET TO AN ALUMINUM TAG THAT IS 1 FOOT UP ON THE NORTHEAST SIDE.
A DNR VINYL RP TAG ON A 33" FIR BEARS S31W AT 58.29 FEET TO AN ALUMINUM NAIL THAT IS 1 FOOT UP ON THE NORTHWEST SIDE.
A DNR VINYL RP TAG ON A 34" FIR SNAG BEARS N34W AT 17.92 FEET TO AN ALUMINUM NAIL THAT IS 1 FOOT UP ON THE SOUTHWEST SIDE.
AN ORANGE CARSONITE POST BEARS NORTH AT 1.5 FEET.

FIELD BOOK 7082, PAGE 40, DATED 10-10-2013

(S17) N 1/16 SEC. COR. OF SECS. 26 AND 27

FOUND & ACCEPTED 1/2" REBAR & PLASTIC CAP

HISTORY:
1997 - A SURVEY BY CROWN PACIFIC SET A 1/2" REBAR WITH PLASTIC CAP LS26303 (1).

FIELD SEARCH:

ON 10-14-13, THIS SURVEY FOUND AND ACCEPTED A 1/2" REBAR WITH YELLOW PLASTIC CAP MARKED "CPL 26303." WITHIN A LOOSE RING OF STONES, AN OVERGROWN CROWN PACIFIC RP TAG WAS FOUND FACING THE REBAR & CAP.

CORNER PERPETUATION:

THIS SURVEY ESTABLISHED REFERENCES AS FOLLOWS:
A DNR VINYL RP TAG ON AN 8" HEMLOCK BEARS N84E AT 45.04 FEET TO AN ALUMINUM NAIL THAT IS 2 FEET UP ON THE SOUTHEAST SIDE.
A DNR VINYL RP TAG ON A 27" HEMLOCK STUMP BEARS S74W AT 25.32 FEET TO A STEEL NAIL THAT IS 1 FOOT UP ON THE SOUTHEAST SIDE.
A DNR VINYL RP TAG ON A 32" FIR BEARS N24W AT 14.90 FEET TO AN ALUMINUM NAIL THAT IS ON THE SOUTHWEST SIDE.
AN ORANGE CARSONITE POST BEARS EAST AT 1 FOOT.

FIELD BOOK 7082, PAGE 41, DATED 10-14-2013