

Return to:

Skagit County
Planning & Development Services
1800 Continental Place
Mount Vernon, WA 98273-5526
360 336-9410



201311270082

Skagit County Auditor

\$73.00

11/27/2013 Page

1 of

2 1:26PM

PROTECTED CRITICAL AREA SITE PLAN

Page 1 of 2

Grantor/Owner: David Manier/Danielle Haugland

Grantee: PUBLIC

Site Address: 21422 Prairie Road

Property ID #: P50141

Assessors Tax Account #: 360427-2-012-0005

Legal Description: Sec. 27 Twp. 36 Rng. 04/ Plat Name: --- Lot: ---

Permit/Activity #: BP13-0547

The PROTECTED CRITICAL AREA (PCA) is to be left undisturbed in its natural state. "With the exception of activities identified as Allowed without Standard review under SCC 14.24.070, any land-use activity that can impair the functions and values of critical areas or their buffers through a development activity or by disturbance of the soil or water, and/or by removal of, or damage to, existing vegetation shall require critical areas review and written authorization pursuant to SCC 14.24." SCC 14.24.060

No clearing, grading, filling, logging or removal of woody material, building, construction or road construction of any kind, planting of non-native vegetation or grazing of livestock is allowed within the PCA areas except as specifically permitted by Skagit County on a case-by-case basis consistent with SCC 14.24.

Representations on this site plan may be approximations only and should not be used for purposes other than for determining general locations of critical areas. Development activities beyond the scope of this plan may require additional studies and approvals.

The above references to "Grantor" and "Grantee" shall not be construed as a transfer of property ownership and are used solely for filing with the County Auditor.

Owner: Danielle S. Haugland Date: 11/26/2013

On this day personally appeared before me Danielle S. Haugland, to me known to be the individual(s) described in and who executed the within and foregoing instrument, and acknowledged that he/she/they signed the same as his/her/their free and voluntary act and deed, for the uses and purposes therein mentioned.

Given under my hand and seal of office this 26th day of November, 2013

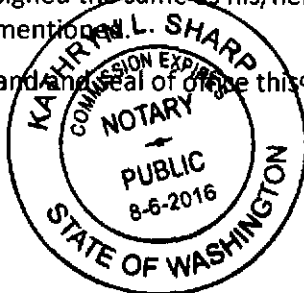

Notary: Kathryn L. Sharp

Notary Public residing at: Skagit Co.

My Commission Expires: 8-6-2016

CRITICAL AREA SITE PLAN

This property is designated Ag-NRL/RRC-NRL. All existing & ongoing commercial agriculture may continue in compliance with SCC 14.24.120.

Owners: Danielle and Jason Haugland
 Address: 21422 Prairie Road
 Parcel: PS0141
 Permit: BP13-0549
 Preparer: Edison Engineering
 Date: November, 2013

This drawing was done with the designers drawing, but other measurements were added. This drawing is approximate.
 NOT A SURVEY

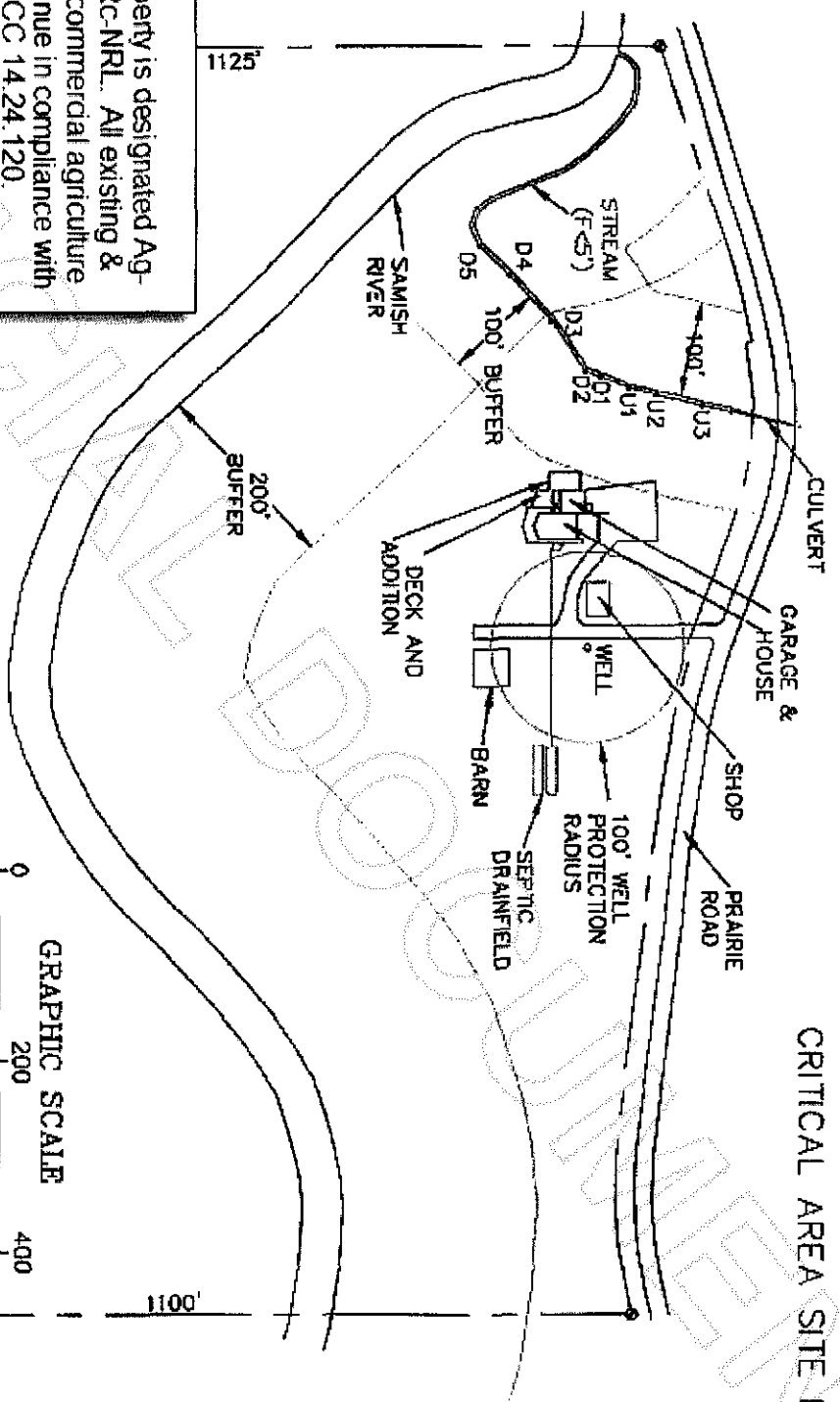

Handwritten: CAD prepared 11/21/13 Leah Perry