

SURVEY DESCRIPTION

SKAGIT COUNTY ASSESSOR'S PARCEL NO. P-24064

TRACT 2, OF REVISED SHORT PLAT NO. 48-76, APPROVED DECEMBER 28, 1976, AND RECORDED DECEMBER 29, 1976 UNDER AUDITOR'S FILE NO. 848370 IN VOLUME 2 OF SHORT PLATS, PAGE II, RECORDS OF SKAGIT COUNTY WASHINGTON, BEING A PORTION OF THE NORTHWEST 1/4 OF THE NORTHEAST 1/4 OF SECTION 7, TOWNSHIP 34 NORTH, RANGE 4 EAST, 11N1, EXCEPT THE NORTHERLY 66.8 FEET THEREOF.

SKAGIT COUNTY ASSESSOR'S PARCEL NO. P-107161

THAT PORTION OF TRACT 1 OF REVISED SHORT PLAT NO. 48-76, APPROVED DECEMBER 28, 1976, AND RECORDED DECEMBER 29, 1976 UNDER AUDITOR'S FILE NO. 848370, IN VOLUME 2 OF SHORT PLATS, PAGE II, RECORDS OF SKAGIT COUNTY WASHINGTON, BEING A PORTION OF THE NORTHWEST 1/4 OF THE NORTHEAST 1/4 OF SECTION 7, TOWNSHIP 34 NORTH, RANGE 4 EAST, 11N1, DESCRIBED AS FOLLOWS:

COMMENCING AT THE SOUTHWEST CORNER OF TRACT 2 OF SAID REVISED SHORT PLAT;
THENCE NORTH 88°33'54" WEST ALONG THE SOUTH LINE OF SAID TRACT 1 A DISTANCE OF 88.44 FEET;
THENCE NORTH 1°27'18" EAST 443.83 FEET TO THE NORTH LINE OF THAT CERTAIN PARCEL, "D", AS DESCRIBED UNDER AUDITOR'S FILE NO. 4403010145, RECORDS OF SKAGIT COUNTY, WASHINGTON;
THENCE SOUTH 88°33'54" EAST ALONG THE NORTH LINE OF SAID PARCEL "D" 88.32 FEET TO THE NORTHEAST CORNER THEREOF SAID POINT ALSO BEING ON THE WEST LINE OF TRACT 2 OF SAID REVISED SHORT PLAT;
THENCE SOUTH 1°26'01" WEST ALONG THE WEST LINE THEREOF, 443.83 FEET TO THE POINT OF BEGINNING.

SKAGIT COUNTY ASSESSOR'S PARCEL NO. P-116150

THAT PORTION OF TRACT 1 OF REVISED SHORT PLAT NO. 48-76, APPROVED DECEMBER 28, 1976 AND RECORDED DECEMBER 29, 1976 UNDER AUDITOR'S FILE NO. 848370 IN VOLUME 2 OF SHORT PLATS, PAGE II, RECORDS OF SKAGIT COUNTY, WASHINGTON, BEING A PORTION OF THE NORTHEAST 1/4 OF THE NORTHEAST 1/4 OF SECTION 7, TOWNSHIP 34 NORTH, RANGE 4 EAST, 11N1, DESCRIBED AS FOLLOWS:

COMMENCING AT THE SOUTHWEST CORNER OF TRACT 2 OF SAID REVISED SHORT PLAT;
THENCE NORTH 88°33'54" WEST, ALONG THE SOUTH LINE OF SAID TRACT 1, A DISTANCE OF 88.44 FEET;
THENCE NORTH 1°27'18" EAST, 443.83 FEET TO THE NORTH LINE OF THAT CERTAIN PARCEL, "D", AS DESCRIBED UNDER AUDITOR'S FILE NO. 4403010145, RECORDS OF SKAGIT COUNTY, WASHINGTON, AND THE TRUE POINT OF BEGINNING;
THENCE CONTINUE NORTH 1°27'18" EAST, A DISTANCE OF 155.12 FEET;
THENCE SOUTH 88°33'54" EAST, A DISTANCE OF 88.26 FEET TO THE WEST LINE OF TRACT 2 OF SAID REVISED SHORT PLAT;
THENCE SOUTH 1°26'01" WEST ALONG THE WEST LINE THEREOF, A DISTANCE OF 155.12 FEET;
THENCE NORTH 88°33'54" WEST, A DISTANCE OF 88.32 FEET TO THE TRUE POINT OF BEGINNING.

EXCEPTING FROM ALL OF THE ABOVE ROAD RIGHTS OF WAY, INCLUDING, BUT NOT LIMITED TO, DOCUMENTS RECORDED UNDER SKAGIT COUNTY AUDITOR'S FILE NUMBERS 9510200047 AND 200305200041.

AND ALSO BEING SUBJECT TO AND TOGETHER WITH EASEMENTS, RESERVATIONS, RESTRICTIONS, COVENANTS, LIENS, LEASES, COURT CAUSES AND OTHER INSTRUMENTS OF RECORD.

SITUATE IN THE CITY OF BURLINGTON, COUNTY OF SKAGIT, STATE OF WASHINGTON.

SURVEYOR'S CERTIFICATE

THIS MAP CORRECTLY REPRESENTS A SURVEY MADE BY ME OR UNDER MY DIRECTION IN CONFORMANCE WITH THE REQUIREMENTS OF THE SURVEY RECORDING ACT AT THE REQUEST OF DAN SIMS, LDV BURLINGTON PROPERTIES, LLC, IN AUGUST 2013.

[Signature]
BRUCE G. LISGER, P.L.S., CERTIFICATE NO. 22960 DATE *Sept 20, 2013*
LISGER & ASSOCIATES, PLLC
820 MILWAUKEE ST/PO BOX 1104
MOUNT VERNON WA 98273
PHONE (360) 419-7442
FAX (360) 419-0581
E-MAIL BRUCE@LISGER.COM

NOTES

- INDICATES REBAR SET AND CAPPED WITH YELLOW CAP INSCRIBED LISGER 22960.
O INDICATES EXISTING REBAR OR IRON PIPE FOUND AS NOTED
- DESCRIPTION FOR THIS SURVEY IS BASED UPON DEEDS RECORDED UNDER SKAGIT COUNTY AUDITOR'S FILE NUMBER 199912160109, 9510200047, 9112020004 AND 200305200041.
- FOR ADDITIONAL SURVEY AND SUBDIVISION INFORMATION SEE SHORT PLAT NO. 48-76 REVISED RECORDED UNDER AUDITOR'S FILE NO. 848370, BINDING SITE PLAN NO. BSP-1-03 RECORDED UNDER AUDITOR'S FILE NO. 200306260161, ALL IN RECORDS OF SKAGIT COUNTY AUDITOR AND UNRECORDED SURVEY LABELED EXHIBIT MAP OF OWNERSHIP AND LDV BURLINGTON PROPERTIES, VERN SIMS, LLC, AND GILBERT FAMILY PROPERTIES, LLC, PREPARED BY LEONARD, BOUDINOT AND SKODJE, INC., DATED DECEMBER 2006.
- INSTRUMENTATION: LEICA TCRA1103 THEODOLITE DISTANCE METER
- SURVEY PROCEDURE: STANDARD FIELD TRAVERSE
- MERIDIAN: ASSUMED
- BASIS OF BEARING: WEST LINE OF THE NORTHWEST 1/4 OF THE NORTHEAST 1/4 OF SECTION 7, TOWNSHIP 34 NORTH, RANGE 4 EAST, 11N1, PER LEONARD, BOUDINOT AND SKODJE, INC., MAP REFERENCED IN NOTE NO. 3 ABOVE
BEARING = SOUTH 0°40'32" EAST
- THIS SURVEY WAS PERFORMED AT THE REQUEST OF DAN SIMS, LDV BURLINGTON PROPERTIES, LLC, FOR THE DELINEATION AND STAKING OF THE DESCRIBED PROPERTY, AS SHOWN.
- EXCEPT AS SPECIFICALLY STATED OR SHOWN ON THIS SURVEY MAP THIS SURVEY DOES NOT PURPORT TO REFLECT ALL OF THE FOLLOWING WHICH MAY BE APPLICABLE TO THE SUBJECT REAL ESTATE: EASEMENTS, BUILDING SETBACK LINES, RESTRICTIVE COVENANTS, SUBDIVISION RESTRICTIONS, ZONING OR OTHER LAND-USE REGULATIONS THAT AN ACCURATE AND CURRENT TITLE REPORT MAY DISCLOSE.
- ALL DISTANCES SHOWN HEREON ARE IN FEET.
- THIS SURVEY HAS SHOWN OCCUPATIONAL INDICATORS (BLOCK WALL) AS PER WAC CHAPTER 332-130. LINES OF OCCUPATION MAY INDICATE AREAS FOR POTENTIAL CLAIMS OF UNWRITTEN OWNERSHIP. THIS BOUNDARY SURVEY HAS ONLY SHOWN THE RELATIONSHIP OF LINES OF OCCUPATION TO THE DEEDED LINES OF RECORD. NO RESOLUTION OF OWNERSHIP BASED ON UNWRITTEN RIGHTS HAS BEEN MADE OR IMPLIED BY THIS SURVEY.

SURVEYOR'S NOTE

THIS PROPERTY HAS BEEN SUBJECT TO A SUBSTANTIAL NUMBER OF RECONFIGURATIONS, AN UNRECORDED MAP PREPARED BY LEONARD, BOUDINOT AND SKODJE, INC., DATED DECEMBER 2006 WAS HELPFUL IN DETERMINING THE PROPERTY BOUNDARY. PRIOR TO ANY SALE OR CONVEYANCE, A TITLE REPORT SHOULD BE PREPARED TO CONFIRM THE BOUNDARY AS SHOWN HEREON IS THE TRUE OWNERSHIP FOR THE LDV BURLINGTON PROPERTIES, LLC.

AUDITOR'S CERTIFICATE

FILED FOR RECORD AT THE REQUEST OF LISGER & ASSOCIATES, PLLC.

201309200078
Skagit County Auditor
9/20/2013 Page 1 of 2 3:15PM
\$143.00

[Signature]
SKAGIT COUNTY AUDITOR

[Signature]
DEPUTY

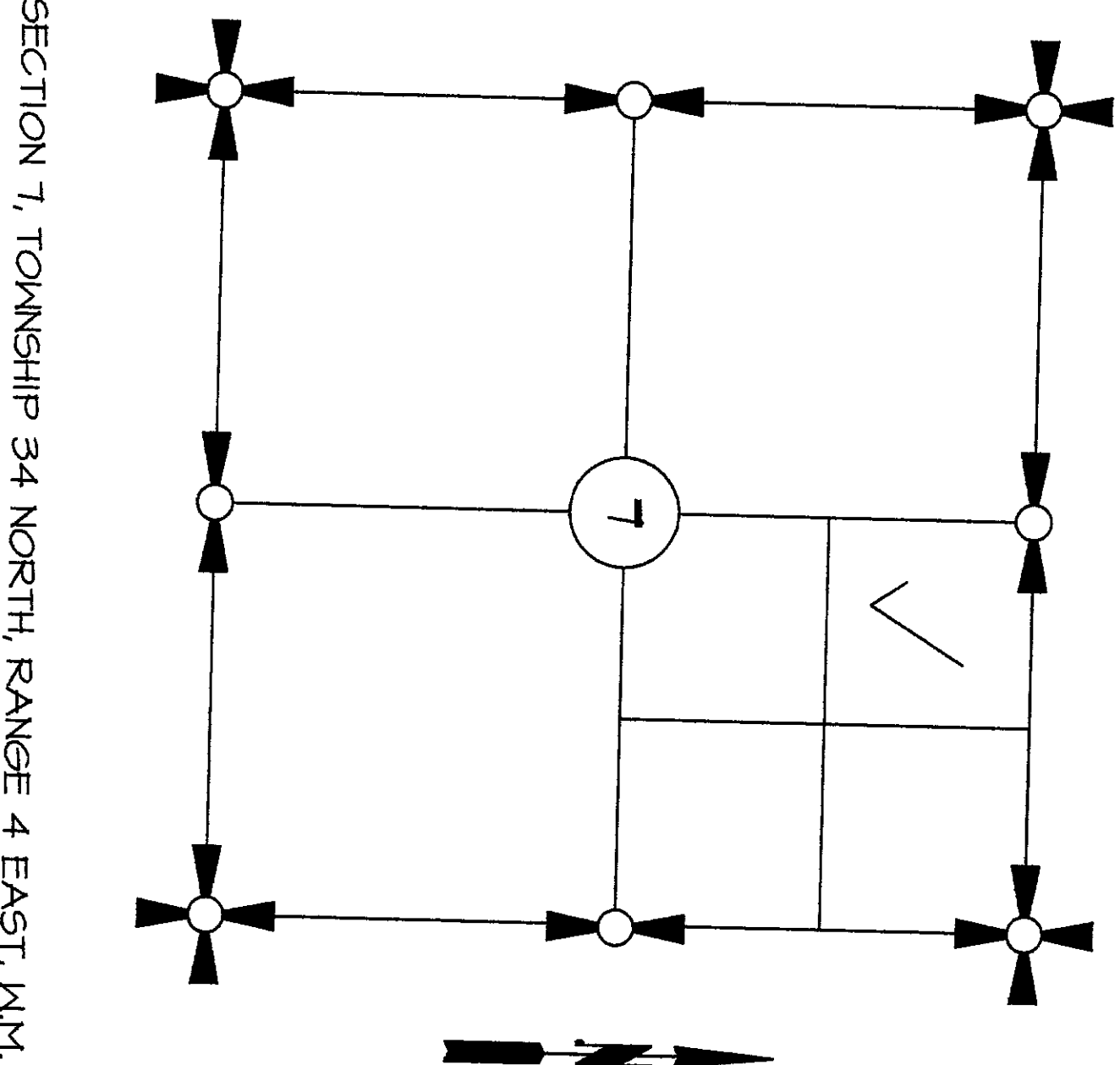

SHEET 1 OF 2

VICINITY MAP
N75

DATE: 09/20/13

SURVEY IN A PORTION OF THE
NW 1/4 OF THE NE 1/4 OF
SECTION 7, T. 34 N., R. 4 E., 11N1,
CITY OF BURLINGTON
SKAGIT COUNTY, WASHINGTON
FOR: LDV BURLINGTON PROPERTIES, LLC

FB: Pg: LISGER & ASSOCIATES, PLLC SCALE:
MERIDIAN: ASSUMED SURVEYING & LAND-USE CONSULTATION 13-04 BDRY/ROS
MOUNT VERNON, WA 98273 360-419-7442

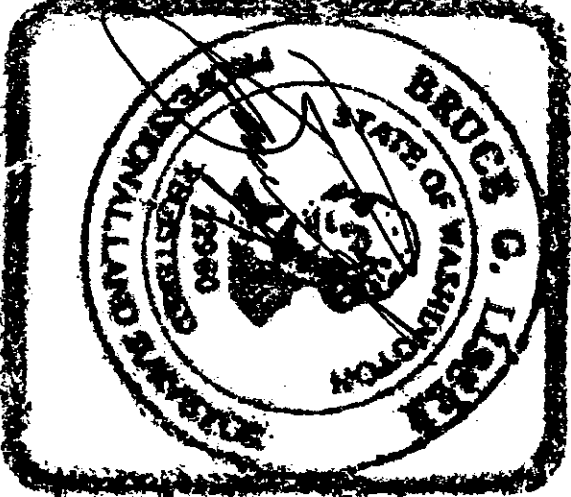

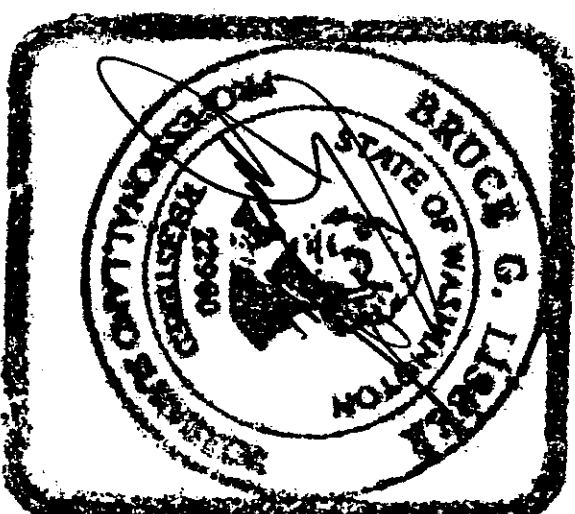
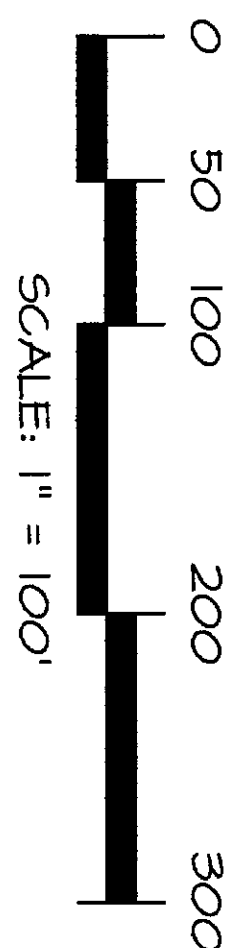

SHEET 2 OF 2

DATE: 09/20/13

SURVEY IN A PORTION OF THE
NW 1/4 OF THE NE 1/4 OF
SECTION 7, T. 34 N., R. 4 E., WM.
CITY OF BURLINGTON
SKAGIT COUNTY, WASHINGTON
FOR: LDV BURLINGTON PROPERTIES, LLC

FB: 341 Pg: 1	LISSEER & ASSOCIATES, PLLC	SCALE: 1"=100'
	SURVEYING & LAND-USE CONSULTATION	
MERIDIAN: ASSUMED	MOUNT VERNON, WA 98273	13-041 BDRY/ROS
	360-419-7442	