

Return to:



201308150100

Skagit County Auditor

\$73.00

8/15/2013 Page

1 of

2 1:56PM

PROTECTED CRITICAL AREA SITE PLAN

This PCA replaces AF# 200308050305

Page 1 of 2

Grantor/Owner: Stephen & Janet Mara

Grantee: PUBLIC

Site Address: 34768 North Shore Drive

Property ID #: P66420

Assessors Tax Account #: 3937-004-002-0002

Legal Description: Sec. 26 Twp. 33 Rng. 06/ Plat Name: Lk Cav Div Lot: 2 Blk: 4

Permit/Activity #: BP13-0385

The PROTECTED CRITICAL AREA (PCA) is to be left undisturbed in its natural state. "With the exception of activities identified as Allowed without Standard review under SCC 14.24.070, any land-use activity that can impair the functions and values of critical areas or their buffers through a development activity or by disturbance of the soil or water, and/or by removal of, or damage to, existing vegetation shall require critical areas review and written authorization pursuant to SCC 14.24." SCC 14.24.060

No clearing, grading, filling, logging or removal of woody material, building, construction or road construction of any kind, planting of non-native vegetation or grazing of livestock is allowed within the PCA areas except as specifically permitted by Skagit County on a case-by-case basis consistent with SCC 14.24.

Representations on this site plan may be approximations only and should not be used for purposes other than for determining general locations of critical areas. Development activities beyond the scope of this plan may require additional studies and approvals.

The above references to "Grantor" and "Grantee" shall not be construed as a transfer of property ownership and are used solely for filing with the County Auditor.

Owner: Janet Mara Date: 8/14/2013

On this day personally appeared before me Janet Mara, to me known to be the individual(s) described in and who executed the within and foregoing instrument, and acknowledged that he/she/they signed the same as his/her/their free and voluntary act and deed, for the uses and purposes therein mentioned.

Given under my hand and seal of office this 14th day of August, 2013

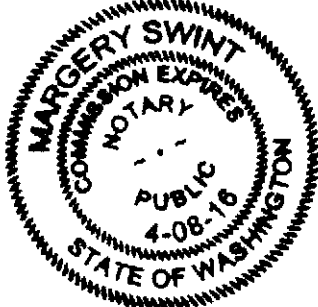

Notary: Margery Swint

Notary Public residing at: Mount Vernon

My Commission Expires: 4/8/16

CRITICAL AREA SITE PLAN

PARCEL: 66415

30 PERCENT COVERAGE
WITHIN 200 FEET OF OHWM

BULKHEAD	59 Sq.Ft.
DECKS & STAIRS	761 Sq.Ft.
HOUSE	1,382 Sq.Ft.
PORCH	75 Sq.Ft.
GRAVELED	2,034 Sq.Ft.
EXIST. SHED	96 Sq.Ft.
TOTAL	4,433 Sq.Ft.

200 FOOT
SHORELINE
AREA

Q NORTH SHORE DRIVE

PERCENTAGE 50.6 %
OF 200 FOOT
SHORELINE AREA 5,768 Sq.Ft.

TREES	TYPE	DIA.
1	CED.	26
2	DOUG.	26
3	DOUG.	25
4	DOUG.	18
5	DOUG.	33
6	CED.	40
7	CED.	37
8	CED.	33
9	CED.	38
10	MAPL.	63
11	DOUG.	38
12	ALDER	20

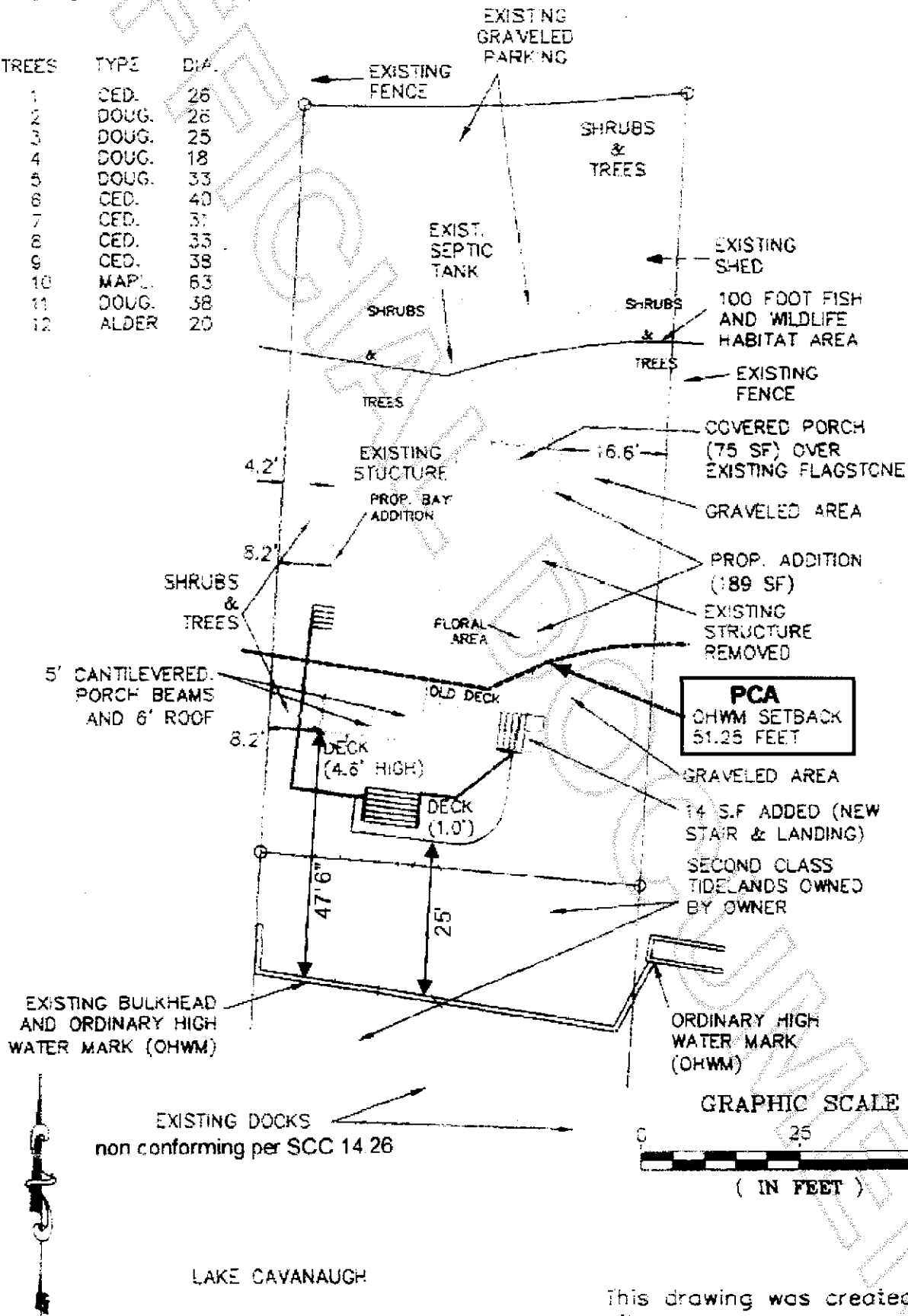

CAU Approved 8/8/13 Leah Mc

Owners: Steve and Jan Mara
Address: 34758 North Shore Dr.
Parcel: P66420
Preparer: Edison Engineering
Date: August, 2012

This drawing was created
with surveyors maps, and
with site measurements by
the architect and engineer.
This drawing is approximate.



201308150100

Skagit County Auditor

\$73.00

8/15/2013 Page

2 of

2 1:56PM