

Return to:

\_\_\_\_\_  
\_\_\_\_\_  
\_\_\_\_\_

Skagit County Auditor  
6/26/2013 Page

1 of

2 1:54PM

\$73.00

**PROTECTED CRITICAL AREA SITE PLAN**

Page 1 of 2

Grantor/Owner: Scott & Sara Lemke

Grantee: PUBLIC

Site Address: 33082 Deer Park Lane

Property ID #: P66874

Assessors Tax Account #: 3939-001-098-0001

Legal Description: Sec. 22 Twp. 33 Rng. 06/ Plat Name: Lk Cav Div 3, Blk 1

Lot: 98

Permit/Activity #: BP13-0255

The PROTECTED CRITICAL AREA (PCA) is to be left undisturbed in its natural state. "With the exception of activities identified as Allowed without Standard review under SCC 14.24.070, any land-use activity that can impair the functions and values of critical areas or their buffers through a development activity or by disturbance of the soil or water, and/or by removal of, or damage to, existing vegetation shall require critical areas review and written authorization pursuant to SCC 14.24." SCC 14.24.060

No clearing, grading, filling, logging or removal of woody material, building, construction or road construction of any kind, planting of non-native vegetation or grazing of livestock is allowed within the PCA areas except as specifically permitted by Skagit County on a case-by-case basis consistent with SCC 14.24.

Representations on this site plan may be approximations only and should not be used for purposes other than for determining general locations of critical areas. Development activities beyond the scope of this plan may require additional studies and approvals.

The above references to "Grantor" and "Grantee" shall not be construed as a transfer of property ownership and are used solely for filing with the County Auditor.

Owner: *[Signature]*

Date: 6/25/13

On this day personally appeared before me, Tracy L. Berg, to me known to be the individual(s) described in and who executed the within and foregoing instrument, and acknowledged that he/she/they signed the same as his/her/their free and voluntary act and deed, for the uses and purposes therein mentioned.

Given under my hand and office this 25<sup>th</sup> day of June, 2013



*Tracy L. Berg*  
Notary Public residing at Mt. Vernon, WA  
My Commission Expires: 09/01/2016

Skagit  
County

# Critical Area Site Plan

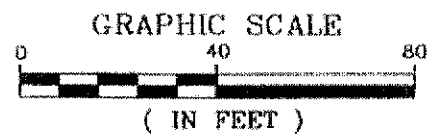
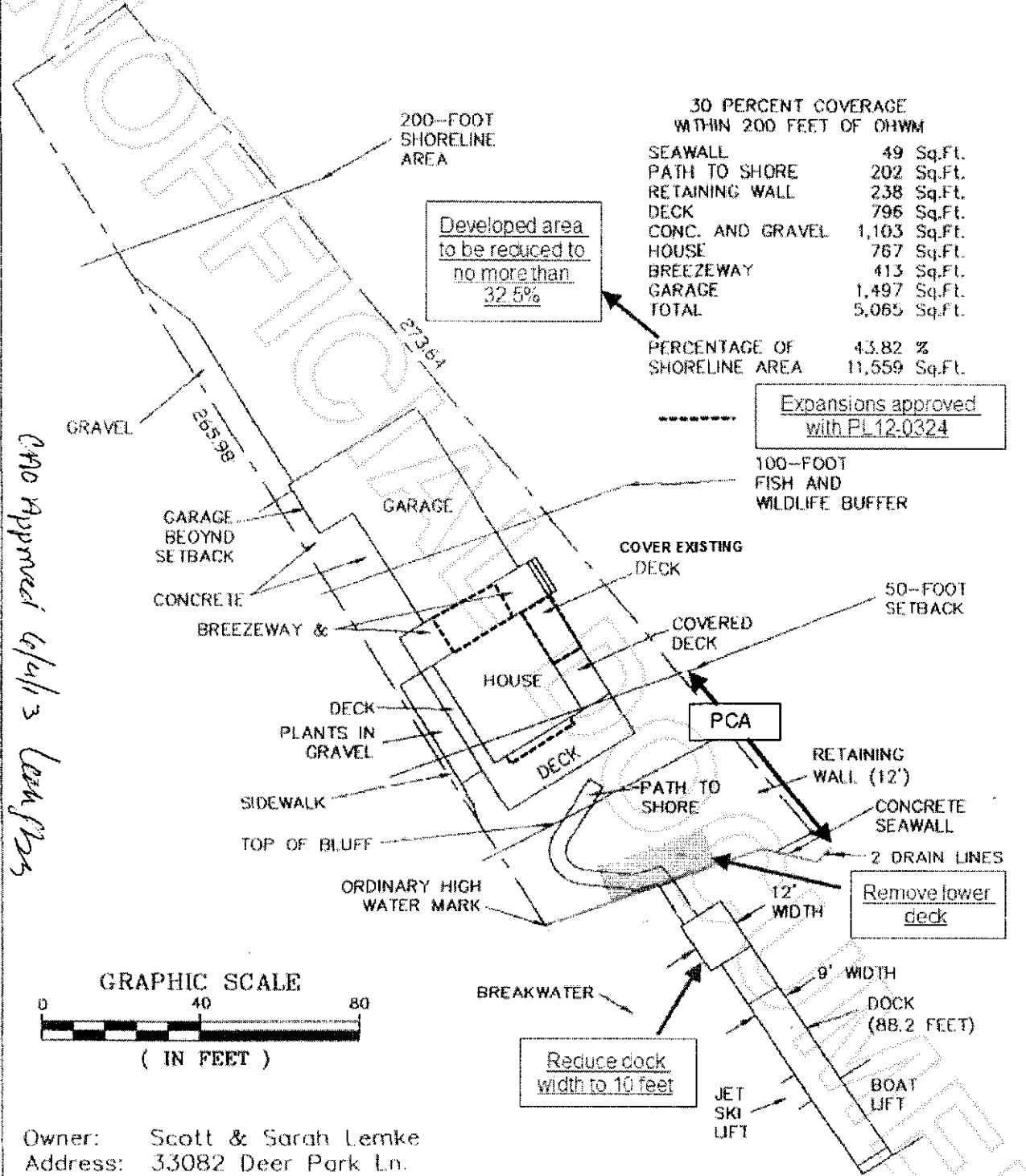

Owner: Scott & Sarah Lemke  
 Address: 33082 Deer Park Ln.  
 Parcel: P66874  
 Permit: PL11-0022  
 Preparer: Edison Engineering  
 Date: April, 2011  
 Revision: July, 2011

Site plan created with compass and tape measure. This map is approximate and not intended to be a survey.

