

Return to:



201302120097
Skagit County Auditor

2/12/2013 Page 1 of 3 3:58PM

Land 7.14.10
144503-06

PROTECTED CRITICAL AREA SITE PLAN
Page 1 of 2

Grantor/Owner: Lucille L Werner

Grantee: PUBLIC

Site Address: 5285 Campbell Lake Road

Property ID #: P19302 Assessors Tax Account #: 340112-3-001-0008

Legal Description: Sec. 12 Twp. 34 Rng. 01/ Plat Name: --- Lot: ---

Permit/Activity #: PL12-0392

The PROTECTED CRITICAL AREA (PCA) is to be left undisturbed in its natural state. "With the exception of activities identified as Allowed without Standard review under SCC 14.24.070, any land-use activity that can impair the functions and values of critical areas or their buffers through a development activity or by disturbance of the soil or water, and/or by removal of, or damage to, existing vegetation shall require critical areas review and written authorization pursuant to SCC 14.24." SCC 14.24.060

No clearing, grading, filling, logging or removal of woody material, building, construction or road construction of any kind, planting of non-native vegetation or grazing of livestock is allowed within the PCA areas except as specifically permitted by Skagit County on a case-by-case basis consistent with SCC 14.24.

Representations on this site plan may be approximations only and should not be used for purposes other than for determining general locations of critical areas. Development activities beyond the scope of this plan may require additional studies and approvals.

The above references to "Grantor" and "Grantee" shall not be construed as a transfer of property ownership and are used solely for filing with the County Auditor.

Owner: Barbara J. Peterson Date: 1/24/2013
Personal Representative of Lucille L Werner

On this day personally appeared before me Barbara J. Peterson, to me known to be the individual(s) described in and who executed the within and foregoing instrument, and acknowledged that he/she/they signed the same as his/her/their free and voluntary act and deed, for the uses and purposes therein mentioned.

Given under my hand and seal of office this 24th day of January, 2013

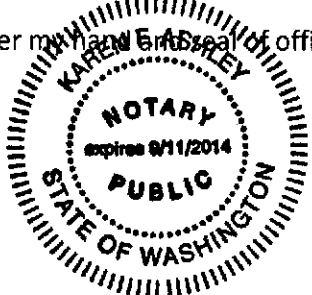

Notary Karen Ashley
Notary Public residing at Sedro Woolley
My Commission Expires 9-11-2014

STATE OF Washington }
County of Skagit , SS:

I certify that I know or have satisfactory evidence that Barbara J. Peterson
signed this instrument, on oath stated that She is
authorized to execute the instrument and acknowledged it as the Personal Representative
of The Estate of Lucille Lillian Werner, deceased, in Skagit to be the free and voluntary act of such
County Superior Court under Probate No. 12-4-00242-8
party for the uses and purposes mentioned in this instrument.

Dated: January 24, 2013

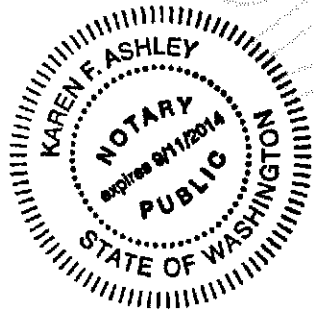

Karen Ashley
Notary Public in and for the State of Washington
Residing at Sedro-Woolley
My appointment expires: September 11, 2014



201302120097
Skagit County Auditor

CNO Approved 1/22/13
Leafless

P19216 & P19301 not investigated for critical areas

SURVEY
AF 8003100026
P19216
P19301

LEGEND

FENCE — x — x — x —

Not investigated for critical areas

Not investigated for critical areas

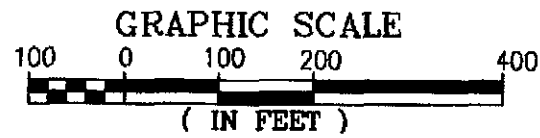
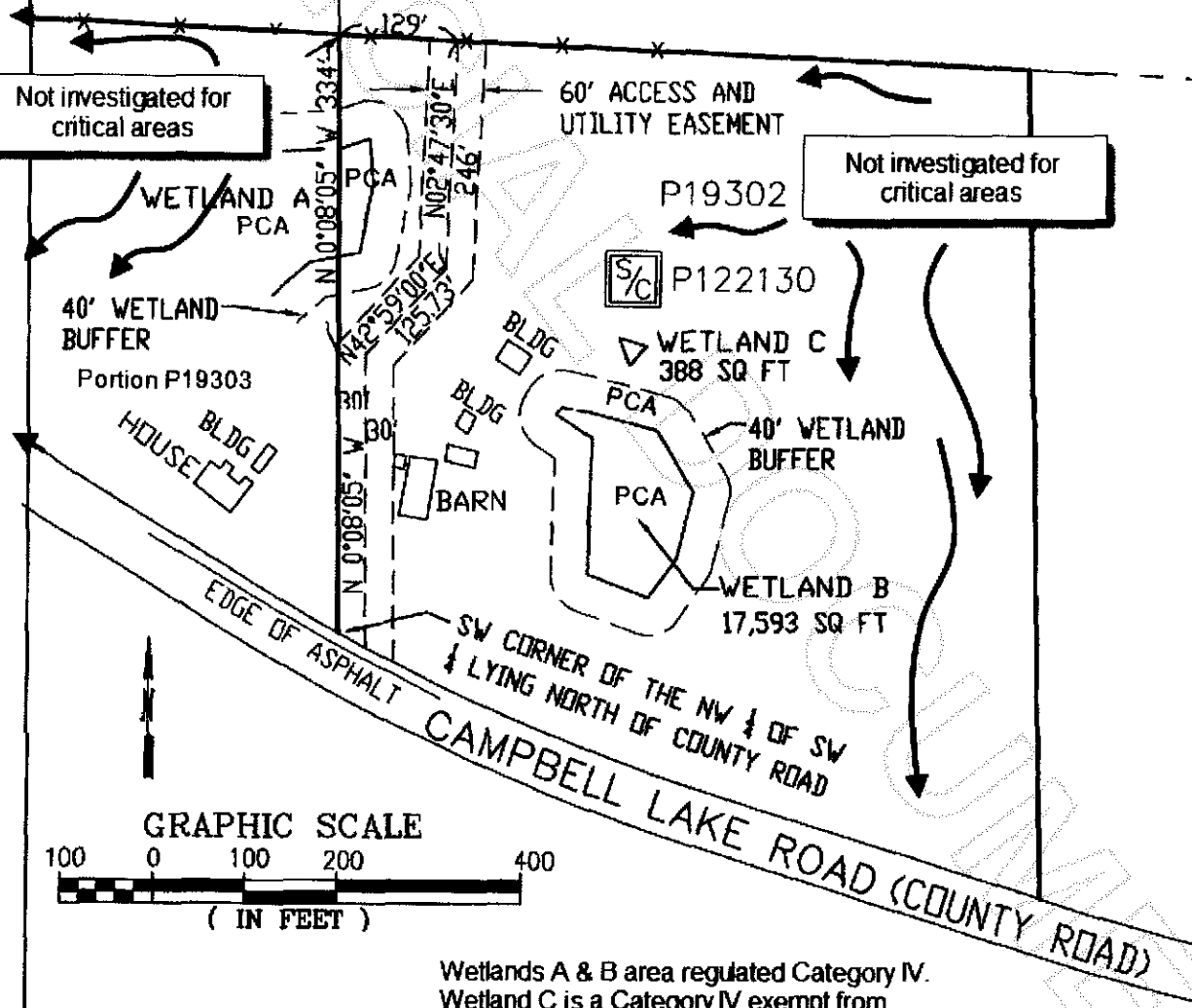

Wetlands A & B area regulated Category IV.
Wetland C is a Category IV exempt from Skagit County regulation.

<p>HERRIGSTAD ENGINEERING & SURVEYING 4320 WHISTLE LAKE ROAD ANACORTES, WA 98221 299-8604</p>	<p>PRIVATE ACCESS AND UTILITY EASEMENT</p> <p>SCALE: NOTED</p>	<p>DATE: JAN 11, 2013</p>
--	--	---------------------------

