

AUDITORS CERTIFICATE

RECORD OF SURVEY AT THE REQUEST OF DALE K. HERRIGSTAD

E 1/4 COR. SEC 18-34-2 6"x 6"
CONCRETE MON. WITH TACK IN LEAD
PLUG SET 12" HIGH AS IDENTIFIED IN
ROS AF #9410140093

201212270102
Skagit County Auditor
12/27/2012 Page 1 of 1 2:20PM

LEGEND

FENCE — X — X — X — X —
STORM SEWER — SD —

N 0°29'18" E
2643.38'

60 FT NON-EXCLUSIVE
ESMT FOR INGRESS,
EGRESS AND UTILITIES
BY AF NO. 9210070043.

LEGAL DESCRIPTION

LOTS 1, THROUGH 4, BLOCK 4, PLAT OF THE TOWNSITE OF GIBRALTER, according to the plat thereof in Volume 1 of Plats, pages 19 and 20, records of Skagit County, Washington.

TOGETHER WITH those portions of the North Half of vacated alley adjacent thereto: the South 20 feet of vacated Carolina Street and the West Half of vacated Dakota Street adjacent thereto as would attached by operation of law.

EXCEPT all that portion thereof conveyed to the county of Skagit for Carolina Street by deed recorded under Auditor's File No. 9506120078.

Situated in Skagit County, Washington.

SUBJECT TO: Restrictions, reservations and easements of record.

NOTES:-

1. THE LEGAL DESCRIPTION FOR THIS SURVEY IS A STATUTORY WARRANTY DEED RECORDED UNDER AUDITOR'S FILE # 9806190139, RECORDS OF SKAGIT COUNTY, WASHINGTON.
2. FOUND MONUMENT AS NOTED. TIED ON NOV. 12, 2012.
3. FOUND 3/4" PIPE.
4. SET REBAR & RED CAP 27807.
5. EQUIPMENT USED: Pentax 323N Total Station.
6. ERROR OF CLOSURE MEETS WASHINGTON STATE SURVEY STANDARDS.
7. SURVEY METHOD: STANDARD FIELD TRAVERSE.
8. BASIS OF BEARINGS: Recorded survey AF #9410140093.
9. THIS SURVEY WAS PERFORMED WITHOUT THE BENEFIT OF A CURRENT TITLE REPORT. THIS SURVEY DOES NOT PURPORT TO SHOW ALL EASEMENTS, RESTRICTIONS, RESERVATIONS, COVENANTS OR CONDITIONS WHICH MAY AFFECT THE PARCELS SHOWN HEREON.
10. THIS IS A BOUNDARY SURVEY ONLY. UTILITIES WERE NOT INVESTIGATED.
11. THIS SURVEY HAS DEPICTED EXISTING OCCUPATIONAL LINES IN ACCORDANCE WITH W.A.C.H. 332.130. THESE OCCUPATIONAL INDICATORS MAY INDICATE A POTENTIAL FOR CLAIMS OF UNWRITTEN TITLE OWNERSHIP. THE LEGAL RESOLUTION OF SUCH CLAIMS HAS NOT BEEN RESOLVED BY THIS BOUNDARY SURVEY.

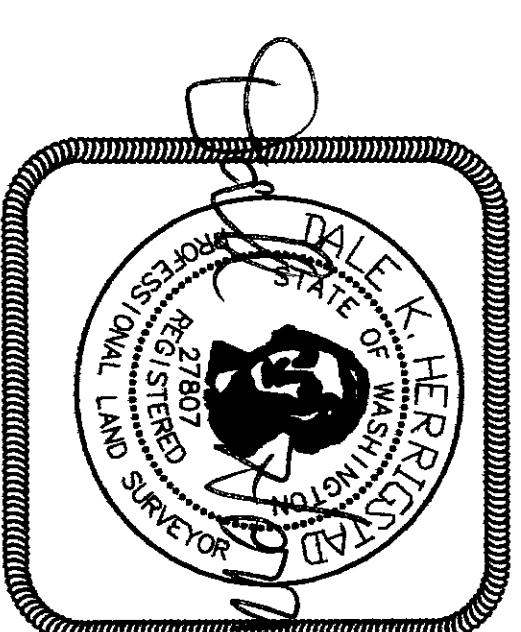

SURVEYOR'S CERTIFICATE

THIS MAP CORRECTLY REPRESENTS A SURVEY MADE BY ME OR UNDER MY DIRECTION IN CONFORMANCE WITH THE REQUIREMENTS OF THE SURVEY RECORDING ACT AT THE REQUEST OF TOM BAKER IN NOVEMBER, 2012.

DALE K. HERRIGSTAD, P.L.S.
Certificate No. 27807
Date 12-27-2012

RECORD OF SURVEY FOR:

Brian Bakke
6970 Carolina Street
Anacortes, WA 98221

SURVEY IN THE SE 1/4 OF SECTION 18,
TOWNSHIP 34 N., RANG. 2 EAST, W.M.
SKAGIT COUNTY, WASHINGTON

HERRIGSTAD ENGINEERING & SURVEYING

4320 Whistle Lake Road, Anacortes, WA 98221 (360) 299-8804

SHEET 1 OF 1

DWG.: J2012-82

DWN BY: DKH

CHECK BY: DH

DATE: Nov. 2012

SCALE: 1"=60'

JOB NO.: 2012-82

NEBRASKA STREET

N 0°29'18" E 400.03' (400.00' PLAT)

CONCRETE MON WITH
BRASS CAP IN CASE

CAROLINA STREET

439.81' (440.00' PLAT)

S 89°25'19" E

445.00'

16 15 14 13 12 11 10 9 8 7 6 5 4 3 2 1

N 0°29'18" E 170.04'

FOUND 3/4" PIPE LOOSE,
12" HIGH, AND BENT APPROX.
3' NORTH OF SET CORNER

SET REBAR AND CAP AND
CYCLONE

VACATED
DAKOTA STREET

N 0°29'18" E 170.06'

439.81' (440.00 PLAT)

S 89°24'46" E

647.65'

CONCRETE MON WITH
PLASTIC CAP IN CASE
(JUDY 7598)

2655.94'

GIBRALTER DRIVE
(FLORIDA STREET)

SOUTHWEST SECTION
CORNER
CONCRETE MON WITH
PLASTIC CAP (JUDY 7598)

GRAPHIC SCALE



(IN FEET)
1 inch = 60 ft.