

Return to:



201211300007

Skagit County Auditor

11/30/2012 Page

1 of

2 9:02AM

PROTECTED CRITICAL AREA SITE PLAN

Page 1 of 2

Grantor/Owner: Stephen & Janet Mara

Grantee: PUBLIC

Site Address: 34771 North Shore Drive

Property ID #: P66415

Assessors Tax Account #: 3937-003-018-0006

Legal Description: Sec. 26 Twp. 33 Rng. 06/Plat Name: Lk Cavanaugh Div 1

Lot: 18 Blk: 3

Permit/Activity #: BP12-0379

The PROTECTED CRITICAL AREA (PCA) is to be left undisturbed in its natural state. "With the exception of activities identified as Allowed without Standard review under SCC 14.24.070, any land-use activity that can impair the functions and values of critical areas or their buffers through a development activity or by disturbance of the soil or water, and/or by removal of, or damage to, existing vegetation shall require critical areas review and written authorization pursuant to SCC 14.24." SCC 14.24.060

No clearing, grading, filling, logging or removal of woody material, building, construction or road construction of any kind, planting of non-native vegetation or grazing of livestock is allowed within the PCA areas except as specifically permitted by Skagit County on a case-by-case basis consistent with SCC 14.24.

Representations on this site plan may be approximations only and should not be used for purposes other than for determining general locations of critical areas. Development activities beyond the scope of this plan may require additional studies and approvals.

The above references to "Grantor" and "Grantee" shall not be construed as a transfer of property ownership and are used solely for filing with the County Auditor.

Owner:

Stephen & Janet Mara

Date:

11/15/2012

On this day personally appeared before me Stephen Mara, to me known to be the individual(s) described in and who executed the within and foregoing instrument, and acknowledged that he/she/they signed the same as his/her/their free and voluntary act and deed, for the uses and purposes therein mentioned.

Given under my hand and seal of office this 15th day of November, 2012

Notary: [Signature]

Notary Public residing at: Kirkland, WA

My Commission Expires: 3-18-2016

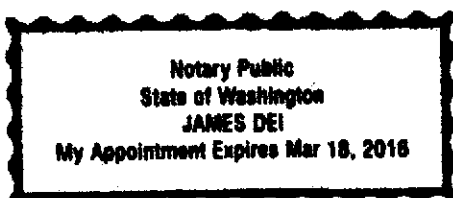

CRITICAL AREA SITE PLAN

CAO Approved 11/28/12
Van Jan

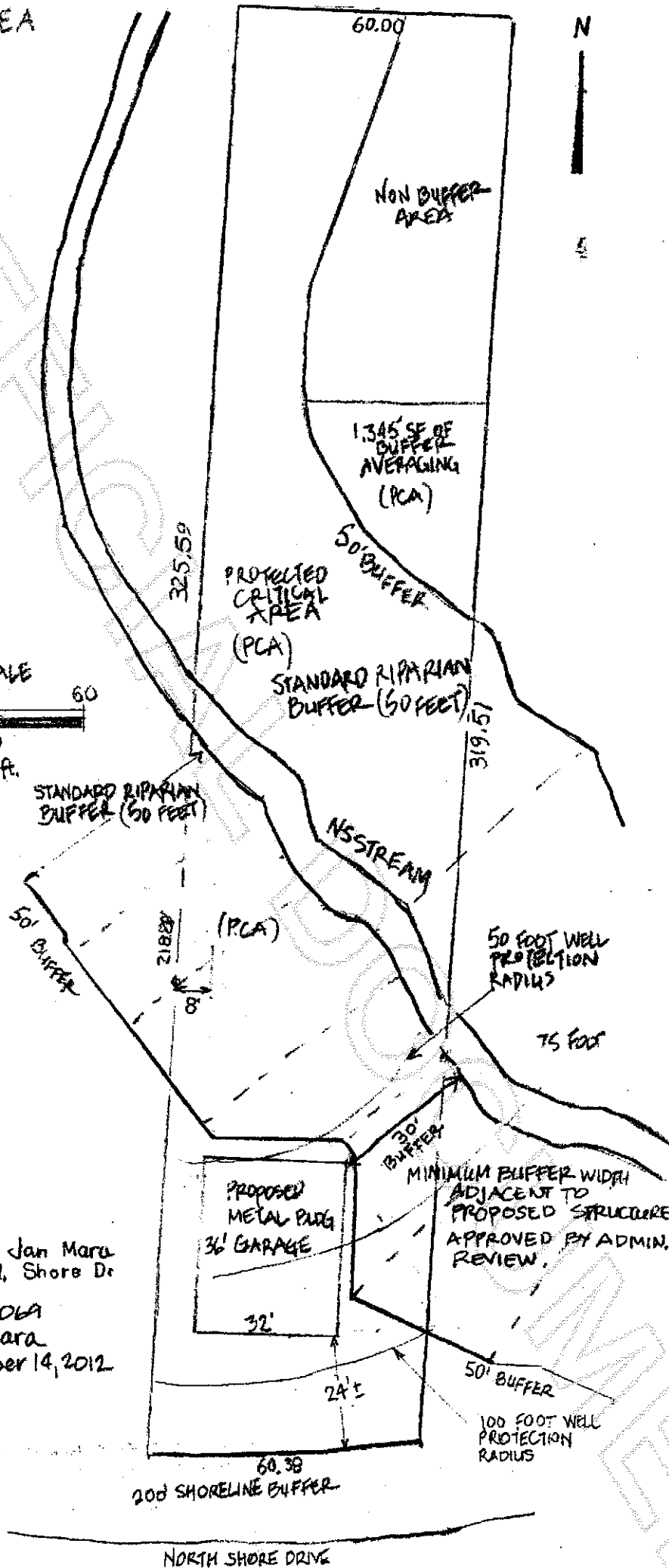
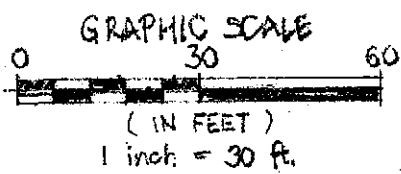

PROJECT DATA

Owner: Steve & Jan Mara
Address: 34771 N. Shore Dr
Parcel: P66415
County File: PL12-06A
Preparer: Steve Mara
Date: November 14, 2012



201211300007

Skagit County Auditor