

ALTMAN PARCEL
PARCEL NO. P15644
LOT 1

S 89°51'55" W
211.87'

90.00'

0+00

0+90

121.87'

2+11.87'

SEE DETAIL "A"

DETAIL "A"

1" = 10'

2+11.87'

LANDSCAPING/
ROCKERY

2+19.43'

2+20.38 0.47' RIGHT

2+23.90 0.53' RIGHT

2+24.95'

ROBINSON PARCEL
PARCEL NO. P10387
LOT 2

SHORT PLAT NO. SPT 90-054
BOOK 10 OF SHORT PLATS, PAGE 177

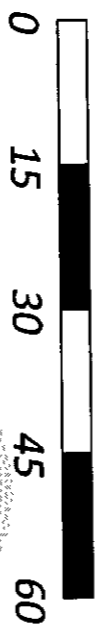

LEGEND

○ SET 5/8" X 24" REBAR WITH 2" ALUMINUM CAP "P15#4266"
● FOUND REBAR AND CAP "LEONARD LS892"
⊙ BASIS OF BEARINGS
— CENTERLINE

N 00°53'04" E (BOB)

0+00

165.03'

BRIDGEWAY DRIVE

60.00'

0+60

AREA OF LANDSCAPING

100.29'

S 89°51'55" W

1+60.29'

TRULL PARCEL
PARCEL NO. P103389
LOT 3

60.00'

206.98'

S 89°51'55" W

142.94'

SCRAGG PARCEL
PARCEL NO. P103390
LOT 4

ASPHALT

ROADWAY

BRIDGEWAY DRIVE

ASPHALT DRIVEWAY

AREA OF LANDSCAPING
OCCUPIED BY MARIA TRULL

0+60.18
9.69' LEFT

1+03.85
8.45' LEFT

1+18.26
0.00' LEFT

1+19.10
6.52' LEFT

SURVEY NOTES

1) THIS SURVEY CONFORMS TO THE REQUIREMENTS SET FORTH IN RCW 58.09 AND WAC 332-190
2) THIS SURVEY FOLLOWS A CONVENTIONAL FIELD TRAVERSE WITH A TRIMBLE S6 TOTAL STATION EQUIPPED WITH AN EDM AND
EXCEEDS THE RELATIVE ACCURACY REQUIREMENTS OF WAC 332-190-090

AUDITOR'S CERTIFICATE

FILED FOR RECORD THIS 11 DAY OF JULY 2012 AT
IN BOOK OF AT PAGE 177
THE REQUEST OF SCHEMMER JOHNSTON, PLLC
DEPUTY COUNTY AUDITOR
7-11-12

SURVEYOR'S CERTIFICATE

THIS MAP CORRECTLY REPRESENTS A SURVEY MADE BY ME OR UNDER MY
DIRECTION IN CONFORMANCE WITH THE REQUIREMENTS OF THE SURVEY
RECORDING ACT AT THE REQUEST OF MARIA TRULL MAY, 2012
DATE 7-11-12

LEGAL DESCRIPTION

LOTS 1, 2, 3 AND 4 OF SHORT PLAT SPT
90-054, RECORDED UNDER AUDITOR'S FILE
NUMBER 9303300011, RECORDS OF SAGIT
COUNTY, WASHINGTON.
SITUATE IN THE COUNTY OF SAGIT, STATE
OF WASHINGTON.

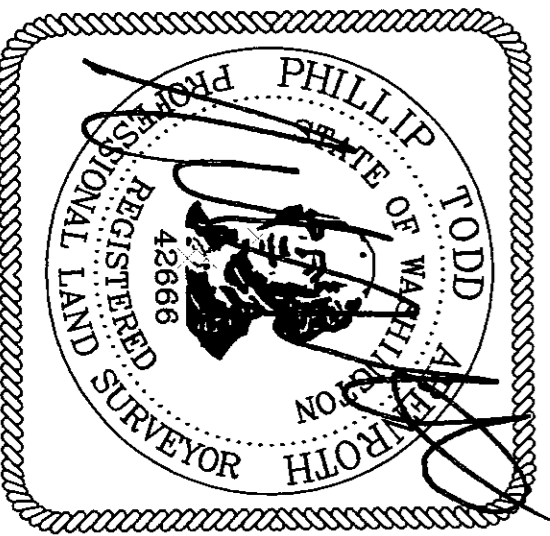

SCHEMMER JOHNSTON, PLLC
3014 COMMERCIAL AVE., SUITE C
ANACORTES, WA 98221

RECORD OF SURVEY IN:
NE 1/4 OF NE 1/4 SEC 24 TWP 34N R 01 E, W.M.

FOR:

MARIA TRULL

15107 BRIDGEWAY DR., ANACORTES, WA

DATE: 06-11-2012

JOB #: 12-032

SCALE: 1" = 30'

SHEET 1 OF 1

24

201207110074
Sagit County Auditor
7/11/2012 Page 1 of 1 3:23PM