

PLAT OF RANCHO SAN JUAN DEL MAR,  
VOLUME 5 OF PLATS PAGE 27

MARINE DRIVE

LOT 27  
PARCEL NO. 68214

MALSED PARCEL  
LOT 28  
PARCEL NO. 68213  
15,545 Sq. Feet ±

LOT 29  
PARCEL NO. 68215

NORTH DEL MAR DRIVE

SET MAG NAIL AND WASHER "LS 42666"  
ON PROPERTY LINE EXTENSION

FOUND 1" IRON PIPE 0.8' DEEP 0.06' NW OF PROPERTY LINE  
AND 1/2" IRON PIPE 0.9' DEEP ON PROPERTY LINE  
PIPES WERE TOUCHING ONE ANOTHER AND WERE ACCEPTED

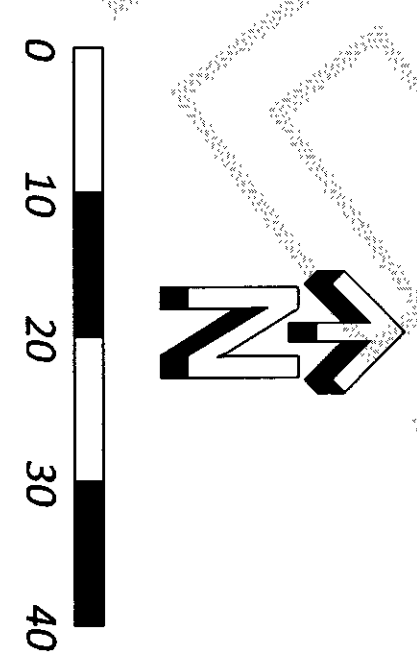

- LEGEND**
- FOUND MARKER PER RECORD OF SURVEY #200608250034
  - SET 5/8" X 24" REBAR WITH 2" ALUMINUM CAP "PLS#42666"
  - FOUND MARKER AS DESCRIBED
  - UTILITY POLE
  - (BOB) BASIS OF BEARINGS

**LEGAL DESCRIPTION**

LOT 28, "RANCHO SAN JUAN DEL MAR, SUBDIVISION NO. 1", AS PER PLAT  
RECORDED IN VOLUME 5 OF PLATS, PAGE 27, RECORDS OF SKAGIT COUNTY,  
WASHINGTON,  
EXCEPT THAT PORTION THEREOF, DESCRIBED AS FOLLOWS:  
BEGINNING AT A POINT THAT LIES ON THE LINE BETWEEN LOTS 27 AND 28 IN SAID  
PLAT AT A DISTANCE OF 26.66 FEET NORTH 49°48' EAST FROM THE WESTERNMOST  
CORNER OF SAID LOT 28;  
THENCE CONTINUE NORTH 40°48' EAST 119.25 FEET;  
THENCE SOUTH 31°11'09" WEST 102.13 FEET;  
THENCE SOUTH 83°23'52" WEST 25.30 FEET TO THE POINT OF BEGINNING.  
SITUATE IN THE COUNTY OF SKAGIT, STATE OF WASHINGTON.

**SURVEY NOTES**  
1) THIS SURVEY CONFORMS TO THE REQUIREMENTS SET FORTH IN RCW 58.09 AND WAC 332-190.  
2) THIS SURVEY FOLLOWS A CONVENTIONAL FIELD TRAVERSE WITH A TRIMBLE S6 TOTAL STATION EQUIPPED WITH AN EDM, AND  
EXCEEDS THE RELATIVE ACCURACY REQUIREMENTS OF WAC 332-190-090

**AUDITOR'S CERTIFICATE**  
FILED FOR RECORD THIS 11 DAY OF JULY 2012 AT  
IN BOOK 11 PAGE 34 AT  
THE REQUEST OF SCHEMMER JOHNSTON, PLLC  
COUNTY CLERK  
*[Signature]*  
COUNTY CLERK  
CERTIFICATE NO. 2-11-12

**SURVEYOR'S CERTIFICATE**  
THIS MAP CORRECTLY REPRESENTS A SURVEY MADE BY ME OR UNDER MY  
DIRECTION IN CONFORMANCE WITH THE REQUIREMENTS OF THE SURVEY  
RECORDING ACT AT THE REQUEST OF SCHEMMER JOHNSTON, PLLC  
DATE 7-11-12  
SIGNATURE *[Signature]*

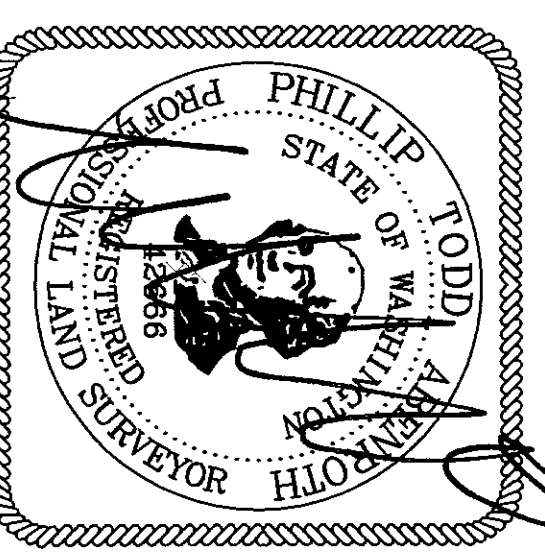

**S** SCHEMMER JOHNSTON, PLLC  
3014 COMMERCIAL AVE., SUITE C  
ANACORTES, WA 98221

RECORD OF SURVEY IN:		FOR:	
NE 1/4 OF SE 1/4 SEC 34 TWP 35N R 01 E, W.M.		DAVE MALSED	
DRAWN: PA		3949 CHIQUITA LN, ANACORTES, WA 98221	
CHECKED BY: JJ		DATE: 06-11-2012	SCALE: 1" = 20'
REVISION: N/A		JOB #: 12-034	SHEET 1 OF 1