



**LEGAL DESCRIPTION  
FOR  
CHARLES MINERICH  
OF  
A 60 FOOT WIDE ACCESS EASEMENT  
THROUGH LOT 3 SHORT PLAT No. 7-90**

October 9, 1996

A non-exclusive easement 60 feet wide for ingress, egress, and utilities, over, under, and through Lot 3 of Short Plat No. 7-90 recorded in Volume 9 of Short Plats at Page 195, records of Skagit County, Washington, the centerline of which is described as follows:

Commencing at the southeast corner of said Lot 3; thence N 00°31'29"E along the east line thereof, a distance of 30.05 feet to the initial point of this centerline description; thence N 86°02'17"W, a distance of 83.34 feet to the point of curvature of a curve to the right having a radius of 148.61 feet; thence along said curve through a central angle of 60°48'33" and an arc length of 157.72 feet to the point reverse curvature of a curve to the left having a radius of 337.78 feet; thence along said curve through a central angle of 32°13'26" and an arc length of 189.97 feet to the point of tangency; thence N 57°27'10"W, a distance of 216.55 feet; thence N 59°48'05"W, a distance of 169.21 feet to a point on the west line of said Lot 3 and the terminal point of this centerline description, said terminal point is 459.21 feet north of the southwest corner of said Lot 3.

Situated in Skagit County, Washington.



201205020039  
Skagit County Auditor

5/2/2012 Page 2 of 2 11:11AM

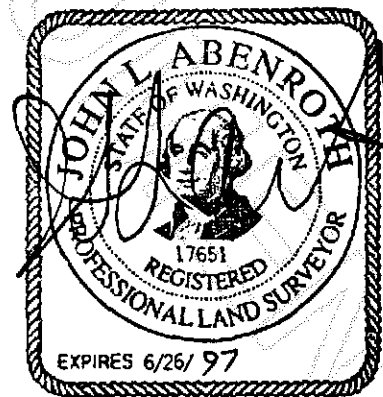

10/11/96