

SURVEY DESCRIPTION

LOT A, REVISED SHORT PLAT NO. 47-80, APPROVED APRIL 7, 1983, AND RECORDED IN VOLUME 6 OF SHORT PLATS, PAGE 54, BEING A PORTION OF THE NORTHEAST 1/4 OF THE SOUTHEAST 1/4 OF SECTION II, TOWNSHIP 34 NORTH, RANGE 1 EAST OF THE WILLAMETTE MERIDIAN.

EXCEPT THOSE PORTIONS CONVEYED TO MIKE BALDWIN AND KARIN BALDWIN, HUSBAND AND WIFE, BY DEED RECORDED MAY 16, 1985, UNDER AUDITOR'S FILE NO. 8505160051, RECORDS OF SKAGIT COUNTY, WASHINGTON.

ALSO EXCEPT THE EAST 60 FEET OF THE NORTH 20 FEET THEREOF;

SUBJECT TO AND TOGETHER WITH EASEMENTS, RESERVATIONS, RESTRICTIONS, COVENANTS, LIENS, LEASES, COURT CAUSES AND OTHER INSTRUMENTS OF RECORD.

SITUATE IN THE COUNTY OF SKAGIT, STATE OF WASHINGTON.

NOTES

- INDICATES REBAR SET AND CAPPED WITH YELLOW CAP INSCRIBED LISSER 22960.
 - INDICATES MONUMENT IN CASE
 - INDICATES EXISTING PIPE OR REBAR FOUND AS NOTED

- DESCRIPTION FOR THIS SURVEY IS BASED UPON WARRANTY DEED RECORDED UNDER SKAGIT COUNTY AUDITOR'S FILE NO. 8706150042, DEED RECORDED UNDER AUDITOR'S FILE NO. 4306180014 UTILIZED AN ABBREVIATED LEGAL DESCRIPTION AND SHOULD BE RE-RECORDED TO CONFORM TO THE CORRECT DESCRIPTION.

- FOR ADDITIONAL SURVEY AND SUBDIVISION INFORMATION SEE SHORT PLAT NO. 47-80 RECORDED UNDER AUDITOR'S FILE NO. 8103210010 AND REVISED SHORT PLAT NO. 47-80 RECORDED UNDER AUDITOR'S FILE NO. 85040710014 AND RECORD OF SURVEY MAP RECORDED UNDER AUDITOR'S FILE NO. 8310120047, ALL IN RECORDS OF SKAGIT COUNTY AUDITOR.

- INSTRUMENTATION: LEICA TCRA1103 THEODOLITE DISTANCE METER

- SURVEY PROCEDURE: STANDARD FIELD TRAVERSE

- MERIDIAN: ASSUMED

- BASIS OF BEARING: FROM MONUMENTED EAST 1/4 CORNER SECTION II, TOWNSHIP 34 NORTH, RANGE 1 EAST, 1/4M, TO FOUND NEWMAN REBAR AT THE NORTHEAST PROPERTY CORNER BEARING = SOUTH 88°14'08" WEST

- THIS SURVEY WAS PERFORMED AT THE REQUEST OF SHARON K. MANN, TRUSTEE, SHARON MANN LIVING TRUST, FOR THE DELINEATION AND STAKING OF THE DESCRIBED PROPERTY, AS SHOWN

- EXCEPT AS SPECIFICALLY STATED OR SHOWN ON THIS SURVEY MAP, THIS SURVEY DOES NOT PURPORT TO REFLECT ANY OF THE FOLLOWING WHICH MAY BE APPLICABLE TO THE SUBJECT REAL ESTATE: EASEMENTS, BUILDING SETBACK LINES, RESTRICTIVE COVENANTS, SUBDIVISION RESTRICTIONS, ZONING OR OTHER LAND-USE REGULATIONS THAT AN ACCURATE AND CURRENT TITLE REPORT MAY DISCLOSE.

- ALL DISTANCES SHOWN HEREON ARE IN FEET.

- THIS SURVEY HAS SHOWN OCCUPATIONAL INDICATORS (FENCE LINE, GRAVEL DRIVE) AS PER IAC CHAPTER 332-130. LINES OF OCCUPATION MAY INDICATE AREAS FOR POTENTIAL CLAIMS OF UNWRITTEN OWNERSHIP. THIS BOUNDARY SURVEY HAS ONLY SHOWN THE RELATIONSHIP OF LINES OF OCCUPATION TO THE DEEDED LINES OF RECORD. NO RESOLUTION OF OWNERSHIP BASED ON UNWRITTEN RIGHTS HAS BEEN MADE OR IMPLIED BY THIS SURVEY.

SURVEYOR'S CERTIFICATE

THIS MAP CORRECTLY REPRESENTS A SURVEY MADE BY ME OR UNDER MY DIRECTION IN CONFORMANCE WITH THE REQUIREMENTS OF THE SURVEY RECORDING ACT, AT THE REQUEST OF SHARON K. MANN, TRUSTEE, SHARON MANN LIVING TRUST, IN MARCH 2012.

BRUCE G. LISSER, P.L.S., CERTIFICATE NO. 22960 DATE 11/24/2012

LISSER & ASSOCIATES, PLLC
320 MILWAUKEE ST/PO BOX 1104
MOUNT VERNON WA 98273
PHONE (360) 414-7442
FAX (360) 414-0581
E-MAIL BRUCE@LISSER.COM

AUDITOR'S CERTIFICATE

FILED FOR RECORD AT THE REQUEST OF LISSER & ASSOCIATES, PLLC.

Sharon K. Mann
SKAGIT COUNTY AUDITOR

Mike Baldwin
DEPUTY

201204020116
Skagit County Auditor
4/2/2012 Page 1 of 2 2:12:16PM

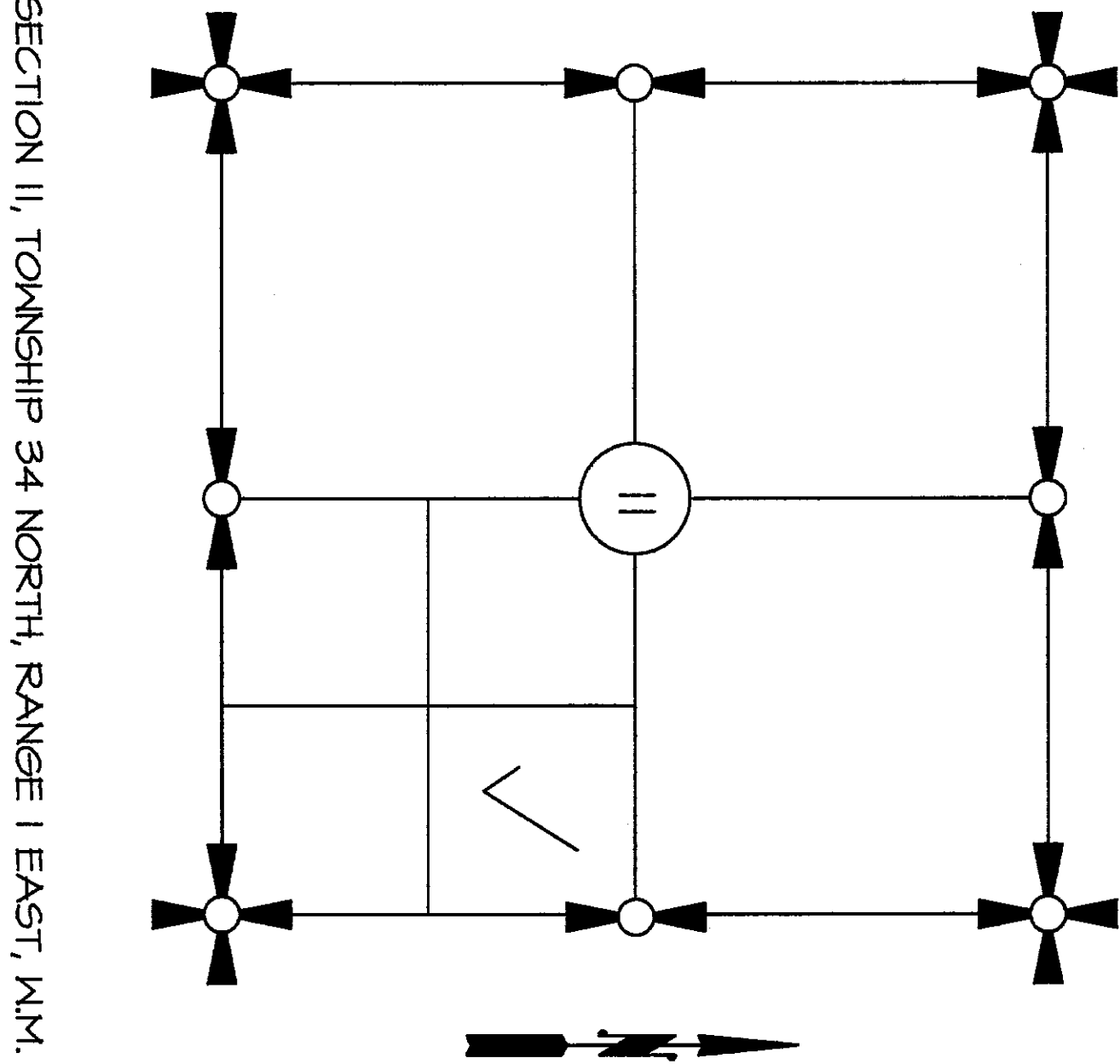

VICINITY MAP
N.T.S.

SHEET 1 OF 2

DATE: 03/03/12

SURVEY IN A PORTION OF THE
NE 1/4 OF THE SE 1/4 OF
SECTION II, T. 34 N., R. 1 E., 1/4M.
SKAGIT COUNTY, WASHINGTON
FOR: SHARON MANN LIVING TRUST

FB: PO: LISSER & ASSOCIATES, PLLC SCALE:
SURVEYING & LAND-USE CONSULTATION
MERIDIAN: ASSUMED MOUNT VERNON WA 98273 360-414-7442 12-012 ROS/DWG.

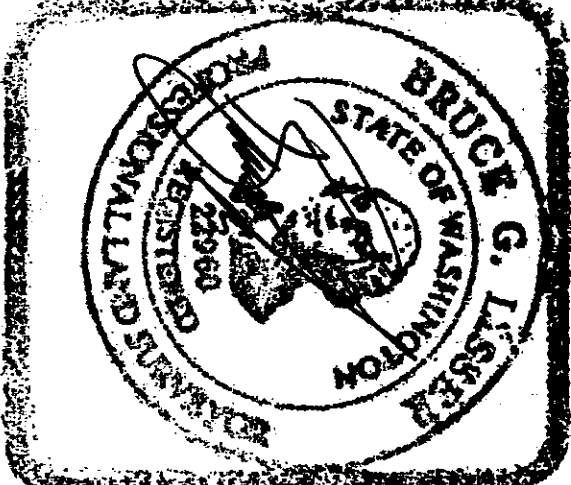

3-30-12

201204020116

Skegitt County Auditor

4/12/2012 Page 2 of 2 2:12:15PM

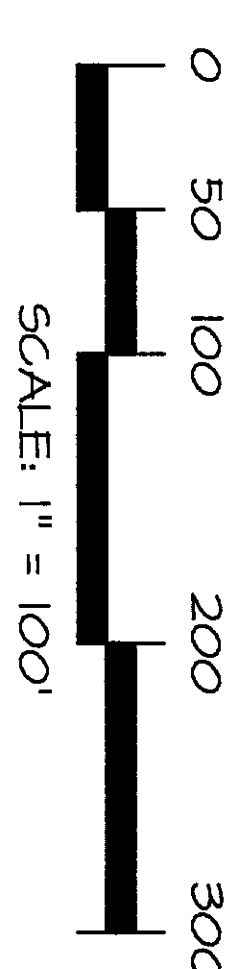
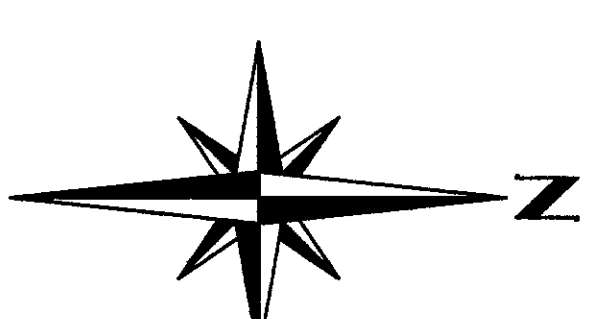

CURVE TABLE			
LINE	DELTA	ARC	RADIUS
C1	33°43'00"	18.68'	133.70'
C2	5°24'56"	24.50'	254.16'

- ① NEWMAN REBAR 0.2' S AND 0.3' E OF CALC
- ② TERENCE REBAR 0.2' S AND 0.3' E OF CALC
- ③ NEWMAN REBAR 0.2' E OF CALC
- ④ LEONARD REBAR 0.1' N AND 0.4' E OF CALC
- ⑤ TERENCE REBAR 0.2' S AND 0.5' E OF CALC
- ⑥ IRON PIPE 0.15' AND 0.4' E OF CALC
- ⑦ TERENCE IRON PIPE 0.1' N OF CALC
- ⑧ 1/2" IRON PIPE 0.2' N AND 0.1' E OF CALC

SHARPE ROAD

LOT B
P-19182

LOT C
SHORT PLAT 47-80 (REV)

LOT D

LOT A
SHORT PLAT 47-80
P-19181

EAST 1/4 CORNER
CONC. MOUNT AT
N. END FENCE
(MARCH 2012)

11 12

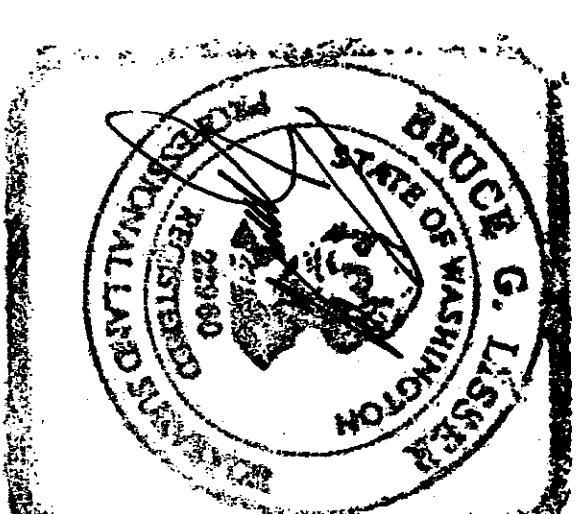

SHEET 2 OF 2

DATE: 03/03/12

SURVEY IN A PORTION OF THE
NE 1/4 OF THE SE 1/4 OF
SECTION 11, T. 34 N., R. 1 E., W.M.
SKEGITT COUNTY, WASHINGTON
FOR: SHARON MANN LIVING TRUST

FB: 331 PG: 66
LISSENER & ASSOCIATES, PLLC
SURVEYING & LAND-USE CONSULTATION
MERIDIAN: ASSUMED
MOUNT VERNON, WA 98275
360-419-1442
SCALE: 1" = 100'
12-012 ROS/DWG.