

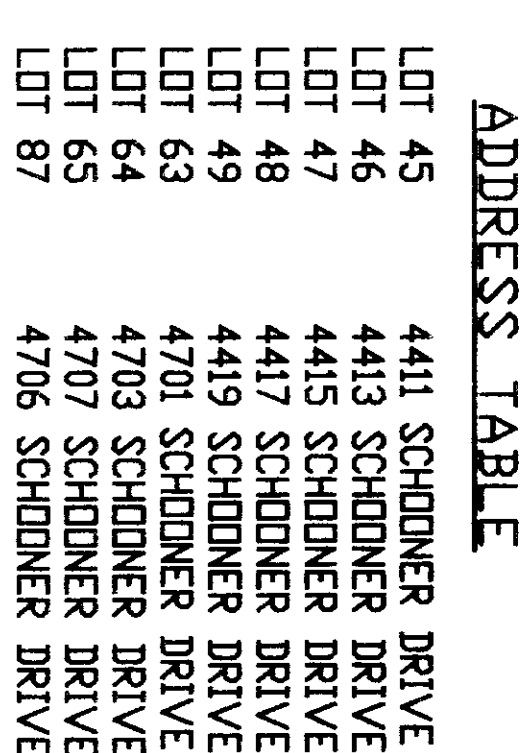



201112080064  
Skagit County Auditor

12/8/2011 Page 2 of 4 4:22PM



CURVE TABLE			
NUMBER	RADIUS	ARC LENGTH	DELTA ANGLE
C1	190.00'	199.80'	64°53.44'
C2	175.00'	167.16'	50°11.50'
C3	175.00'	280.7'	121°21.34'
C4	175.00'	37.75'	52°56.38'
C5	225.00'	207.91'	24°18.09'
C6	125.00'	53.02'	89°59.46'
C7	55.00'	86.39'	57°13.49'
C8	210.00'	209.76'	28°32.30'
C9	275.00'	136.99'	33°34.22'
C10	230.00'	134.77'	

LINE TABLE		
NUMBER	BEARING	DISTANCE
L1	N 02°01'02" W	30.35'
L2	S 23°03'13" E	53.07'
L3	N 01°14'56" W	48.03'

- LEGEND**
1. ● SET RE-BAR AND YELLOW CAP PLS. #27807.
  2. ○ FOUND EXISTING REBAR AND CAP MARKED "SKODJE #19645". VISITED 2-11-2011.
  3. ⊕ FOUND EXISTING MONUMENT IN CASE WITH COVER VISITED 2-11-2011.

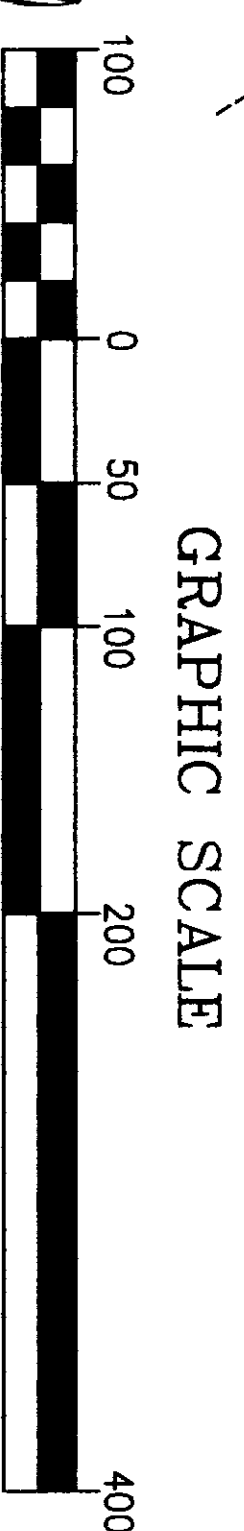

DEVELOPER  
GP ANACORTES LLC  
7 JACKSON WALKWAY  
PROVIDENCE, RHODE ISLAND 02093

**SHEET 2 OF 4**

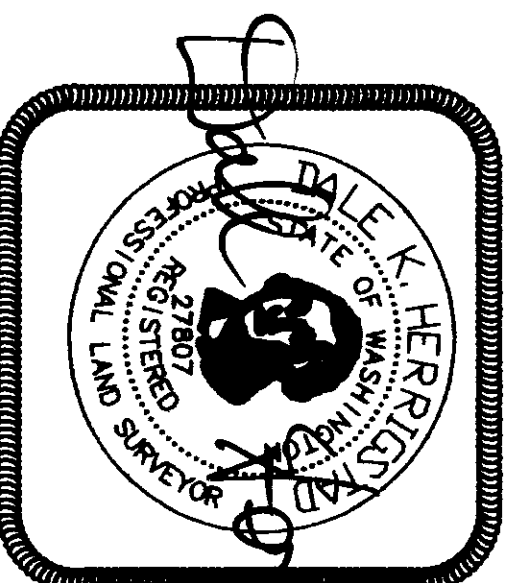

DWN BY: DH

DATE: SEPT 2011

# HERRIGSTAD ENGINEERING & SURVEYING

4320 Whistle Lake Road, Anacortes, WA 98221 (360) 299-8804

SCALE: NOTED  
JOB NO.: 968



PLAT OF SAN JUAN PASSAGE PHASE III  
SECTION 22, TOWNSHIP 35 NORTH, RANGE 1 EAST, W.M.  
CITY OF ANACORTES, WASHINGTON

201112080064  
Skagit County Auditor  
12/8/2011 Page 3 of 4 4:22PM



CURVE TABLE			
NUMBER	RADIUS	ARC LENGTH	DELTA ANGLE
C11	215.00'	3.74'	0°39'48"
C12	215.00'	48.02'	12°47'49"
C13	215.00'	35.03'	9°20'07"
C14	215.00'	35.10'	9°21'14"
C15	215.00'	35.16'	9°22'11"
C16	215.00'	49.28'	13°07'58"
C17	215.00'	19.76'	5°15'57"

- LEGEND
- 1. SET RE-BAR AND YELLOW CAP PLS. #27807.
  - 2. FOUND EXISTING REBAR AND CAP MARKED "SKODJE #19645". VISITED 2-11-2011.
  - 3. FOUND EXISTING MONUMENT IN CASE WITH COVER VISITED 2-11-2011.
  - 4. FOUND EXISTING PK NAIL IN CONCRETE

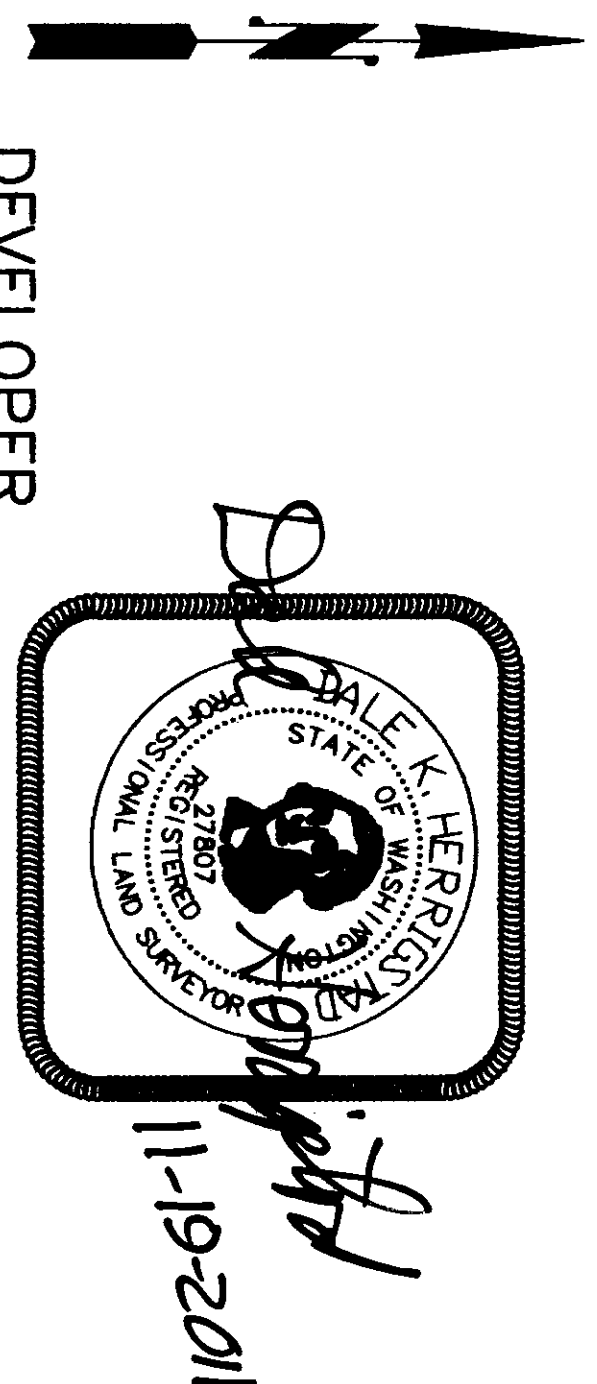
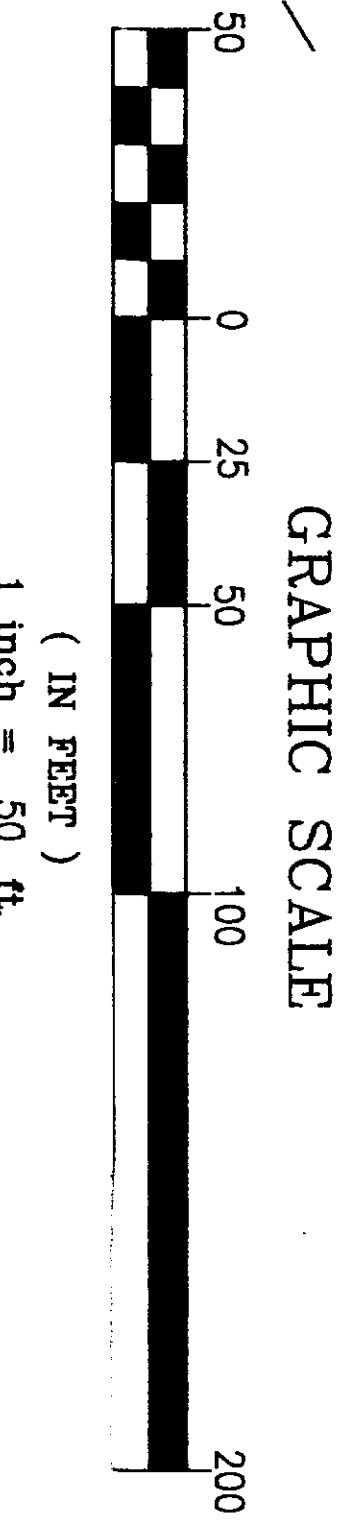

DEVELOPER  
GP ANACORTES LLC  
7 JACKSON WALKWAY  
PROVIDENCE, RHODE ISLAND 02093

SECTION 22, TOWNSHIP 35 NORTH, RANGE 1 EAST, W.M.  
CITY OF ANACORTES, WASHINGTON

12/8/2011 Page 4 of 4 4:22PM

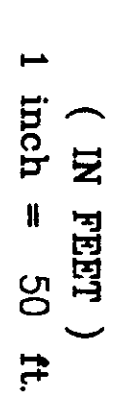

- 

**SHEET 4 OF 4**

DWN BY: DH  
DATE: SEPT 201

SCALE: NOTED  
JOB NO.: 968