



201108040042
Skagit County Auditor

8/4/2011 Page 1 of 2 2:54PM

Return to:

NANCY FOX & NICK ALLISON
652 W. GALER ST.
SEATTLE, WA 98119

PROTECTED CRITICAL AREA SITE PLAN

Page 1 of 2

Grantor/Owner: NANCY FOX & NICK ALLISON

Grantee: PUBLIC

Site Address: 7202 CHANNEL VIEW DRIVE

Property ID #: P66101 Assessors Tax Account #: 3926-009-002-0004

Legal Description: Sec 5W 1/4 Twp. 35N Rng. 2E Plat Name _____ Lot _____

Permit/Activity #: PL11-0155

The PROTECTED CRITICAL AREA (PCA) is to be left undisturbed in its natural state. "With the exception of activities identified as Allowed without Standard review under SCC 14.24.070, any land-use activity that can impair the functions and values of critical areas or their buffers through a development activity or by disturbance of the soil or water, and/or by removal of, or damage to, existing vegetation shall require critical areas review and written authorization pursuant to SCC 14.24." SCC 14.24.060

No clearing, grading, filling, logging or removal of woody material, building, construction or road construction of any kind, planting of non-native vegetation or grazing of livestock is allowed within the PCA areas except as specifically permitted by Skagit County on a case-by-case basis consistent with SCC 14.24.

Representations on this site plan may be approximations only and should not be used for purposes other than for determining general locations of critical areas. Development activities beyond the scope of this plan may require additional studies and approvals.

The above references to "Grantor" and "Grantee" shall not be construed as a transfer of property ownership and are used solely for filing with the County Auditor.

Owner: Nancy Fox  Date: 7-29-11

On this day personally appeared before me NANCY FOX / NICK ALLISON known to be the individual described herein and acknowledged to me that they signed the same as _____ free and voluntary act and deed for the uses and purposes therein mentioned.

Steven G Parrish, Notary Public in and for the State of Washington,
residing at Seattle, WA Date: 7/29/11

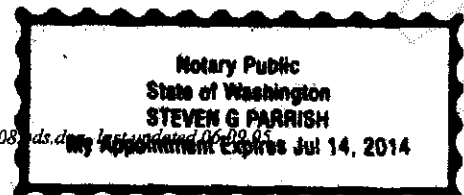

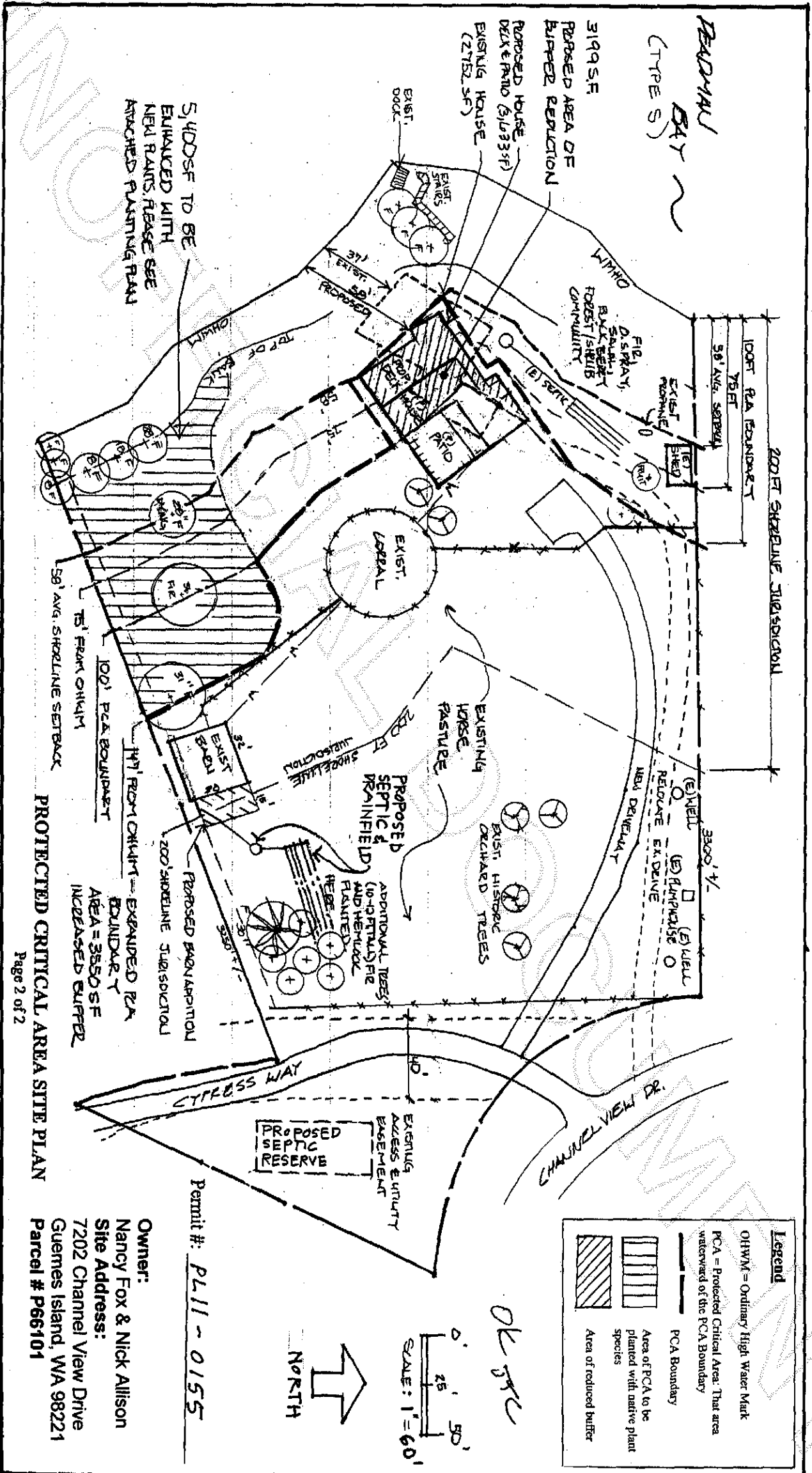

PROTECTED CRITICAL AREA SITE PLAN

Page 2 of 2

Owner:
 Nancy Fox & Nick Allison
Site Address:
 7202 Channel View Drive
 Guemes Island, WA 98221
Parcel # P66101

Permit #: PL11-0155



SCALE: 1" = 60'

OK JRC

Legend

- OHWM = Ordinary High Water Mark
- PCA = Protected Critical Area. That area waterward of the PCA Boundary
- PCA Boundary
- Area of PCA to be planted with native plant species
- Area of reduced buffer



201108040042
Skagit County Auditor