

AUDITORS CERTIFICATE

RECORD OF SURVEY AT THE REQUEST OF DALE K. HERRIGSTAD

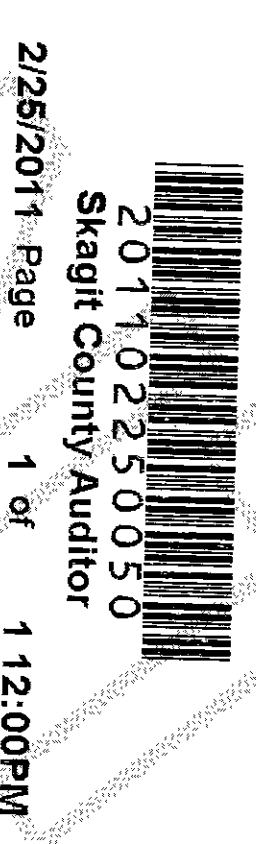

AUDITOR *J. H. HERRIGSTAD* DEPUTY AUDITOR

LEGAL DESCRIPTION

PARCEL A:

LOTS 1 AND 2, BLOCK 10, QUEEN ANNE ADDITION TO THE CITY OF ANACORTES, ACCORDING TO THE PLAT THEREOF, RECORDED IN VOLUME 2 OF PLATS, PAGE 39, RECORDS OF SKAGIT COUNTY, WASHINGTON.

SITUATED IN SKAGIT COUNTY, WASHINGTON.

PARCEL B:

THE WEST HALF OF LOT 4, BLOCK 115, MAP OF THE CITY OF ANACORTES, ACCORDING TO THE PLAT THEREOF RECORDED IN VOLUME 2 OF PLATS, PAGE 4, RECORDS OF SKAGIT COUNTY, WASHINGTON.

SITUATED IN SKAGIT COUNTY, WASHINGTON.

NOTES-

1. THIS SURVEY WAS COMPLETED WITHOUT THE BENEFIT OF A TITLE REPORT AND DOES NOT PURPORT TO SHOW ALL EASEMENTS RESTRICTIONS, RESERVATIONS, PROVISION, COVENANTS OR CONDITIONS WHICH MAY AFFECT THE PARCELS SHOWN HEREON. THE LEGAL DESCRIPTION FOR THIS SURVEY IS A STATUTORY WARRANTY DEED RECORDED UNDER AUDITOR'S FILE #200607060101, RECORDS OF SKAGIT COUNTY, WASHINGTON.
2. SET RE-BAR AND ORANGE CAP P.L.S. #27807.
3. FOUND RE-BAR AND WHITE CAP NEWMAN 4908.
4. FOUND MONUMENT WITH CASE AND COVER.
5. * PK NAIL AS NOTED.
6. FOUND ALUMINUM SURFACE MONUMENT BY F & K.
7. EQUIPMENT USED: Pentax 323N Total Station.
8. MONUMENTS TIED ON 11-04-2010.
9. ERROR OF CLOSURE MEETS WASHINGTON STATE SURVEY STANDARDS.
10. SURVEY METHOD: STANDARD FIELD TRAVERSE.
11. BASIS OF BEARINGS: CENTER LINE OF 11TH STREET BETWEEN "K" AND "L" AVENUES - S 89°26'34" E.
12. LOT AREA = 9,389 SQUARE FEET.
13. ELEVATION AT PROPERTY CORNERS

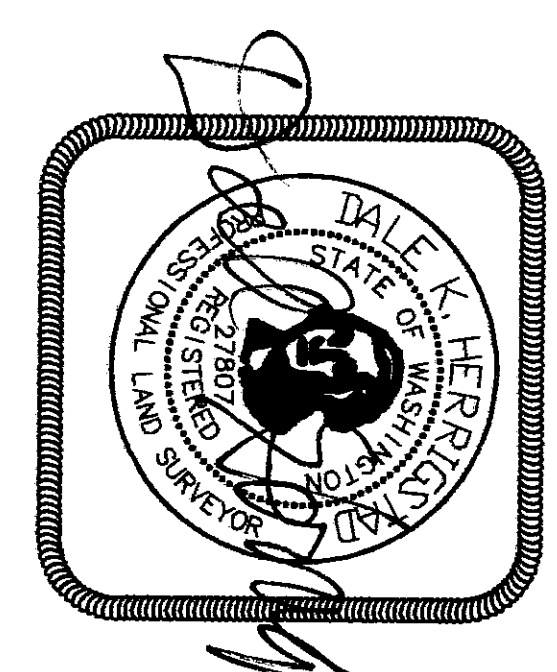

SURVEYORS CERTIFICATE

THIS BOUNDARY SURVEY CORRECTLY REPRESENTS A SURVEY MADE BY ME OR UNDER MY DIRECTION IN CONFORMANCE WITH THE SURVEY RECORDING ACT AT THE REQUEST OF KENT PETERSON OF SKAGIT COUNTY, IN DECEMBER 2010.

DALE K. HERRIGSTAD, P.L.S. *Dale K. Herrigstad*
Certificate No. 27807
Date 2-18-2011

RECORD OF SURVEY

FOR: KENT & KATHY PETERSON
1150 LEFAYETTE STREET
DENVER, CO 80218

A PORTION OF THE NE 1/4 OF
SECTION 24, TOWNSHIP 35 N., RNG. 1 EAST, W.M.
CITY OF ANACORTES, SKAGIT COUNTY, WASHINGTON

HERRIGSTAD ENGINEERING & SURVEYING
4320 Whistle Lake Road, Anacortes, WA 98221 (360) 299-8804

DWG.: J900

DWN BY: DKH

CHECK BY: DKH

DATE: Nov. 2010

SCALE: 1"=30'

JOB NO.: 900

SHEET 1 OF 1

