

Survey in the SE1/4 of the SE1/4 of Section 8, and in the SW1/4 of the SW1/4 of Section 9,  
Twp. 35 N., Rng. 7 E., W.M.

CENTER OF SECTION 8 AS SHOWN ON THE PLAT OF WINDSONG RANCH ESTATES FILED IN A.F.#200804090083.

### Legend

- CONCRETE MONUMENT WITH 2" BRASS CAP MARKED "SKA SURV 17651" IN CASE AND COVER, SET DURING THE SURVEY OF THE PLAT OF WINDSONG RANCH ESTATES FILED IN A.F.#200804090083.

- 1/2" X 18" REINFORCING ROD WITH YELLOW PLASTIC CAP MARKED "SKA SURV 17651" AND WHITE 2" X 2" WITNESS STAKE, SET DURING THE SURVEY OF THE PLAT OF WINDSONG RANCH ESTATES FILED IN A.F.#200804090083, EXCEPT AS NOTED.

- 1/2" X 18" REINFORCING ROD WITH YELLOW PLASTIC CAP MARKED "SKA SURV 17651" SET DURING THE SURVEY FILED IN A.F.#201001280001.

- 1/2" X 18" REINFORCING ROD WITH YELLOW PLASTIC CAP MARKED "SKA SURV 16224" SET DURING THE SURVEY OF SHORT PLAT #20-84 FILED IN A.F.#8410100014.

- SET 1/2" X 18" REINFORCING ROD WITH YELLOW PLASTIC CAP MARKED "SKA SURV 17651" AND WHITE 2" X 2" WITNESS STAKE, EXCEPT AS NOTED.

FOUND 1" IRON PIPE WITH REAL YELLOW CAP AND TACK IN NORTH/SOUTH FENCE LINE ON 1/13/05.

### Legal Description

P42305 THE SOUTHEAST QUARTER OF THE SOUTHEAST QUARTER OF SECTION 8, TOWNSHIP 35 NORTH, RANGE 7 EAST OF THE WILLAMETTE MERIDIAN, EXCEPT COUNTY ROAD RIGHTS OF WAY THEREFOR, AND EXCEPT RAILROAD RIGHT OF WAY.

P42322 THE SOUTHWEST QUARTER OF THE SOUTHWEST QUARTER OF SECTION 9, TOWNSHIP 35 NORTH, RANGE 7 EAST OF THE WILLAMETTE MERIDIAN.

### Notes

1. BASIS-OF-BEARINGS - ASSUMED N01°36'19"W ON THE EAST LINE OF THE SOUTHEAST QUARTER OF SECTION 8.
2. THIS SURVEY WAS ACCOMPLISHED BY FIELD TRAVERSE USING: 5 SECOND OR BETTER DIGITAL ELECTRONIC TOTAL STATION, AND MEETS OR EXCEEDS THE STANDARDS CONTAINED IN WAC 332-130-090.
3. BOUNDARY SURVEYS REFLECT INFORMATION DISCOVERED BY THE SURVEYOR IN THE NORMAL COURSE OF WORK AND DO NOT NECESSARILY SHOW EVERY POSSIBLE CONDITION AFFECTING THE PROPERTY, EASEMENTS, RESTRICTIONS, AND OTHER ENCUMBRANCES MAY EXIST WHICH ARE NOT SHOWN HEREON.
4. THE NORTH, WEST, AND EAST LINES OF P42305 WERE NOT VISITED DURING THIS SURVEY.

CENTER OF SECTION 9 COMPUTED FROM SURVEY OF SHORT PLAT #1-89 FILED IN A.F.#8902160001.

### AUDITOR'S CERTIFICATE



201010270078  
Skagit County Auditor

10/27/2010 Page 1 of 1 3:39PM

J. Yarnagust  
County Auditor or Deputy Auditor

### SURVEYOR'S CERTIFICATE

This map correctly represents a survey made by me or under my direction in conformance with the Survey Recording Act in September 2010 at the request of Verne Ruyle.

John L. Abenroth CERT#17651

Date 10/27/10

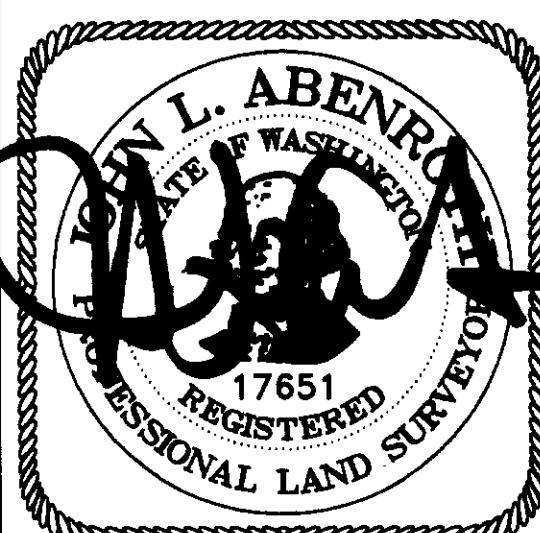

COPYRIGHT 2008 SKAGIT SURVEYORS, INC.

**Skagit Surveyors & Engineers**  
806 Metcalf St., Sedro-Woolley, WA 98284 Phone: (360) 855-2121 FAX: (360) 855-1658

DATE	REVISION	BY	JOB#	DRAWN	CHECKED	DATE	SCALE	SHEET
			210052	srn	jia	060CT10	1" = 200'	1 OF 1

Scale in Feet



Survey for Verne Ruyle