

PLAT MON.
FND. 3/4" PLUGGED
PIPE, SET NAIL IN CTR.
7-1991

DEER PARK LANE
122.65' (P=122.56')
61.33' (P=61.29')
15.32'
78' 13'
61.33' (P=61.29')
15.32'
378.89' (P=378.66')
15.32'

PLAT MON.
FND. 3/4" PLUGGED
PIPE W/TACK 0.2"
BELOW SURFACE
7-1991

LOT 87
LOT 88
LOT 89
LOT 90
110.83'
60.04' (60.00')
N90°00'00"E
98.31'
162.46'
27.09'
136.91'
31.67'
36.16'
30.95'
23.17'

SEE DETAIL

FND. 1/2" BAR &
CAP L.S. 12716
FND. 3/8" BAR &
CAP L.S. 12716
0.41' N. OF EDGE
WATER

LAKE CAVANAUGH

LEGAL DESCRIPTION:
LOT 89, LAKE CAVANAUGH SUBDIVISION DIVISION NO. 3, ACCORDING TO THE PLAT THEREOF
RECORDED IN VOLUME 6 OF PLATS, PAGES 25 THROUGH 31, INCLUSIVE, RECORDS OF SKAGIT
COUNTY, WASHINGTON.

TOGETHER WITH THAT PORTION OF LOT 88 OF SAID PLAT DESCRIBED AS FOLLOWS:
BEGINNING AT THE NORTHEAST CORNER OF SAID LOT 88; THENCE NORTH 78°13' WEST ALONG
THE NORTH LINE THEREOF, 61.32 FEET TO THE NORTHWEST CORNER OF SAID LOT 88;
THENCE SOUTH ALONG THE WEST LINE OF SAID LOT 88, A DISTANCE OF 110.83 FEET;
THENCE EAST 60.00 FEET TO THE EAST LINE OF SAID LOT 88; THENCE NORTH ALONG SAID
EAST LINE 98.31 FEET TO THE POINT OF BEGINNING.
SITUATE IN THE COUNTY OF SKAGIT, STATE OF WASHINGTON.

Survey For: PORTIN GOVT LOT 6, SEC.22, TWP.33N, RGE.6E, W.M.

BARRY OTTERHOLT

Survey By: (360)-435-5551

Cascade Surveying & Engineering, Inc.

P.O. BOX 326, ARLINGTON, WASHINGTON, 98223 (105 EAST DIVISION STREET)

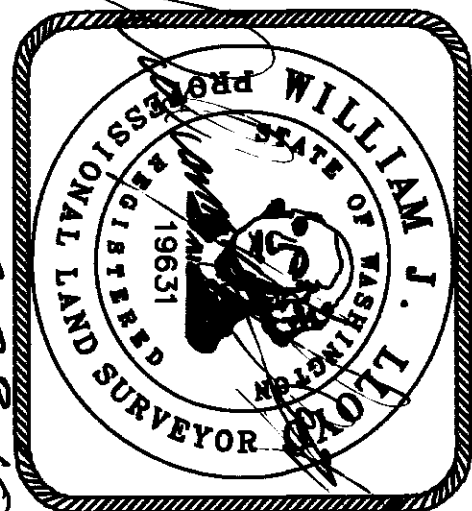

RECORDING CERTIFICATE

FILED FOR RECORD BY:
CASCADE SURVEYING & ENGINEERING, INC.
THIS 4 DAY OF August, 2010 A.D., AT 5
MINUTES PAST 9 O'CLOCK A.M. AND RECORDED UNDER
AUDITOR'S FILE NO. 201008040021, RECORDS OF
SKAGIT COUNTY, WASHINGTON.

J. J. J. J. J.

DEPUTY AUDITOR

AUDITOR'S FILE #

8/4/2010 Page 1 of 1 9:05AM
201008040021
Skagit County Auditor

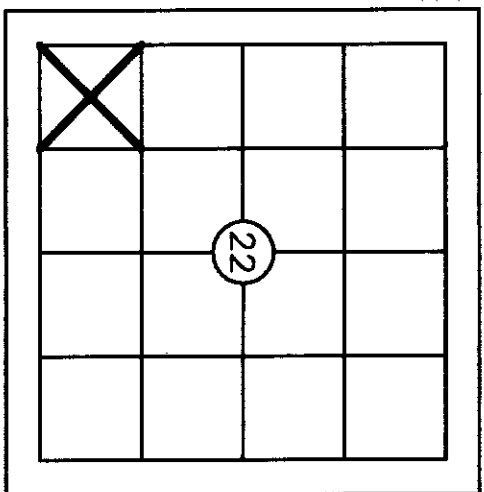

NOTE:
BOUNDARIES ESTABLISHED PER THIS SURVEY MAY
NOT CONFORM TO EXISTING LINES OF OCCUPATION,
AND FENCE LINES AND COULD RESULT IN POSSIBLE
BOUNDARY DISPUTES.

1 inch = 30 ft.
BASIS OF BEARINGS: RECORDED PLAT
THIS SURVEY DOES NOT PURPORT TO SHOW ALL
EASEMENTS OF RECORD OR OTHERWISE.
SURVEY INSTRUMENT USED: 5" TRIMBLE 5605DR200+
SURVEY PROCEDURE: CLOSED TRAVERSE
SURVEY PRECISION: THIS SURVEY EXCEEDS FIELD
TRAVERSE REQUIREMENTS OF WAC 332-130-090

LEGEND:
○ DENOTES 1/2" X 24" REBAR & CAP #S19631
○ SET THIS SURVEY UNLESS OTHERWISE NOTED
○ DENOTES FOUND PLAT MONUMENT

NOTE:
THIS SURVEY REPLACES AND SUPERCEDES THAT
SURVEY RECORDED UNDER AUDITOR'S FILE NO.
201007190094, RECORDS OF SKAGIT COUNTY,
WASHINGTON.

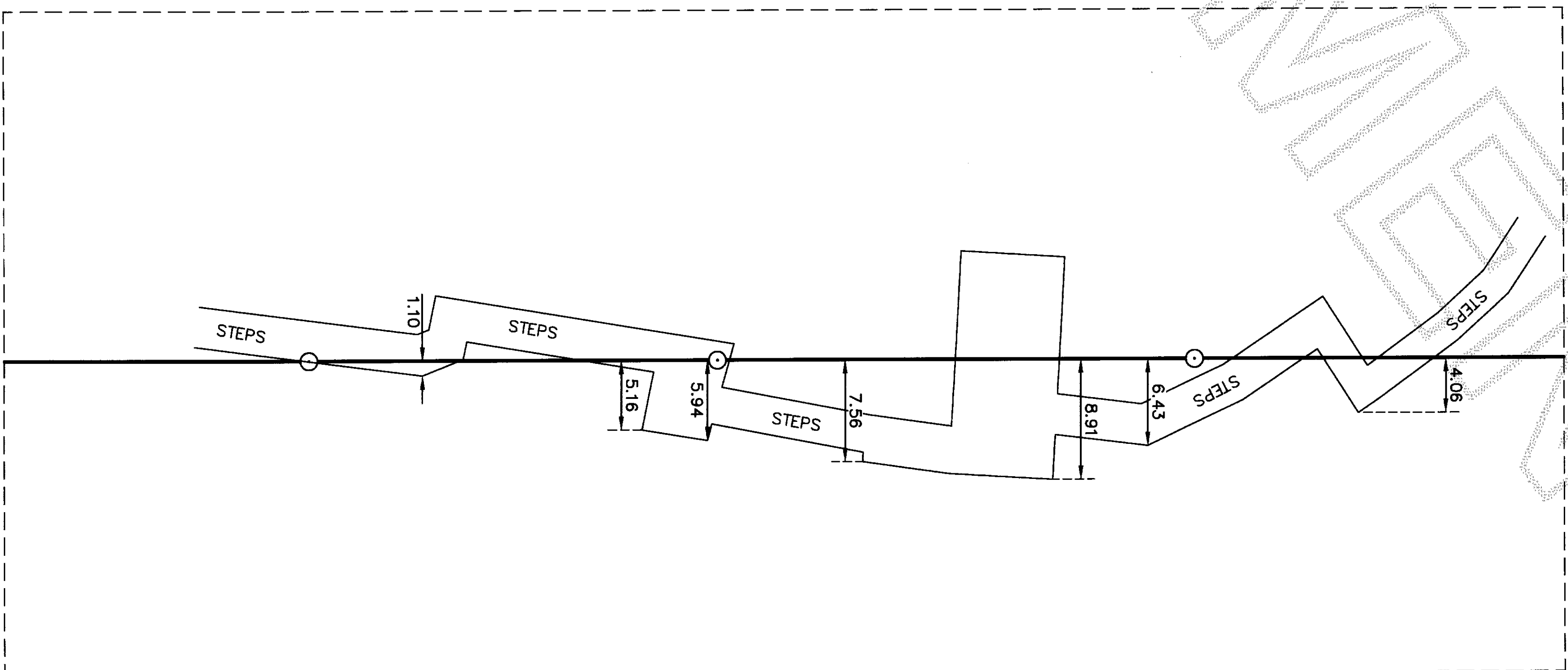

SURVEYOR'S CERTIFICATE

THIS MAP CORRECTLY REPRESENTS A SURVEY MADE BY ME
OR UNDER MY DIRECTION IN CONFORMANCE WITH THE
REQUIREMENTS OF THE SURVEY RECORDING ACT, AT THE
REQUEST OF BARRY OTTERHOLT THIS 22ND DAY
OF JULY, 2010.

REGISTERED LAND SURVEYOR

L.S. NO 19631

SCALE: 1"=30'
DRAWN BY: LAF
CHECKED BY: WJL
DATE: 7/22/2010
JOB #: 18916
F.B. #: SK. 61