



200909180004

Skagit County Auditor

9/18/2009 Page 1 of 12 9:13AM

When recorded return to:

Craig Sjostrom  
411 Main Street  
Mount Vernon, Washington 98273

***Quitclaim Deed***  
(Boundary Line Adjustment)

**Grantor:** (1) Nohea A. De La Fuente  
(2) Lola Lang

**Grantee:** Lola Lang

**Legal Description:** Ptn SE ¼ NW ¼ 34-34-4 lyg S Little Mtn Rd & E haul rd

**Assessor's Property Tax Parcel or Account Nos.:** P29718, 29694, 29695, 29707, 29708, 29716.

**Reference Nos of Documents Assigned or Released:** N/A

THIS INDENTURE, made this 21<sup>st</sup> day of January, 2008<sup>9</sup>, between Nohea De La Fuente, as her separate property, & Lola Lang, as her separate property, each as to an undivided ½ interest, Grantor, and Lola Lang, as her separate property, Grantee.

***Recitals***

- a. Grantor is the owner of the property described in the attached Exhibit A.
- b. Grantee is the owner of the property described in the attached Exhibit B, which is contiguous to Grantor's property.
- c. The parties wish to adjust the boundaries between their respective lots, with a portion of Grantor's property, described in the attached Exhibit C, to be incorporated into Grantee's property.

- d. The adjusted description of Grantor's property is set forth in the attached Exhibit D.
- e. The adjusted description of Grantee's property is set forth in the attached Exhibit E.

**Conveyance**

THEREFORE, for and in consideration of the said boundary line adjustment, and for no monetary consideration, grantor does hereby QUIT CLAIM to the grantee all of their interest in the real property lying and being in the county of Skagit and State of Washington, and described in the attached Exhibit C.

This boundary adjustment is not for the purposes of creating an additional building lot.

DATED: Jan 21, 2008<sup>9</sup>

SKAGIT COUNTY WASHINGTON  
REAL ESTATE EXCISE TAX

2855

SEP 18 2009

Amount Paid \$ 0  
By MF Skagit Co. Treasurer Deputy

Nohea De La Fuente  
NOHEA De La FUENTE

Eola Lang  
EOLA LANG

Idaho  
STATE OF WASHINGTON )  
Bonner :SS  
COUNTY OF SKAGIT )

On this day personally appeared before me Nohea De La Fuente, to me known to be one of the individuals described in and who executed the within and foregoing instrument, and acknowledged that she signed the same as her free and voluntary act and deed for the uses and purposes therein mentioned.

GIVEN under my hand and official seal this 21<sup>st</sup> day of January, 2008<sup>9</sup>

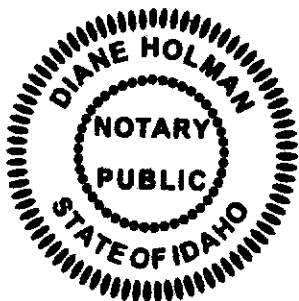

Diane Holman  
NOTARY PUBLIC in and for the State of Washington,  
residing at London Idaho  
My commission expires: 8-26-13  
Name: Diane Holman



200909180004

Skagit County Auditor

STATE OF WASHINGTON )  
 )  
 ) :ss  
COUNTY OF SKAGIT )

On this day personally appeared before me Lola Lang, to me known to be one of the individuals described in and who executed the within and foregoing instrument, and acknowledged that she signed the same as her free and voluntary act and deed for the uses and purposes therein mentioned.

GIVEN under my hand and official seal this 2<sup>nd</sup> day of Feb., 2009

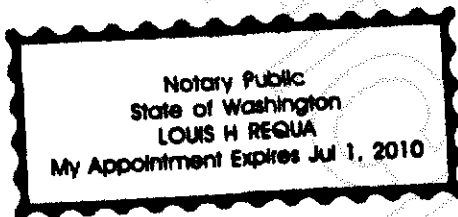

Louis H. Regua  
NOTARY PUBLIC in and for the State of Washington,  
residing at Sedro-Woolley  
My commission expires: July 1, 2010  
Name: Louis H. Regua

**BOUNDARY ADJUSTMENT**  
Reviewed and approved  
in accordance with S.C. ~~Code~~ **Chapter 14.18**  
Joan Roeder  
**SKAGIT CO. PLANNING & PERMIT CNTR**  
Date: 1/6/2009



200909180004  
Skagit County Auditor

**skagit**  
**Surveyors & Engineers**

806 Metcalf St., Sedro-Wooiley, WA 98284 Phone: (360) 855-2121 FAX: (360) 855-1658

LEGAL DESCRIPTION  
FOR  
MARY JOHNSON  
ASSESSOR'S PARCEL P29718  
BEFORE BOUNDARY LINE ADJUSTMENT

*EXHIBIT A*

November 5, 2008

That portion of the southeast quarter of the northwest quarter of Section 34, Township 34 North, Range 4 East, W.M. lying south of Little Mountain Road and east of the haul road shown on Washington State Department of Transportation Sundry Site Plan - Conway Jct to Jct. P.S.H. No.1 North of Burlington - Pit Sites, approved February 10, 1953;

EXCEPT the west 680 of the south 330 of the southeast quarter of the northwest quarter of said Section 34;

AND EXCEPT that portion described as follows:

Commencing at the northeast corner of the northwest quarter of said Section 34; thence S 01°21'46" W along the east line of said northwest quarter, a distance of 1521.31 feet; thence N 88°34'14" W, a distance of 867 feet to the intersection of the south line of the Little Mountain Road and a fence and the point of beginning of this description; thence S 03°47'05" E, a distance of 575.96 feet to the thread of a creek; thence N 87°18'25" E, a distance of 110 feet to a fence; thence N 03°47'05" W, a distance of 521.59 feet to the southerly right of way line of the Little Mountain Road; thence northwesterly along the said south line to the point of beginning of this description;

AND EXCEPT the east 30 feet of that portion of the southeast quarter of the northwest quarter of said Section 34 lying south of the Little Mountain Road.

Situate in Skagit County, Washington.

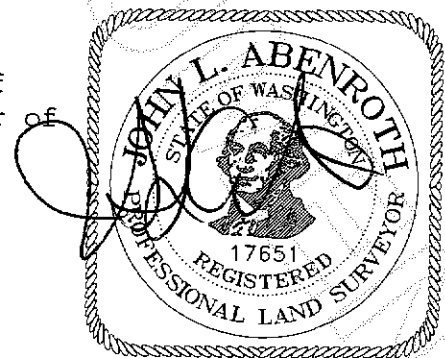

*12/2/08*





806 Metcalf St., Sedro-Woolley, WA 98284 Phone: (360) 855-2121 FAX: (360) 855-1658

LEGAL DESCRIPTION

EXHIBIT B

FOR

MARY JOHNSON

LOLA LANG PROPERTY

BEFORE BOUNDARY LINE ADJUSTMENT

November 5, 2008

Parcel A

That portion of the northwest quarter of the northwest quarter of Section 34, Township 34 North, Range 4 East, W.M. described as follows:

Beginning at the northeast corner of said northwest quarter of the northwest quarter; thence running west along the north line thereof, a distance of 660 feet; thence south at right angles, a distance of 660 feet; thence east parallel with the north line of said subdivision, a distance of 260 feet; thence south to the northerly line of the county road; thence southeasterly along said road to the east line of the northwest quarter of the northwest quarter; thence north to the point of beginning.

Parcel B

That portion of the southeast quarter of the northwest quarter of Section 34, Township 34 North, Range 4 East, W.M. described as follows:

Beginning at a point on the north line of said southeast quarter of the northwest quarter, a distance of 800 feet west of its northeast corner; thence west along the north line of said southeast quarter of the northwest quarter, a distance of 312 feet, more or less, to the county road as established on October 30, 1938; thence easterly along said road, a distance of 368 feet, more or less, to a point south of point of beginning; thence north, a distance of 191 feet, more or less, to the point of beginning;

TOGETHER WITH the northeast quarter of the northwest quarter of said Section 34;

EXCEPT county road rights of way.

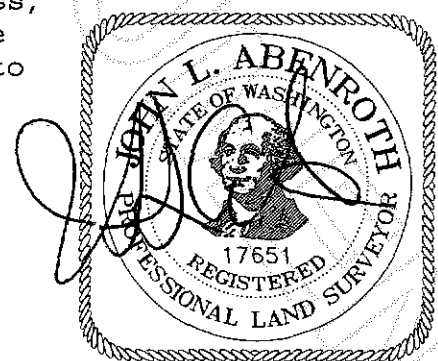

200909180004  
Skagit County Auditor

12/2/08



806 Metcalf St., Sedro-Woolley, WA 98284 Phone: (360) 855-2121 FAX: (360) 855-1658

**Parcel C**

That portion of the west half of the west half of the west half of the northeast quarter of Section 34, Township 34 North, Range 4 East, W.M. lying north of the Little Mountain Road.

**Parcel D**

That portion of the southeast quarter of the northwest quarter of Section 34, Township 34 North, Range 4 East, W.M. lying northerly of the County road as it existed on August 27, 1935;

EXCEPT that portion of said premises described as follows:

Beginning at a point on the quarter section line 800 feet west of the northeast corner of said southeast quarter of the northwest quarter; thence west along said quarter section line, a distance of 312 feet to the county road as it existed on October 5, 1935; thence easterly along said road, a distance of 368 feet, more or less, to a point 191 feet south of the point of beginning; thence north, a distance of 191 feet to the point of beginning.

AND EXCEPT county road.

Situate in Skagit County, Washington.

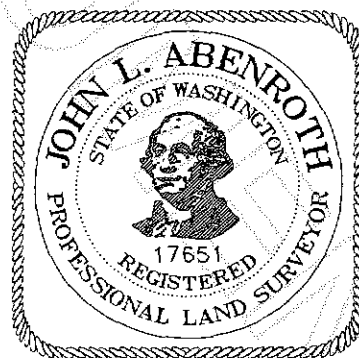

200909180004  
Skagit County Auditor



806 Metcalf St., Sedro-Woolley, WA 98284 Phone: (360) 855-2121 FAX: (360) 855-1658

LEGAL DESCRIPTION  
FOR

EXHIBIT C

MARY JOHNSON

PORTION OF ASSESSOR'S PARCEL P29718  
TO BE AGGREGATED WITH LOLA LANG PROPERTY  
NORTH OF THE LITTLE MOUNTAIN ROAD  
November 5, 2008

That portion of the southeast quarter of the northwest quarter of Section 34, Township 34 North, Range 4 East, W.M. lying south of Little Mountain Road and east of the haul road shown on Washington State Department of Transportation Sundry - Site Plan Conway Jct to Jct. P.S.H. No.1 North of Burlington - Pit Sites, approved February 10, 1953;

EXCEPT the west 680 of the south 330 of the southeast quarter of the northwest quarter of said Section 34;

AND EXCEPT that portion described as follows:

Commencing at the northeast corner of the northwest quarter of said Section 34; thence S 01°21'46" W along the east line of said northwest quarter, a distance of 1521.31 feet; thence N 88°34'14" W, a distance of 867 feet to the intersection of the south line of the Little Mountain Road and a fence and the point of beginning of this description; thence S 03°47'05" E, a distance of 575.96 feet to the thread of a creek; thence N 87°18'25" E, a distance of 110 feet to a fence; thence N 03°47'05" W, a distance of 521.59 feet to the southerly right of way line of the Little Mountain Road; thence northwesterly along the said south line to the point of beginning of this description;

AND EXCEPT the east 30 feet of that portion of the southeast quarter of the northwest quarter of said Section 34 lying south of the Little Mountain Road.

AND EXCEPT that portion of the southeast quarter of the northwest quarter of Section 34, Township 34 North, Range 4 East, W.M. described as follows:

Commencing at the northeast corner of the northwest quarter of said Section 34; thence S 01°14'27" W

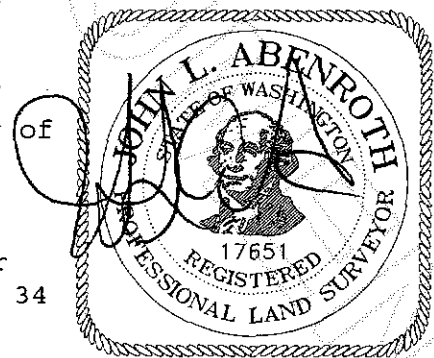

12/2/08



200909180004

Skagit County Auditor



806 Metcalf St., Sedro-Woolley, WA 98284 Phone: (360) 855-2121 FAX: (360) 855-1658

along the east line of said northwest quarter, a distance of 1621.83 feet to the south line of the Little Mountain Road; thence S 89°22'17" W along said south line, a distance of 30.02 feet to the west line of the east 30 feet of the northwest quarter of said Section 34 and the point of beginning of this description; thence S 89°22'17" W along the south line of the Little Mountain Road, a distance of 294.54 to the point of curvature of a curve to the right having a radius of 1175.92 feet; thence westerly along the south line of the Little Mountain Road and said curve through a central angle of 21°22'08" and an arc distance of 438.57 feet to the northeast corner of the property conveyed to Eric A. Swanson and Leah M. Swanson by Statutory Warranty Deed recorded under Auditor's File Number 200007280107; thence S 03°52'30" E along the east line of said Swanson property, a distance of 523.28 feet to the southeast corner thereof; thence S 41°17'12" E, a distance of 279.10 feet to the north line of the south 305.03 feet of the northwest quarter of said Section 34; thence S 89°37'36" E, along said north line, a distance of 489.99 feet to the west line of the east 30 feet of the northwest quarter of said Section 34; thence N 01°14'27" E, along said west line, a distance of 662.25 feet to the point of beginning of this description.

Situate in Skagit County, Washington.

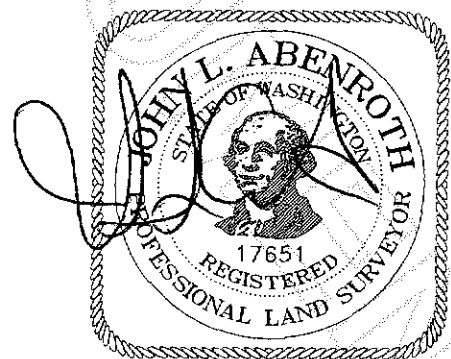

200909180004  
Skagit County Auditor

12/2/08



**Skagit**  
**Surveyors & Engineers**

806 Metcalf St., Sedro-Woolley, WA 98284 Phone: (360) 855-2121 FAX: (360) 855-1658

LEGAL DESCRIPTION  
FOR  
MARY JOHNSON  
ASSESSOR'S PARCEL P29718  
AFTER BOUNDARY LINE ADJUSTMENT

EXHIBIT D

November 5, 2008

That portion of the southeast quarter of the northwest quarter of Section 34, Township 34 North, Range 4 East, W.M. described as follows:

Commencing at the northeast corner of the northwest quarter of said Section 34; thence S 01°14'27" W along the east line of said northwest quarter, a distance of 1621.83 feet to the south line of the Little Mountain Road; thence S 89°22'17" W along said south line, a distance of 30.02 feet to the west line of the east 30 feet of the northwest quarter of said Section 34 and the point of beginning of this description; thence S 89°22'17" W along the south line of the Little Mountain Road, a distance of 294.54 to the point of curvature of a curve to the right having a radius of 1175.92 feet; thence westerly along the south line of the Little Mountain Road and said curve through a central angle of 21°22'08" and an arc distance of 438.57 feet to the northeast corner of the property conveyed to Eric A. Swanson and Leah M. Swanson by Statutory Warranty Deed recorded under Auditor's File Number 200007280107; thence S 03°52'30" E along the east line of said Swanson property, a distance of 523.28 feet to the southeast corner thereof; thence S 41°17'12" E, a distance of 279.10 feet to the north line of the south 305.03 feet of the northwest quarter of said Section 34; thence S 89°37'36" E, along said north line, a distance of 489.99 feet to the west line of the east 30 feet of the northwest quarter of said Section 34; thence N 01°14'27" E, along said west line, a distance of 662.25 feet to the point of beginning of this description.

Situate in Skagit County, Washington.

Containing 10.23 acres.

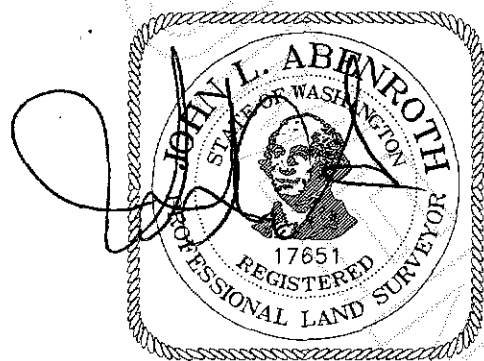

12/2/08



200909180004  
Skagit County Auditor

**Skagit**  
**Surveyors & Engineers**

806 Metcalf St., Sedro-Woolley, WA 98284 Phone: (360) 855-2121 FAX: (360) 855-1658

LEGAL DESCRIPTION  
FOR  
MARY JOHNSON  
LOLA LANG PROPERTY  
AFTER BOUNDARY LINE ADJUSTMENT

*EXHIBIT E*

November 5, 2008

Parcel A

That portion of the northwest quarter of the northwest quarter of Section 34, Township 34 North, Range 4 East, W.M. described as follows:

Beginning at the northeast corner of said northwest quarter of the northwest quarter; thence running west along the north line thereof, a distance of 660 feet; thence south at right angles, a distance of 660 feet; thence east parallel with the north line of said subdivision, a distance of 260 feet; thence south to the northerly line of the county road; thence southeasterly along said road to the east line of the northwest quarter of the northwest quarter; thence north to the point of beginning.

Parcel B

The northeast quarter of the northwest quarter of Section 34, Township 34 North, Range 4 East, W.M.

EXCEPT county road rights of way.

Parcel C

That portion of the west half of the west half of the west half of the northeast quarter of Section 34, Township 34 North, Range 4 East, W.M. lying north of the Little Mountain Road.

Parcel D

That portion of the southeast quarter of the northwest quarter of Section 34, Township 34 North, Range 4 East, W.M. lying northerly of the County road as it existed on August 27, 1935.

Parcel E

That portion of the southeast quarter of the northwest quarter of Section 34, Township 34 North, Range 4 East, W.M. lying south of Little Mountain Road and east of the haul road shown on Washington State Department of Transportation

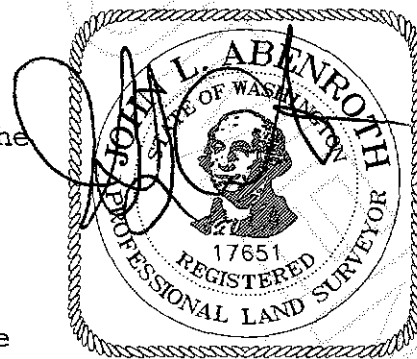

12/2/08



200909180004

Skagit County Auditor



806 Metcalf St., Sedro-Woolley, WA 98284 Phone: (360) 855-2121 FAX: (360) 855-1658

Sundry Site Plan - Conway Jct to Jct. P.S.H. No.1 North of Burlington  
- Pit Sites, approved February 10, 1953;

EXCEPT the west 680 of the south 330 of the southeast quarter of the northwest quarter of said Section 34;

AND EXCEPT that portion described as follows:

Commencing at the northeast corner of the northwest quarter of said Section 34; thence S 01°21'46" W along the east line of said northwest quarter, a distance of 1521.31 feet; thence N 88°34'14" W, a distance of 867 feet to the intersection of the south line of the Little Mountain Road and a fence and the point of beginning of this description; thence S 03°47'05" E, a distance of 575.96 feet to the thread of a creek; thence N 87°18'25" E, a distance of 110 feet to a fence; thence N 03°47'05" W, a distance of 521.59 feet to the southerly right of way line of the Little Mountain Road; thence northwesterly along the said south line to the point of beginning of this description;

AND EXCEPT the east 30 feet of that portion of the southeast quarter of the northwest quarter of said Section 34 lying south of the Little Mountain Road.

AND EXCEPT that portion of the southeast quarter of the northwest quarter of Section 34, Township 34 North, Range 4 East, W.M. described as follows:

Commencing at the northeast corner of the northwest quarter of said Section 34; thence S 01°14'27" W along the east line of said northwest quarter, a distance of 1621.83 feet to the south line of the Little Mountain Road; thence S 89°22'17" W along said south line, a distance of 30.02 feet to the west line of the east 30 feet of the northwest quarter of said Section 34 and the point of beginning of this description; thence S 89°22'17" W along the south line of the Little Mountain Road, a distance of 294.54 to the point of curvature of a curve to the right having a radius of 1175.92 feet; thence westerly along the south line of the Little Mountain Road and said curve through a central angle of 21°22'08" and an arc distance of 438.57 feet to the northeast corner of the property conveyed to Eric A. Swanson and Leah M. Swanson by Statutory Warranty Deed recorded under Auditor's File Number 200007280107; thence S 03°52'30" E along the east line of said Swanson property, a distance of 523.28 feet to

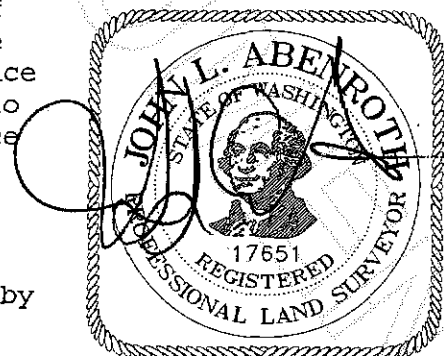

**Skagit**  
**Surveyors & Engineers**

806 Metcalf St., Sedro-Woolley, WA 98284 Phone: (360) 855-2121 FAX: (360) 855-1658

the southeast corner thereof; thence S 41°17'12" E, a distance of 279.10 feet to the north line of the south 305.03 feet of the northwest quarter of said Section 34; thence S 89°37'36" E, along said north line, a

distance of 489.99 feet to the west line of the east 30 feet of the northwest quarter of said Section 34; thence N 01°14'27" E, along said west line, a distance of 662.25 feet to the point of beginning of this description.

Situate in Skagit County, Washington.

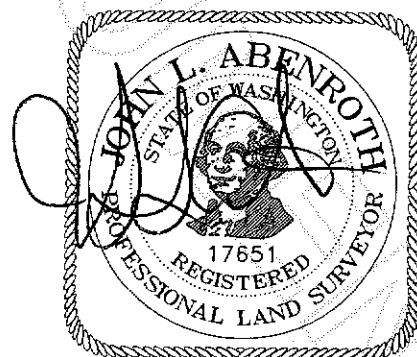

12/2/08



200909180004

Skagit County Auditor