

AUDITORS CERTIFICATE

200907200141
Skagit County Auditor

7/20/2009 Page 2 of 2 2:08PM

SKAGIT COUNTY AUDITOR

BY DEPUTY

SHORT CARD NO. PLO6-1026

LEGEND:

- SECTION CORNER
- 1/4 SECTION CORNER
- SET 1/2" RB W/ YELLOW PLASTIC CAP
- MARKED "B" V.S. 37548"
- FOUND 1/2" RB WCAP P.L.S. #17651
- EXISTING EDGE OF ASPHALT
- EXISTING TOP OF SLOPE LINE
- EXISTING TOE OF SLOPE LINE
- EXISTING BARBED WIRE FENCE
- EXISTING CEDAR TREES
- EXISTING WELL
- EXISTING SOIL LOG
- ACCESS POINT
- DRAINFIELD AND RESERVE AREA
- POLE MARKER POST

NOTE: WELL PROTECTION ZONE
LOT 2 GRANTED OVERLAP WPZ BY TRACT C

SAMISH HEIGHTS ROAD

ERSHIG ROAD

ERSHIG BY THE TRACKS

ERSHIG BY THE TRACKS
A.F. # 200509190241

MITIGATION AREA FOR
CREEK BUFFER AREA
DISTURBANCE 1,206 SF

CURVE	LENGTH	RADIUS	DELTA
C1	74.57	55.00	77°40'47"
C2	20.61	50.00	23°36'42"
C3	22.67	50.00	25°58'51"
C4	32.77	55.00	34°08'05"



SCALE 1"=100'

ZONING:
RURAL RESERVE 2/10 ACRE-CARD.

OCCUPATIONAL INDICATORS AND
EXISTING FENCELINE NOTE:

THIS SURVEY HAS DEPICTED EXISTING OCCUPATIONAL INDICATORS IN ACCORDANCE WITH W.A.C.
CH. 332.130. THESE OCCUPATIONAL INDICATORS MAY INDICATE A POTENTIAL FOR CLAIMS OF
UNWRITTEN TITLE OWNERSHIP. THE LEGAL RESOLUTION OF OWNERSHIP BASED UPON
UNWRITTEN TITLE CLAIMS HAS NOT BEEN RESOLVED BY THIS BOUNDARY SURVEY.

BASIS OF BEARING:

SOUTH SECTION LINE = N 89°58'53" E SHORT PLAT MAP NUMBER 41-77

SEC. 2, TWP. 36N, RGE. 3E, WM.

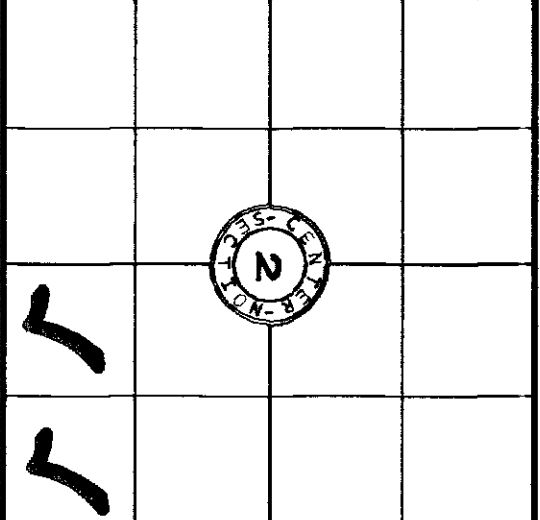

VICINITY MAP

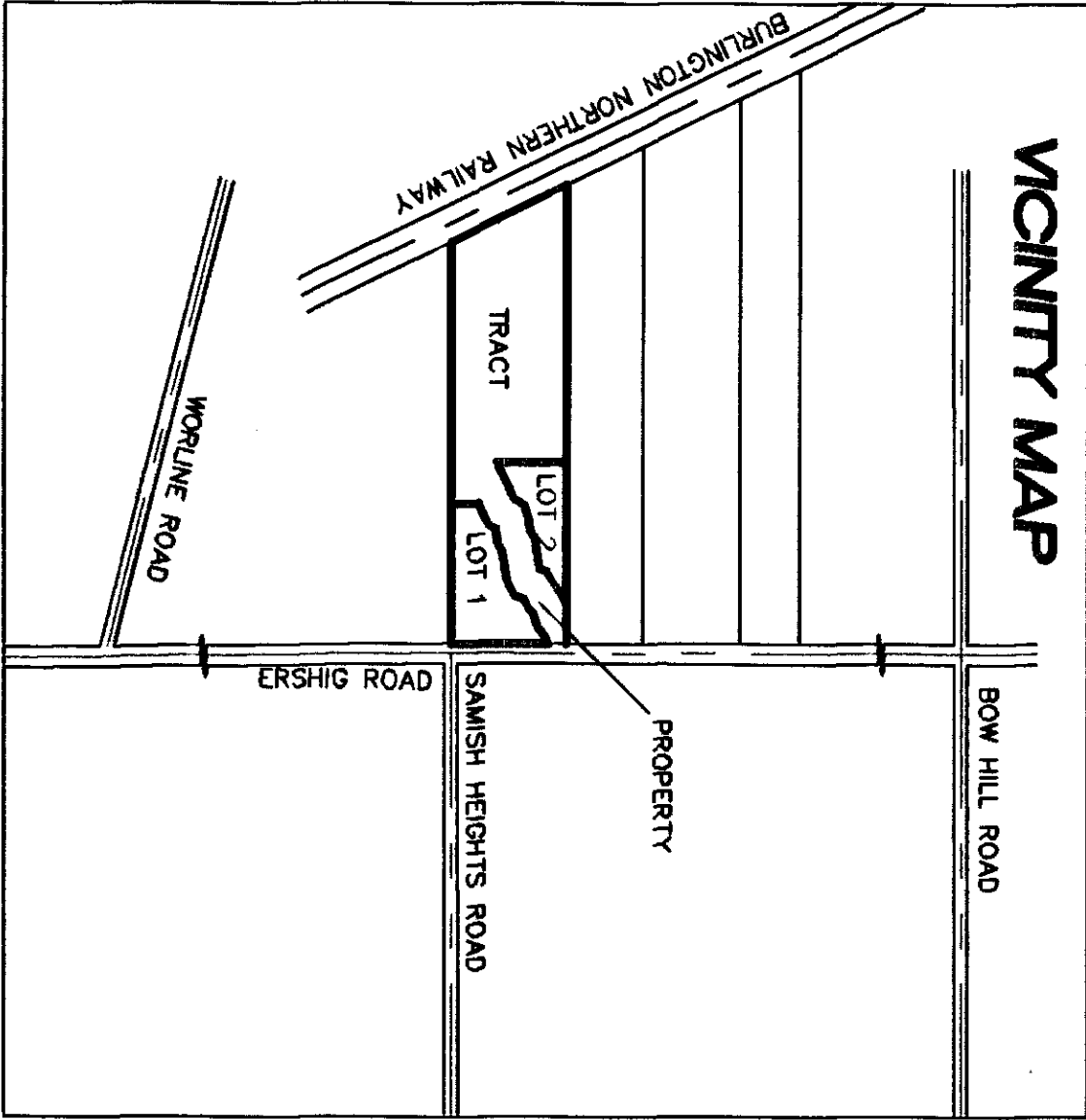

LINE	LENGTH	BEARING
L1	63.20	S75°25'32"W
L2	22.72	S64°36'24"W
L3	24.04	S70°04'17"W
L4	8.90	S80°05'21"W
L5	35.06	S26°52'56"W
L6	50.78	S73°10'45"W
L7	29.15	S83°54'34"W
L8	24.03	S56°50'42"W
L9	89.89	S81°38'08"W
L10	24.55	S20°46'18"W
L11	103.49	S58°15'09"W
L12	8.26	S73°59'18"W
L13	36.57	N83°54'34"E
L14	26.15	N56°50'42"E
L15	87.20	N81°36'06"E
L16	50.41	N63°36'07"E
L17	29.73	N20°45'18"E
L18	32.12	N60°03'18"E
L19	14.02	N56°21'15"E
L20	46.73	N72°17'55"E
L21	35.85	N53°51'08"E
L22	20.36	N58°16'22"E
L23	23.82	N90°00'00"W
L24	76.80	S08°33'09"E
L25	73.04	S32°28'51"E
L26	5.54	N58°15'09"E
L27	92.19	N89°58'53"E
L28	14.92	S47°56'19"E
L29	80.66	S47°56'19"E
L30	66.70	S77°18'12"E
L31	57.93	N69°06'40"E
L32	99.40	N61°01'47"E
L33	14.11	S56°37'48"W
L34	80.82	S63°19'51"W
L35	98.14	S67°35'02"W
L36	15.02	N78°22'44"W
L37	76.36	S23°13'05"W
L38	87.42	S52°17'37"W
L39	39.61	N53°36'51"W
L40	156.18	N24°15'48"W
L41	20.79	S36°04'33"W
L42	43.85	S68°55'40"W
L43	27.49	S80°09'07"W
L44	40.92	S54°15'18"W
L45	18.82	S75°25'32"W
L46	29.92	S01°43'07"E
L47	34.48	S54°15'18"W
L48	88.07	S75°25'32"W
L49	32.65	N68°14'55"E
L50	27.42	N70°04'17"E
L51	47.45	N60°05'21"E
L52	21.83	N26°52'56"E
L53	6.08	N83°54'34"E

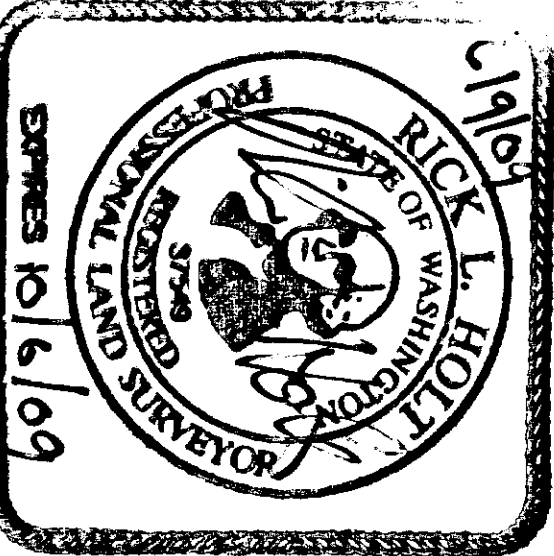

DRAWN BY: R. HOLT
DATE: 06/09/09
FIELD BOOK: 71 PAGE 17-21

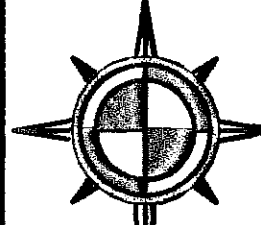

BAYVIEW SURVEYING
& ENGINEERING INC.
130 Sharon Avenue, Burlington WA 98233
Tel: 360-707-2560 Fax: 360-757-5976
info@bayviewwa.com

SHEET NO. 2 OF 2
SCALE: 1"=100'
JOB NO: 2006-62

SHORT CARD FOR
CHRIS AND JILL ISAACSON
A PORTION OF THE SOUTHEAST 1/4 OF SECTION 2,
TOWNSHIP 35 NORTH, RANGE 3 EAST, W.M.