

Survey in the SE1/4 of the SW1/4 of Section 1, Twp. 34 N., Rng. 4 E., W.M.

Legal Descriptions

PARCEL 1

LOT 1, LOT 2, THE SOUTH 69.5 FEET OF LOT 9 AND THE SOUTH 69.5 FEET OF LOT 10, BLOCK 22, WEST ADDITION CLEAR LAKE - WASH. RECORDS TO THE PLAT THEREOF RECORDED IN VOLUME 4, OF PLATS, PAGE 32, RECORDS OF SKAGIT COUNTY, WASHINGTON; EXCEPT THE SOUTH 130.25 FEET OF SAID LOTS 1 AND 2.

PARCEL 2

THE SOUTH 130.25 FEET OF LOTS 1 AND 2, BLOCK 22, WEST ADDITION CLEAR LAKE - WASH. RECORDS TO THE PLAT THEREOF RECORDED IN VOLUME 4, OF PLATS, PAGE 32, RECORDS OF SKAGIT COUNTY, WASHINGTON; TOGETHER WITH THAT PORTION OF VACATED DAY STREET LYING BETWEEN SAID LOTS 1 AND 2 AND LOTS 9 AND 10, BLOCK 15, PLAT OF CLEAR LAKE SKAGIT COUNTY WASHINGTON, ACCORDING TO THE PLAT THEREOF RECORDED IN VOLUME 4 OF PLATS, PAGES 22 & 23, RECORDS OF SKAGIT COUNTY, WASHINGTON.

PARCEL A

LOTS 1, 9, AND 10, IN BLOCK 15 FO THE PLAT OF CLEAR LAKE, SKAGIT COUNTY, WASHINGTON, ACCORDING TO THE PLAT THEREOF RECORDED IN VOLUME 4 OF PLATS AT PAGES 22 AND 23, RECORDS OF SKAGIT COUNTY, WASHINGTON; EXCEPT THE SOUTH 160 FEET OF SAID LOT 1.

Notes

1. BASIS-OF-BEARINGS - ASSUMED N89°51'31"W ON THE CENTERLINE OF PRINGLE STREET AS SHOWN HEREON. FOR ADDITIONAL SURVEY INFORMATION SEE SURVEY FILED IN A.F.#200710300026.
2. THIS SURVEY WAS ACCOMPLISHED BY FIELD TRAVERSE USING: 5 SECOND OR BETTER DIGITAL ELECTRONIC TOTAL STATION, AND MEETS OR EXCEEDS THE STANDARDS CONTAINED IN WAC 332-130-090.
3. BOUNDARY SURVEYS REFLECT INFORMATION DISCOVERED BY THE SURVEYOR IN THE NORMAL COURSE OF WORK AND DO NOT NECESSARILY SHOW EVERY POSSIBLE CONDITION AFFECTING THE PROPERTY, EASEMENTS, RESTRICTIONS, AND OTHER ENCUMBRANCES MAY EXIST WHICH ARE NOT SHOWN HEREON.
4. ESTABLISHED THE NORTH LINE OF DAY STREET FOR DIRECTION AND PROPORTIONMENT BY HOLDING THE PLAT DISTANCE FOR THE EAST LINE OF BLOCK 15 OF "PLAT OF CLEAR LAKE SKAGIT COUNTY WASHINGTON".

Legend

- SET 1/2" X 18" REINFORCING ROD WITH YELLOW PLASTIC CAP MARKED "SKA SURV 17651" AND WHITE 2" X 2" WITNESS STAKE, EXCEPT AS NOTED.

--- FENCE

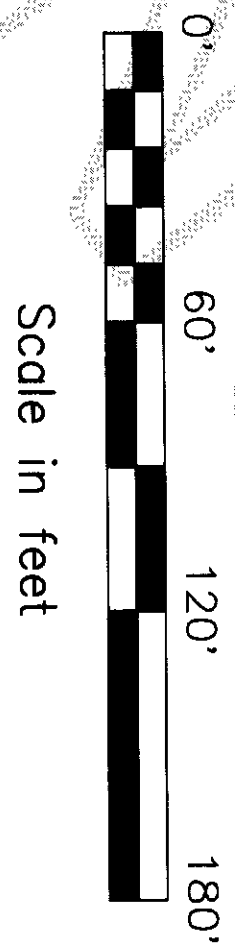

Scale in feet

PRINGLE STREET
N89°51'31"W 2058.40'
20'

BIRCH AVE. (Vacated)

DAY STREET (Vacated)

PLAT OF CLEAR LAKE
BLOCK 15

WEST ADDITION TO
CLEAR LAKE
BLOCK 22

PARCEL 1
0.94 AC.

PARCEL 2
0.94 AC.

PARCEL A
1.05 AC.

FOUND 3/4" IRON PIPE WITH
PLUG & TACK AT THE
INTERSECTION OF MAPLE AVE.
AND PRINGLE ST. ON 5/22/07



FOUND CONCRETE MONUMENT WITH
BRASS CAP IN CASE AND COVER.

BUCHANAN STREET

2064.72'

S89°37'28"W

606.77'

FOUND BRASS CAP MON. IN
CASE AND COVER 10/20/89

DATE	REVISION	BY	JOB#	DRAWN	CHECKED	DATE	SCALE	SHEET
			208018	jla	jla	14APR09	1" = 60'	1 OF 1

Survey for Rebecca Anderson

COPYRIGHT 2008 SKAGIT SURVEYORS, INC.



806 Metcalf St., Sedro-Woolley, WA 98284 Phone: (360) 855-2121 FAX: (360) 855-1658

SURVEYOR'S CERTIFICATE
This map correctly represents a survey made by me or under my direction in conformance with the Survey Recording Act in March 2009 at the request of Rebecca Anderson.
John L. Abenroth CERT#17651
Date May 7, 2009

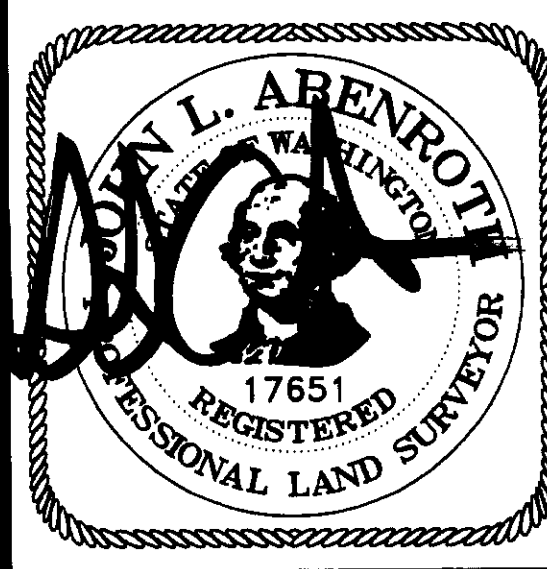

AUDITOR'S CERTIFICATE



200905080001
Skagit County Auditor

5/8/2009 Page 1 of 1 8:33AM

J. Youngquist by: [Signature]
County Auditor or Deputy Auditor