

Return to:



200901280147

Skagit County Auditor

1/28/2009 Page

1 of

2 1:12PM

PROTECTED CRITICAL AREA SITE PLAN

Page 1 of 2

Grantor/Owner: Karen Hunter

Grantee: PUBLIC

Site Address: 22257 Willabelle Pl

Property ID #: 123532 Assessors Tax Account #: \_\_\_\_\_

Legal Description: Sec 25 Twp. 33 Rng. 4 Plat Name \_\_\_\_\_ Lot \_\_\_\_\_

Permit/Activity #: PC09-0016

The PROTECTED CRITICAL AREA (PCA) is to be left undisturbed in its natural state. "With the exception of activities identified as Allowed without Standard review under SCC 14.24.100, any land-use activity that can impair the functions and values of critical areas or their buffers through a development activity or by disturbance of the soil or water, and/or by removal of, or damage to, existing vegetation shall require critical areas review and written authorization pursuant to SCC 14.24." SCC 14.24.060 No clearing, grading, filling, logging or removal of woody material, building, construction or road construction of any kind, planting of non-native vegetation or grazing of livestock is allowed within the PCA areas except as specifically permitted by Skagit County on a case-by-case basis consistent with SCC 14.24.

Representations on this site plan may be approximations only and should not be used for purposes other than for determining general locations of critical areas. Development activities beyond the scope of this plan may require additional studies and approvals.

The above references to "Grantor" and "Grantee" shall not be construed as a transfer of property ownership and are used solely for filing with the County Auditor.

Owner: [Signature] Date: 1/26/09

On this day personally appeared before me Karen Hunter known to be the individual described herein and acknowledged to me that her signed the same as her free and voluntary act and deed for the uses and purposes mentioned.

Mary Ellen Notary Public in and for the State of Washington, residing at 126-09 Date: 1-26-09

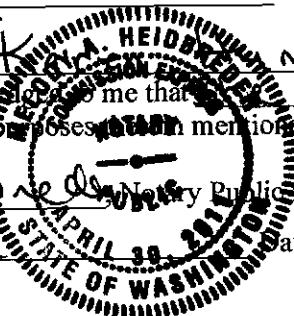

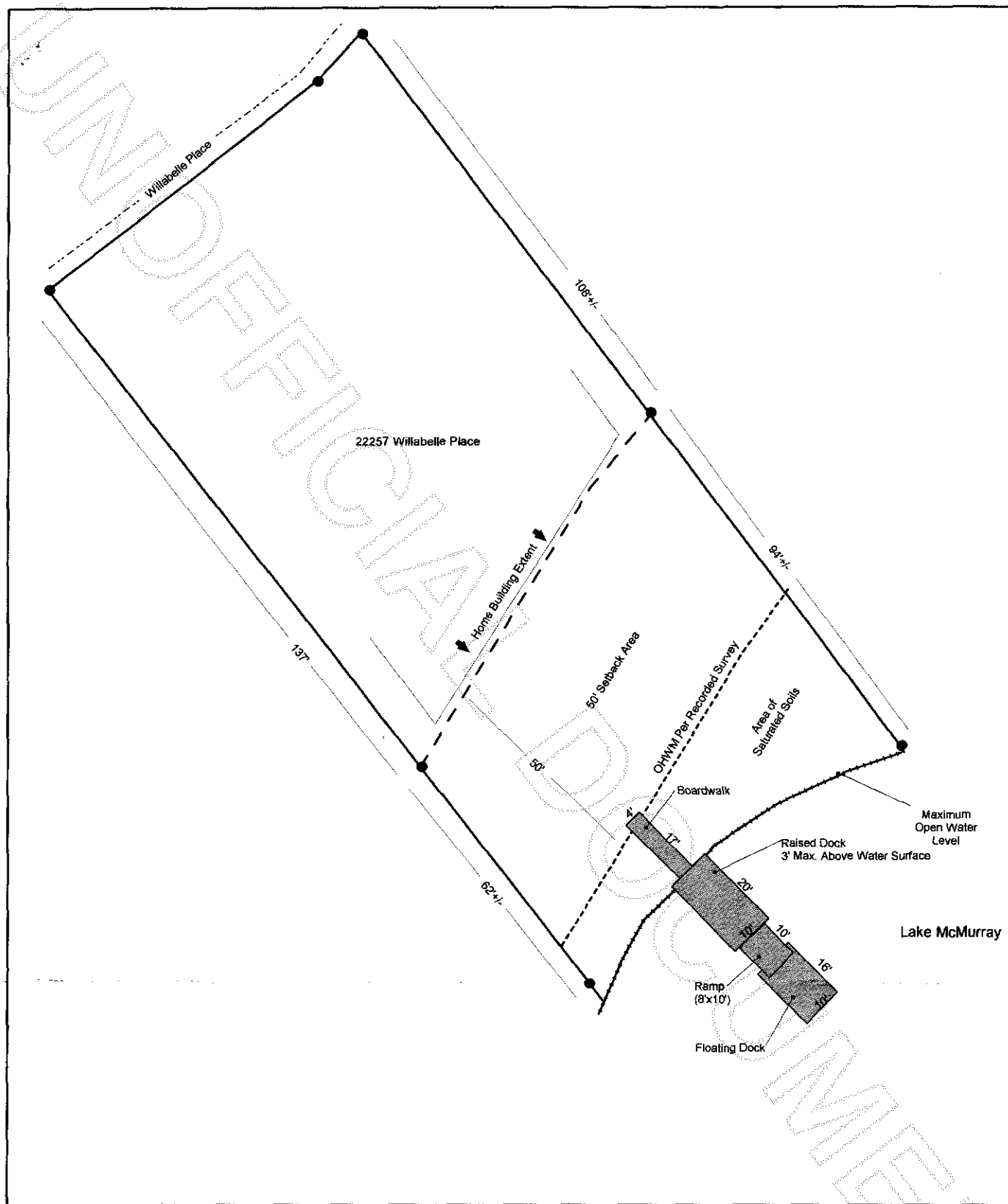

## Dock Positioning

For: Jim Thompson &  
Karen Hunter  
22257 Willabelle Place  
Mount Vernon, WA 98274  
P123532  
Sec. 25, T33N, R04E

*JP*  
*1/28/09*

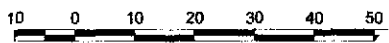

60 Feet

Maximum Open Water Edge  
OHWM Per 11/14/00 Survey  
50' Minimum Building Setback

Skagit Wetlands & Critical Areas  
2009

\*This is not a survey. All positioning  
and locations approximate. for general



200901280147

Skagit County Auditor