

SURVEY DESCRIPTION

THE NORTHEAST 1/4 OF SECTION 22, TOWNSHIP 35 NORTH, RANGE 10 EAST, W.M., EXCEPT THE STATE HIGHWAY RUNNING ALONG THE SOUTHERLY LINE THEREOF.

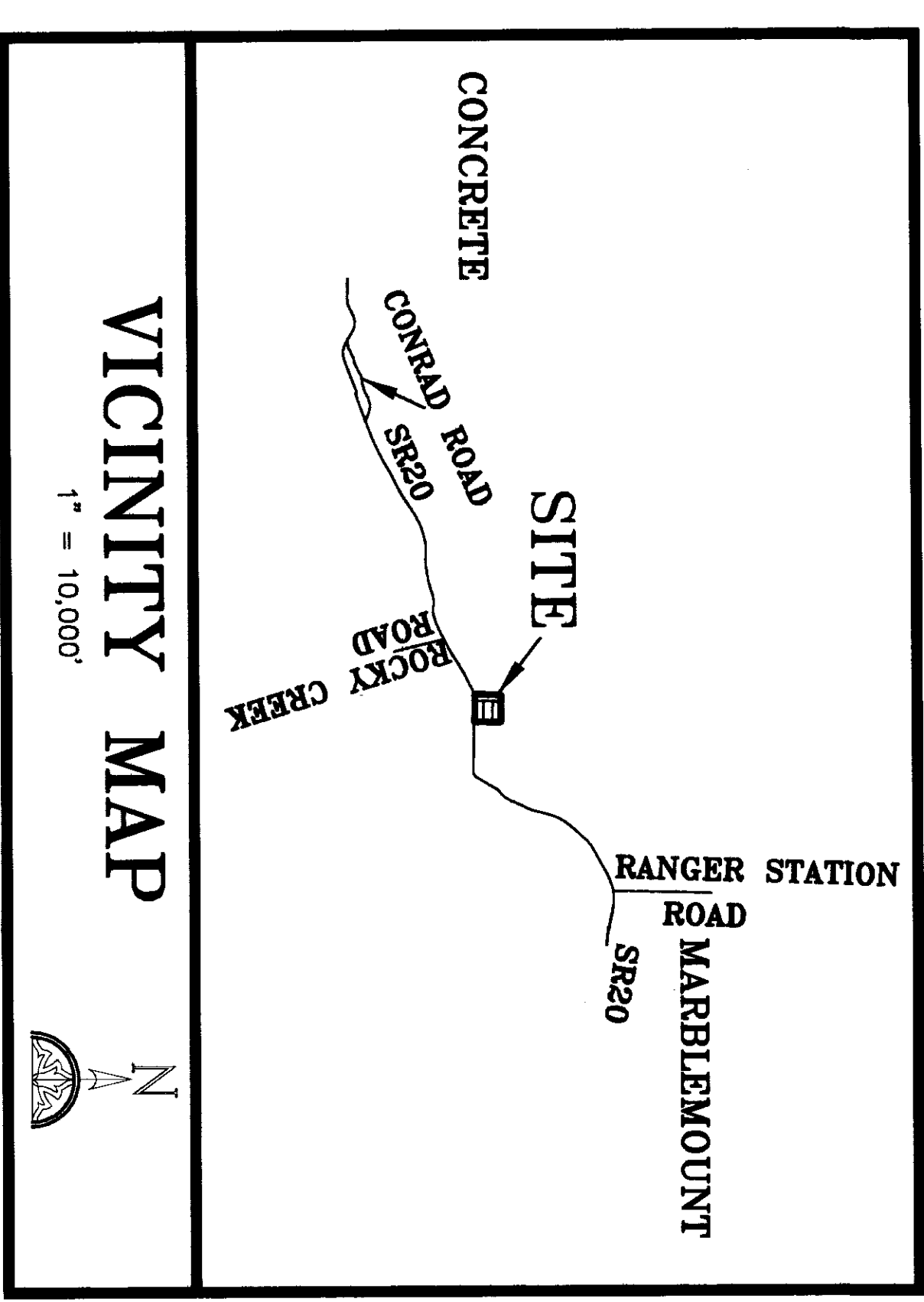

LOT ADDRESS INFORMATION

A SKAGIT COUNTY ADDRESS RANGE HAS BEEN APPLIED TO THE ROAD SYSTEM IN THIS SUBDIVISION. AT THE TIME OF APPLICATION FOR BUILDING AND/OR ACCESS, SKAGIT COUNTY WILL ASSIGN INDIVIDUAL ADDRESSES IN ACCORDANCE WITH THE PROVISIONS OF SKAGIT COUNTY CODE 15.24.

ROAD NAME	BEGINNING RANGE	ENDING RANGE
LIBERTY BELL LANE	9094	9255
SR 20	4000	92023

OWNER

ROBERT A. CUNNINGHAM
5779 STATE ROUTE 20
ROCKPORT, WA 98283

APPROVALS

THE WITHIN AND FOREGOING SHORT PLAT IS APPROVED IN ACCORDANCE WITH THE PROVISIONS OF THE SKAGIT COUNTY SHORT PLAT ORDINANCE ON THIS 17th DAY OF November 2008

SKAGIT COUNTY PLANNING DIRECTOR

SKAGIT COUNTY ENGINEER

THE WITHIN AND FOREGOING SHORT PLAT IS APPROVED IN ACCORDANCE WITH THE PROVISIONS OF SKAGIT COUNTY CODE TITLE 12.05 (ON-SITE SEWAGE) AND 12.48 (WATER) THIS 10th DAY OF November 2008.

SKAGIT COUNTY HEALTH OFFICER

TREASURER'S CERTIFICATE

THIS IS TO CERTIFY THAT ALL TAXES HERETOFORE LEVIED AND WHICH HAVE BECOME A LIEN UPON THE LANDS HEREIN DESCRIBED HAVE BEEN FULLY PAID AND DISCHARGED ACCORDING TO THE RECORDS OF MY OFFICE, UP TO AND INCLUDING THE YEAR OF 2008 THIS 13th DAY OF November 2008

SKAGIT COUNTY TREASURER

SHORT PLAT NO. P1061023 DATE 11/18/08

SURVEYOR'S CERTIFICATE

I HEREBY CERTIFY THAT THIS SHORT SUBDIVISION IS BASED ON AN ACTUAL SURVEY, WHICH IS RETRACEABLE AND BASED ON A TRUE SUBDIVISION OF THE SECTION, THAT THE DISTANCES, COURSES, AND ANGLES ARE SHOWN THEREON CORRECTLY, AND THAT MONUMENTS HAVE BEEN SET AND LOT CORNERS STAKED ON THE GROUND AS SHOWN ON THE SHORT PLAT IN ACCORDANCE WITH THE PROVISIONS CONTAINED IN CHAPTER 332-120 WAC.

JOHN B. SEMRAU, P.E., P.L.S., CERTIFICATE NO. 28626
SEMRAU ENGINEERING & SURVEYING, PLLC.
2118 RIVERSIDE DRIVE SUITE 208
MOUNT VERNON, WA 98273
PHONE (360) 424-9566

DATE: 10.2.08

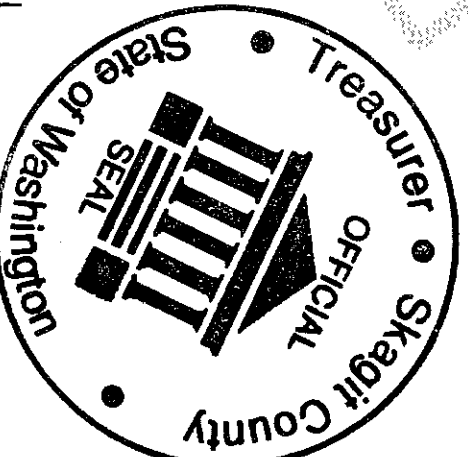

NOTES

- SHORT PLAT NUMBER AND DATE OF APPROVAL SHALL BE INCLUDED IN ALL DEEDS AND CONTRACTS.
- ZONING - RURAL RESERVE (RRV) COMPREHENSIVE PLAN - RRV
- SEWAGE DISPOSAL - INDIVIDUAL SEPTIC
- WATER - WATER WILL BE SUPPLIED FROM INDIVIDUAL WATER SYSTEMS. CONTACT SKAGIT COUNTY HEALTH DEPARTMENT TO DETERMINE IF ADDITIONAL WATER QUALITY OR QUANTITY TESTING WILL BE REQUIRED FOR BUILDING PERMIT APPROVALS. THE HUNDRED (100) FOOT RADIUS WELL PROTECTION ZONE FOR INDIVIDUAL WATER SYSTEMS MUST BE LOCATED ENTIRELY ON THE PROPOSED LOT OWNED IN FEE SIMPLE. OR THE OWNER MUST HAVE THE RIGHT TO EXERCISE COMPLETE SANITARY CONTROL OF THE LAND WITHIN THE REQUIRED WELL PROTECTION ZONE THROUGH OTHER LEGAL PROVISIONS, SUCH AS RECORDED COVENANTS OR EASEMENTS. (ORD. 02007004 (PART); ORD. 14063 (PART), 1991)
- INDICATES IRON REBAR SET WITH YELLOW CAP - SURVEY NUMBER SEMRAU 28626.
O - INDICATES EXISTING REBAR OR IRON PIPE FOUND.
- MERIDIAN - ASSUMED (FROM ROS AF NO. 8202230042)
- BASIS OF BEARING - NORTH LINE OF NE 1/4 OF SECTION 22, TOWNSHIP 35 NORTH, RANGE 10 EAST, W.M. BEARING = SOUTH 89°14'20" EAST.
- SURVEY DESCRIPTION IS FROM A SECOND COMMITMENT FOR TITLE INSURANCE BY GUARDIAN NORTHWEST TITLE & ESCROW ORDER NO. BB9694, DATED AUGUST 25, 2008.
- THIS PROPERTY IS SUBJECT TO AND TOGETHER WITH EASEMENTS, RESERVATIONS, RESTRICTIONS, COVENANTS, LIENS AND OTHER INSTRUMENTS OF RECORD INCLUDING BUT NOT LIMITED TO THOSE INSTRUMENTS DESCRIBED IN THE TITLE REPORT MENTIONED IN NOTE NUMBER 8 ABOVE AND BEING RECORDED UNDER SKAGIT COUNTY AUDITOR'S FILE NUMBERS 227885, 229305, 295893, 435256, 670628, 779913, 9901270090, 9902030041, 9907120206, 200010310088, 200511140270, 200605510008, 200701090106 AND SKAGIT COUNTY SUPERIOR COURT CAUSE NO.S 9510, 13420, 20724 AND 03-3-00073-2.
- INSTRUMENTATION: LEICA TCA 1105 THEODOLITE DISTANCE METER.
- SURVEY PROCEDURE: FIELD TRAVERSE.
- NO BUILDING PERMIT SHALL BE ISSUED FOR ANY RESIDENTIAL AND/OR COMMERCIAL STRUCTURES WHICH ARE NOT, AT THE TIME OF APPLICATION, DETERMINED TO BE WITHIN ANY OFFICIALLY DESIGNATED BOUNDARY OF A SKAGIT COUNTY FIRE DISTRICT.
- CHANGE IN LOCATION OF ACCESS, MAY NECESSITATE A CHANGE OF ADDRESS, CONTACT SKAGIT COUNTY PLANNING AND DEVELOPMENT SERVICES.
- TOTAL ACREAGE OF SP NO. PL 06-1023 IS 39.10 ACRES EXCLUSIVE OF HIGHWAY 20 RIGHT OF WAY.
- SEE PROTECTED CRITICAL AREA EASEMENT RECORDED UNDER AUDITOR'S FILE NO. 20081110003 FOR PCA EASEMENT AGREEMENTS.
- BUYER SHOULD BE AWARE THAT A PORTION OF THIS SHORT SUBDIVISION IS LOCATED IN THE FLOOD PLAIN AS IDENTIFIED BY FEMA ON FLOOD INSURANCE RATE MAP PANEL NUMBER 530151 0310 C WITH THE EFFECTIVE DATE OF JANUARY 3, 1985. SIGNIFICANT ELEVATION MAY BE REQUIRED FOR THE FIRST ELEVATION OF CONSTRUCTION.
- A LOT OF RECORD CERTIFICATION HAS BEEN ISSUED FOR ALL LOTS INCLUDED IN THIS LAND DIVISION. BY VIRTUE OF RECORDING THIS LAND DIVISION AND ISSUANCE OF THE LOT CERTIFICATION, ALL LOTS THEREIN SHALL BE CONSIDERED LOT OF RECORD FOR CONVEYANCE AND DEVELOPMENT PURPOSES UNLESS OTHERWISE RESTRICTED. SEE AF NO. 20081110002.
- FUTURE DEVELOPMENT ACTIVITY ON LOT #4 WITHIN THE TOTEM TRAIL GROUP B (U#888880) WELL PROTECTION AREA SHALL BE REVIEWED AND APPROVED BY THE MANAGEMENT OF TOTEM TRAIL, PUBLIC WATER SYSTEM AND SKAGIT COUNTY PUBLIC HEALTH DEPARTMENT (SCPHD) BEFORE DEVELOPMENT ACTIVITY SHALL OCCUR.
- IN NO CASE SHALL THE COUNTY ACCEPT A DEDICATION OR ANY OBLIGATION AS TO ANY SUCH ROAD, STREET, AND/OR ALLEY UNTIL THE SAME AND ALL ROADS, STREETS, AND/OR ALLEYS CONNECTING THE SAME TO THE FULL CURRENT COUNTY ROAD SYSTEM HAVE BEEN BROUGHT TO FULL COUNTY ROAD STANDARDS AND A RIGHT-OF-WAY DEED HAS BEEN TRANSFERRED TO AND ACCEPTED BY THE COUNTY.
- LOTS ARE SUBJECT TO CONDITIONS AND REQUIREMENTS IN DRAINAGE REPORT, DATED JUNE 19, 2007 AND ROAD PLANS PL. 06-1023, DATED NOVEMBER 29, 2007 AND APPROVED FOR CONSTRUCTION ON JANUARY 10, 2008.
- ALL PRIVATE ROADS, EASEMENTS, COMMUNITY UTILITIES AND PROPERTIES SHALL BE OWNED AND MAINTAINED BY SEPARATE CORPORATE ENTITY OR THE OWNERS OF PROPERTY SERVED BY THE FACILITY AND KEPT IN GOOD REPAIR AND ADEQUATE PROVISIONS SHALL BE MADE FOR APPROPRIATE PRO-RATA CONTRIBUTIONS FOR SUCH MAINTENANCE BY AND FOR SUCH MAINTENANCE BY ANY FUTURE LAND DIVISIONS THAT WILL ALSO USE THE SAME PRIVATE ROAD. SEE ROAD MAINTENANCE AGREEMENT RECORDED UNDER AUDITOR'S FILE NO. 20081110004.
- THIS PARCEL LIES WITHIN AN AREA OR WITHIN 500 FEET OF AREA DESIGNATED AS A NATURAL RESOURCE LANDS (AGRICULTURAL, FOREST AND MINERAL, RESOURCE LANDS OF LONG-TERM COMMERCIAL SIGNIFICANCE) IN SKAGIT COUNTY. A VARIETY OF NATURAL RESOURCE LAND COMMERCIAL ACTIVITIES OCCUR OR MAY OCCUR IN THE AREA THAT MAY NOT BE COMPATIBLE WITH NON-RESOURCE USES AND MAY BE INCONVENIENT OR CAUSE DISCOMFORT TO AREA RESIDENTS. THIS MAY ARISE FROM THE USE OF CHEMICALS, OR FROM SPRAYING, PRUNING, HARVESTING, OR MINERAL EXTRACTION WITH ASSOCIATED ACTIVITIES, WHICH OCCASIONALLY GENERATES TRAFFIC, DUST, SMOKE, NOISE, AND ODOR. SKAGIT COUNTY HAS ESTABLISHED NATURAL RESOURCE MANAGEMENT OPERATIONS AS A PRIORITY USE ON DESIGNATED NATURAL RESOURCE LANDS, AND AREA RESIDENTS SHOULD BE PREPARED TO ACCEPT SUCH INCOMPATIBILITIES, INCONVENIENCES, OR DISCOMFORT FROM NORMAL, NECESSARY NATURAL RESOURCE LAND OPERATIONS WHEN PERFORMED IN COMPLIANCE WITH BEST MANAGEMENT PRACTICES AND LOCAL, STATE, AND FEDERAL LAW, IN THE CASE OF MINERAL LANDS, APPLICATION MIGHT BE MADE FOR MINING-RELATED ACTIVITIES INCLUDING EXTRACTION, WASHING, CRUSHING, STOCKPILING, BLASTING, TRANSPORTING AND RECYCLING OF MINERALS. IN ADDITION, GREATER STRIBACKS THAN TYPICAL MAY BE REQUIRED FROM THE RESOURCE AREA, CONSISTENT WITH SOC 14.16.810. CONTACT SKAGIT COUNTY PLANNING AND DEVELOPMENT SERVICES FOR DETAILS.
- AN AREA OF STEEP SLOPES IS FOUND IN THE NORTHWEST CORNER OF LOT 4, A GEOLOGIC HAZARD SITE ASSESSMENT HAS NOT BEEN PREPARED. NO BUILDING IS ALLOWED IN AREA OVER LOT 2, LOT 3 AND LOT 4 DESIGNATED ON-PA WITHOUT PREPARING A GEOLOGIC HAZARD SITE ASSESSMENT AND COMPLYING WITH ALL APPLICABLE SKAGIT COUNTY CODE. CONTINUED USE OF THIS PROPERTY FOR AGRICULTURE AND FORESTRY IS ALLOWED.
- IF LIVESTOCK ARE TO BE KEPT ON LOT 1, LOT 2 OR LOT 3, A FENCE MUST BE PLACED ON THE PCAE BOUNDARY AND ACCESS TO PCAE BY LIVESTOCK PROHIBITED.
- THE NORTHEAST CORNER OF SECTION 22, T. 35 N., R. 10 E., W.M. WAS DESTROYED BY A FLOOD OF CORKINALE CREEK. SAID SECTION CORNER HAD BEEN MONUMENTED BY FOREST SHOEMAKER, PLS 18920, WITH A STANDARD USA/FOREST SERVICE ROCK TABLE DIRECTLY ABOVE AN EXISTING RADER AND LEONARD 1-DIAMETER IRON PIPE AND CAP MARKED. PLS 6702, AND SAID CORNER WAS REENGINEERED ON A LAND CORNER RECORD UNDER SKAGIT COUNTY AUDITOR'S FILE NO. 8806020018. A 2 1/2 INCH ALUMINUM PIPE MONUMENT WITH A 3 1/2 INCH BRASS Scribed AS NOTED ON SAID LCR WAS RECOVERED FROM AN ADJOINING PROPERTY OWNERS BARN BY MIKE MOWER, PLS 21920. NO EVIDENCE OF THE STONES, CONCRETE OR ROCK TABLE WERE FOUND AT THE SITE. THE RECOVERED SECTION CORNER MONUMENT WAS RESET TO THE NORTH OF SAID OF FOREST SHOEMAKER AND FROM PRELIMINARY SURVEY WORK BY MIKE MOWER TO THE NORTH OF SAID SECTION 22. THE 30 CEDAR STUMP REFERENCE HAD BEEN CUT AND DESTROYED BY SOMEONE SINKING THE TIE TO THIS STUMP WAS SET NEW AT THE SAME DISTANCE ON THE SOUTH FACE OF SAID STUMP.

AUDITOR'S CERTIFICATE



AT THE REQUEST OF SEMRAU ENGINEERING & SURVEYING P.L.L.C.

J. Youngquist

Deputy Auditor

OWNER'S CONSENT

KNOW ALL MEN BY THESE PRESENTS THAT THE UNDERSIGNED SUBDIVIDERS HEREBY CERTIFY THAT THIS SHORT PLAT IS MADE AS THEIR FREE AND VOLUNTARY ACT AND DEED.

Robert A. Cunningham

WELLS FARGO (THE SUCCESSOR IN INTEREST TO INTERWEST BANK)

BY: Robert A. Cunningham

BY: _____

ACKNOWLEDGMENT

STATE OF WASHINGTON
COUNTY OF SKAGIT

I CERTIFY THAT I KNOW OR HAVE SATISFACTORY EVIDENCE **ROBERT A. CUNNINGHAM**, AS HIS SEPARATE PROPERTY, SIGNED THIS INSTRUMENT AND ACKNOWLEDGED IT TO BE HIS FREE AND VOLUNTARY ACT FOR THE USES AND PURPOSES MENTIONED IN THE INSTRUMENT.

DATED 10.2.08
SIGNATURE Cynthia A. Stedler
TITLE N/A
MY APPOINTMENT EXPIRES 3.01.12

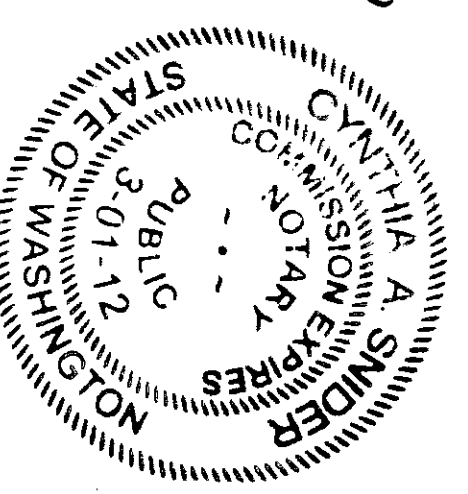

ACKNOWLEDGMENT

STATE OF Washington
COUNTY OF Skagit

I CERTIFY THAT I KNOW OR HAVE SATISFACTORY EVIDENCE THAT Cindy Pena

SIGNED THIS INSTRUMENT, ON OATH STATED THAT (HE/SHE/IT) (WAS/ARE) AUTHORIZED TO EXECUTE THE INSTRUMENT AND ACKNOWLEDGED IT AS THE _____

Branch Manager

OF WELLS FARGO, TO BE THE FREE AND VOLUNTARY ACT OF SUCH PARTY AND PURPOSES MENTIONED IN THE INSTRUMENT.

DATED 10
SIGNATURE [Signature]
TITLE Notary Public
MY APPOINTMENT EXPIRES 1/29/10

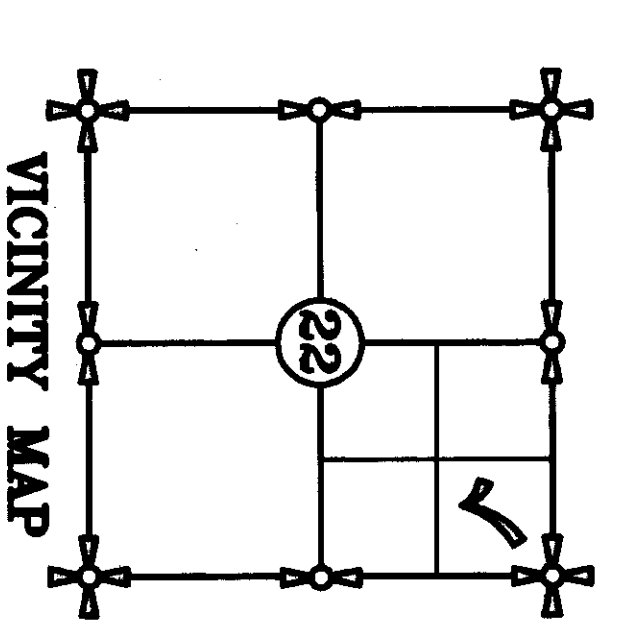
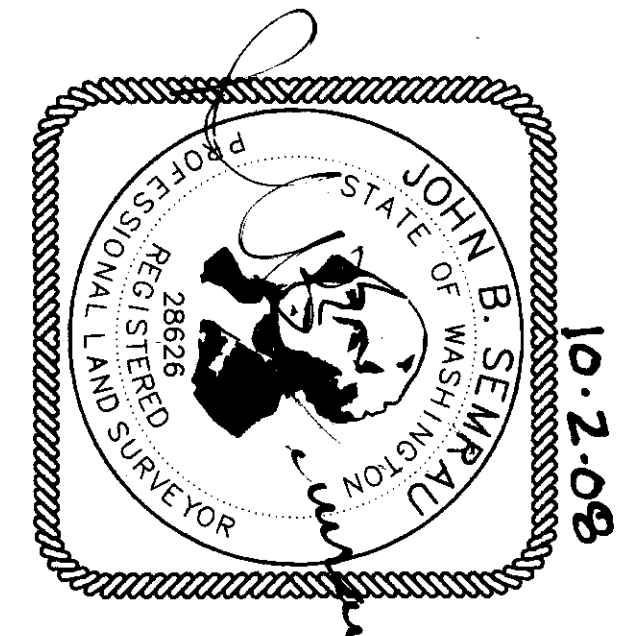

SHORT PLAT NO. PL 06-1023

DATE:

SURVEY IN A PORTION OF THE

NE 1/4 OF THE NE 1/4 OF
SECTION 22, T. 35 N., R. 10 E., W.M.
SKAGIT COUNTY, WASHINGTON
FOR: SHORTGO GUYS, LLC

FE: 2/4, PG: 5-8 SEMRAU ENGINEERING & SURVEYING, PLLC. SCALE: N/A
FE: 2/4, PG: 43-51, 57-62 SURVEYING ENGINEERING & SURVEYING, PLLC.
MERIDIAN: ASSUMED MOUNT VERNON, WA 98273 360-424-9566 JOB NO. 4713

200811180001
Skagit County Auditor

11/18/2008 Page 2 of 2 8:53AM

RESET EXISTING BLM MONUMENT TO
REFERENCED POSITION EAST
SHOULDER OF EXISTING 8' WIDE
GRAVEL DRIVEWAY (SEE NOTE 25
AND DETAIL).

60' EASEMENT FOR INGRESS, EGRESS AND
UTILITIES BY AFN 20051140270
SEATTLE, AFN 227885

FOUND 36"± CEDAR
STUMP WITH CHAINSAW
DAMAGE. THIS IS ONLY
STUMP IN AREA.

FOUND NAIL AND
TAG IN 60"
CEDAR STUMP.
NOTE: BEARINGS SHOWN ARE
MAGNETIC AFTER USING A
DECLINATION OF 1830' EAST.

REFERENCE POINTS TO RESET
BLM SECTION CORNER MONUMENT
LCR AFN 8806020018
(NO SCALE)

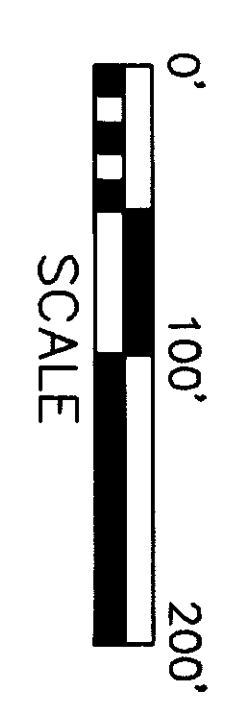

DRAWING FILE: 4713SP.DWG 9/18/08

SHEET 2 OF 2

SHORT PLAT NO. PL 06-1023

DATE:

SURVEY IN A PORTION OF THE

NE 1/4 OF THE NE 1/4 OF
SECTION 22, T. 35 N., R. 10 E., W.M.

SKAGIT COUNTY, WASHINGTON

FOR: SHORTGO GUYS, LLC

SEBRAU ENGINEERING & SURVEYING, PLLC. SCALE: 1" = 100'
FEB 24, PG 4351, 5762 SURVEYING, ENGINEERING, PLANNING
MOUNT VERNON, WA 98273 360-724-9366 JOB NO. 4713

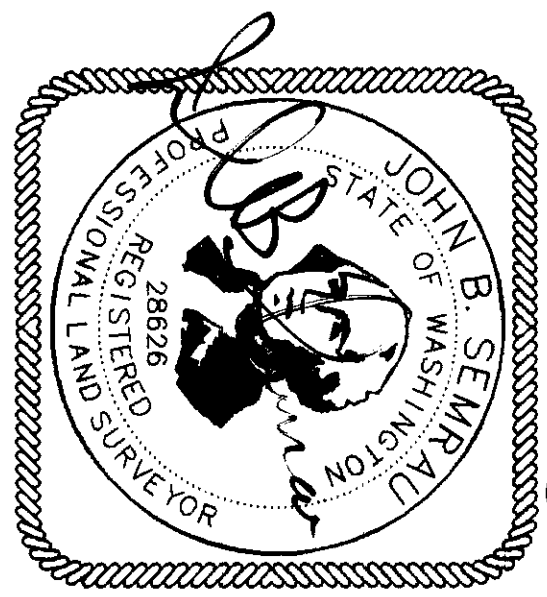

- SOIL LOG LOCATIONS
- FENCE POST WITH WHITE TOP

