

When Recorded Return to:  
Burlington Planning and Permit Center  
901 E. Fairhaven Ave  
Burlington, WA 98233



200809240055  
Skagit County Auditor

9/24/2008 Page 1 of 2 11:19AM

QUIT CLAIM DEED

CHICAGO TITLE CO.  
IQB3115

The GRANTOR(S) Cascade Bank, A Washington State Chartered Commercial Bank

for and in consideration of Boundary Line Adjustment

in hand paid, conveys and quit claims to City of Burlington

the following described real estate, situated in the County of Skagit, State of Washington, together with all after acquired title of the grantor(s) therein:

See full legal description attached as Exhibit A

Abbreviated Legal: The West 5.5 feet of lots 22, 23 and 24 , Block 6, KNUTZEN'S ADDITION  
TO THE TOWN OF BURLINGTON

Tax Parcel Number(s): P72735

3102  
SKAGIT COUNTY WASHINGTON  
REAL ESTATE EXCISE TAX

Dated: August 26, 2008

Jack K. Albright V.P. Cascade Bank 2008  
Date 9-2-08  
Amount Paid \$  
By Skagit Co. Treasurer  
By Deputy

STATE OF WASHINGTON  
COUNTY OF SKAGIT

I certify that I know or have satisfactory evidence that Jack K. Albright is/are the person(s) who appeared before me, and said person(s) acknowledged that he/she/they signed this instrument, on oath stated that he is / she is / they are authorized to execute the instrument and acknowledged it as the Vice President of Cascade Bank to be the free and voluntary act of such party for the uses and purposes mentioned in this instrument.

Dated: 9-2-08

Mary K. Smith  
Notary Public in and for the State of Washington  
Residing at Marefereille  
My appointment expires 8/29/2012

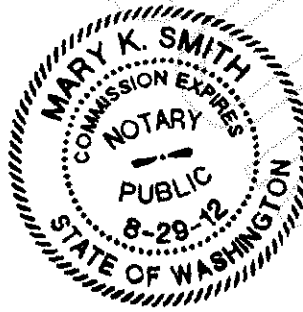

The above described property will be combined or aggregated with contiguous property owned by the grantee. This lot boundary adjustment is not for the purpose of creating an additional lot.

PLANNING DIRECTOR 9-23-08  
DATE

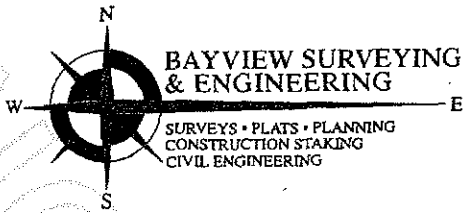

July 1, 2008

CASCADE BANK, a Washington State Chartered Commercial Bank  
Jack Albright  
2628 Colby Avenue  
Everett, WA 98201

Boundary Line Adjustment

**DESCRIPTION FOR PARCEL A:**

THE WEST 5.5 FEET OF LOTS 22, 23 AND 24, BLOCK 6, KNUTZEN'S ADDITION  
TO THE TOWN OF BURLINGTON, ACCORDING TO THE PLAT THEREOF  
RECORDED IN VOLUME 3 OF PLATS, PAGE 80, RECORDS OF SKAGIT  
COUNTY, WASHINGTON.

SITUATED IN SKAGIT COUNTY, WASHINGTON.

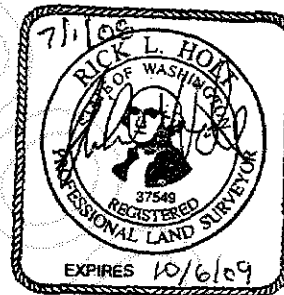

P. 2008 PROJECTS 2008-26 Cascade Bank Legal PARCEL A 223324.doc

130 SHARON AVENUE • BURLINGTON, WA 98233  
1-360-707-2590 • FAX 1-360-757-3976  
www.bayviewse.com



200809240055  
Skagit County Auditor

9/24/2008 Page

2 of

2 11:19AM