



200809090120
Skagit County Auditor

9/9/2008 Page 1 of 4 1:59PM

After recording return document to:

YOUNGQUIST & BETZ
904 South Third
Mount Vernon, WA 98273

DOCUMENT TITLE: Quit Claim Deed
REFERENCE NUMBER OF RELATED DOCUMENT:
GRANTOR(S): Norman L. Ovenell and Eleanor A. Ovenell, husband and wife
GRANTEE(S): Katherine H. Ovenell Roy, a married woman, as her separate property; et al
ADDITIONAL GRANTEES ON PAGE 1 OF DOCUMENT.
ABBREVIATED LEGAL DESCRIPTION: Ptn. of the W 1/2 of SE 1/4 of Sec. 14, Twp. 35 N, R 8 East, W.M.
ADDITIONAL LEGAL DESCRIPTION ON Exhibits A and B OF DOCUMENT.
ASSESSOR'S TAX/PARCEL NUMBER(S): Ptn. of P43907

QUIT CLAIM DEED

THE GRANTORS, **NORMAN L. OVENELL** and **ELEANOR A. OVENELL**, husband and wife, for and in consideration of NO MONETARY CONSIDERATION, boundary line adjustment purposes only, convey and quit claim to **KATHERINE H. OVENELL ROY**, a married woman, as her separate property; **KRISTEN M. OVENELL HANSEN**, a married woman, as her separate property; **CYNTHIA A. OVENELL KLEINHUIZEN**, a married woman, as her separate property; **KARIN N. OVENELL-CARTER**, a married woman, as her separate property; and **HELEN E. OVENELL**, a single woman, in equal shares, the following-described real estate, situated in the County of Skagit, State of Washington, together with all after acquired title of the Grantors therein:

(See attached Exhibit "A" for legal description)



EXHIBIT

"A"

806 Metcalf St., Sedro-Woolley, WA 98284 Phone: (360) 855-2121 FAX: (360) 855-1658

BOUNDARY LINE ADJUSTMENT

LEGAL DESCRIPTION

FOR

NORMAN & ELEANOR OVENELL

OF A PORTION OF ASSESSOR'S PARCEL P43907

TO BE AGGREGATED WITH ASSESSOR'S PARCEL P43893

March 25, 2008

That portion of the west half of the southeast quarter of Section 14, Township 35 North, Range 8 East, W.M. described as follows:

Beginning at the point where the west line of the east 657.75 feet of the west half of the southeast quarter of said Section 14 intersects the south line of the Concrete-Sauk Valley Road; thence S 00°31'28" W along the west line of said east 657.75 feet, a distance of 494.18 feet; thence N 82°21'52" E, a distance of 52.14 feet; thence N 00°48'08" W, a distance of 209.13 feet; thence N 85°30'53" E, a distance of 173.00 feet to a point on a curve to the right, from which the radius point bears N 47°25'10" E, a distance of 140.74 feet; thence northerly along said curve through a central angle of 38°37'25" and an arc distance of 94.87 feet; thence N 03°57'26" E, a distance of 205.08 feet; to the south line of the Concrete-Sauk Valley Road; thence S 81°15'14" W along said south line, a distance of 167.73 feet to the point of beginning of this description.

Situate in Skagit County, Washington.

Containing 1.48 acres.



200809090120

Skagit County Auditor

9/9/2008 Page

3 of

4 1:59PM

of 1

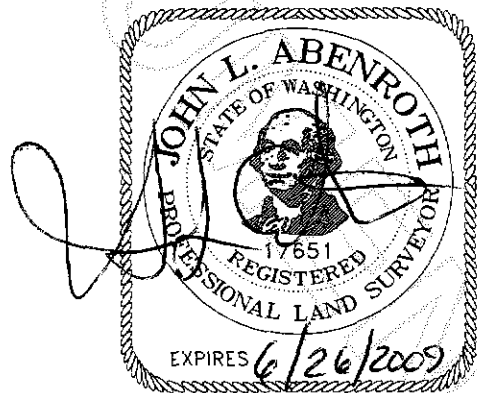

5/5/2008

